

Silever Series

- Rustproff housings made with a special alloy
- Bearings are high carbon chromium bearing steel

UFL000 type*

TWO-BOLT FLANGE UNITS
With Eccentric Collar Locking

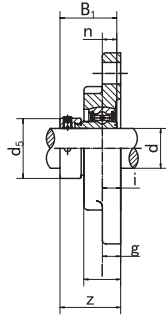

UFL000

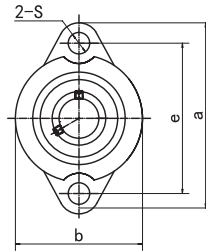

KFL000 type*

TWO-BOLT FLANGE UNITS
With Set Screw Locking

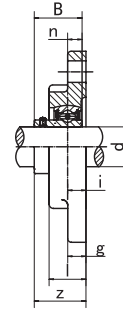

KFL000

Unit NO.	Dimensions (mm / in.)												Bolt Size mm/in.	Bearing No.	Housing No.	Weight (kg)
	d	a	e	i	g	l	S	b	Z	B ₁	n	d ₅				
UFL000	10	60.0 2-23/64	45.0 1-25/32	5.5 7/32	5.5 7/32	11.5 29/64	7.0 9/32	36.0 1-27/64	15.5 39/64	17.5 0.689	4.0 0.157	17.0 43/64	M6	U000	FL000	0.06
UFL001	12	63.0 2-31/64	48.0 1-57/64	5.5 7/32	5.5 7/32	11.5 29/64	7.0 9/32	38.0 1-1/2	16.0 5/8	17.5 0.689	4.0 0.157	19.0 3/4		U001	FL001	0.07
UFL002	15	67.0 2-41/64	53.0 2-3/32	6.5 1/4	6.5 1/4	13.0 33/64	7.0 9/32	42.0 1-21/32	18.6 47/64	18.5 0.728	4.5 0.177	22.0 55/64		U002	FL002	0.10
UFL003	17	71.0 2-51/64	56.0 2-13/64	7.0 9/32	7.0 9/32	14.0 35/64	7.0 9/32	46.0 1-13/16	19.5 49/64	20.5 0.807	5.0 0.197	25.0 31/32	M6	U003	FL003	0.13
UFL004	20	90.0 3-35/64	71.0 2-51/64	8.0 5/16	8.0 5/16	16.0 5/8	10.0 25/64	55.0 2-11/64	23.0 29/32	24.5 0.965	6.0 0.236	30.0 1-3/16	M8	U004	FL04-5	0.20
UFL005	25	95.0 3-47/64	75.0 2-61/64	8.0 5/16	8.0 5/16	16.0 5/8	10.0 25/64	60.0 2-3/8	24.5 31/32	25.5 1.000	6.5 0.256	36.0 1-27/64	M8	U005	FL05-6	0.25
UFL006	30	112.0 4-13/32	85.0 3-11/32	9.0 23/64	9.0 23/64	18.0 23/32	13.0 33/64	70.0 2-3/4	27.0 1-1/6	26.5 1.040	6.5 0.256	42.0 1-21/32	M10	U006	FL06-7	0.35
UFL007	35	122.0 4-51/64	95.0 3-3/4	10.0 25/64	10.0 25/64	20.0 25/32	13.0 33/64	80.0 3-5/32	32.5 1-9/32	29.5 1.161	7.0 0.276	48.0 1-57/64	M10	U007	FL07-8	0.50

Unit NO.	Dimensions (mm / in.)												Bolt Size mm/in.	Bearing No.	Housing No.	Weight (kg)
	d	a	e	i	g	l	S	b	Z	B	n					
KFL000	10	60.0 2-23/64	45.0 1-25/32	5.5 7/32	5.5 7/32	11.5 29/64	7.0 9/32	36.0 1-27/64	15.5 39/64	14.0 0.551	4.0 0.157		M6	K000	FL000	0.06
KFL001	12	63.0 2-31/64	48.0 1-57/64	5.5 7/32	5.5 7/32	11.5 29/64	7.0 9/32	38.0 1-1/2	16.0 5/8	14.5 0.571	4.0 0.157			K001	FL001	0.07
KFL002	15	67.0 2-41/64	53.0 2-3/32	6.5 1/4	6.5 1/4	13.0 33/64	7.0 9/32	42.0 1-21/32	18.6 47/64	16.5 0.650	4.5 0.177			K002	FL002	0.10
KFL003	17	71.0 2-51/64	56.0 2-13/64	7.0 9/32	7.0 9/32	14.0 35/64	7.0 9/32	46.0 1-13/16	19.5 49/64	17.5 0.689	5.0 0.197		M6	K003	FL003	0.13
KFL004	20	90.0 3-35/64	71.0 2-51/64	8.0 5/16	8.0 5/16	16.0 5/8	10.0 25/64	55.0 2-11/64	23.0 29/32	21.0 0.827	6.0 0.236		M8	K004	FL04-5	0.20
KFL005	25	95.0 3-47/64	75.0 2-61/64	8.0 5/16	8.0 5/16	16.0 5/8	10.0 25/64	60.0 2-3/8	24.5 31/32	22.5 0.886	6.5 0.256		M8	K005	FL05-6	0.25
KFL006	30	112.0 4-13/32	85.0 3-11/32	9.0 23/64	9.0 23/64	18.0 23/32	13.0 33/64	70.0 2-3/4	27.0 1-1/6	24.5 0.965	6.5 0.256		M10	K006	FL06-7	0.35

*ALSO AVAILABLE WITH STAINLESS STEEL INSERT AND HOUSING