

DaDo

Information Sheet



Features

- Colour Options
- Operates over entire length
- Optional activation capabilities
- Tamper-proof
- End-cap options
- Easy installation
- Robust and durable
- Reliable

The DaDo signalling system has been designed for a variety of signalling applications in domestic and commercial buildings as well as applications in transportation. It can be operated over its entire length so is ideal for situations where it is advantageous to have a long, continuous signalling switch. Residential care homes, hospitals and police stations are just some examples of places that can benefit from the DaDo System.

The system is simple, robust and reliable. The signalling section consists of three parts: the base aluminium mounting channel, a fully waterproof Tapeswitch® ribbon switch and the TPE top cover. Installation is very easy. After lead connections are made to the ribbon switch and the base is screwed to the wall, the switch is simply placed in the base and then the top cover snaps into position. End caps make the transition from the DaDo system assembly to standard 25mm x 15mm cable trunking, allowing the wiring to be kept neat and tidy. Where internal wiring is used, closed end caps are available. Once the system is fully assembled it is tamper-proof and it is difficult to vandalise the switch.



Typical Applications:

- Police station
- Residential care homes
- Hospitals
- Public sector buildings
- Transportation
- Assembly lines
- Wet environments
- Emergency vehicles



Reassurance in threatening and possible violent situations

Information Sheet

Activation Options

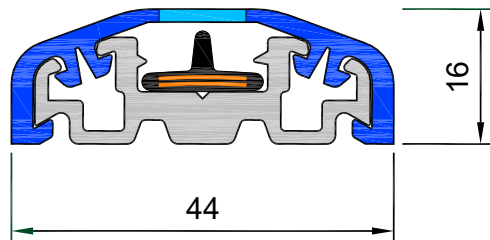

HiSens

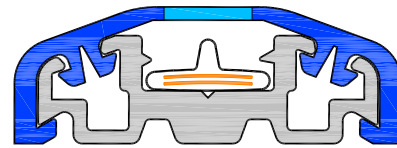

LoSens

The system is available in optional activation. The HiSens version is ideal for panic alarm situations where it is desirable that any contact with the strip, for example, even when someone is pushed into it, causes an alarm. If a great deal of accidental contact is envisaged, which would cause nuisance tripping of the alarm, the LoSens version may be more appropriate, since this is a more deliberate operation. The only difference between the two systems is that the HiSens uses a higher, black ribbon-switch and the LoSens uses a lower, white ribbon-switch.

End-cap Options

Black or white end-cap kits are available, comprising: 2 x closed & 2 x trunking end-caps & 4 x gel-filled terminals

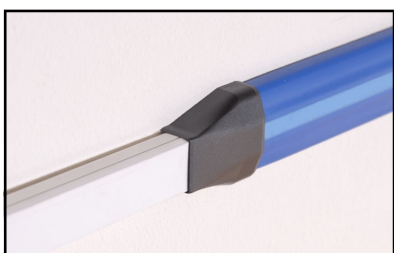
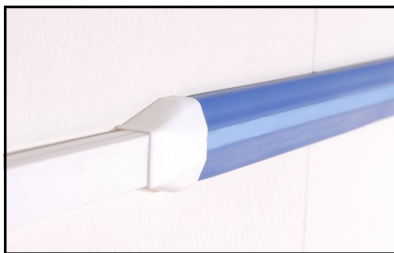

Trunking end-caps for transition to 25x15mm standard trunking

Closed end-cap for embedded cable installations



Illuminated Kit

Illuminated kits comprise: 4 x white end-caps: 2 x closed & 2 x trunking end-caps, 4 x gel-filled terminals and PCB with coloured LED and 5m cable.

Information Sheet

Installation Accessories

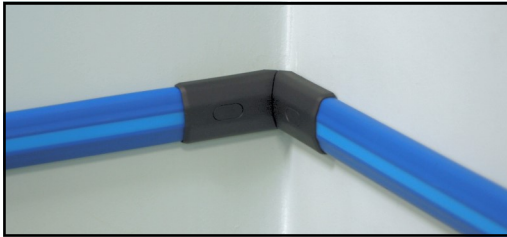

Flexible Internal Corner

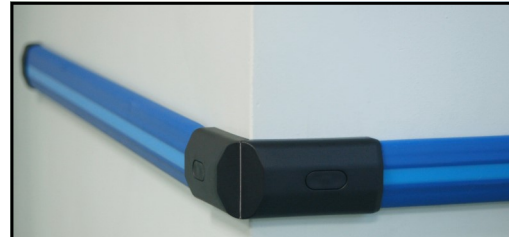

Flexible External Corner

For situations where the DaDo system needs to follow the contours of the room we have designed a flexible internal/external corner.

Installation Tools



Top-cover roller

The Top-cover roller has been designed for installations where long-runs of DaDo are to be installed, once a small section of the top cover has located into the DaDo channel the Top-cover roller is rolled along the lengths of DaDo locking the top cover to the aluminium mounting channel.



Third-hand alignment tool

When installing multiple lengths of DaDo the third-hand alignment tool ensures the top cover will bridge the joins seamlessly. The tool holds together two lengths of channel whilst the installer positions and aligns the channel, the added benefit of a fitted spirit-level ensures the installation is as easy as possible.

Standard Sizes and Colour Options

The DaDo system is available in a single lengths of up to 15m, the mounting channel is supplied in 2m lengths for ease of transportation. The channel is pre-drilled and the holes are countersunk for easy installation. The DaDo top cover is available in 2 colour options; police blue or grey with a red stripe (as shown on front cover). As with any of our products we can customise to suit the customers requirements. If you have a requirement that you think would benefit your installation please contact our sales team to discuss it further.

Information Sheet

Ordering Options

Installations of less than 30m—Ideal for retro-fit small installations by contractors or individuals

For installations where the total length is less than 15m we can supply DaDo as complete ready to fit sections. Measure the room and supply us with the overall dimensions of the lengths of DaDo panic strips required.

Installations of 30m or more with factory-sealed switches—For larger installations by contractors

For installations where the total length is 15m or more we can supply DaDo component parts for on-site configuration and assembly. The DaDo mounting channel will be supplied in 2m sections; the DaDo top cover will be supplied on rolls of 15m; switches will be cut to length and factory-sealed ready for installation; and quantities of end-cap kits as required. Measure the room and supply us with the overall dimensions of the lengths of DaDo panic strips required and we will provide the internal ribbon switch ready for installation along with all the component parts you need. Remember that the factory-sealed switches are terminated and sealed to the length you required, alterations on-site are not recommended without specialist training.

Installations of 15m or more

For larger installations please contact Tapeswitch for further details on all our installation methods.

Tapeswitch Installer

Tapeswitch have a team of expert DaDo system installers who can install your DaDo system. For more details please contact the Tapeswitch sales team.

Order Code

Complete DaDo System

DaDo / Hi / XX / XXXX / DL / XXX

Type

Hi - HiSens (std)
Lo - LoSens

Colour

R - grey/red stripe
B - blue

Overall length (mm)

End cap to end cap

Termination

DL - dual lead (std)

End-cap type

B - black
W - white
XLED - illuminated
X = LED Colour R-red/B-blue/G-green

Factory Sealed Switches

DaDoswitch / Hi / XXXX / DL

Type

Hi - HiSens (std)
Lo - LoSens

Overall length (mm)

End cap to end cap
in 250mm increments

Termination

DL - dual lead (std)