

SOLID SOLUTION DESIGNS

Projectile Information

Name

SSD 358 grain Enforcer

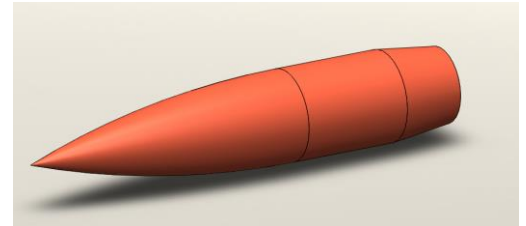

Caliber & Twistrate

.375 , use with 1:8 twist or faster

Comparison with other bullets	
	True BC G1
SSD 358 grain	0.96

Effective range:

3.300m (muzzle velocity : 960 m/s)

Accuracy to be expected:

'Hole-in-hole' at 100m. Use the SSD-Field Test plan to find the correct OAL for the rifle used.

Suggested OAL

The bullet should never be seated deeper than the beginning of the ogive. Also the bullet should not touch the lands and fields of the barrel, in order to prevent overpressure.

Examples:

.375

Minimal: 115,1 mm

Maximum: 122,6 mm (should not touch the rifling)

Quickload information		
BC G1	0.96	
Weight	358 grain	23,19 g
Length	57,15 mm	2,25 "
Velocity band	2800-3280 fps	883 – 1000 m/s

Suggested Powder

N570/N560

Rifle: .375 Desert Tech HTI SSD Custom Barrel: 30 inch Twist: 1 in 8				
Primers: Federal Large Rifle Magnum				
Cases: H&H, trim-to length 72.22 mm (2,84")				
	OAL	Powder	Velocity	Velocity
.375 CT	120.1 mm	133.1 gr N570	2844 fps	867 m/s
.375 CT	116.0 mm	133.0 gr N570	3057 fps	932 m/s
.375 CT	121.7 mm	134.5 gr N570	3169 fps	966 m/s
.375 CT	120.0 mm	134.5 gr N570	3149 fps	960 m/s
.375 CT	119.0 mm	133.7 gr N570	3061 fps	933 m/s
.375 CT	120.1 mm	133.0 gr N570	3005 fps	916 m/s
.375 CT	120.1 mm	134.2 gr N570	3083 fps	940 m/s
.375 CT	119.6 mm	116.0 gr N560	2742 fps	836 m/s
.375 CT	119.6 mm	114.6 gr N560	2680 fps	817 m/s