



# Order Form SEVA

*Recommended Resale Price (RRP). VAT is added as the legal rate of the country.  
Price list valid from September 2024. Images are for illustrative purposes only.*



Shower chair with positioning, with stainless steel frame, footrests and armrests, equipped with hardware for adjustment and insertion of external devices for postural optimization. Soft seat in HR55.

## Available models

A SEVA Tilt 50°	B SEVA Self Propelled	C SEVA Classic																																																									
 <input type="checkbox"/>	 <input type="checkbox"/>	 <input type="checkbox"/>																																																									
<p><b>Reinforced Standard Frame (ESR) Adult</b></p> <table style="width: 100%; border-collapse: collapse;"> <tr><td style="width: 15%;">Width</td><td style="width: 15%; text-align: right;"><b>46 cm</b></td><td style="width: 10%; text-align: center;"><input type="checkbox"/></td></tr> <tr><td rowspan="2">Depth*</td><td style="text-align: right;"><b>40 cm</b></td><td style="text-align: center;"><input type="checkbox"/></td></tr> <tr><td style="text-align: right;"><b>45 cm</b></td><td style="text-align: center;"><input type="checkbox"/></td></tr> <tr><td colspan="3"><b>Seat</b></td></tr> <tr><td>Width</td><td style="text-align: right;"><b>50 cm</b></td><td style="text-align: center;"><input type="checkbox"/></td></tr> <tr><td rowspan="2">Depth*</td><td style="text-align: right;"><b>44 cm</b></td><td style="text-align: center;"><input type="checkbox"/></td></tr> <tr><td style="text-align: right;"><b>49 cm</b></td><td style="text-align: center;"><input type="checkbox"/></td></tr> </table> <p><small>*You must select a depth for each width. ESR incompatible with rear opening seat. Maximum user weight: <b>190 kg</b></small></p>	Width	<b>46 cm</b>	<input type="checkbox"/>	Depth*	<b>40 cm</b>	<input type="checkbox"/>	<b>45 cm</b>	<input type="checkbox"/>	<b>Seat</b>			Width	<b>50 cm</b>	<input type="checkbox"/>	Depth*	<b>44 cm</b>	<input type="checkbox"/>	<b>49 cm</b>	<input type="checkbox"/>	<p><b>Reinforced Standard Frame (ESR) Adult</b></p> <table style="width: 100%; border-collapse: collapse;"> <tr><td style="width: 15%;">Width</td><td style="width: 15%; text-align: right;"><b>46 cm</b></td><td style="width: 10%; text-align: center;"><input type="checkbox"/></td></tr> <tr><td rowspan="2">Depth*</td><td style="text-align: right;"><b>40 cm</b></td><td style="text-align: center;"><input type="checkbox"/></td></tr> <tr><td style="text-align: right;"><b>45 cm</b></td><td style="text-align: center;"><input type="checkbox"/></td></tr> <tr><td colspan="3"><b>Seat</b></td></tr> <tr><td>Width</td><td style="text-align: right;"><b>50 cm</b></td><td style="text-align: center;"><input type="checkbox"/></td></tr> <tr><td rowspan="2">Depth*</td><td style="text-align: right;"><b>44 cm</b></td><td style="text-align: center;"><input type="checkbox"/></td></tr> <tr><td style="text-align: right;"><b>49 cm</b></td><td style="text-align: center;"><input type="checkbox"/></td></tr> </table> <p><small>*You must select a depth for each width. ESR incompatible with rear opening seat. Maximum user weight: <b>200 kg</b></small></p>	Width	<b>46 cm</b>	<input type="checkbox"/>	Depth*	<b>40 cm</b>	<input type="checkbox"/>	<b>45 cm</b>	<input type="checkbox"/>	<b>Seat</b>			Width	<b>50 cm</b>	<input type="checkbox"/>	Depth*	<b>44 cm</b>	<input type="checkbox"/>	<b>49 cm</b>	<input type="checkbox"/>	<p><b>Reinforced Standard Frame (ESR) Adult</b></p> <table style="width: 100%; border-collapse: collapse;"> <tr><td style="width: 15%;">Width</td><td style="width: 15%; text-align: right;"><b>46 cm</b></td><td style="width: 10%; text-align: center;"><input type="checkbox"/></td></tr> <tr><td rowspan="2">Depth*</td><td style="text-align: right;"><b>40 cm</b></td><td style="text-align: center;"><input type="checkbox"/></td></tr> <tr><td style="text-align: right;"><b>45 cm</b></td><td style="text-align: center;"><input type="checkbox"/></td></tr> <tr><td colspan="3"><b>Seat</b></td></tr> <tr><td>Width</td><td style="text-align: right;"><b>50 cm</b></td><td style="text-align: center;"><input type="checkbox"/></td></tr> <tr><td rowspan="2">Depth*</td><td style="text-align: right;"><b>44 cm</b></td><td style="text-align: center;"><input type="checkbox"/></td></tr> <tr><td style="text-align: right;"><b>49 cm</b></td><td style="text-align: center;"><input type="checkbox"/></td></tr> </table> <p><small>*You must select a depth for each width. ESR incompatible with rear opening seat. Maximum user weight: <b>200 kg</b></small></p>	Width	<b>46 cm</b>	<input type="checkbox"/>	Depth*	<b>40 cm</b>	<input type="checkbox"/>	<b>45 cm</b>	<input type="checkbox"/>	<b>Seat</b>			Width	<b>50 cm</b>	<input type="checkbox"/>	Depth*	<b>44 cm</b>	<input type="checkbox"/>	<b>49 cm</b>	<input type="checkbox"/>
Width	<b>46 cm</b>	<input type="checkbox"/>																																																									
Depth*	<b>40 cm</b>	<input type="checkbox"/>																																																									
	<b>45 cm</b>	<input type="checkbox"/>																																																									
<b>Seat</b>																																																											
Width	<b>50 cm</b>	<input type="checkbox"/>																																																									
Depth*	<b>44 cm</b>	<input type="checkbox"/>																																																									
	<b>49 cm</b>	<input type="checkbox"/>																																																									
Width	<b>46 cm</b>	<input type="checkbox"/>																																																									
Depth*	<b>40 cm</b>	<input type="checkbox"/>																																																									
	<b>45 cm</b>	<input type="checkbox"/>																																																									
<b>Seat</b>																																																											
Width	<b>50 cm</b>	<input type="checkbox"/>																																																									
Depth*	<b>44 cm</b>	<input type="checkbox"/>																																																									
	<b>49 cm</b>	<input type="checkbox"/>																																																									
Width	<b>46 cm</b>	<input type="checkbox"/>																																																									
Depth*	<b>40 cm</b>	<input type="checkbox"/>																																																									
	<b>45 cm</b>	<input type="checkbox"/>																																																									
<b>Seat</b>																																																											
Width	<b>50 cm</b>	<input type="checkbox"/>																																																									
Depth*	<b>44 cm</b>	<input type="checkbox"/>																																																									
	<b>49 cm</b>	<input type="checkbox"/>																																																									
<p><b>Standard Frame (ES) Adult</b></p> <table style="width: 100%; border-collapse: collapse;"> <tr><td style="width: 15%;">Width</td><td style="width: 15%; text-align: right;"><b>46 cm</b></td><td style="width: 10%; text-align: center;"><input type="checkbox"/></td></tr> <tr><td rowspan="2">Depth*</td><td style="text-align: right;"><b>40 cm</b></td><td style="text-align: center;"><input type="checkbox"/></td></tr> <tr><td style="text-align: right;"><b>45 cm</b></td><td style="text-align: center;"><input type="checkbox"/></td></tr> <tr><td colspan="3"><b>Seat</b></td></tr> <tr><td>Width</td><td style="text-align: right;"><b>50 cm</b></td><td style="text-align: center;"><input type="checkbox"/></td></tr> <tr><td rowspan="2">Depth*</td><td style="text-align: right;"><b>44 cm</b></td><td style="text-align: center;"><input type="checkbox"/></td></tr> <tr><td style="text-align: right;"><b>49 cm</b></td><td style="text-align: center;"><input type="checkbox"/></td></tr> </table> <p><small>*You must select a depth for each width. ES compatible with the entire range of seats. Maximum user weight: <b>120 kg</b></small></p>	Width	<b>46 cm</b>	<input type="checkbox"/>	Depth*	<b>40 cm</b>	<input type="checkbox"/>	<b>45 cm</b>	<input type="checkbox"/>	<b>Seat</b>			Width	<b>50 cm</b>	<input type="checkbox"/>	Depth*	<b>44 cm</b>	<input type="checkbox"/>	<b>49 cm</b>	<input type="checkbox"/>	<p><b>Standard Frame (ES) Adult</b></p> <table style="width: 100%; border-collapse: collapse;"> <tr><td style="width: 15%;">Width</td><td style="width: 15%; text-align: right;"><b>46 cm</b></td><td style="width: 10%; text-align: center;"><input type="checkbox"/></td></tr> <tr><td rowspan="2">Depth*</td><td style="text-align: right;"><b>40 cm</b></td><td style="text-align: center;"><input type="checkbox"/></td></tr> <tr><td style="text-align: right;"><b>45 cm</b></td><td style="text-align: center;"><input type="checkbox"/></td></tr> <tr><td colspan="3"><b>Seat</b></td></tr> <tr><td>Width</td><td style="text-align: right;"><b>50 cm</b></td><td style="text-align: center;"><input type="checkbox"/></td></tr> <tr><td rowspan="2">Depth*</td><td style="text-align: right;"><b>44 cm</b></td><td style="text-align: center;"><input type="checkbox"/></td></tr> <tr><td style="text-align: right;"><b>49 cm</b></td><td style="text-align: center;"><input type="checkbox"/></td></tr> </table> <p><small>*You must select a depth for each width. ES compatible with the entire range of seats. Maximum user weight: <b>150 kg</b></small></p>	Width	<b>46 cm</b>	<input type="checkbox"/>	Depth*	<b>40 cm</b>	<input type="checkbox"/>	<b>45 cm</b>	<input type="checkbox"/>	<b>Seat</b>			Width	<b>50 cm</b>	<input type="checkbox"/>	Depth*	<b>44 cm</b>	<input type="checkbox"/>	<b>49 cm</b>	<input type="checkbox"/>	<p><b>Standard Frame (ES) Adult</b></p> <table style="width: 100%; border-collapse: collapse;"> <tr><td style="width: 15%;">Width</td><td style="width: 15%; text-align: right;"><b>46 cm</b></td><td style="width: 10%; text-align: center;"><input type="checkbox"/></td></tr> <tr><td rowspan="2">Depth*</td><td style="text-align: right;"><b>40 cm</b></td><td style="text-align: center;"><input type="checkbox"/></td></tr> <tr><td style="text-align: right;"><b>45 cm</b></td><td style="text-align: center;"><input type="checkbox"/></td></tr> <tr><td colspan="3"><b>Seat</b></td></tr> <tr><td>Width</td><td style="text-align: right;"><b>50 cm</b></td><td style="text-align: center;"><input type="checkbox"/></td></tr> <tr><td rowspan="2">Depth*</td><td style="text-align: right;"><b>44 cm</b></td><td style="text-align: center;"><input type="checkbox"/></td></tr> <tr><td style="text-align: right;"><b>49 cm</b></td><td style="text-align: center;"><input type="checkbox"/></td></tr> </table> <p><small>*You must select a depth for each width. ES compatible with the entire range of seats. Maximum user weight: <b>150 kg</b></small></p>	Width	<b>46 cm</b>	<input type="checkbox"/>	Depth*	<b>40 cm</b>	<input type="checkbox"/>	<b>45 cm</b>	<input type="checkbox"/>	<b>Seat</b>			Width	<b>50 cm</b>	<input type="checkbox"/>	Depth*	<b>44 cm</b>	<input type="checkbox"/>	<b>49 cm</b>	<input type="checkbox"/>
Width	<b>46 cm</b>	<input type="checkbox"/>																																																									
Depth*	<b>40 cm</b>	<input type="checkbox"/>																																																									
	<b>45 cm</b>	<input type="checkbox"/>																																																									
<b>Seat</b>																																																											
Width	<b>50 cm</b>	<input type="checkbox"/>																																																									
Depth*	<b>44 cm</b>	<input type="checkbox"/>																																																									
	<b>49 cm</b>	<input type="checkbox"/>																																																									
Width	<b>46 cm</b>	<input type="checkbox"/>																																																									
Depth*	<b>40 cm</b>	<input type="checkbox"/>																																																									
	<b>45 cm</b>	<input type="checkbox"/>																																																									
<b>Seat</b>																																																											
Width	<b>50 cm</b>	<input type="checkbox"/>																																																									
Depth*	<b>44 cm</b>	<input type="checkbox"/>																																																									
	<b>49 cm</b>	<input type="checkbox"/>																																																									
Width	<b>46 cm</b>	<input type="checkbox"/>																																																									
Depth*	<b>40 cm</b>	<input type="checkbox"/>																																																									
	<b>45 cm</b>	<input type="checkbox"/>																																																									
<b>Seat</b>																																																											
Width	<b>50 cm</b>	<input type="checkbox"/>																																																									
Depth*	<b>44 cm</b>	<input type="checkbox"/>																																																									
	<b>49 cm</b>	<input type="checkbox"/>																																																									
<p><b>Standard Frame (ES) Pediatrics</b></p> <table style="width: 100%; border-collapse: collapse;"> <tr><td style="width: 15%;">Width</td><td style="width: 15%; text-align: right;"><b>34 cm</b></td><td style="width: 10%; text-align: center;"><input type="checkbox"/></td></tr> <tr><td rowspan="2">Depth*</td><td style="text-align: right;"><b>28 cm</b></td><td style="text-align: center;"><input type="checkbox"/></td></tr> <tr><td style="text-align: right;"><b>33 cm</b></td><td style="text-align: center;"><input type="checkbox"/></td></tr> <tr><td colspan="3"><b>Seat</b></td></tr> <tr><td>Width</td><td style="text-align: right;"><b>36 cm</b></td><td style="text-align: center;"><input type="checkbox"/></td></tr> <tr><td rowspan="2">Depth*</td><td style="text-align: right;"><b>30 cm</b></td><td style="text-align: center;"><input type="checkbox"/></td></tr> <tr><td style="text-align: right;"><b>35 cm</b></td><td style="text-align: center;"><input type="checkbox"/></td></tr> </table> <p><small>*You must select a depth for each width. ES compatible with the entire range of seats. Maximum user weight: <b>120 kg</b></small></p>	Width	<b>34 cm</b>	<input type="checkbox"/>	Depth*	<b>28 cm</b>	<input type="checkbox"/>	<b>33 cm</b>	<input type="checkbox"/>	<b>Seat</b>			Width	<b>36 cm</b>	<input type="checkbox"/>	Depth*	<b>30 cm</b>	<input type="checkbox"/>	<b>35 cm</b>	<input type="checkbox"/>		<p><b>Standard Frame (ES) Pediatrics</b></p> <table style="width: 100%; border-collapse: collapse;"> <tr><td style="width: 15%;">Width</td><td style="width: 15%; text-align: right;"><b>34 cm</b></td><td style="width: 10%; text-align: center;"><input type="checkbox"/></td></tr> <tr><td rowspan="2">Depth*</td><td style="text-align: right;"><b>28 cm</b></td><td style="text-align: center;"><input type="checkbox"/></td></tr> <tr><td style="text-align: right;"><b>33 cm</b></td><td style="text-align: center;"><input type="checkbox"/></td></tr> <tr><td colspan="3"><b>Seat</b></td></tr> <tr><td>Width</td><td style="text-align: right;"><b>36 cm</b></td><td style="text-align: center;"><input type="checkbox"/></td></tr> <tr><td rowspan="2">Depth*</td><td style="text-align: right;"><b>30 cm</b></td><td style="text-align: center;"><input type="checkbox"/></td></tr> <tr><td style="text-align: right;"><b>35 cm</b></td><td style="text-align: center;"><input type="checkbox"/></td></tr> </table> <p><small>*You must select a depth for each width. ES compatible with the entire range of seats. Maximum user weight: <b>120 kg</b></small></p>	Width	<b>34 cm</b>	<input type="checkbox"/>	Depth*	<b>28 cm</b>	<input type="checkbox"/>	<b>33 cm</b>	<input type="checkbox"/>	<b>Seat</b>			Width	<b>36 cm</b>	<input type="checkbox"/>	Depth*	<b>30 cm</b>	<input type="checkbox"/>	<b>35 cm</b>	<input type="checkbox"/>																			
Width	<b>34 cm</b>	<input type="checkbox"/>																																																									
Depth*	<b>28 cm</b>	<input type="checkbox"/>																																																									
	<b>33 cm</b>	<input type="checkbox"/>																																																									
<b>Seat</b>																																																											
Width	<b>36 cm</b>	<input type="checkbox"/>																																																									
Depth*	<b>30 cm</b>	<input type="checkbox"/>																																																									
	<b>35 cm</b>	<input type="checkbox"/>																																																									
Width	<b>34 cm</b>	<input type="checkbox"/>																																																									
Depth*	<b>28 cm</b>	<input type="checkbox"/>																																																									
	<b>33 cm</b>	<input type="checkbox"/>																																																									
<b>Seat</b>																																																											
Width	<b>36 cm</b>	<input type="checkbox"/>																																																									
Depth*	<b>30 cm</b>	<input type="checkbox"/>																																																									
	<b>35 cm</b>	<input type="checkbox"/>																																																									
		<p><b>Reinforced Standard Frame (ESR) Bariatric</b></p> <table style="width: 100%; border-collapse: collapse;"> <tr><td style="width: 15%;">Width</td><td style="width: 15%; text-align: right;"><b>54 cm</b></td><td style="width: 10%; text-align: center;"><input type="checkbox"/></td></tr> <tr><td rowspan="2">Depth*</td><td style="text-align: right;"><b>48 cm</b></td><td style="text-align: center;"><input type="checkbox"/></td></tr> <tr><td style="text-align: right;"><b>53 cm</b></td><td style="text-align: center;"><input type="checkbox"/></td></tr> </table> <p><small>*You must select a depth for each width. ES compatible with the entire range of seats. Maximum user weight: <b>250 kg</b></small></p>	Width	<b>54 cm</b>	<input type="checkbox"/>	Depth*	<b>48 cm</b>	<input type="checkbox"/>	<b>53 cm</b>	<input type="checkbox"/>																																																	
Width	<b>54 cm</b>	<input type="checkbox"/>																																																									
Depth*	<b>48 cm</b>	<input type="checkbox"/>																																																									
	<b>53 cm</b>	<input type="checkbox"/>																																																									

## Seat Support Frames (ESR/ES)

### Reinforced Standard Frame (ESR)

### Standard Frame (ES)

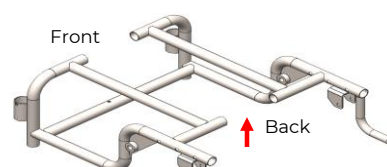
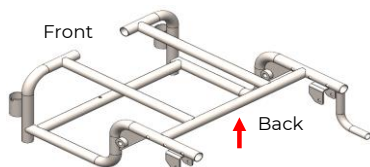

The difference between ESR and ES is based on the rear closure of the seat, giving ESR greater structural strength.

## Wheels and castors

### SEVA Tilt e SEVA Classic models:

4 Castors 100 mm Tente® with brake (Image A/B)

4 Castors 125 mm Tente® with brake (Image A/B)

3 Castors 100 mm Tente® with brake and 1 directional caster 100 mm (Image A/B)

\*The use of 125 mm castors implies a 25 mm increase in seat height



Std



110 €



70 €

### SEVA Self Propelled model:

2 Castors 100 mm Tente® without brake and 2 wheels 24" (Image C)

2 Castors 100 mm Tente® without brake and 2 wheels 22" (Image C)



Std



110 €

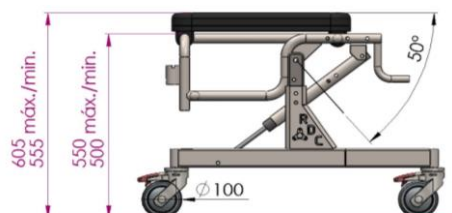

Image A

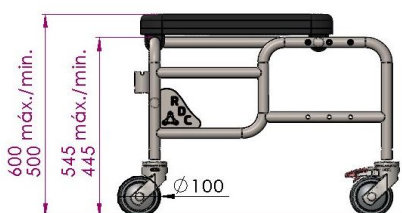

Image B

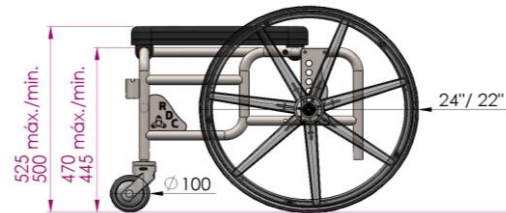

Image C

\*The measurements indicated in the drawings are given in mm with a tolerance of 5%.

## Backrest

Padded vinyl mesh back with high tensioning bands

(Height 310 mm - 6 straps)

Padded vinyl mesh back with medium tensioning bands

(Height 250 mm - 5 straps)

Padded vinyl mesh back with low tensioning bands

(Height 200 mm - 4 straps)

Back width depending on the selected seat width.



90 €



Std



80 €

## Backrest reclination

Backrest reclination to 90° (Image A)

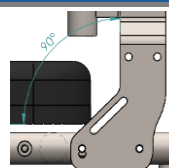

Image A

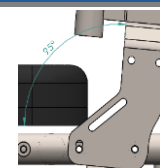

Image B



Std

Backrest reclination to 95° (Image B)



No cost

## Seats

Front-opening seat

Central-opening seat

Rear-opening seat (incompatible with ESR frame)

Pear-opening seat (not available in paediatric and bariatric version)

Seat without opening



Std



170 €



Std



195 €



170 €

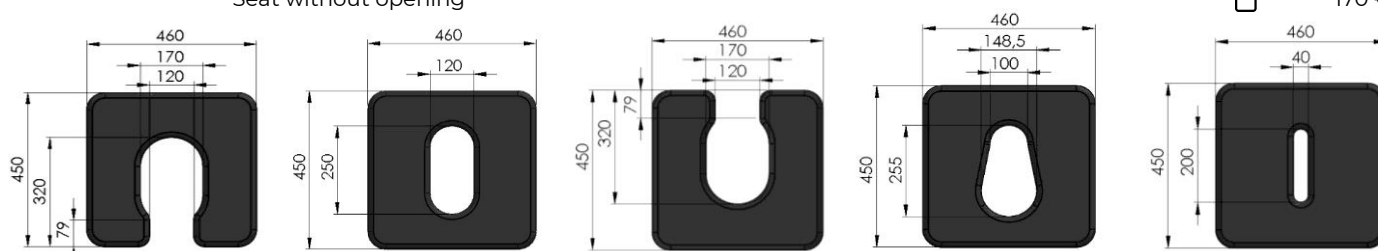

Seat in soft foam HR55 (5 cm), covered with waterproof vinyl mesh, in black color.

## Headrest

Multi-adjustable PU open headrest (W225xH100xD96 mm)\*



50 €

Multi-adjustable PU open headrest (W300xH150xD110 mm)



70 €

Multi-adjustable PU enclosed headrest (W213xH135xD135 mm)



90 €

Low headrest attachment system to the frame\*



195 €





High headrest attachment system to the frame\*



195 €

\*Included in the SEVA Tilt model. The change in the type of support implies added cost.

### Other accessories

Sandals	Foot length _____ cm		<input type="checkbox"/>	190 €
Upholstered footplate (neoprene)			<input type="checkbox"/>	70 €
Sideboard with lid			<input type="checkbox"/>	85 €
PU armrest (L230xW50xH25 mm)			<input type="checkbox"/>	90 €

### Positioning

Medium PU abductor (L113xW82xH100 mm)			<input type="checkbox"/>	190 €
Small PU abductor (L93xW66xH90 mm)			<input type="checkbox"/>	180 €
Padded trunk supports (L120xH80xD20 mm)			<input type="checkbox"/>	195 €
Padded hip guides (L120xH80xD20 mm)			<input type="checkbox"/>	225 €
Aeromesh® Bodypoint® Pelvic Belt M (Length 61-94 cm)			<input type="checkbox"/>	210 €
Aeromesh® Bodypoint® Pelvic Belt L (Length 79-109 cm)			<input type="checkbox"/>	210 €
Aeromesh® Bodypoint® Chest Strap M Comp (61-94 cm)			<input type="checkbox"/>	210 €
Aeromesh® Bodypoint® Chest Strap L (Length 79-109 cm)			<input type="checkbox"/>	210 €
Aeromesh® Bodypoint® Calf Supports			<input type="checkbox"/>	98 €
Women's 4-point butterfly belt			<input type="checkbox"/>	190 €
Men's 4-point butterfly belt			<input type="checkbox"/>	190 €
Prevention gel seat cover			<input type="checkbox"/>	
Knee guide (high footrest curvature)			<input type="checkbox"/>	190 €

### Technical Specifications

SEVA Tilt 50°	SEVA Self Propelled	SEVA Classic
<p><b>Tilt:</b> 50° (0° to 50°)</p> <p><b>Seat height adjustment:</b> 5 cm</p> <p><b>Seat depth adjustment:</b> 5 cm</p> <p><b>Gas spring force:</b> 2 x 200 N</p> <p><b>Footrests:</b> removable, folding stainless steel platform</p> <p><b>Height adjustable footplate:</b> 10 cm</p> <p><b>Castors:</b> 4 with brake 100 mm Tente®</p> <p><b>Tilt actuation:</b> single push lever</p> <p><b>Backrest:</b> with mechanical adjustment at 90° or 95°, tensioned, in waterproof vinyl mesh</p> <p><b>Seat:</b> soft foam HR55, coated padded vinyl mesh</p> <p><b>Armrests:</b> height adjustable 15 cm, folding and neoprene coated</p>	<p><b>Seat height adjustment:</b> 2,5 cm</p> <p><b>Seat depth adjustment:</b> 5 cm</p> <p><b>Footrests:</b> removable and folding stainless steel platform</p> <p><b>Height adjustment footplates:</b> 10 cm</p> <p><b>Castors:</b> 2 without brake, 100 mm Tente® and 24" nylon self-propelled wheels</p> <p><b>Backrest:</b> with mechanical adjustment at 90° or 95°, tensioned, in waterproof vinyl mesh</p> <p><b>Seat:</b> soft foam HR55, coated padded vinyl mesh</p> <p><b>Armrests:</b> height adjustable 15 cm, folding and neoprene coated</p>	<p><b>Seat height adjustment:</b> 10 cm</p> <p><b>Seat depth adjustment:</b> 5 cm</p> <p><b>Footrests:</b> removable and folding stainless steel platform</p> <p><b>Height adjustment footplates:</b> 10 cm</p> <p><b>Castors:</b> 4 with brake 100 mm Tente®</p> <p><b>Backrest:</b> with mechanical adjustment at 90° or 95°, tensioned, in waterproof vinyl mesh</p> <p><b>Seat:</b> soft foam HR55, coated padded vinyl mesh</p> <p><b>Armrests:</b> height adjustable 15 cm, folding and neoprene coated</p>

### Observations

### Information

#### User Info.:

Weight: \_\_\_\_\_ Height: \_\_\_\_\_ Age: \_\_\_\_\_

#### Company Info.:

Name: \_\_\_\_\_

Email: \_\_\_\_\_ Telephone: \_\_\_\_\_ Date: \_\_\_\_\_

*All models can be customized to the user. Price on request.*

Document Date: 09/2024	Tolerance: +/- 1 cm and +/- 1°	Additional information:	geral@rdcmedical.pt
------------------------	--------------------------------	-------------------------	---------------------

---