



DATA SHEET

EASY : BREATHE



FFP2 NR D NANO TECH

EN 149:2001 + A1:2009

CE 0200



MADE IN
DENMARK

CHARACTERISTICS

The FFP2 NR D Nano Tech offers respiratory protection in industries where users are exposed to fine dust particles or aerosols

- Nano filter enables easier, fatigue free breathing
- Tested and approved with CE mark according to EN 149:2001/A1:2009
- Dolomite dust test passed
- Foldability possible
- Space saving storage
- The shape of the mask allows a comfortable fit even in warm and humid environments
- 3 layers
- Latex free and odourless
- Ear loops allow effortless adjustment to face and head
- Nosebands for optimal fit
- Co2 friendly production by purely Danish production
- UVC threatened before packed in Single
- Allergy tested

MATERIALS

- Polyethylene terephthal (PPTL)
- Polypropylene Homopolymer (PPH)
- Polyethylene Vinyl Acetate Elastomer (PVE)
- Ear loops 78% polyamid , 22% spandex
- Noseband Steel/ Plastic
- Filter non woven carrier with nanofiber coating
- Outer layers : spinning fleece
- Product weight : 4 gr

Model Type: FFP2 NR D Nano tech without Valve

MARKING

- **CE mark:** CE 0200
- **Protection level:** FFP2
- **Usability:** NR (Not reusable)
- **Dolomite dust tested:** D
- **Item title:** FFP2 NR D NANO TECH
- **Manufacturer:** HCM GLOBAL APS
- **EN standard:** EN 149:2001 + A1:2009

EXAMPLES

- Drilling
- Hospital
- Nursing home/care
- Woodworking
- Quarry work
- Agriculture
- Grinding/Milling
- Cleaning
- Pest control (water based)
- Construction work
- Demolition work
- Shotcrete
- Decluttering
- Plant and equipment maintenance
- Silo work
- Pandemic preparedness

STANDARDS

The products meet the requirements of the European standard EN 149:2001, filtering half masks for protection against particles. The performance tests of this standard include filter passage, flammability, respiratory resistance and total leakage to the inside. A complete copy of EN 149:2001 can be obtained from your national standardisation authority. In addition, the products have been subjected to the load test according to EN 1327 (test methods with paraffin oil) and meet the corresponding requirements of EN 149:2001/A1:2009.

The selection of the most appropriate personal protection equipment (PPE) depends on the situation involved and may only be made by a competent person who is familiar with the risks, working conditions and restrictions of PPE. For more information about performance features and limitations, see the product packaging. In case of doubt, please contact HCM Global APS info@healthcaremask.com

APPROVALS

The products meet the safety requirements of the EC Directive 2016/425 EEC (Personal Protective Equipment) and therefore bear the CE mark (Module B and Module C2). The certification was carried out by **The notified body' Force Certification A/S, Brøndby , Denmark., NB 0200**

- Module B:0200 PPE 10857 Version 1
- Module C2:0200 PPE QA 11000 Version 1
- Report number: 400/PB COV/2021/NO

STORAGE AND TRANSPORT

The expiration date is indicated on the product packaging. Before use, please always check whether the product is still durable. The product should be stored clean and dry in the temperature range of 20 C to + 25 C with a maximum humidity of 80 percent. Transport the product in its original packaging.

DISPOSAL

For the disposal of used FFP2 NR D NANO Tech. respirators, please observe the regional disposal regulations.

CATEGORY	VALUE
Filter-Rate	Ø 97,5%
Total leakage	Ø 4,67 mbar
Maximum passage of test aerosols / 120 mg NaCl and paraffin oil	Ø 2,50 mbar
Inhalation resistance 30 l per minute	Ø 0,38 mbar
Inhalation resistance 95 l per minute	Ø 1,70 mbar
Exhalation resistance 160 l per minute	Ø 1,90 mbar

DIRECTIONS FOR USE

1. Remove the mask from the packaging and check that it is in good condition.
2. Place the mask on your chin. The nose clip should be positioned at the top.
3. Pull the straps behind your ears and adjust them.
4. Place your fingers on the nose clip and press it while your fingertips move along the nose clip until the nose clip is pressed into a nasal bridge shape to ensure the mask is worn properly.
5. Place both hands completely over the mask and exhale to check the mask-to-face sealing. Adjust the position of the mask if necessary.
6. Breathe normally. Avoid touching the mask.

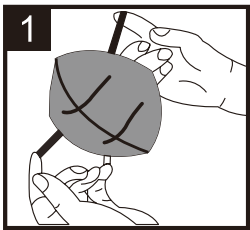

WARNING

This protective mask can be used for respiratory protection, but is not suitable for use in toxic gas environments. This product cannot be used as a gas mask. This protective mask cannot produce oxygen and should not be used in hypoxic environments. Please use them correctly to avoid serious consequences caused by improper use. This mask is a disposable product and cannot be washed. It is unlikely that the leakage values will be achieved by beard wearers who use the mask.

Do not use in potentially explosive atmospheres. Please note that the mask may only be worn during one shift. Do not use the mask if physical damage is detectable. Change the mask when moisturized. Do not touch the mask in the danger zone. Remove the mask - as soon as you feel shortness of breath.