

Site Agent:-

Morrison Supervisor

SITE ADDRESS:-

10070
ZNORWD10
Coburg Crescent
London
SW2 3EB

SIGNS TO BE PLACE ON FENCING/BARRIER-----

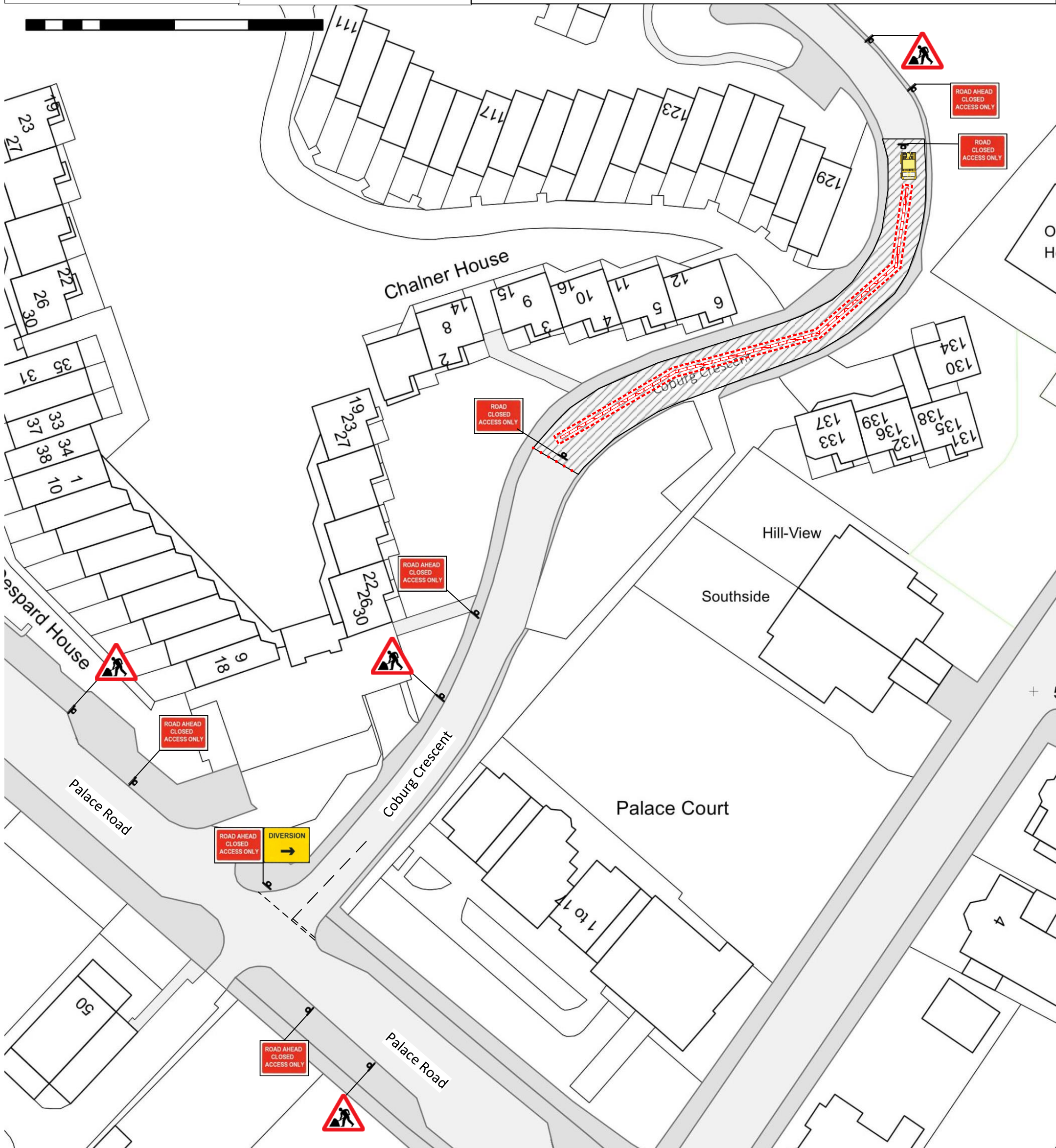
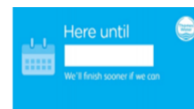
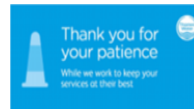

All Traffic Management will be in accordance with Safety at Streetworks and Roadworks Code of Practice 2013



MORRISON Utility Services

Dual carriageways (lane closures) restricted to 40mph or less
Minimum sitting distance of first sign in advance of lead in taper 300mtrs
Minimum taper length calculated dependant on width of hazard at a rate of 1:2.5 with cone spacing of 3mtrs
Single carriageway restricted to 30mph or less
Minimum sitting distance of first sign in advance of lead in taper 20mtrs
(lane closures) Minimum taper length calculated dependant on width of hazard at a rate of 1:1.3

All lead in tapers used with temp traffic lights / stop go boards / priority boards will be at 45 degrees from kerb line at 1.2 metre spacing
Unmarked running lanes will be maintained at 3.5 metres.
Unmarked walkways will be maintained at 1.5 metres or wider
DO NOT SCALE FROM THIS DRAWING

- Key Works area
- Safety zone
- 1m Road cones
- Aspect of sign view
- Barrier/Fencing
- Traffic Signal

DRAWN:- Kevin McQueen
kevin.mcqueen@morrisonws.com
REF: KM231122-1
SCALE: N/A
Checked : John Davidson