

Monitor Support Bracket

Produ CT Code: **MSB**

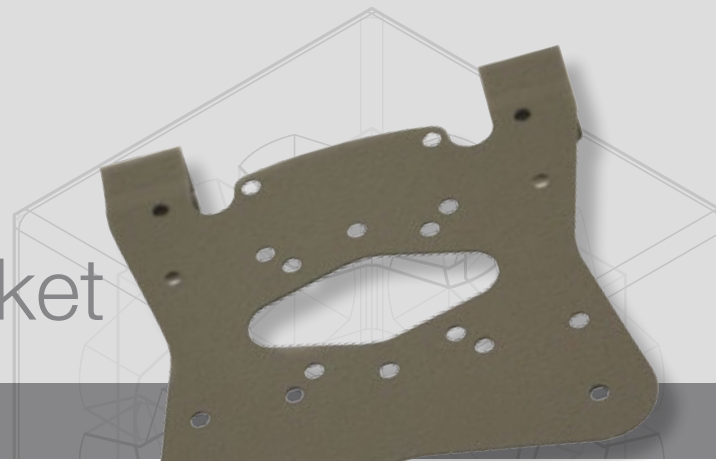

This accessory is designed to support monitors and other screens. The Bracket is fitted to the rear of the monitor using the bolts supplied and then hooked over the horizontal tube. A "letter box" slot needs to be cut in the graphic to allow access for the bracket. There are two knobs at the rear which can be tightened to further secure the bracket to the structure.

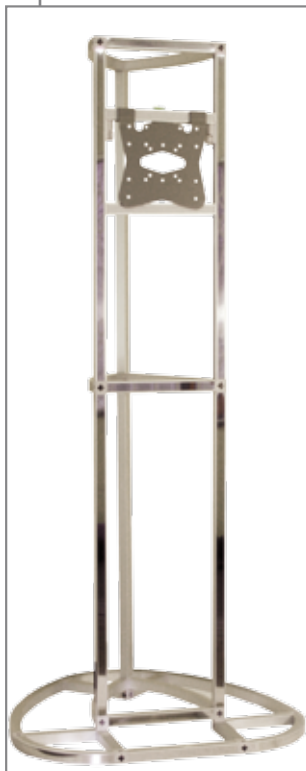

The horizontal tube can be fitted using the normal method of tube to connector or using the twist lock end fitting (CHTL) to any two uprights in any position on the structure.

The twist lock method gives much more flexibility to the location of the monitor. There is a small spirit level permanently fitted



to the top horizontal tube to ensure that the monitor is level. Two adjustable shelf supports (CHSSA) are fitted below the tube to support it, to ensure there is no slippage of the tube under load.

Heavier monitors may swing back into the structure. To stop this happening another horizontal tube is fitted, again either tube to connector or twist lock, though on this occasion there is no need for the adjustable shelf supports. This will stop any movement back into the structure.

The distance between the two horizontal tubes should be 245mm centre to centre.



A full set of bolts and spacers are supplied as standard with the bracket to ensure that all monitors can be attached.

Please note that it is the responsibility of the fitter on site to ensure that the monitor has been attached securely to the framework and the designer that the structure has been correctly designed to carry the load safely.

For all technical or sales enquiries, please visit:
www.next-xpo.com
 info@next-xpo.com +32 (2) 384 83 02