

Modern continuous line luminaire featuring LED light sources.

TECHNICAL DATA

Mounting: suspended, on wire suspension (on request), surface mounted

Body: aluminium profile

Colour: white

Diffuser: opal plexiglass (PLX)

ELECTRICAL DATA

Power: 220-240V 50/60Hz

Includes light source: yes

Type of equipment: STANDARD, DALI

Electrical connection: max 3x1,5 mm² wire, max 5x1,5 mm² wire

OPTICAL DATA

Light distribution: symmetric

Way of lighting: direct

GENERAL DATA

Lifetime (L70B50): 50 000 h

Operating temperature range: 0°C ... +50°C

Additional information: through wiring

Additional equipment: included mounting bracket (2 pc. for 1m luminaire, 2 pcs. for 2m luminaire)

Warranty: 3 years

Application: shopping centers, supermarkets



Code	Replacement of conventional technology [W]	Degree of water and dust protection	Power LED [W]	Luminaire power [W]	Lumen LED [lm]	Lumen luminaire [lm]	Efficacy [lm/W]	Colour temperature [K]	CRI/ Ra
Type of equipment: STANDARD									
300081.00001	1x39W (46W)	IP20	27	32	3800	3550	111	3000	≥80
300081.00002	1x39W (46W)	IP20	27	32	3800	3550	111	4000	≥80
300081.00003	2x39W (92W)	IP20	54	64	7700	7100	111	3000	≥80
300081.00004	2x39W (92W)	IP20	54	64	7700	7100	111	4000	≥80
Type of equipment: DALI									
300081.00009	1x39W (46W)	IP20	27	33	3800	3550	108	3000	≥80
300081.00010	1x39W (46W)	IP20	27	33	3800	3550	108	4000	≥80
300081.00011	2x35W (84W)	IP20	54	65	7700	7100	109	3000	≥80
300081.00012	2x35W (84W)	IP20	54	65	7700	7100	109	4000	≥80

Code	Dimensions [mm] L W H	Pallet quantity	Net weight [kg]
Type of equipment: STANDARD			
300081.00001	1014 40 60	432	2.0
300081.00002	1014 40 60	432	2.0
300081.00003	2014 40 60	432	4.0
300081.00004	2014 40 60	432	4.0
Type of equipment: DALI			
300081.00009	1014 40 60	432	2.0
300081.00010	1014 40 60	432	2.0
300081.00011	2014 40 60	432	4.0
300081.00012	2014 40 60	432	4.0

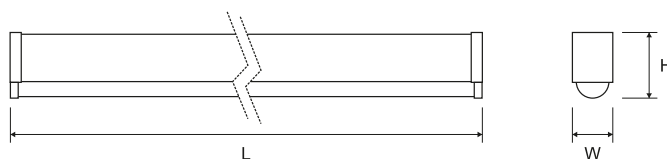

Luminous flux tolerance +/- 10%.

Lighting beam, light intensity distribution and light efficiency were examined in accordance with the EN ISO 17025:2005 norm for EN13032 norm series and the LM-79 norm.

Up-to-date product info available on our website www.lugbox24.com

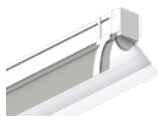
OTHER PICTURES**ACCESSORIES**

150230.00768

Asymmetrical aluminum mirror reflector
(glossy)

150231.00791

LUGLINE LB LED Starter KIT 3-pole (1x
power connector, 2x end cap, 2x cover
masking for reflector)

150231.00792

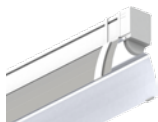
LUGLINE LB LED Starter KIT 5-pole (1x
power connector, 2x end cap, 2x cover
masking for reflector)

150230.00769

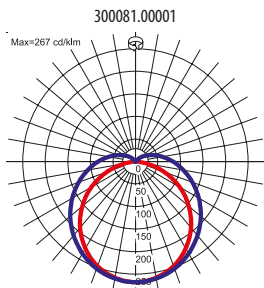
Double asymmetrical aluminum mirror
reflector (glossy)**LIGHT BEAM CURVES**

Luminous flux tolerance +/- 10%.

Lighting beam, light intensity distribution and light efficiency were examined in accordance with the EN ISO 17025:2005 norm for EN13032 norm series and the LM-79 norm.

Up-to-date product info available on our website www.lugbox24.com