

GLINE-2019-nCoV Ag Solution

Quick Perception in Real-time Screening

GLINE-2019-nCoV Ag assay is a colloidal gold immunoassay for the rapid qualitative determination of nucleocapsid protein of SARS-CoV-2 in human nasal or nasopharyngeal swab.

Your Test Choice in:

- Screening checkpoints of specific area: e.g. schools, airports, prisons, nursing homes, primary care, or other high risk congregate settings
- Daily self-check of healthcare personnel and emergency responders
- Home-based routine testing
- Regions with insufficient nucleic acid detection capabilities or unavailable
- Triaging individuals with respiratory symptoms in an emergency department or current outbreak situations

Features:

- **Totally electronic equipment free**
- **Minimal operations required**
- **Results available within 15 minutes**
- Support nasal/nasopharyngeal swab
- Operation environment: 20-30°C
- Storage environment: 2-30°C



Workflow of GLINE-2019-nCoV Ag:

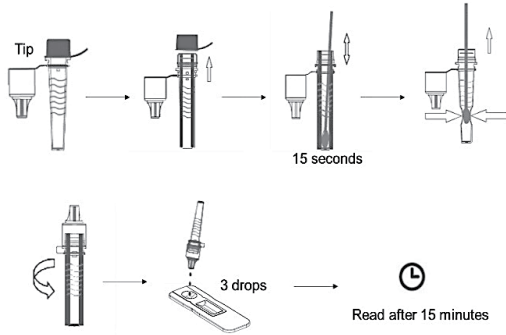

Result Interpretation:

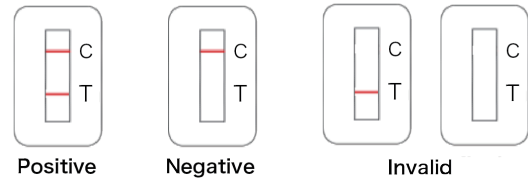

Clinical Significance of SARS-CoV-2 Ag Test

WHO Laboratory Testing Guidance for SARS-CoV-2:
 Generally, the ease-of-use and rapid turnaround time of Ag-RDTs offers the potential to expand access to testing and decrease delays in diagnosis by shifting to decentralized testing of patients with early symptoms.

Antigen-detection in the diagnosis of SARS-CoV-2 infection using rapid immunoassays

Interim guidance
 11 September 2020



Identify the most infectious status of a COVID-19 positive person within the first seven days of symptom onset

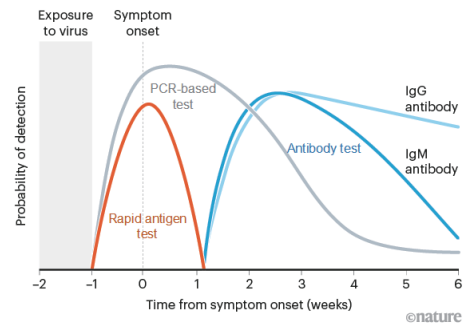

(Giorgia Guglielmi. (2020) Fast coronavirus tests: what they can and can't do. *Nature*, 585: 496-498.)

Meet GLINE-2019-nCoV Family

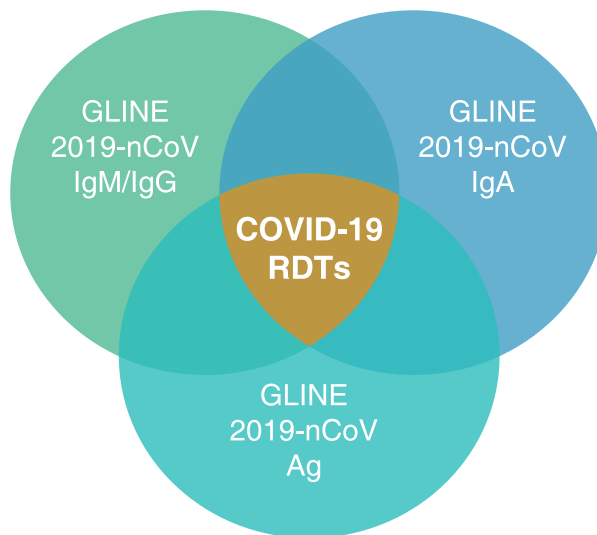

Local Distributor:

P/N: ENG-C030-202011



YHLO

SHENZHEN YHLO BIOTECH CO., LTD.

Headquarter: Building 1, YHLO Biopark, Baolong 2nd Road, Baolong Subdistrict, Longgang District, 518116 Shenzhen, P.R.China

Tel: +86 755 26601910

Email: marketing@szyhlo.com

Website: www.szyhlo.com