

BRASS JACOB ADAPTERS, PG TO METRIC

Material	Brass CuZn39Pb3, nickel-plated
External thread	PG (DIN 40430)
Internal thread	Metric (EN 60423)
Temperature range	-60 °C up to +200 °C
Protection grade	Dependent on the combination with other components

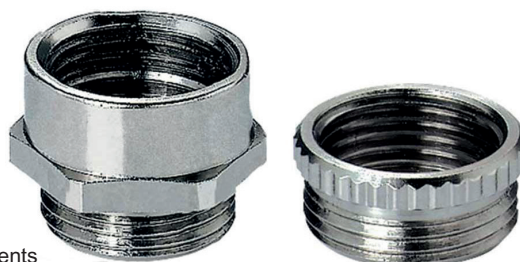

Hexagonal

Typenr.	Connecting thread from - to	Thread length (mm)	Height (mm)	Packing (pcs)
PG7-M12 brass adapter hexagonal	PG7 - M12 x 1,5	5,0	15,0	100
PG9-M16 brass adapter hexagonal	PG9 - M16 x 1,5	6,0	16,0	100
PG11-M16 brass adapter hexagonal	PG11 - M16 x 1,5	6,0	16,0	100
PG13,5-M20 brass adapter hexagonal	PG13,5 - M20 x 1,5	6,5	17,5	100
PG16-M20 brass adapter hexagonal	PG16 - M20 x 1,5	6,5	17,5	100
PG16-M25 brass adapter hexagonal	PG16 - M25 x 1,5	6,5	18,5	100
PG21-M25 brass adapter hexagonal	PG21 - M25 x 1,5	7,0	19,0	100
PG21-M32 brass adapter hexagonal	PG21 - M32 x 1,5	7,0	20,0	100
PG29-M40 brass adapter hexagonal	PG29 - M40 x 1,5	8,0	21,0	50
PG36-M50 brass adapter hexagonal	PG36 - M50 x 1,5	9,0	23,0	25
PG42-M63 brass adapter hexagonal	PG42 - M63 x 1,5	10,0	25,0	10

Knurled

Typenr.	Connecting thread from - to	Thread length (mm)	Height (mm)	Packing (pcs)
PG16-M20 brass adapter knurled	PG16 - M20 x 1,5	6,5	9,5	100
PG21-M25 brass adapter knurled	PG21 - M25 x 1,5	7,0	10,0	100
PG29-M25 brass adapter knurled	PG29 - M25 x 1,5	8,0	11,5	50

In addition to our standard range of cable glands and accessories, we can also supply all other Jacob products (on request).
For this, we refer you to the website of Jacob GmbH: www.jacob-gmbh.de/en/