

*Maria Nyberg*

Blohmé og Holmgren



# Tegnebog

for Folkeskolen.

Uden Farvelægning



DANSK SKOLE-FORLAG  
AARHUS

Hæfte B

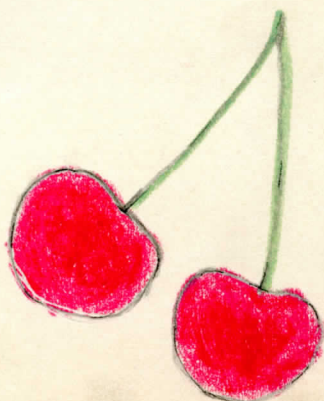
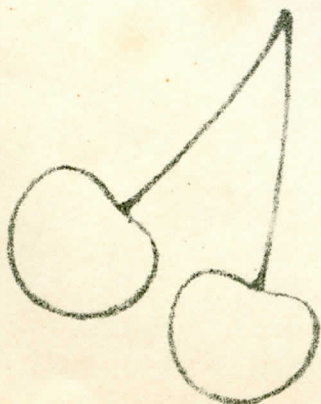
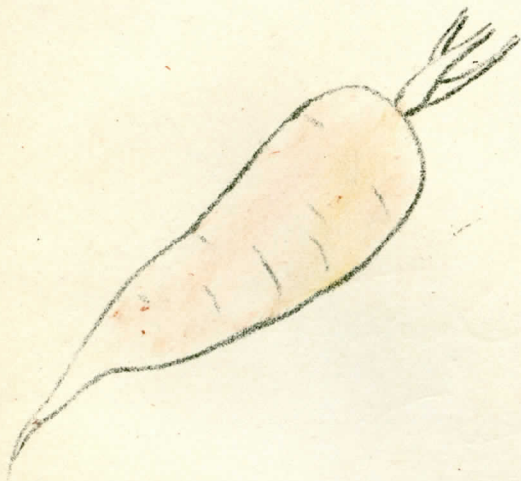
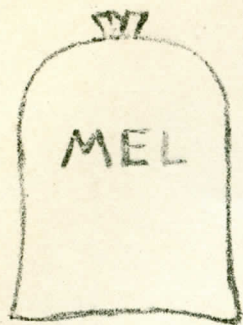

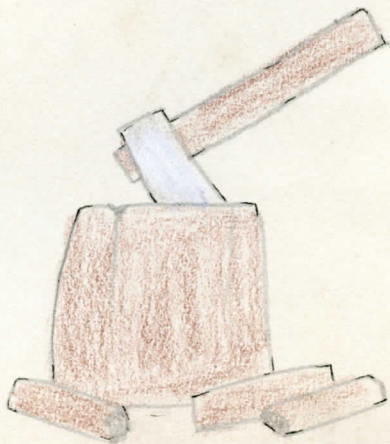
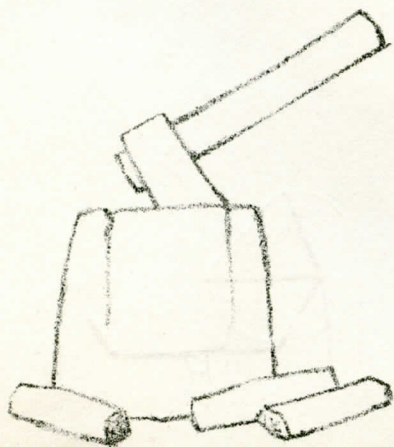
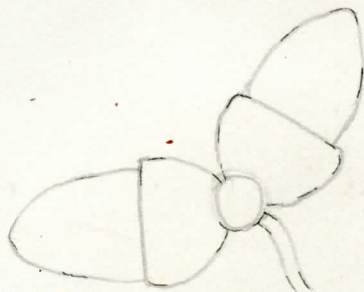
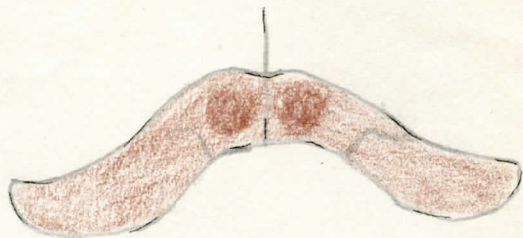
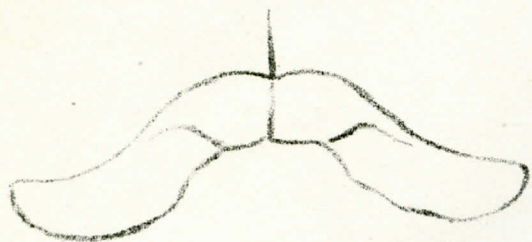

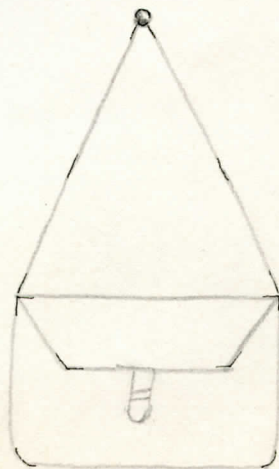
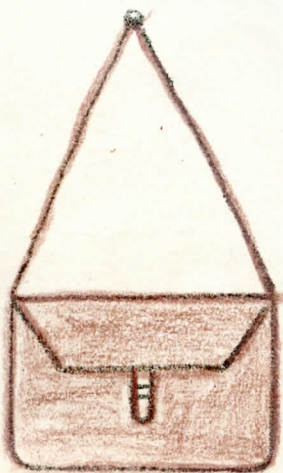
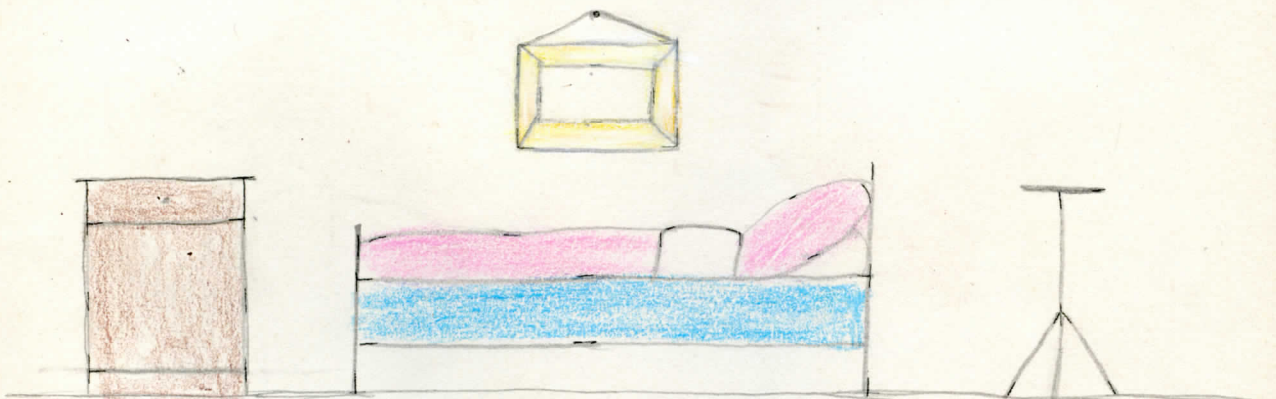
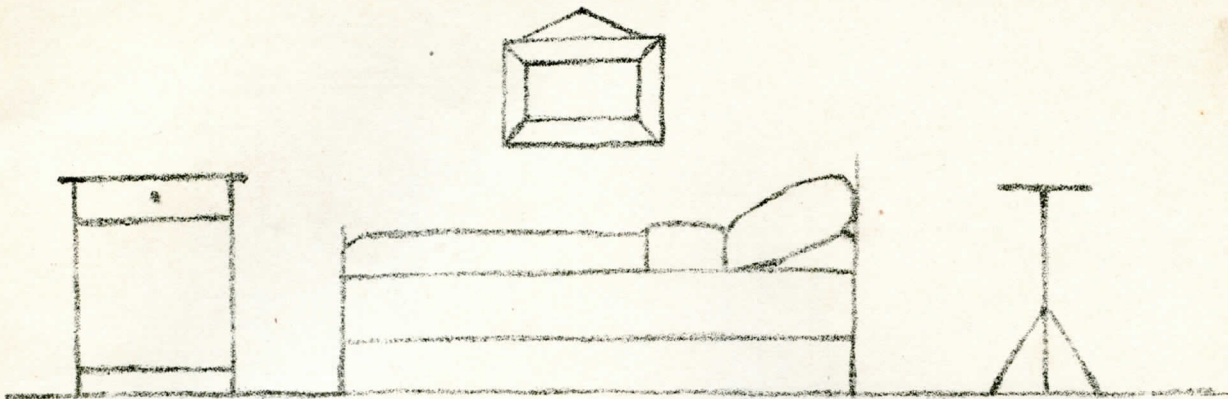

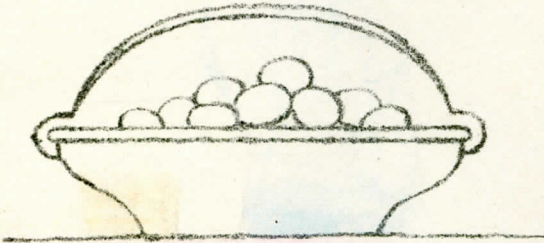
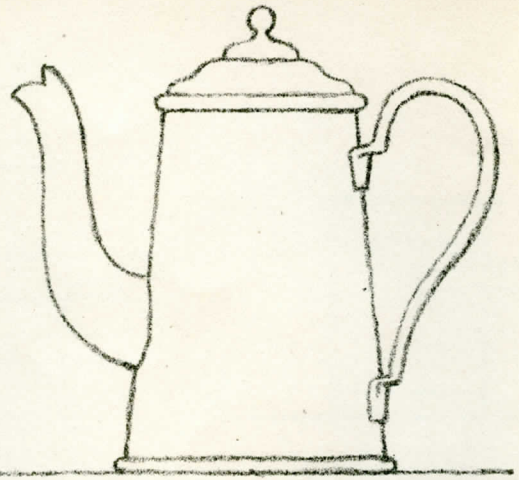
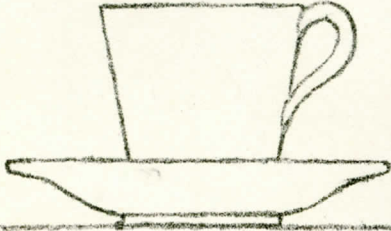

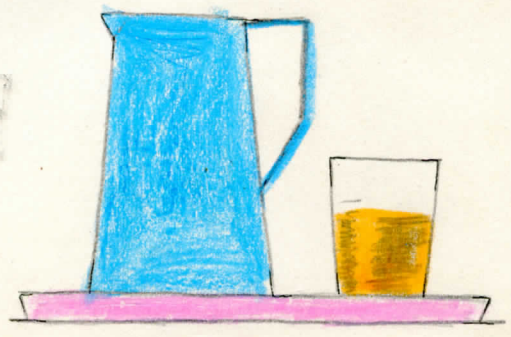
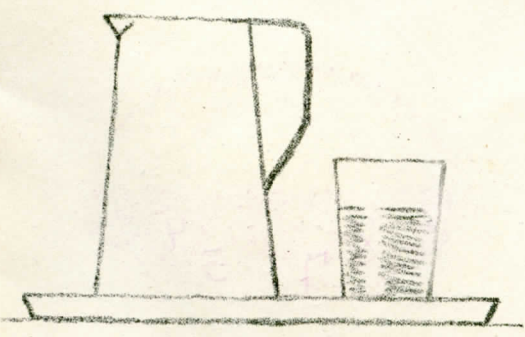
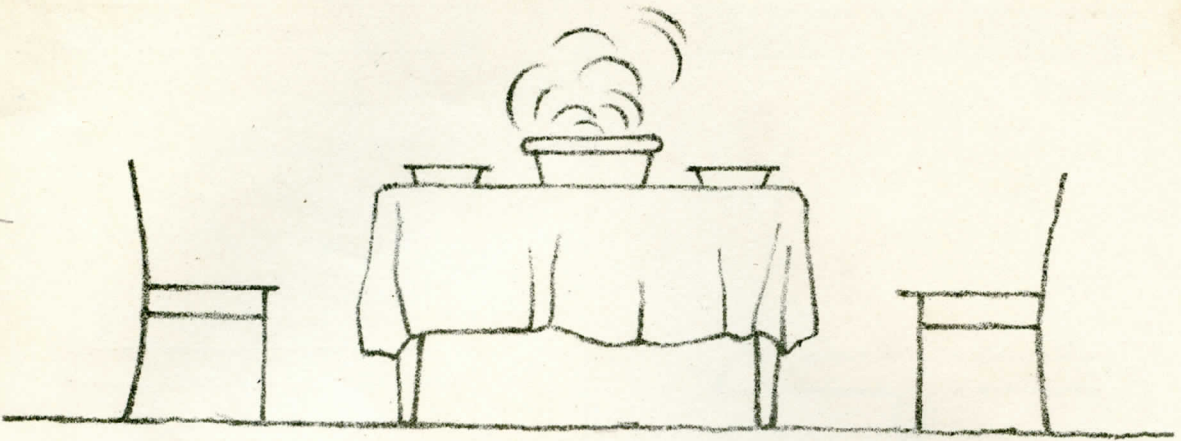

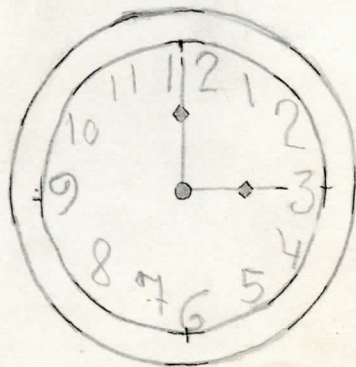
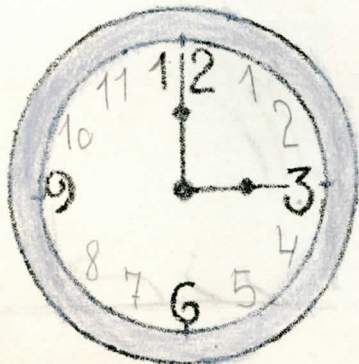
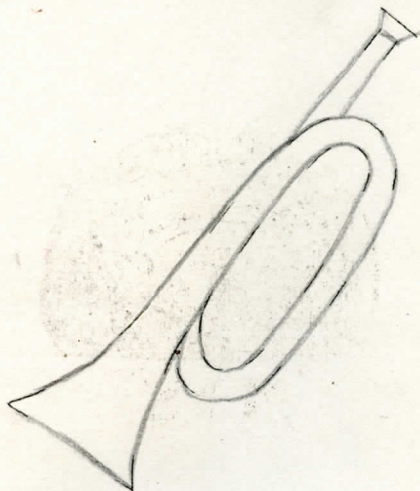
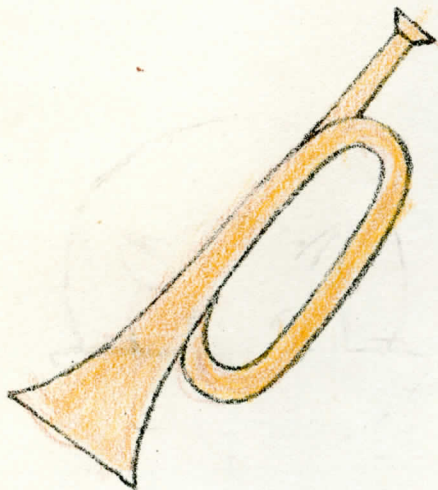
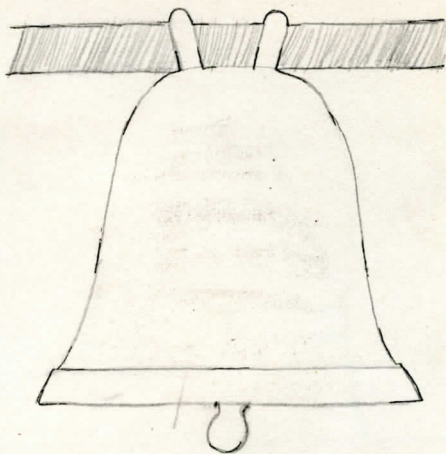
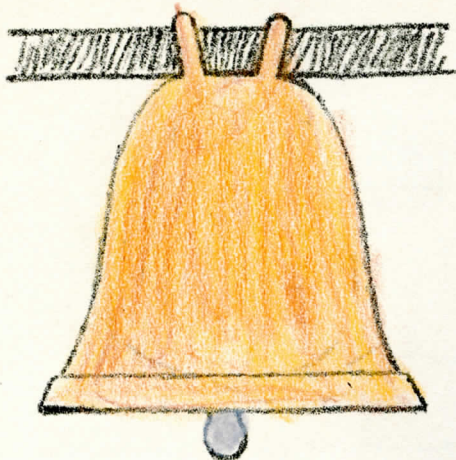

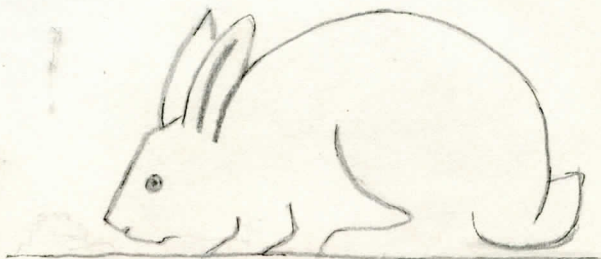
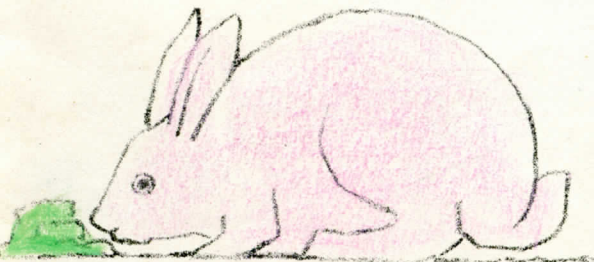
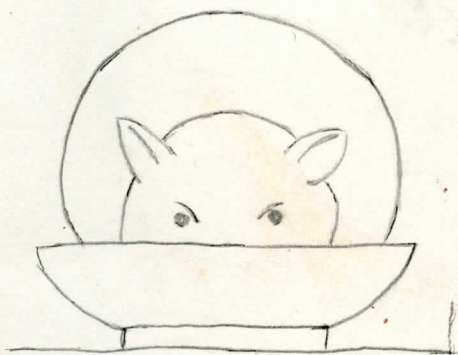
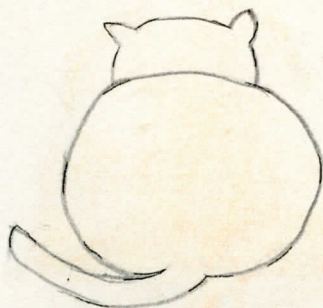



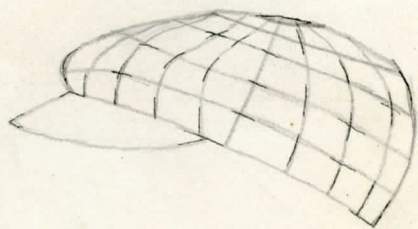
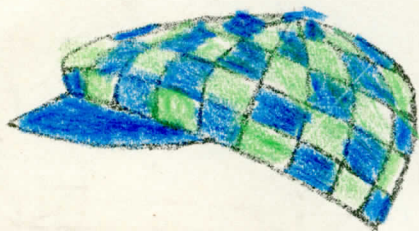

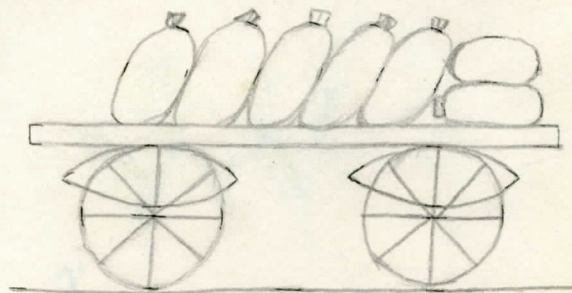
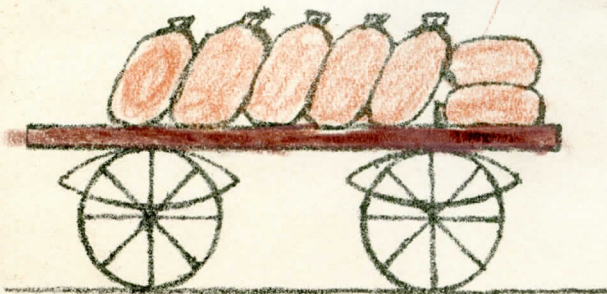
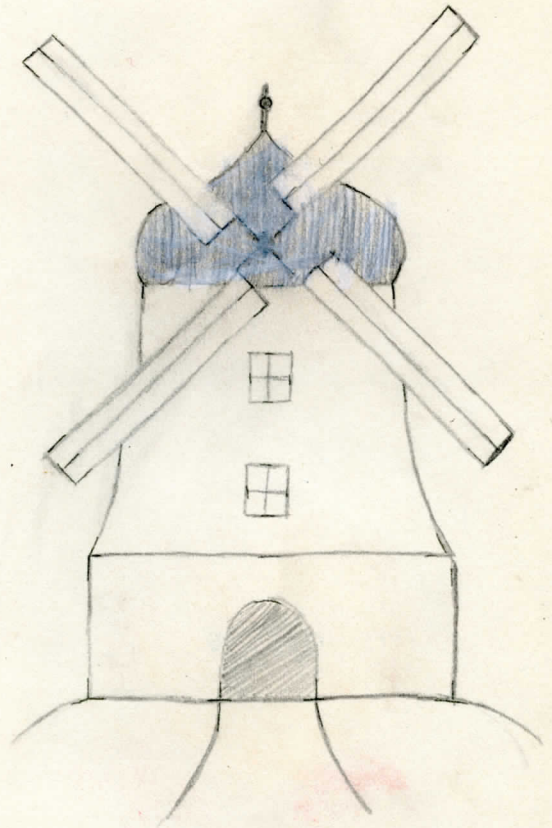
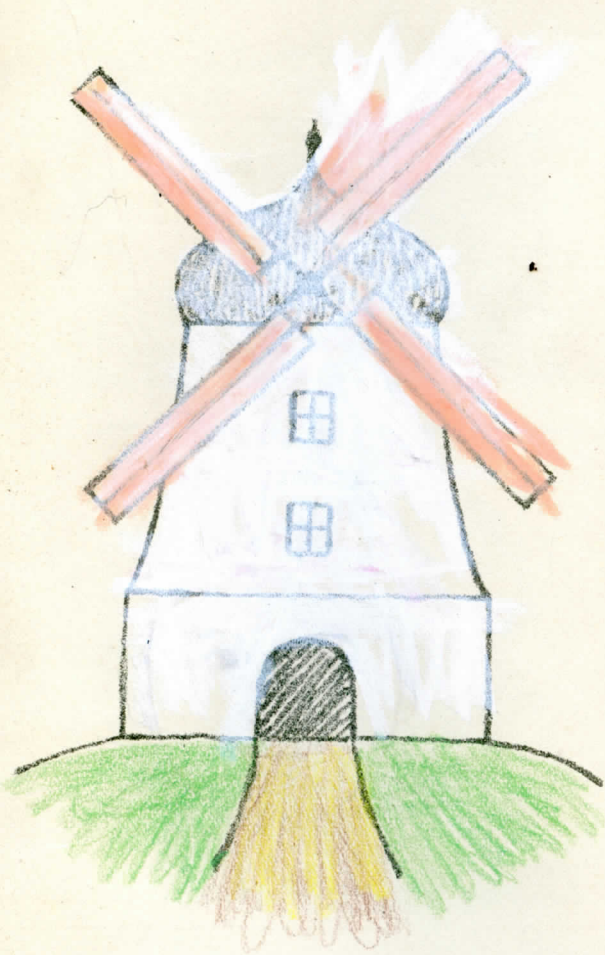

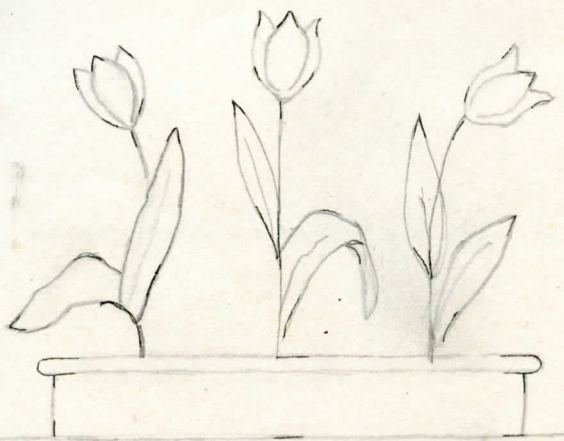
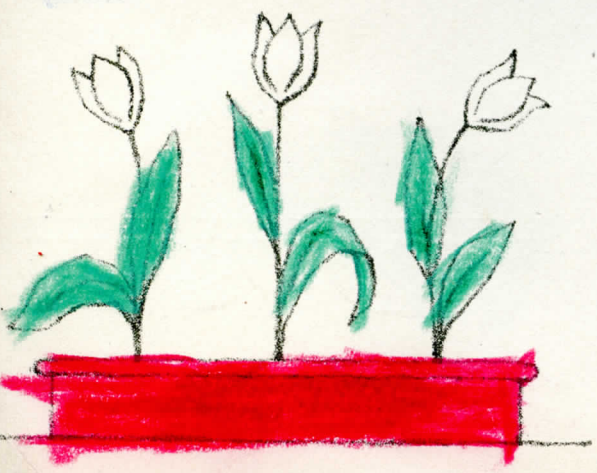
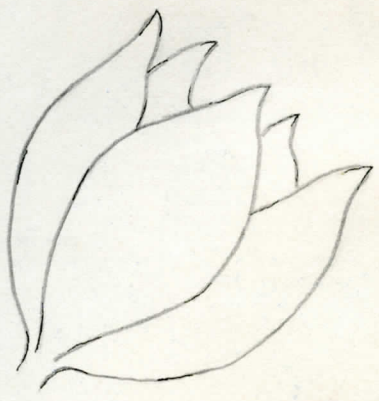
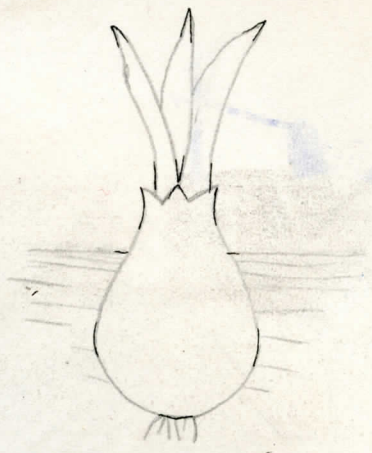
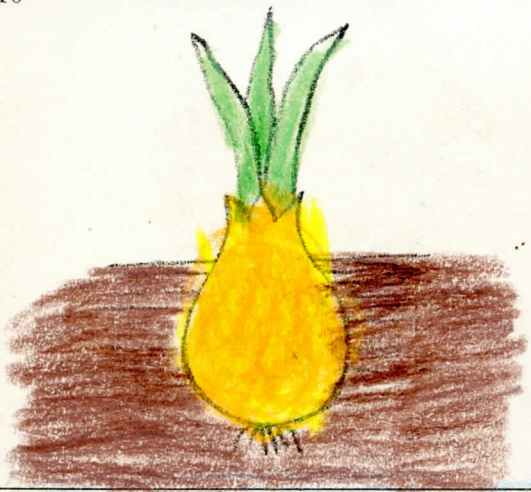

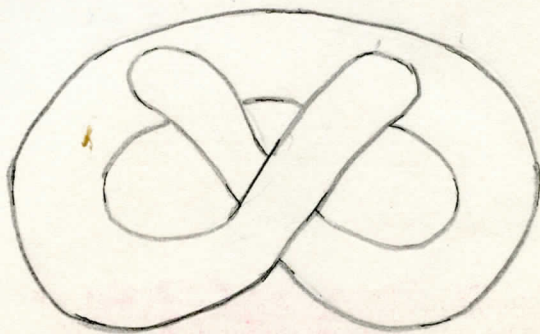
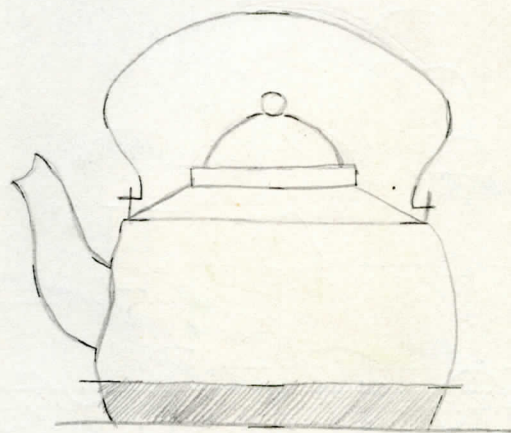
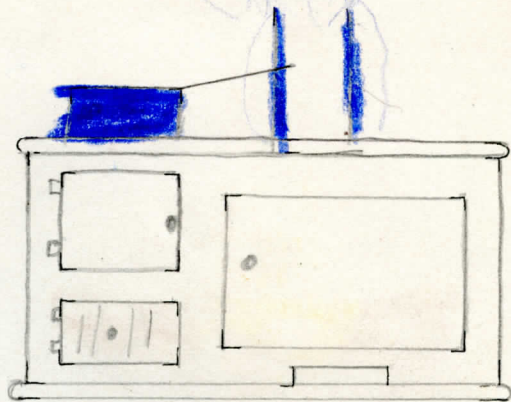
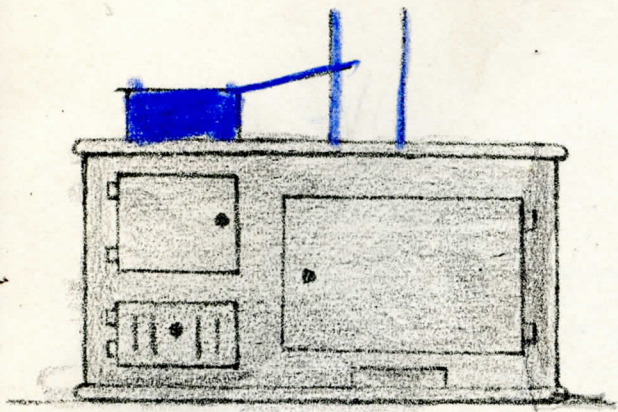

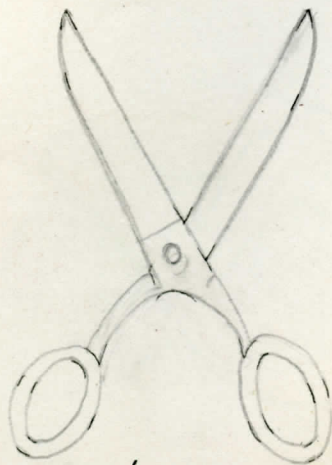
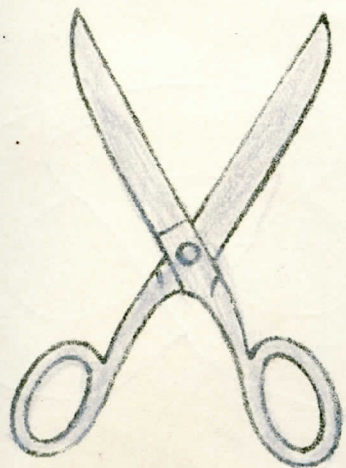
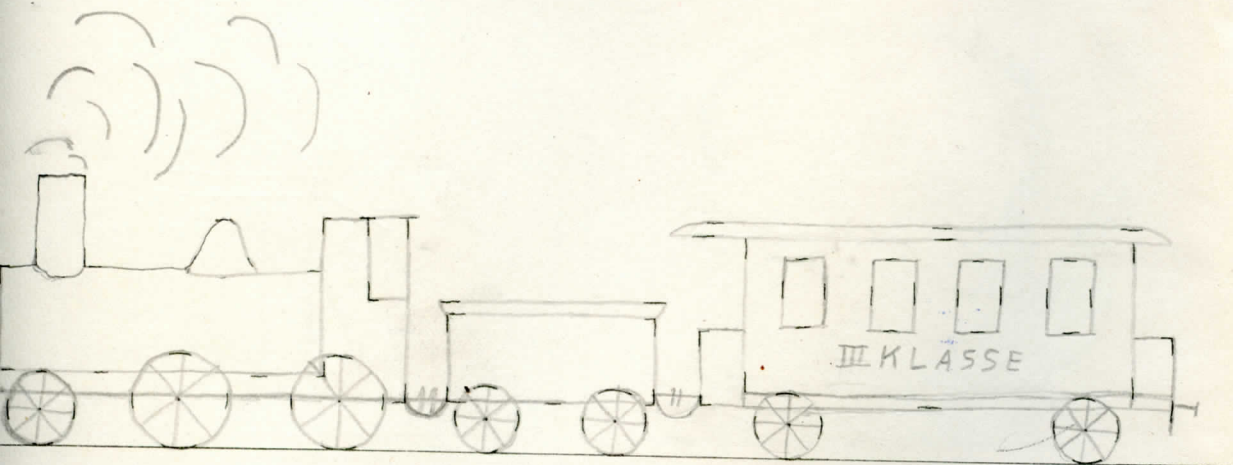
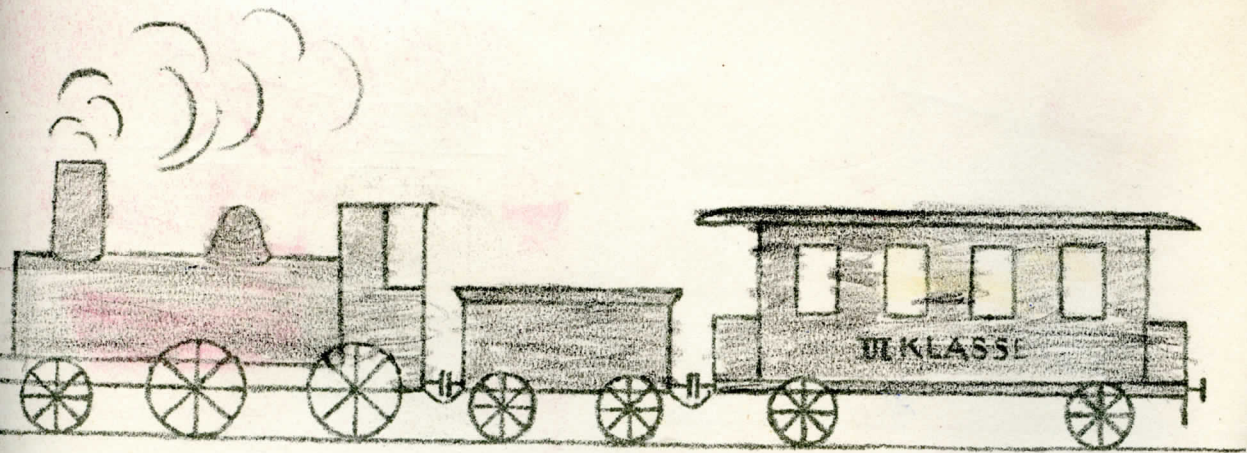

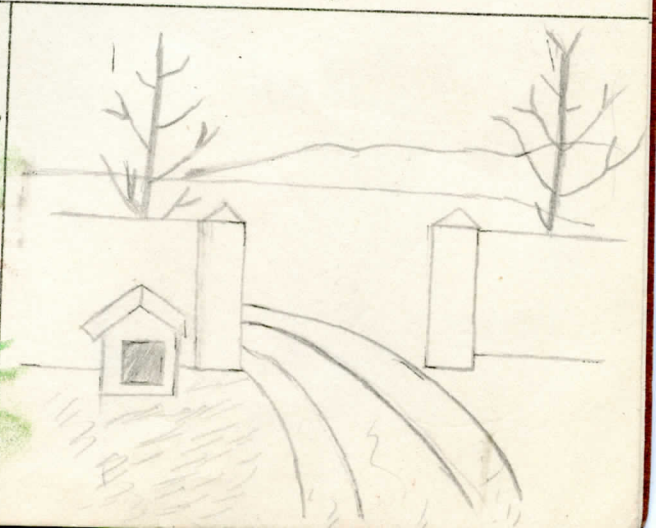
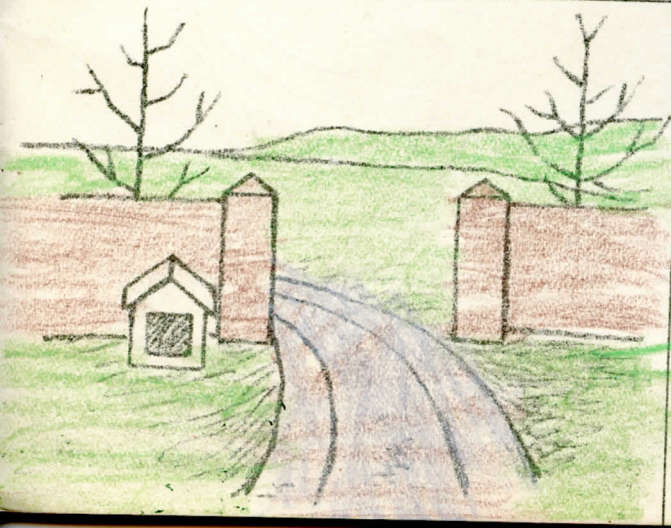
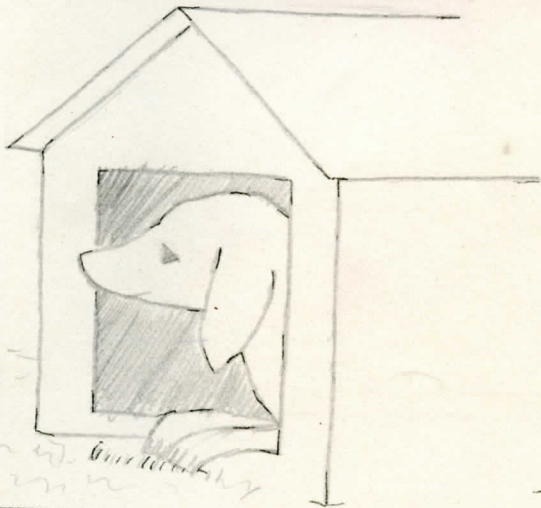
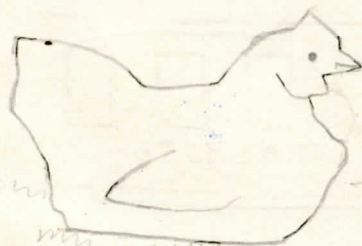
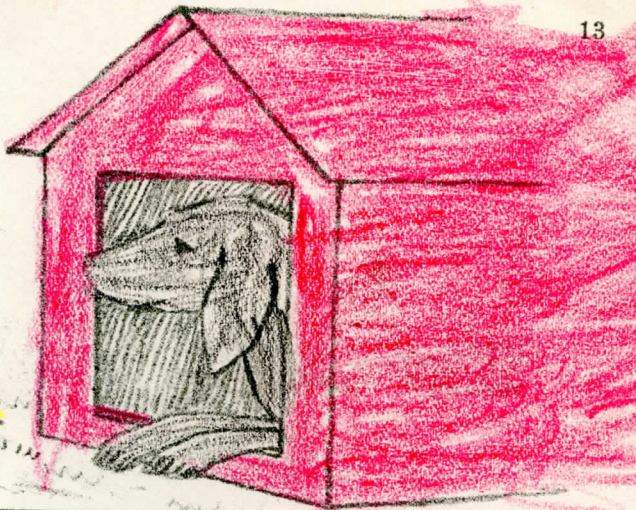
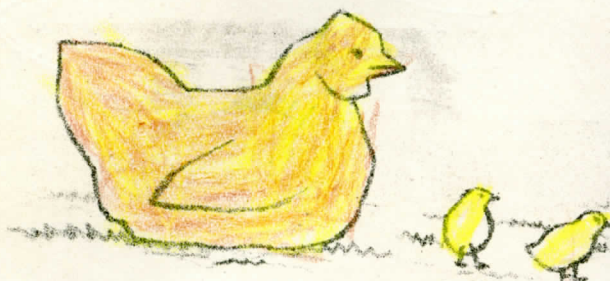

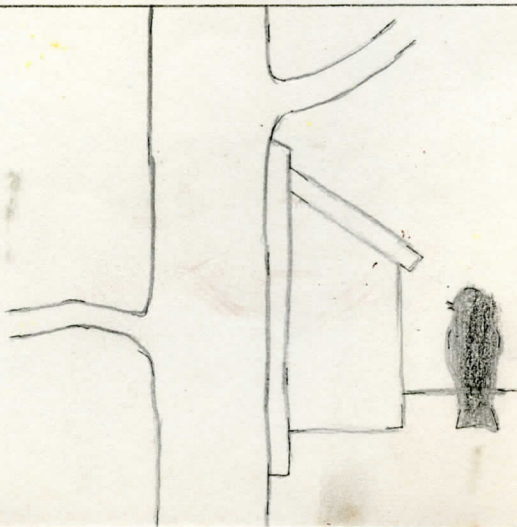
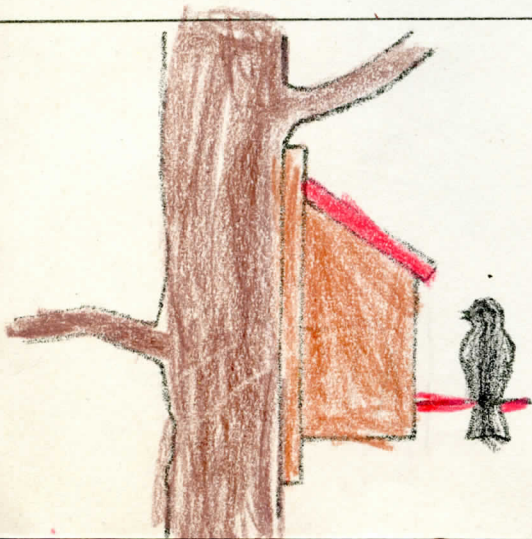
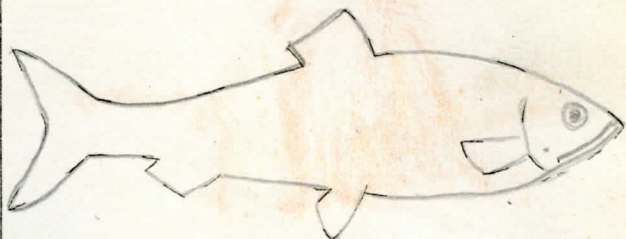
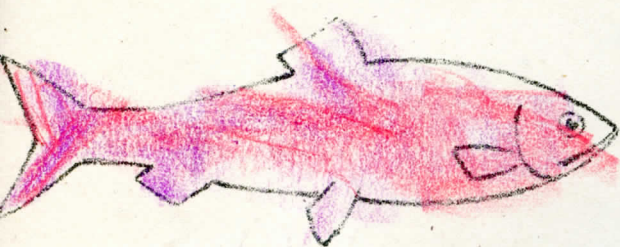

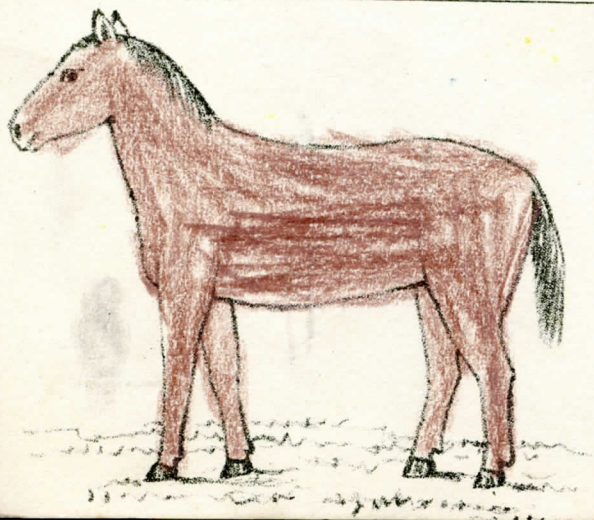
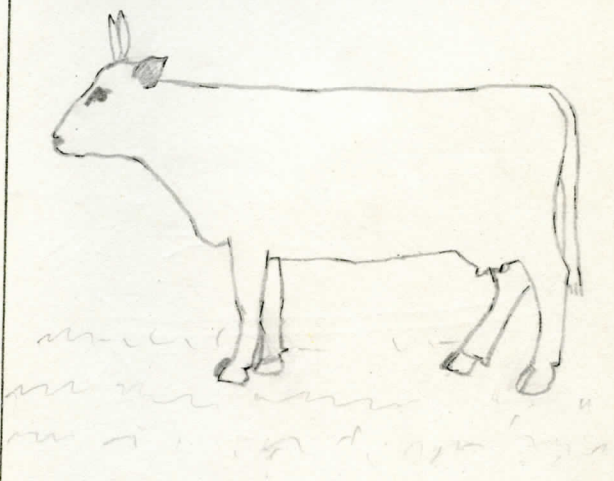
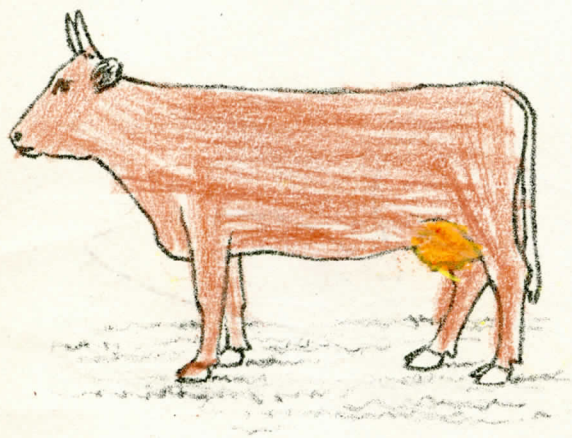
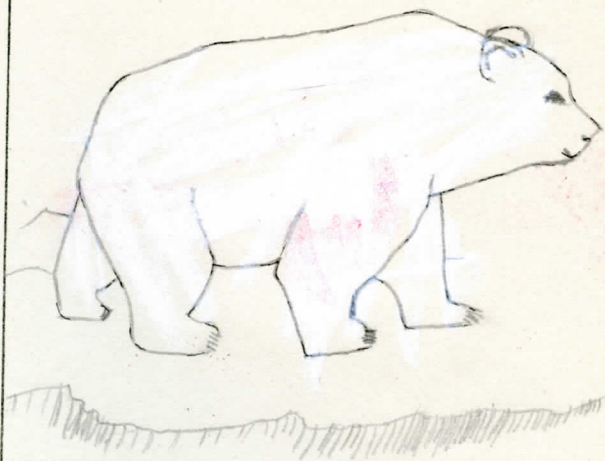
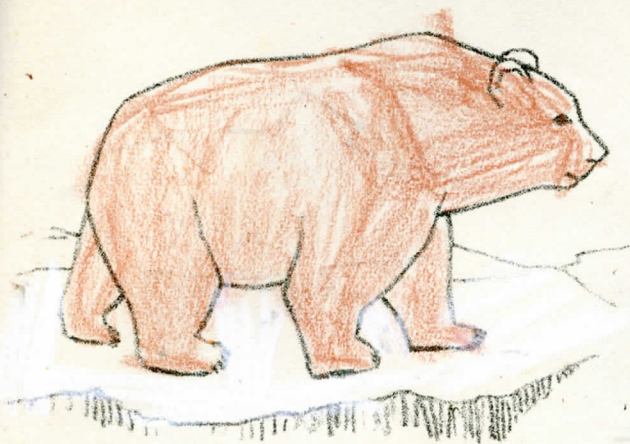



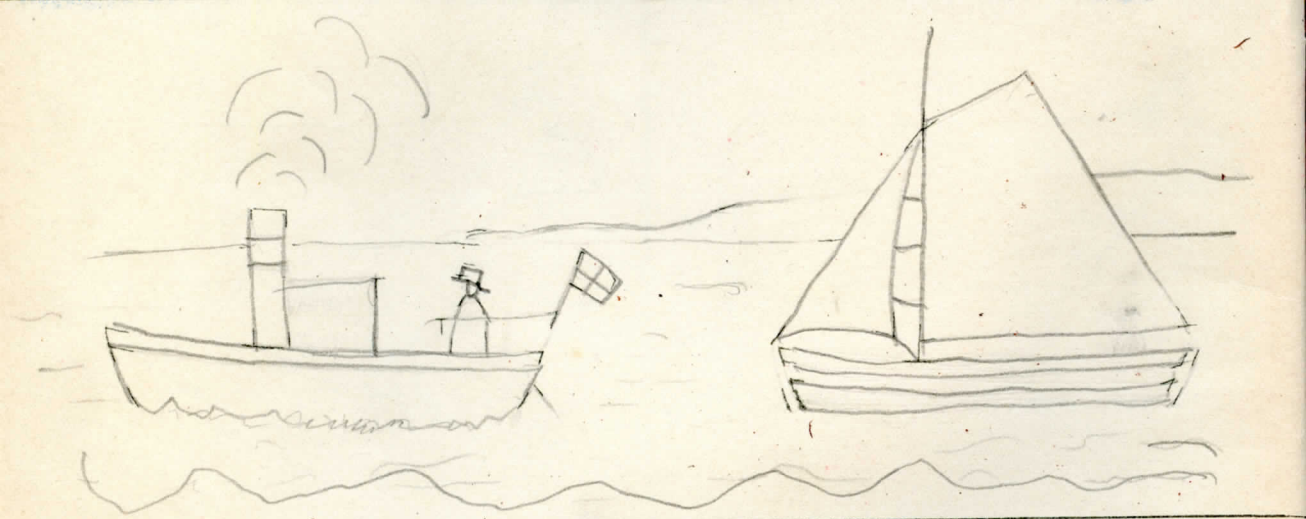
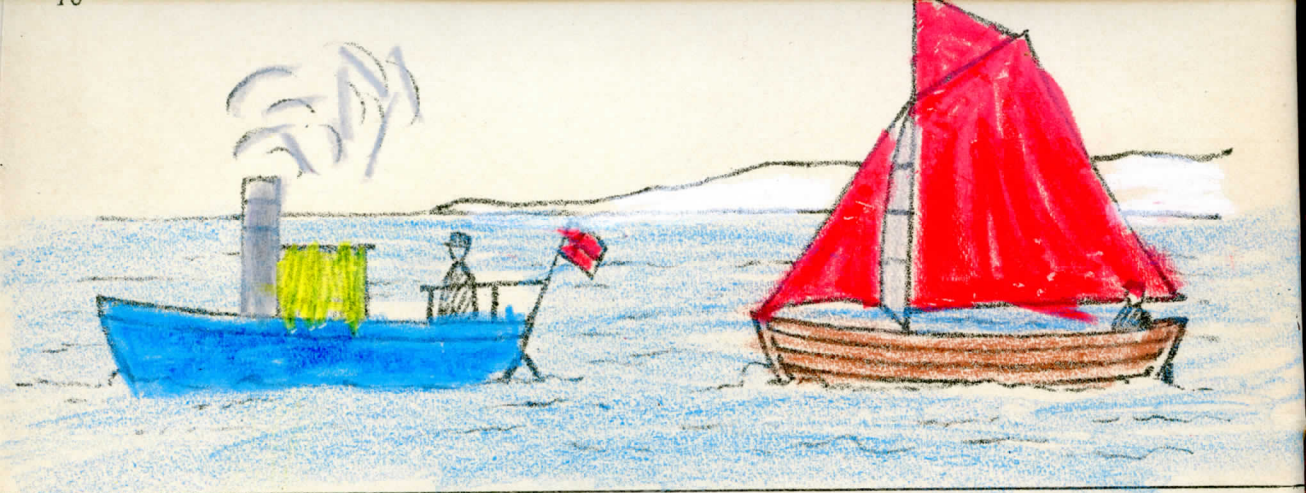

BLOHME OG HOLMGREN:  
TEGNEBOG FOR FOLKESKOLEN

OMFATTER FØLGENDE 12 HÆFTER  
i hver Serie:

- Hæfte A og B for Begyndere, alene til Blyantstegning.  
— A og B do. til Farvelægn. m. Kridtfarver.  
— 1—8 alene til Blyantstegning.  
— 1—8 til Farvelægning med Kridtfarver.  
Hæfte 9 for Drengene og Hæfte 9 for Piger, med eller uden  
Farvelægning.  
Tegnehæfte med 8 blanke Blade (prima Tegnepapir).

Til Hæfterne til Farvelægning anvendes Pastel-  
kridt eller Oliekridt. — Oversprøjtning med Fixativ  
forhindrer Udviskningen af Pastelkridttegningerne.

Bemærk:

EGEN SPECIALFABRIK

for

SKRIVE-, REGNE- OG TEGNEHÆFTER

Benyt Landsbyskolens Karakterbog.

Forlang Prøver.

---

---

DANSK SKOLE-FORLAG & AARHUS