

DIN 444B KNEVELSCHROEVEN – MESSING

DIN 444B EYE BOLTS – BRASS

DIN 444B CORPS DE BOULON A OEIL – LAITON

DIN 444B AUGENSCHRAUBEN – MESSING

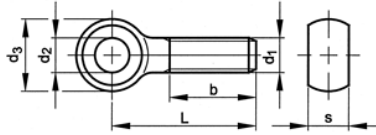

ISO :-
DIN : 444B
NEN : 2310 B
ANSI :-
BS :-
NF :-



M
Ms

P		1	1,25	1,5	1,75	2	2,5
	1	18	22	26	30	38	46
b	2	-	28	32	36	44	52
	3	-	-	-	49	57	65
d2 (H9)		6	8	10	12	16	18
d3 (max.)		14	18	20	20	32	40
S (max.)		7	9	12	14	17	22
d		M6	M8	M10	M12	M16	M20
LENGTE							
25							
30		57180060030					
35							
40		57180060040	57180080040				
45		57180060045	57180080045	57180100045	57180120045		
50		57180060050	57180080050	57180100050	57180120050		
55		57180060055	57180080055	57180100055	57180120055		
60		57180060060	57180080060	57180100060	57180120060	57180160060	57180200060
65		57180060065	57180080065	57180100065	57180120065	57180160065	57180200065
70		57180060070	57180080070	57180100070	57180120070	57180160070	57180200070
80		57180060080	57180080080	57180100080	57180120080	57180160080	57180200080
90				57180100090	57180120090	57180160090	57180200090
100				57180100100	57180120100	57180160100	57180200100
120				57180100120	57180120120	57180160120	57180200120
130							57180200130
140						57180160140	57180200140
150							
160							57180200160
170							
180							
190							
200							
210							
220							
230							
240							
250							

CU2/CU3

1: L ≤ 125 mm.

2: 125 mm < L ≤ 200 mm.

3: L > 200 mm.

