

DIN 444B KNEVELSCHROEVEN – ROESTVASTSTAAL A4

DIN 444B EYE BOLTS – STAINLESS STEEL A4

DIN 444B CORPS DE BOULON A OEIL – ACIER INOXYDABLE A4

DIN 444B AUGENSCHRAUBEN – ROSTFREISTAHL A4

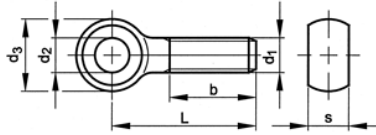

ISO :-
DIN : 444B
NEN : 2310 B
ANSI :-
BS :-
NF :-



M
RVS
A4

P		0,8	1	1,25	1,5	1,75	2
	1	16	18	22	26	30	34
b	2	-	-	28	32	36	40
	3	-	-	-	-	49	53
d2 (H9)		5	6	8	10	12	14
d3 (max.)		12	14	18	20	25	28
S (max.)		6	7	9	12	14	16
d	LENGTE	M5	M6	M8	M10	M12	M14
25		65790050025	65790060025	65790080025	65790100025	65790120025	
30		65790050030	65790060030	65790080030	65790100030	65790120030	
35		65790050035	65790060035	65790080035	65790100035	65790120035	
40		65790050040	65790060040	65790080040	65790100040	65790120040	
45			65790060045	65790080045	65790100045	65790120045	
50			65790060050	65790080050	65790100050	65790120050	65790140050
55			65790060055	65790080055	65790100055	65790120055	65790140055
60			65790060060	65790080060	65790100060	65790120060	65790140060
65			65790060065	65790080065	65790100065	65790120065	65790140065
70			65790060070	65790080070	65790100070	65790120070	65790140070
75			65790060075	65790080075	65790100075	65790120075	65790140075
80			65790060080	65790080080	65790100080	65790120080	65790140080
85				65790080085	65790100085	65790120085	65790140085
90				65790080090	65790100090	65790120090	65790140090
95				65790080095	65790100095	65790120095	65790140095
100				65790080100	65790100100	65790120100	65790140100
105				65790080105	65790100105	65790120105	65790140105
110				65790080110	65790100110	65790120110	65790140110
115				65790080115	65790100115	65790120115	65790140115
120				65790080120	65790100120	65790120120	65790140120
125				65790080125	65790100125	65790120125	65790140125
130				65790080130	65790100130	65790120130	65790140130
135				65790080135	65790100135	65790120135	65790140135
140				65790080140	65790100140	65790120140	65790140140
145						65790120145	65790140145
150						65790120150	65790140150
160						65790120160	65790140160
170						65790120170	65790140170
180						65790120180	65790140180
190						65790120190	65790140190
200						65790120200	65790140200
210							
220							
230							
240							
250							

Knevelschroeven M14, M18 en M22 zijn niet meer in de actuele norm omschreven.

1: L ≤ 125 mm.

2: 125 mm < L ≤ 200 mm.

3: L > 200 mm.



DIN 444B KNEVELSCHROEVEN – ROESTVASTSTAAL A4

DIN 444B EYE BOLTS – STAINLESS STEEL A4

DIN 444B CORPS DE BOULON A OEIL – ACIER INOXYDABLE A4

DIN 444B AUGENSCHRAUBEN – ROSTFREISTAHL A4

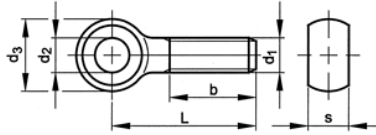

ISO :-
DIN : 444B
NEN : 2310 B
ANSI :-
BS :-
NF :-



M
RVS
A4

P		2	2,5	2,5	2,5	3	3
1	1	38	42	46	50	54	60
b	2	44	48	52	56	60	66
	3	57	61	65	69	73	79
d2 (H9)		16	18	18	18	22	25
d3 (max.)		32	32	40	42	45	50
S (max.)		17	20	22	24	25	27
d		M16	M18	M20	M22	M24	M27
LENGTE							
25							
30							
35							
40							
45							
50							
55							
60		65790160060	65790180060	65790200060			
65		65790160065	65790180065	65790200065			
70		65790160070	65790180070	65790200070			
75		65790160075	65790180075	65790200075			
80		65790160080	65790180080	65790200080	65790220080	65790240080	
85		65790160085	65790180085	65790200085	65790220085	65790240085	
90		65790160090	65790180090	65790200090	65790220090	65790240090	
95		65790160095	65790180095	65790200095	65790220095	65790240095	
100		65790160100	65790180100	65790200100	65790220100	65790240100	
105		65790160105	65790180105	65790200105	65790220105	65790240105	
110		65790160110	65790180110	65790200110	65790220110	65790240110	
115		65790160115	65790180115	65790200115	65790220115	65790240115	
120		65790160120	65790180120	65790200120	65790220120	65790240120	65790270120
125		65790160125	65790180125	65790200125	65790220125	65790240125	65790270125
130		65790160130	65790180130	65790200130	65790220130	65790240130	65790270130
135		65790160135	65790180135	65790200135	65790220135	65790240135	65790270135
140		65790160140	65790180140	65790200140	65790220140	65790240140	65790270140
145		65790160145	65790180145	65790200145	65790220145	65790240145	65790270145
150		65790160150	65790180150	65790200150	65790220150	65790240150	65790270150
160		65790160160	65790180160	65790200160	65790220160	65790240160	65790270160
170		65790160170	65790180170	65790200170	65790220170	65790240170	65790270170
180		65790160180	65790180180	65790200180	65790220180	65790240180	65790270180
190		65790160190	65790180190	65790200190	65790220190	65790240190	65790270190
200		65790160200	65790180200	65790200200	65790220200	65790240200	65790270200
210				65790200210	65790220210	65790240210	
220				65790200220	65790220220	65790240220	
230				65790200230			
240				65790200240			
250				65790200250			
260				65790200260			
270							
280							
290							

Knevelschroeven M14, M18 en M22 zijn niet meer in de actuele norm omschreven.

1: L ≤ 125 mm.

2: 125 mm < L ≤ 200 mm.

3: L > 200 mm.



DIN 444B KNEVELSCHROEVEN – ROESTVASTSTAAL A4

DIN 444B EYE BOLTS – STAINLESS STEEL A4

DIN 444B CORPS DE BOULON A OEIL – ACIER INOXYDABLE A4

DIN 444B AUGENSCHRAUBEN – ROSTFREISTAHL A4

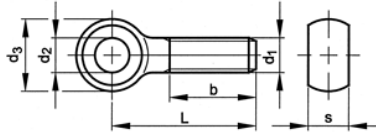

ISO :-
DIN : 444B
NEN : 2310 B
ANSI :-
BS :-
NF :-



M
RVS
A4

P		3,5	3,5	4	4,5		
	1	66					
b	2	72	78	84	96		
	3	85	91	97	109		
d2 (H9)		28	30	32	38		
d3 (max.)		55	60	65	78		
S (max.)		30	34	38	44		
d		M30	M33	M36	M42		
LENGTE							
100							
105							
110							
115							
120		65790300120	65790330120	65790360120	65790420120		
125		65790300125	65790330125	65790360125	65790420125		
130		65790300130	65790330130	65790360130	65790420130		
135		65790300135	65790330135	65790360135	65790420135		
140		65790300140	65790330140	65790360140	65790420140		
145		65790300145	65790330145	65790360145	65790420145		
150		65790300150	65790330150	65790360150	65790420150		
160		65790300160	65790330160	65790360160	65790420160		
170		65790300170	65790330170	65790360170	65790420170		
180		65790300180	65790330180	65790360180	65790420180		
190		65790300190	65790330190	65790360190	65790420190		
200		65790300200	65790330200	65790360200	65790420200		
210				65790360210	65790420210		
220				65790360220	65790420220		
230				65790360230	65790420230		
240				65790360240	65790420240		
250				65790360250	65790420250		
260				65790360260	65790420260		
270							
280							
290							

Knevelschroeven M14, M18 en M22 zijn niet meer in de actuele norm omschreven.

1: L ≤ 125 mm.

2: 125 mm < L ≤ 200 mm.

3: L > 200 mm.

