



# HOSES AND FITTINGS

FOR COMPRESSED AIR | MADE IN DENMARK



## PROFESSIONAL TOOLS, BLOW GUNS AND ACCESSORIES FOR COMPRESSED AIR

In this catalogue you will find the assortment of hoses and fittings for compressed air. JW L also produces Air Boy® blow guns, quick connect couplings and accessories for blow guns.

Contact us to get the catalogues or download from [www.jwl.dk](http://www.jwl.dk).



# Hoses and fittings for compressed air



## PNEUMATIC RECOIL HOSES PA12

Robust and withstands sunlight. With fittings, plastic or metal reliefs and swivel.

4



## RECOIL HOSES PUR - FLEX BOY

Flexible and oil-resistant hose. With fittings, reliefs or as ready-to-use set with blow gun.

5



## RECOIL HOSES PUR - FLEX BOY

Flexible and oil-resistant hose. With quick connect coupling and euro nipple or with blow gun.

7



## RECOIL HOSES PUR BLACK

Super flexible and oil-resistant recoil hoses with fittings.

8



## FRL UNITS

Protect tools and equipment from moisture and impurities.

8



## SOFT PVC HOSES

Heavy-duty, reinforced and pressure-resistant. As loose hoses or with couplings and euro nipple.

9



## FITTINGS

Fittings for compressed air systems.

10

## GET TOOLS, BLOW GUNS, HOSES AND COUPLINGS AS PRIVATE LABEL

If you like to have your own private label products for compressed air, then you can get all the JWL products as private label. You can adjust colour, engraving, shape, etc. to make it your own look.

Contact us to get more information. Call +45 75 89 16 99 or send an e-mail to [salg@jwl.dk](mailto:salg@jwl.dk).

Visit [www.jwl.dk](http://www.jwl.dk).

# Pneumatic recoil hoses PA12

Nylon recoil hoses is particular suitable for environments that require robust pneumatic hoses. The hoses are resistant to pressure and high/low temperatures. They have an excellent ability to retain their coiled form. Withstands continuous sunlight.

## Technical description

Material	Polyamide 12 (PA12)
Working pressure	Max. 25 bar at 23 °C
Temp. range	-40 °C to +100 °C
Surface hardness	Shore D63



1700208-05  
Recoil hose PA12 with metal relief spring, swivel joint and fittings.



1700512-05  
Recoil hose PA12 with fittings and plastic relief spring.

## Recoil hose PA12 with metal relief spring, swivel joint & fittings

Connection	Dimension	Work length	Max. work pressure	Art. No.
1/4" BSPT external thread	ø6 x ø8 mm	2.5 m	25 bar	1700208-02
1/4" BSPT external thread	ø6 x ø8 mm	3.5 m	25 bar	1700208-03
1/4" BSPT external thread	ø6 x ø8 mm	5 m	25 bar	1700208-05
1/4" BSPT external thread	ø6 x ø8 mm	7.5 m	25 bar	1700208-07
1/4" BSPT external thread	ø6 x ø8 mm	10 m	25 bar	1700208-10 *
1/4" BSPT external thread	ø6 x ø8 mm	15 m	25 bar	1700208-15 *
1/4" BSPT external thread	ø7,5 x ø10 mm	3 m	25 bar	1700410-03
1/4" BSPT external thread	ø7,5 x ø10 mm	7.5 m	25 bar	1700410-07

## Recoil hose PA 12 with fittings & plastic relief spring

Connection	Dimension	Work length	Max. work pressure	Art. No.
3/8" BSPT external thread	ø9 x 12 mm	5 m	25 bar	1700512-05 *
3/8" BSPT external thread	ø9 x 12 mm	7.5 m	25 bar	1700512-07 *
3/8" BSPT external thread	ø9 x 12 mm	10 m	25 bar	1700512-10 *

\* Special order item. Expected delivery time minimum 7 weeks. MOQ 25 units.

# Recoil hoses PUR - Flex Boy

Very flexible recoil hoses that are capable of bending without being damaged. Maintains persistent flexibility at temperatures as low as -40 °C. An oil-resistant hose whose superior qualities are acknowledged in all sectors of industry. We recommend that polyurethane hoses do not be used in direct sunlight for long periods of time.

## Technical description

Material	Polyurethane
Working pressure	Max. 10 bar at +20 °C
Temp. range	-40 °C to +60 °C
Surface hardness	Shore D52



1710410-04  
Recoil hose PUR with fittings.



1710512-04  
Recoil hose PUR with fittings and plastic relief spring.

## Recoil hose PUR - Flex Boy with fittings

Connection	Dimension	Work length	Max. work pressure	Art. No.
1/4" BSPT external thread	ø4 x ø6 mm	1 m	10 bar	1710206-01*
1/4" BSPT external thread	ø4 x ø6 mm	2 m	10 bar	1710206-02*
1/4" BSPT external thread	ø4 x ø6 mm	4 m	10 bar	1710206-04*
1/4" BSPT external thread	ø5 x ø8 mm	2 m	10 bar	1710208-02
1/4" BSPT external thread	ø5 x ø8 mm	4 m	10 bar	1710208-04
1/4" BSPT external thread	ø5 x ø8 mm	6 m	10 bar	1710208-06
1/4" BSPT external thread	ø5 x ø8 mm	8 m	10 bar	1710208-08
3/8" BSPT external thread	ø6.5 x ø10 mm	2 m	10 bar	1710410-02*
3/8" BSPT external thread	ø6.5 x ø10 mm	4 m	10 bar	1710410-04*
3/8" BSPT external thread	ø6.5 x ø10 mm	6 m	10 bar	1710410-06*
3/8" BSPT external thread	ø6.5 x ø10 mm	8 m	10 bar	1710410-08*

## Recoil hose PUR - Flex BOY with fittings & plastic relief spring

Connection	Dimension	Work length	Max. work pressure	Art. No.
3/8" BSPT external thread	ø8 x 12 mm	4 m	10 bar	1710512-04
3/8" BSPT external thread	ø8 x 12 mm	6 m	10 bar	1710512-06 *
3/8" BSPT external thread	ø8 x 12 mm	8 m	10 bar	1710512-08 *

## Ready to use Flex Boy recoil hose with Air Boy® Classic blow gun

Connection	Dimension	Work length	Max. work pressure	Art. No.
1/4" BSPT external thread	ø5 x ø8 mm and Air Boy® Classic	2 m	10 bar	242802-000
1/4" BSPT external thread	ø5 x ø8 mm and Air Boy® Classic	4 m	10 bar	242804-000 *
1/4" BSPT external thread	ø5 x ø8 mm and Air Boy® Classic	6 m	10 bar	242806-000 *

\* Special order item. Expected delivery time minimum 7 weeks. MOQ 25 units.

Ready to use recoil hose with series 530 quick connect coupling and Air Boy® Classic blow gun with 8 mm bent pipe.

Art. No. 240806-000530



# Recoil hoses PUR - Flex Boy

Very flexible recoil hoses that are capable of bending without being damaged. Maintains persistent flexibility at temperatures as low as -40 °C. An oil-resistant hose with superior qualities that are acknowledged in all sectors of industry.

We recommend not to use polyurethane hoses in direct sunlight for long periods of time.

## Technical description

Material	Polyurethane
Working pressure	Max. 10 bar at +20 °C
Temp. range	-40 °C to +60 °C
Surface hardness	Shore D52



1810410-04530  
Recoil hose PUR with series 530 quick connect coupling and euro nipple.



240806-000530  
Ready-to-use Flex Boy recoil hose with heavy duty series 530 quick connect coupling, euro nipple and Air Boy® Classic blow gun.

## Recoil hoses PUR -Flex Boy with Series 530 quick connect coupling & euro nipple

Connection	Dimension	Work length	Max. work pressure	Art. no.
Series 530 quick connect coupling and euro nipple	ø5 x ø8 mm	1 m	10 bar	1810208-01530*
Series 530 quick connect coupling and euro nipple	ø5 x ø8 mm	2 m	10 bar	1810208-02530
Series 530 quick connect coupling and euro nipple	ø5 x ø8 mm	4 m	10 bar	1810208-04530*
Series 530 quick connect coupling and euro nipple	ø5 x ø8 mm	6 m	10 bar	1810208-06530
Series 530 quick connect coupling and euro nipple	ø5 x ø8 mm	8 m	10 bar	1810208-08530*
Series 530 quick connect coupling and euro nipple	ø6.5 x ø10 mm	2 m	10 bar	1810410-02530
Series 530 quick connect coupling and euro nipple	ø6.5 x ø10 mm	4 m	10 bar	1810410-04530
Series 530 quick connect coupling and euro nipple	ø6.5 x ø10 mm	6 m	10 bar	1810410-06530
Series 530 quick connect coupling and euro nipple	ø6.5 x ø10 mm	8 m	10 bar	1810410-08530
Series 530 quick connect coupling and euro nipple	ø8 x ø12 mm	2 m	10 bar	1810512-02530
Series 530 quick connect coupling and euro nipple	ø8 x ø12 mm	4 m	10 bar	1810512-04530
Series 530 quick connect coupling and euro nipple	ø8 x ø12 mm	6 m	10 bar	1810512-06530
Series 530 quick connect coupling and euro nipple	ø8 x ø12 mm	8 m	10 bar	1810512-08530*

## Flex Boy recoil hose with Air Boy® Classic blow gun, 530 quick connect coupling & euro nipple

Connection	Dimension	Work length	Max. work pressure	Art. no.
Series 530 quick connect coupling, euro nipple & Air Boy	ø5 x ø8 mm	4 m	10 bar	240802-000530
Series 530 quick connect coupling, euro nipple & Air Boy	ø5 x ø8 mm	4 m	10 bar	240804-000530
Series 530 quick connect coupling, euro nipple & Air Boy	ø5 x ø8 mm	6 m	10 bar	240806-000530

\* Special order item. Expected delivery time minimum 7 weeks. MOQ 25 units.

# Recoil hoses PUR black

Very flexible recoil hoses that are capable of bending without being damaged. Maintains persistent flexibility at temperatures as low as -40 °C. An oil-resistant hose with superior qualities that are acknowledged in all industry sectors. We recommend not to use polyurethane hoses in direct sunlight for long periods of time.



1750410-04  
Black recoil hose PUR with fittings.

## Technical description

Material	Polyamide 12 (PA12)
Working pressure	Max. 10 bar at 20 °C
Temp. range	-40 °C to +80 °C

## Black recoil hoses PUR with fittings

Connection	Dimension	Work length	Max. work pressure	Art. No.
1/4" BSPT external thread	ø5 x ø8 mm	2 m	10 bar	1750208-02*
1/4" BSPT external thread	ø5 x ø8 mm	4 m	10 bar	1750208-04
1/4" BSPT external thread	ø5 x ø8 mm	6 m	10 bar	1750208-06
1/4" BSPT external thread	ø5 x ø8 mm	8 m	10 bar	1750208-08
3/8" BSPT external thread	ø6.5 x ø10 mm	2 m	10 bar	1750410-02*
3/8" BSPT external thread	ø6.5 x ø10 mm	4 m	10 bar	1750410-04*
3/8" BSPT external thread	ø6.5 x ø10 mm	6 m	10 bar	1750410-06
3/8" BSPT external thread	ø6.5 x ø10 mm	8 m	10 bar	1750410-08*
1/2" BSPT external thread	ø8 x ø12 mm	4 m	10 bar	1750512-04*
1/2" BSPT external thread	ø8 x ø12 mm	6 m	10 bar	1750512-06*

\* Special order item. Expected delivery time minimum 7 weeks. MOQ 25 units.

# FRL Units

To protect tools and equipment from moisture and impurities a FRL unit should be placed before them. FRL units are compact devices that filter, pressure regulate and separate fluid and particles from the compressed air (FRL = Filter-Regulator-Lubricator). The FRL units are available either as regulator with a water separator (334381) or a regulator with water separator and lubricator (334386). Both models come with mounting brackets.



334381  
Regulator with water separator.



334386  
Regulator with water separator and lubricator.

## Specifications and materials

Working pressure	<10 bar (145 psi)
Guaranteed maximum pressure	15 bar (218 psi)
Temperature range	+5 °C to +60 °C
Filter Size	25 µm
Recommended oil (lubricator)	Turbine No1 Oil ISOVG32
Pressure regulation range	0.5 to 8.5 bar

Valve Type	Overflow
Air consumption at p1=7 Bar & p2=5 Bar	500 l/min.
Connections	1/4"BSPT thread
Pressure gauge	G36-10-01
Weight (334381/334386)	353 g / 581 g
Container made of	Polycarbonat

## Flow

Bar / l/min.

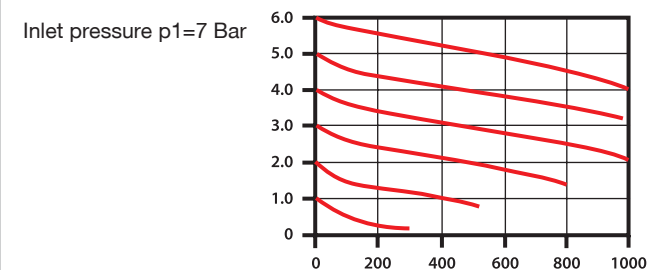

## Flow

Bar / bar

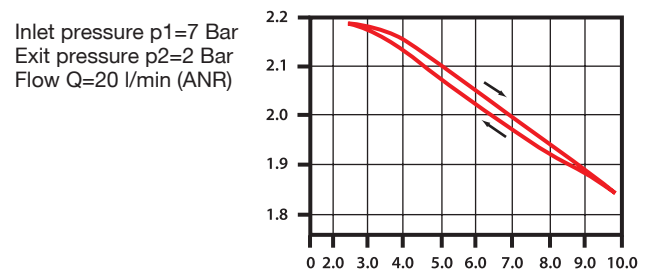



# Soft PVC pneumatic hoses

Super flexible pneumatic hoses, ideal for most pneumatic installations.

A robust, heavy-duty, reinforced, pressure-resistant hose. Please note that lengths of the PVC hoses can vary +/- 5%.



1710512-04

Recoil hose PUR with fittings and plastic relief spring.

## Technical description

Material	3 layers PVC
Working pressure	Max. 15 bar at +20 °C
Temp. range	-20 °C to +60 °C
Reinforcement	Polyester fiber

## Reinforced soft PVC hose with series 520 quick connect coupling & euro nipple

Connection	Dimension	Work length	Max. work pressure	Art. No.
Series 520 quick connect coupling & euro nipple	ø6.3 x 11 mm	5 m	15 bar	1761002-05520
Series 520 quick connect coupling & euro nipple	ø6.3 x 11 mm	10 m	15 bar	1761002-10520
Series 520 quick connect coupling & euro nipple	ø6.3 x 11 mm	15 m	15 bar	1761002-15520
Series 520 quick connect coupling & euro nipple	ø6.3 x 11 mm	20 m	15 bar	1761002-20520
Series 520 quick connect coupling & euro nipple	ø9 x 14.5 mm	5 m	15 bar	1761004-05520
Series 520 quick connect coupling & euro nipple	ø9 x 14.5 mm	10 m	15 bar	1761004-10520
Series 520 quick connect coupling & euro nipple	ø9 x 14.5 mm	15 m	15 bar	1761004-15520
Series 520 quick connect coupling & euro nipple	ø9 x 14.5 mm	20 m	15 bar	1761004-20520

## Reinforced soft PVC hose with series 530 quick connect coupling & euro nipple

Connection	Dimension	Work length	Max. work pressure	Art. No.
Series 530 quick connect coupling & euro nipple	ø6.3 x 11 mm	5 m	15 bar	1761002-05530
Series 530 quick connect coupling & euro nipple	ø6.3 x 11 mm	10 m	15 bar	1761002-10530
Series 530 quick connect coupling & euro nipple	ø6.3 x 11 mm	15 m	15 bar	1761002-15530
Series 530 quick connect coupling & euro nipple	ø6.3 x 11 mm	20 m	15 bar	1761002-20530
Series 530 quick connect coupling & euro nipple	ø9 x 14.5 mm	5 m	15 bar	1761004-05530
Series 530 quick connect coupling & euro nipple	ø9 x 14.5 mm	10 m	15 bar	1761004-10530
Series 530 quick connect coupling & euro nipple	ø9 x 14.5 mm	15 m	15 bar	1761004-15520
Series 530 quick connect coupling & euro nipple	ø9 x 14.5 mm	20 m	15 bar	1761004-20530

## Reinforced soft PVC Hoses

Connection	Dimension	Work length	Max. work pressure	Art. No.
No connection - only hose	ø6.3 x 11 mm	50 m	15 bar	1761002-50
No connection - only hose	ø9 x 14.5 mm	50 m	15 bar	1761004-50
No connection - only hose	ø12.7 x 19 mm	50 m	15 bar	1761006-50

## Hose clamps

Dimension	Art. No.
Hose clamp (7-9 mm)	1490709
Hose clamp (9-11 mm)	1490911
Hose clamp (11-13 mm)	1491113
Hose clamp (13-15 mm)	1491315
Hose clamp (15-18 mm)	1491518
Hose clamp (17-20 mm)	1491720

# Fittings

JWL Fittings comprise a wide range of connectors and accessories for your compressed-air installations.

## Free angle fittings



Dimension	Art. No.
Coupler plug (Euro) x 1/4" internal thread	443302
Coupler plug (Euro) x 1/4" external thread	443312
1/4" internal x 1/4" internal thread	440202
1/4" external x 1/4" internal thread	441202
3/8" external x 3/8" internal thread	441404
1/4" hose connection x 1/4" external thread	442202
3/8" hose connection x 1/4" external thread	442412
3/8" hose connection x 3/8" external thread	442414
PUR connection $\varnothing 5/\varnothing 8$ mm x 1/4" external thread	440812
PUR connection $\varnothing 6,5/\varnothing 10$ mm x 1/4" ext. thread	441012



## Hose connectors

Dimension	Art. No.
3/16" - 5 mm x 1/4" external thread	625002
1/4" - 6 mm x 1/8" external thread	625020
1/4" - 6 mm x 1/4" external thread	625022
1/4" - 6 mm x 3/8" external thread	625024
1/4" - 6 mm x 1/2" external thread	625025
5/16" - 8 mm x 1/4" external thread	625032
5/16" - 8 mm x 3/8" external thread	625034
5/16" - 8 mm x 1/2" external thread	625035
3/8" - 10 mm x 1/4" external thread	625042
3/8" - 10 mm x 3/8" external thread	625044
3/8" - 10 mm x 1/2" external thread	625045
1/2" - 13 mm x 1/4" external thread	625052
1/2" - 13 mm x 3/8" external thread	625054
1/2" - 13 mm x 1/2" external thread	625055
1/2" - 13 mm x 3/4" external thread	625057
3/4" - 20 mm x 3/8" external thread	625074
3/4" - 20 mm x 3/4" external thread	625077
1/4" - 6 mm x 1/8" internal thread	626020
1/4" - 6 mm x 1/4" internal thread	626022
1/4" - 6 mm x 3/8" internal thread	626024
5/16" - 8 mm x 1/4" internal thread	626032
3/8" - 10 mm x 1/4" internal thread	626042
3/8" - 10 mm x 3/8" internal thread	626044
3/8" - 10 mm x 1/2" internal thread	626045
1/2" - 13 mm x 1/4" internal thread	626052
1/2" - 13 mm x 3/8" internal thread	626054
1/2" - 13 mm x 1/2" internal thread	626055

## Hose connectors



Dimension	Art. No.
1/4" (6 mm) x 1/4" (6 mm)	621022
5/16"(8 mm) x 5/16" (8 mm)	621033
3/8"(10 mm) x 3/8" (10 mm)	621044
1/2" (12 mm) x 1/2" (12 mm)	621055

## X-pieces



Dimension	Art. No.
4 x 1/8" internal thread	628000
4 x 1/4" internal thread	628022
4 x 3/8" internal thread	628044
4 x 1/2" internal thread	628055

## Y-pieces



Dimension	Art. No.
1/8" x 1/8" x 1/8" internal thread	627000
1/4" x 1/4" x 1/4" internal thread	627022
3/8" x 3/8" x 3/8" internal thread	627044
1/2" x 1/2" x 1/2" internal thread	627055
1/8" external x 1/8" internal x 1/8" internal thread	627200
1/4" external x 1/4" internal x 1/4" internal thread	627222
3/8" external x 3/8" internal x 3/8" internal thread	627244
1/2" external x 1/2" internal x 1/2" internal thread	627255

## T-pieces



Dimension	Art. No.
1/8" x 1/8" x 1/8" internal thread	630000
1/4" x 1/4" x 1/4" internal thread	630022
3/8" x 3/8" x 3/8" internal thread	630044
1/2" x 1/2" x 1/2" internal thread	630055
1/8" external x 1/8" internal x 1/8" internal thread	630200
1/4" external x 1/4" internal x 1/4" internal thread	630222
3/8" external x 3/8" internal x 3/8" internal thread	630244
1/2" external x 1/2" internal x 1/2" internal thread	630255



## L-pieces

Dimension	Art. No.
1/8" internal x 1/8" internal thread	623000
1/4" internal x 1/4" internal thread	623022
3/8" internal x 3/8" internal thread	623044
1/2" internal x 1/2" internal thread	623055
3/4" internal x 3/4" internal thread	623077
1/8" external x 1/8" external thread	623100
1/4" external x 1/4" external thread	623122
3/8" external x 3/8" external thread	623144
1/2" external x 1/2" external thread	623155
1/8" external x 1/8" internal thread	623200
1/4" external x 1/4" internal thread	623222
3/8" external x 3/8" internal thread	623244
1/2" external x 1/2" internal thread	623255
3/4" external x 3/4" internal thread	623277



## Ball cocks

Dimension	Art. No.
1/4" internal thread x 1/4" internal thread	631022
3/8" internal thread x 3/8" internal thread	631044
1/2" internal thread x 1/2" internal thread	631055
1/4" external thread x 1/4" internal thread	631222
3/8" external thread x 3/8" internal thread	631244
1/2" external thread x 1/2" internal thread	631255



## Adaptors

Dimension	Art. No.
1/8" external x 1/8" external thread	624000
1/8" external x 1/4" external thread	624002
1/8" external x 3/8" external thread	624004
1/4" external x 1/4" external thread	624022
1/4" external x 3/8" external thread	624024
1/4" external x 1/2" external thread	624025
3/8" external x 3/8" external thread	624044
3/8" external x 1/2" external thread	624045
1/2" external x 1/2" external thread	624055
1/2" external x 3/4" external thread	624057
3/4" external x 3/4" external thread	624077



## Sockets

Dimension	Art. No.
1/8" internal thread x 1/8" internal thread	629000
1/8" internal thread x 1/4" internal thread	629002
1/8" internal thread x 3/8" internal thread	629004
1/4" internal thread x 1/4" internal thread	629022
1/4" internal thread x 3/8" internal thread	629024
1/4" internal thread x 1/2" internal thread	629025
3/8" internal thread x 3/8" internal thread	629044
3/8" internal thread x 1/2" internal thread	629045
1/2" internal thread x 1/2" internal thread	629055
3/4" internal thread x 1/2" internal thread	629075
3/4" internal thread x 3/4" internal thread	629077

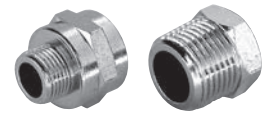

## Reduction nipples

Dimension	Art. No.
1/8" external x 1/8" internal thread	622000
1/8" external x 1/4" internal thread	622002
1/8" external x 3/8" internal thread	622004
1/8" external x 1/2" internal thread	622005
1/4" external x 1/8" internal thread	622020
1/4" external x 1/4" internal thread	622022
1/4" external x 3/8" internal thread	622024
1/4" external x 1/2" internal thread	622025
3/8" external x 1/8" internal thread	622040
3/8" external x 1/4" internal thread	622042
3/8" external x 3/8" internal thread	622044
3/8" external x 1/2" internal thread	622045
1/2" external x 1/8" internal thread	622050
1/2" external x 1/4" internal thread	622052
1/2" external x 3/8" internal thread	622054
1/2" external x 1/2" internal thread	622055
1/2" external x 3/4" internal thread	622057
3/4" external x 3/8" internal thread	622074
3/4" external x 1/2" internal thread	622075

JWL A/S  
Tekniker vej 4  
DK-8722 Hedensted  
Phone: +45 75 89 16 99  
salg@jwl.dk  
www.jwl.dk



The three triangles in the JWL logo symbolizes extremely high quality and precision within technical engineering. They commit and we have been committed to them since 1963, when Johannes Wagner Lund started JWL A/S.

We will continue to live up to the very high standards that we are respected for and proud of. The resourcefulness and creativity that prevail at JWL will secure user-friendly and innovative compressed air solutions that will last - for the next 50 years as well.

MADE IN DENMARK