

IWCS - Updating iriSelect BB

Follow the steps below carefully to ensure correct installation of the iriSelect Black Box firmware

- **IMPORTANT:**

Before doing anything you first need to determine, what version of the iriSelect Black Box you are working with. This is a very crucial step. If not paid attention to, your unit will not function correctly and there is no redo.

Fortunately this is very easy. Simply power on your iriSelect Black Box and look at the "STATUS LED".

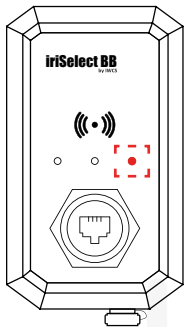

If the **STATUS LED** flashes **RED** you have a version 1 and should download the firmware 1.x.x

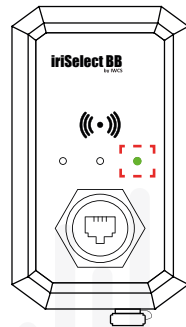

If the **STATUS LED** flashes **GREEN** you have a version 2 and should download the firmware 2.x.x

- **Download:**

Download the firmware compatible with your iriSelect Black Box and unzip the folder.

- **Connection:**

Connect the iriSelect Black Box to your PC, either via LAN cable to your router or wireless via its built-in WiFi "iriSelect Temp".

To turn on the WiFi, place and hold a magnet to the front of the iriSelect Black Box. The "STATUS LED" will start flashing rapidly. Remove the magnet once the LED is steady **RED** or **GREEN** - Depending on the version

Connect to the "iriSelect Temp" WiFi. (There is no password)

Once connected, open a browser and type "iriSelect.local/update" in the search bar.

- **Installation:**

Click "Choose image" and select one of the two files you just unzipped. (it does not matter whether you start with the .BIN or the .IMG file)

Then click "update". It will say "success" when done.

You might lose connection when a file has successfully updated. Simply reconnect and continue to the next step.

Now click on "choose image" again and select the other file and click "update" and wait for "success".

Now your iriSelect Black Box is updated.