

# User manual

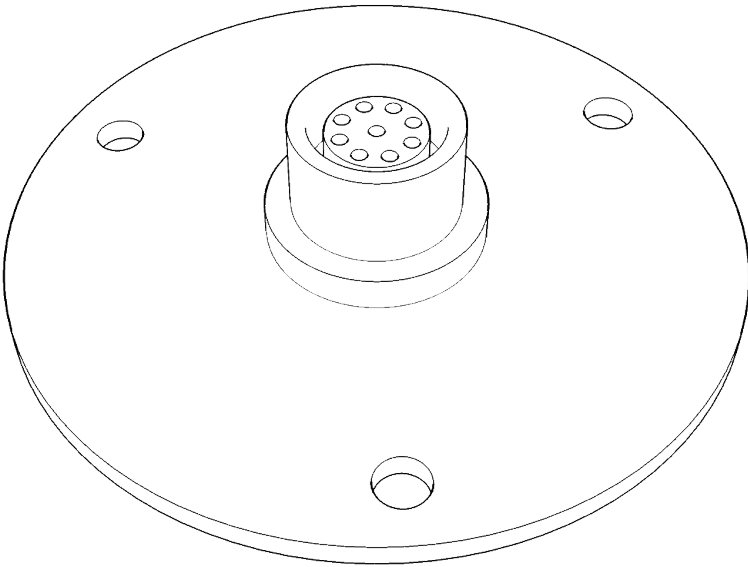

# Headset Connection Panel

CONGRATULATIONS ON YOUR NEW PRODUCT FROM  
IRIDIUM WATERPROOF COMMUNICATION SYSTEMS

### Headset Connection Panel

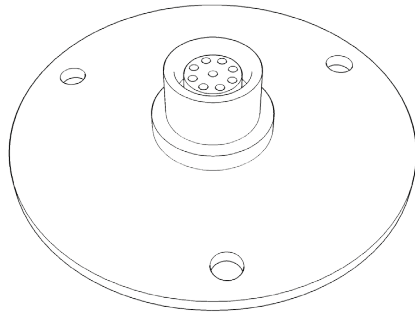

IWCS HOPE YOU WILL ENJOY THE BENEFITS OF TROUBLE  
FREE HIGH QUALITY INTERCOM. PLEASE READ THESE  
INSTRUCTIONS CAREFULLY BEFORE FIRST USE.  
IF INSTALLED, OPERATED AND MAINTAINED  
ACCORDING TO THIS MANUAL.

The Headset Connection Panel WILL BE A RELIABLE PARTNER  
FOR MANY YEARS TO COME.

THOMAS B SVENNINGSSEN  
CO-FOUNDER OF IWCS

## 1. Introduction

1.1 Disclaimer	Page:	4
1.2 Copyright	Page:	4
1.3 Trademark	Page:	4
1.4 Safety Warning	Page:	5

## 2. Installation

2.1 Unboxing	Page:	6
2.2 Tools	Page:	6
2.3 Installation	Page:	6
2.4 Drill Template 1:1	Page:	7
2.5 Mounting and Connecting	Page:	9

## 3. Operation

3.1 Instruction for use	Page:	10
-------------------------	-------	----

## 4. Service And Maintenance

4.1 Specifications	Page:	11
4.2 Cleaning	Page:	11
4.3 Warranty	Page:	11
4.4 Service and upgrades	Page:	11
4.5 Maintenance	Page:	11

## 1.1 Disclaimer

Any responsibility or liability for loss or damage in connection with the use of this product and the accompanying documentation is disclaimed by IWCS.

The information in this manual is provided for information purposes only, is subject to change without notice and may contain errors or inaccuracies.  
Manuals issued by IWCS are periodically revised and updated.

Anyone relying on this information should acquire the most current version e.g. upon request at [info@iwcs.eu](mailto:info@iwcs.eu)

IWCS is not responsible for the content or accuracy of any translations or reproductions, in the whole or in part, of this manual from any other source.

## 1.2 Copyright

2024 Iridium Waterproof Communication Systems ApS. All right reserved.  
Printed in Denmark.

## 1.3 Trademark

Headset Connection Panel is a Trademark by Iridium Waterproof Communication Systems ApS.

## 1.4 Safety warning

The following general safety precautions must be observed during all phases of operation, service and repair of this equipment. Failure to comply with these precautions or with specific warnings elsewhere in this manual violates safety standards of design, manufacture and intended use of the equipment. IWCS assumes no liability for the customer's failure to comply with these requirements.

- **EMC / RF EXPOSURE**

Headset Connection Panel is CE and UKCA certified as stated in the Declaration of Conformity.



- **FIRE**

In case of fire, harmful gases and fumes may occur. One should immediately leave the area and seek help. In case of suspected smoke in the lungs, a doctor should be consulted



- **POWER LOSS**

Power interruptions limited to Headset Connection Panel will not affect other users communication. A general power outage will turn off the entire intercom system. IWCS is not responsible for any power outages or consequences thereof, of any kind.



- **WARRANTY LIMITATIONS**

IMPORTANT - This unit is a sealed waterproof unit (classified IP67). To create and maintain its waterproof integrity it has been assembled in a controlled environment using special equipment. This unit is NOT a user serviceable unit, and under no circumstances should the unit be opened except by authorized personnel. Unauthorized opening of the unit will invalidate the warranty.



- **DISPOSAL**

When disposing of Headset Connection Panel and related equipment, it must happen in accordance with applicable national law.



Revision	Release date	Release note
1.1	19-03-2024	General Revisit

## 2.1 Unboxing

### 1 x Headset Connection Panel

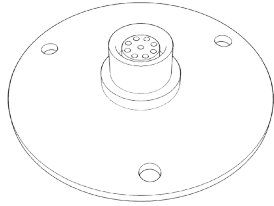

### 1 x User Manual

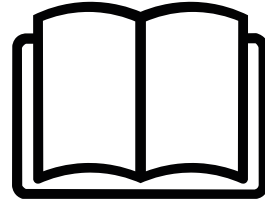

## 2.2 Tools

Before installation please prepare the following tools:

- Tape
- 3,5 or 3 mm drill bits
- 20 mm hole saw drill bit
- Drill
- Screw heads may not exceed 7 mm
- Silicone based sealant

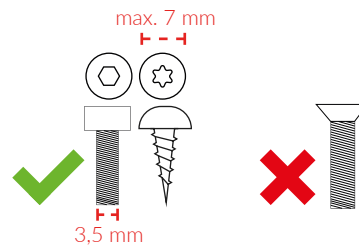

## 2.3 Installation

When mounting the Headset Connection Panel, it is essential to consider the material and the appropriate drill bit size. Please note the following guidelines:

If you are using wood screws you will need:

- 3x 3,5 mm screws.
- Drill 3 mm holes.

If you are using machine screws you will need:

- 3x 3,5 mm screws.
- 3x locking bolts.
- 3x washers.
- Drill 4 mm holes.

In both cases you will need a 25 mm. hole saw drill bit to drill out the center hole behind the Headset Connection Panel to run the cable through.

*\*Note that no mounting equipment is included in the box.*



## 2.4 Drill Template 1:1

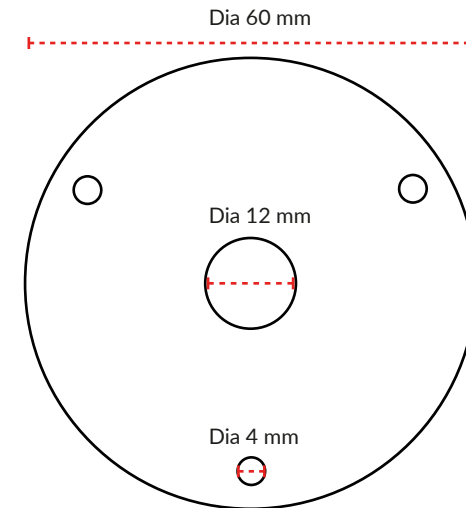

Backside of drill template



### 2.5 Mounting and connecting

Apply silicone based sealant in the 3 mounting holes and around to the center hole. Lead the radio interface connector through the hole from the outside and in. Be careful and avoid sealant touching the parts. Place the connector plate exactly aligned with the 3 mounting holes, and fasten them with screws, either self-tapping or machine screws, depending on surface.

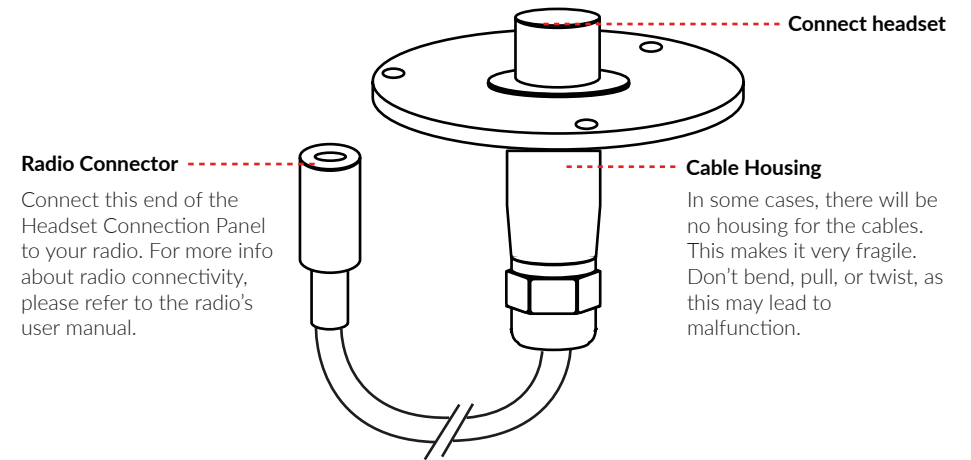

### Apply Sealant

Apply silicone based sealant in the 3 mounting holes and around to the center hole.

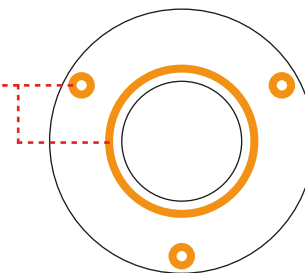

## 3.1 Intructions for use

The Headset Connection Panel Connector should always be left with its protection cap on, covering the connector, when not in use.

Remove the protection cap and align the red dots on both the connector on the Headset Connection Panel and the Headset Connector.

Gently press the Headset connector into the Headset Connection Panel Connector, until the Push-Pull clicks.

The headset is now ready to use.

Do not break or twist the connectors while in use.

Do not use unintended force to connect or disconnect the connectors.

## 4.1 Specifications

Headset Connection Panel	
Weight	100 g*
Size	Ø 60 mm
Waterproof	IP67
Temperature range	-30 to +60 °C
Part number	IR-40-4011-0X-_____

## 4.2 Cleaning

Do not use chemicals or solvents to clean your Headset Connection Panel. Use only fresh water. Pressure, friction, sharp objects, etc. can damage the product and the warranty may be void.

## 4.3 Warranty

Headset Connection Panel is covered by a two (2) year warranty.

## 4.4 Service / Upgrades

Any Service or additional Upgrades must be handled by IWCS Do not try to open or modify the IWCS product

## 4.5 Maintenance

If your IWCS Headset Connection Panel has been exposed to saltwater, chemicals or any other solvents/liquids, immediately rinse with freshwater and wipe with a dry cloth.

**WARNING - The Headset connector is only IP67 Waterproof when mated, and may NOT be exposed to any solvents/liquids when unmated. Always use the silicone lid, when not in use.**

The Headset Connector must be inspected after each use, and apply a modest amount of Molykote 44 Medium as required.

No further maintenance is required.



Hejrevang 13  
3450 Allerød  
Denmark

+45 43 43 26 26  
info@iwcs.eu  
www.iwcs.eu



Hejrevang 13  
3450 Allerød  
Denmark

+45 43 43 26 26  
info@iwcs.eu  
www.iwcs.eu

Headset Connection Panel  
is developed, designed and  
manufactured by

IWCS Aps

**Hejrevang 13  
3450 Allerød  
Denmark**

**+45 4343 2626**

**info@iwcs.eu  
www.iwcs.eu**

