



ICCH17

COPENHAGEN
12-15 AUGUST 2018

PROGRAM



A WELCOME BY THE PRESIDENT

Dear colleagues,

Welcome to the 17th International Congress of Circumpolar Health (ICCH17).

The conference takes place August 12-15, 2018, in Copenhagen, Denmark. Overall organizer is the International Union for Circumpolar Health (IUCH), and local organizer the Danish Greenlandic Society for Circumpolar Health.



The ICCH congresses are held every third year in different locations in the circumpolar area and represent the largest scientific meetings worldwide on circumpolar health. The focus of the conferences is any aspect related to health in Circumpolar areas.

The overall focus of this year's conference is 'Moving Circumpolar Health Forward'. Arctic areas and populations in Arctic areas are at present going through major changes related to environmental, social and living conditions that all affect health. In this conference, we wish to focus on what the future may bring to health of populations in circumpolar areas, and how health of populations in these parts of the world may be improved.

The conference consists of keynote lectures and presentation of accepted abstracts in oral sessions or poster presentations. A new initiative this year is a range of Meet-the-experts sessions, where you can meet and discuss with some of the experts well-known in Circumpolar Health.

In addition to the scientific content of the conference, each day ends with a social event that we hope as many participants as possible will attend. Finally, a national sports competition will be held, a Tug-of-War competition, that we hope as many as possible will take part in.

Also, a Summer School of Circumpolar Health and a PhD research course will take place immediately after the conference.

While the conference is held in Denmark, the focus remains on health in Circumpolar areas. Therefore, Greenland and other circumpolar areas will be central in all aspects of the conference.

Traditional events of each ICCH conference include the general IUCH assembly and presentations of the Hildes and the Jens Peder Hart Hansen medals for distinguished and young researchers, respectively. In addition, a number of side meetings take place at the conferences.

Copenhagen is beautiful in August, so besides an exciting scientific and social program, we hope that you will take your time to explore the capital of the happiest people in the world.

On behalf of the IUCH, The Danish Greenlandic Society for Circumpolar Health and the organizing committee, I wish you all a warm welcome to the 17th International Congress of Circumpolar Health, August 12-15, 2018, in Copenhagen, Denmark.

Anders Koch, MD, PhD, MPH

Professor, Ilisimatusarfik, University of Greenland
President, The 17th International Congress of Circumpolar Health
President, The International Union for Circumpolar Health
President, The Danish Greenlandic Society for Circumpolar Health

ICCH CONFERENCES

The ICCH congresses are held every third year in different locations in the circumpolar area and represent the largest scientific meetings worldwide on circumpolar health.

The ICCH congresses are organized by the International Union for Circumpolar Health (IUCH), aided by a local organizing committee.

The ICCH congresses serve as the primary source of information exchange and scholarly communication in issues relating to circumpolar health. More than 750 participants generally register and participate in each Congress, and more than 400 scientific papers or posters are usually presented.

The involvement of medical scientists, policy and decision makers, Native peoples, and others in the triennial congresses is growing steadily. To date, there has been fifteen international symposia/congresses:

- Fairbanks, Alaska 1967
- Oulu, Finland 1971
- Yellowknife, Canada 1974
- Novosibirsk, Siberia 1978
- Copenhagen, Denmark 1981
- Anchorage, Alaska 1984
- Umea, Sweden 1987
- Whitehorse, Canada 1990
- Reykjavik, Iceland 1993
- Anchorage, Alaska 1996
- Harstad, Norway 2000
- Nuuk, Greenland 2003
- Novosibirsk, Russia 2006
- Yellowknife, Canada 2009
- Fairbanks, Alaska 2012
- Oulu, Finland 2015
- Copenhagen, Denmark 2018

Proceedings have been published for all but one of the congresses. The Fourth Symposia published extended abstracts in English and Russian.

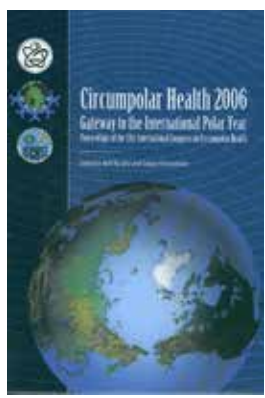
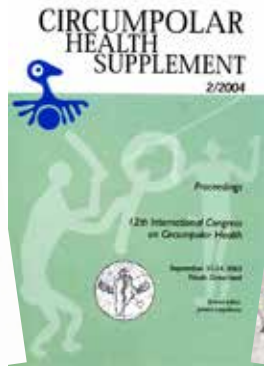

ORGANISERS

The ICCH congresses are organised by the International Union for Circumpolar Health (IUCH), www.iuch.net.

IUCH Board

- President: Anders Koch (Danish-Greenlandic Society for Circumpolar Health)
- Vice-President: Mikhail Voevoda (The Russian Academy of Polar Medicine)
- Secretary: Jon-Øyvind Odland (Nordic Society for Circumpolar Health)
- Treasurer: Brenna Simons (American Society for Circumpolar Health)
- Suzanne Møller (Danish-Greenlandic Society for Circumpolar Health)
- Arja Rautio (Nordic Society for Circumpolar Health)
- Jon Petter Storr (Nordic Society for Circumpolar Health – member at large)
- Gwen Healey (Canadian Society for Circumpolar Health)
- Michael Jong (Canadian Society for Circumpolar Health)
- Philippe Amtislavski (American Society for Circumpolar Health)
- Abbie Wolfe (American Society for Circumpolar Health – member at large)



INTERNATIONAL UNION FOR
CIRCUMPOLAR HEALTH

LOCAL ORGANISING COMMITTEE

Local organiser of the ICCH17 is the Danish Greenlandic Society for Circumpolar Health, www.gmsnet.dk



Danish Greenlandic Society for Circumpolar Health

- Anders Koch (President of the IUCH)
- Anne Christine Nordholm
- Anne-Sophie Homøe
- Anne Rolskov
- Bolette Søborg
- Christina Viskum Lytken Larsen
- Christine Ingemann
- Emilie Birch
- Gert Mulvad
- Jacqueline Møller Mistry
- Karen Bjørn-Mortensen
- Marit Eika Jørgensen
- Mila Broby Johansen
- Preben Homøe
- Regitze Seerup
- Sascha Wilk Michelsen
- Stig Andersen

KEYNOTE SPEAKERS

ANDERS KOCH

MD, PhD, MPH. Professor, Ilisimatusarfik, University of Greenland. President of the International Union for Circumpolar Health (IUCH), Denmark



GERT MULVAD

MD, GP, Doctor h.c., Greenland Center for Health Research, Ilisimatusarfik, University of Greenland, Greenland

DORIS J. JENSEN

Ministry of Health and Research, Government of Greenland, Greenland



ULLA WEVER

Dean and Professor, University of Copenhagen, Denmark

LEVINIA BROWN

Elder, Deputy Minister, Nunavut



KARSTEN FLEISCHER REX

MD, Staff specialist, Queen Ingrid's Hospital,
Nuuk, Greenland



RHONDA JOHNSON

Professor of Public Health at University of Alaska
Anchorage, USA

JON ØYVIND ODLAND

Professor of Global Health, The Norwegian
University for Science and Technology,
Trondheim, Norway



AVIAJA LYBERTH HAUPTMANN

PhD, Greenland Perspective, Ilisimatusarfik,
University of Greenland, Greenland

KRISTIE EBI

Director, the Center for Health and the Global
Environment (CHaNGE), and Rohm and Haas
Endowed Professor in Public Health Sciences,
University of Washington, Canada



TOM HENNESSY

MD, MPH, Director, Arctic Investigations Program, US Centers for Disease Control and Prevention (CDC), Anchorage, Alaska, USA



INGIBJÖRG THORISDÓTTIR

Public health specialist, PhD student, Reykjavik University, Iceland

ALLISON CRAWFORD

MD, PhD, FRCPC, Associate Professor of Psychiatry, University of Toronto, Canada



STEN LUND

Research Coordinator in the Ministry of Education, Culture, Research and Church, Greenland Self Rule, Greenland

ANASTASIA EMELYANOVA

Postdoctoral Researcher, UArctic Thematic Networks and Research Liaison Office, Thule Institute at the University of Oulu, Finland



MARIT EIKA JØRGENSEN

Professor, University of Southern Denmark, & Adjunct Professor, Ilisimatusarfik, University of Greenland, Denmark

AASE BENGAARD ANDERSEN

Professor, University of Southern Denmark, and Head, Department of Infectious Diseases, Copenhagen University Hospital Rigshospitalet, Copenhagen, Denmark



ESKE WILLERSLEV

Lundbeck Foundation, Professor at the University of Copenhagen and Director of the Centre for GeoGenetics, Copenhagen, Denmark

ANDERS ALBRECHTSEN

Associate professor, Department of Biology, University of Copenhagen, Denmark



LAURA ARBOUR

Professor, University of British Columbia, Canada



BO LIDEGAARD

Historian, writer and strategic advisor, Denmark



PRACTICAL INFORMATION

ATM

ATMs are found in many places, although the use of credit cards in almost all shops, restaurants, cafes, etc. in Denmark make ATMs less important.

Banks

Banks are normally open Monday to Friday from 09:30 – 16:00.

Breaks

Lunch and coffee will be served during breaks in the lobby outside the Niels K. Jerne auditory.

Chairmen

Chairmen are kindly asked to be present in the auditory/class room at least 10 minutes before the designated session. The chairmen's most important job is to make sure that the time is kept with a maximum of 15 minutes for oral presentations and 5 minutes for oral introductions of posters. Furthermore, chairmen will assist in loading presentations onto the computer.

Conference location

The conference takes place at the Panum Institute in the newly constructed Mærsk Tower, University of Copenhagen. The building consists of 15 floors. We will be located on the first floor. From the 15th floor you find a spectacular view of Copenhagen.

Circumpolar Nations' Sports Cup

As a new initiative during the ICCH17 conference, a Tug-of-War competition takes place between teams from the Circumpolar Nations (from west to east the USA, Canada, Greenland, Scandinavia, Denmark, Russian Federation and 'The rest of the world'). The event takes place in the open just outside the Maersk Tower on Wednesday 14:30 – 15:45. We encourage everyone to take part. If you do not compete yourself, please support your national team loudly. Teams are formed on the day. From each national team a fixed number of persons can compete in each round. We do encourage the teams to select different persons for each round, and also to make this gender-balanced. Please, wear your official ICCH17 t-shirt (given at registration) and a country sign given at the competition. There will be nice rewards for the winning team and refreshments for all.

Credit cards

It is possible to withdraw money with VISA, Master card, Eurocard, Maestro and JCB from ATMs. Likewise, almost all shops accept Visa or Master card. American Express cards may be of more limited use.

Currency

The national currency in Denmark is Kroner (DKr). Exchange rates are 100 DKr ~Euros 13.4 / US\$15.7 / English £ 11.9.

Customs and VAT

Danish prices include 25 % Value Added Tax (VAT). VAT is refundable to non-EU visitors in the airport after your visit. Tax free shopping is possible in many major shops and department stores in Copenhagen.

Electricity

Denmark, like most other European countries, has 220-volt AC, 50Hz and uses two-pin continental plugs.

Emergency phone number

In case of an emergency while you are in Copenhagen, always dial 112. This is a free call that connects you to the police, fire brigade or hospital. If you need a pharmacy or dentist, there are a few that are open 24/7. Please ask at your hotel or at the conference registration desk if you need help.

Getting around Copenhagen

It is easy to find your way around Copenhagen. Numerous buses, trains and a metro serve the Copenhagen area. Please, see the Public Transportation website (<https://dinoffentligetransport.dk>). In addition, the Journey planner (<https://www.rejseplanen.dk>) makes it easy to find the right connection.

The price depends on how many zones you travel. Within central Copenhagen it is usually 2 zones. An adult ticket for two zones is 24 DKK.

Denmark is a country of bicycles and The City Bike found in many locations (bycyklen.dk/en) is a popular and easy way to get around. An increasing number of hotels and bicycle rental shops also have bikes for rent or loan. There is a protected bicycle parking in the basement of the Panum Institute. Just remember when you bicycle in Copenhagen – the Copenhagen bikers are considerate, but drive fast!

Disabilities

The Maersk Tower has good accessibility with elevators and easy wheel chair access to auditories and class rooms. There are handicap toilets on the premises.

Insurance and liability

Neither the organisers nor the congress venue are responsible for any injury. Participants are advised to take out their own health and travel insurance.

Language

English is official language throughout the conference. There will be not simultaneous translation.

Lunch

Lunch and refreshments inclusive of coffee will be served each day in the lobby outside of the Niels K. Jerne Auditory.

Meet-the-experts

In circumpolar health literature, you often come across particular names and experts. A new initiative during the ICCH17 congress is an opportunity to meet and discuss with some of these experts.

Four 1-hour sessions will be arranged covering four topics: Infectious diseases; Mental health; Population studies; and Chronic diseases and genetic interactions. A number of experts within each have been invited. The list is not exclusive, there are definitely other experts in each field, but the experts invited are indeed well-known experts. Anyone is invited, and registration is not necessary.

During the sessions (Monday and Tuesday mornings 8-9), each expert will, in two minutes, give a short talk on

- What are the future challenges in the relevant field and
- What do I think are the future solutions to these challenges

After the panel talks, the word is essentially free for an open discussion between the participants and the experts. There is no agenda, so please feel free to discuss whatever you want! A light breakfast will be served. Please join these new and hopefully interesting and engaging events.

Name badges

Your name badge will be handed to you when you check in at the registration desk. The badge is your ticket to all scientific sessions, catering, and social events. Please wear your badge on all occasions.

Opening hours

Most common opening hours are: Monday - Thursday 10:00 - 18:00 Friday 10:00 - 19:00 Saturday 10:00 - 16:00 Sunday 12:00 - 16:00

Oral presentations

Oral presentations have 15 minutes at their disposal; 10 minutes for presentation and 5 minutes for discussion. Please upload your presentation in the break prior to the relevant session. USB sticks may be used. There are microphones in the roof of auditories, so auditory speakers do not need a microphone. However, as keynote talks will be audiotaped, keynote presenters will have a microphone attached.

Parking

Although there is a car parking lot in the basement of the Maersk Tower, this is only for employees. As it is difficult to find public parking around the Maersk Tower, we encourage attendees not to bring cars to the venue.

Payment

Payment of registration fees for the conference and social events takes, as a rule, place using the icch2018.com website. However, possible payment for late registration etc. can take place using a credit card or cash (DKr, Euros, US or Canadian \$) at the registration desk.

Pharmacy

There is no shortage of pharmacies in Copenhagen. Look for the green "a" sign that symbolizes the Danish word for pharmacy 'Apotek'. The Steno Apotek, Vesterbrogade 6C, 1620 Copenhagen V, tel.: +45 3314 8266 is open 24-/7. If you need a prescription, please ask the organisers.

Phone

We kindly request all participants to keep mobile phones in silent mode, in particular during the sessions.

Posters

Posters will be on display the whole conference in the hall between the Holst and the Jerne auditories. Maximal size of poster is 168 (height) and 110 (width) cm. Posters will be attached with pins (supplied). Poster presenters are invited to give a short (5 minutes and two slides maximum) oral presentation in an oral session. Slides for the poster presentation need to be uploaded on the computer in the break before the given session. Presentation times can be found in the program. In the afternoon coffee break (15:00 – 15:30) of the day of the oral poster presentation, the poster presenter is supposed to be present at the poster. There are, however, no formal poster walks.

Poster competition

A poster competition will take place. All posters will be evaluated by an expert committee by the following three criteria:

- Scientific quality
- Relevance of research question
- Presentation style and clarity

The poster presenter does not need to be present at the poster evaluation.

Preparation for oral presentations – slide centre – speakers

Presentations may be viewed in one room with a computer.

Proceedings

All abstracts will be published in a special volume of the International Journal of Circumpolar Health (IJCH). If an author does not wish to have his/hers abstract printed in such a volume, please contact the organisers.

Programme changes

The organisers cannot assume liability for any changes in the program due to unforeseen circumstances.

Registration/information desk

The registration desk is open 08:00 – 17:00 each day during the conference (Sunday August 12 from 12:00). Please do not hesitate to ask the registration desk if you need assistance.

Security

Copenhagen is generally a safe city. There are no particular spots you should not walk in the evenings, but do take care of pick pockets, particularly in crowded places like train stations, etc.

Social events

Four social events will take place. Please see separate description of social events in this program.

Time difference and weather

Time zone is UTC +1. Weather is normally warm in Copenhagen in August, although Denmark has coastal climate and rain/showers may therefore be expected. Therefore, pack also for rain.

Tipping

Tipping is not a tradition in Denmark. Tipping in cafes and restaurants is always welcomed, but not expected. Tipping in shops, hairdressers, etc. is not done.

Venue

The conference takes place at the Panum Institute in the newly constructed Maersk Tower, Faculty of Health, University of Copenhagen. The address is Blegdamsvej 3. DK-2200 Copenhagen N. Auditories and class rooms are located on the first floor. Please visit the 15th floor for a magnificent view of Copenhagen.

WiFi

There is a free guest WiFi at the Panum Institute besides the Eduroam network.

SOCIAL PROGRAMME

A **Welcome Reception** in the evening of Sunday August 12 19:00 – 21:00 at Nordatlantens Brygge opposite Nyhavn. Attendance is free for conference participants, but due to shortage of space, accompanying persons cannot attend.



A tour around the **Copenhagen canals** with sandwich and beverages in the evening of Monday August 13, 18:00 – 20:00. Attendance open to all participants and accompanying persons (50 Euros).

A trip to the new **Nordic Ring in the Zoo of Copenhagen** with barbecue in the evening of Tuesday August 14, 18:00 – 20:00. Attendance open to all participants and accompanying persons (60 Euros).



A **Gala Dinner** at the Langelinie Pavillon just next to the Little Mermaid statue in the harbor of Copenhagen in the evening of Wednesday, August 14, 19:00 -02:00. Registration is open to all participants (30 Euros) and accompanying persons (115 Euros).

VENUE

The conference takes place at the Panum Institute in the newly constructed Maersk Tower, Faculty of Health, University of Copenhagen.

Do not miss the spectacular view of Copenhagen from the 15th floor.



VENUE LEVEL 1

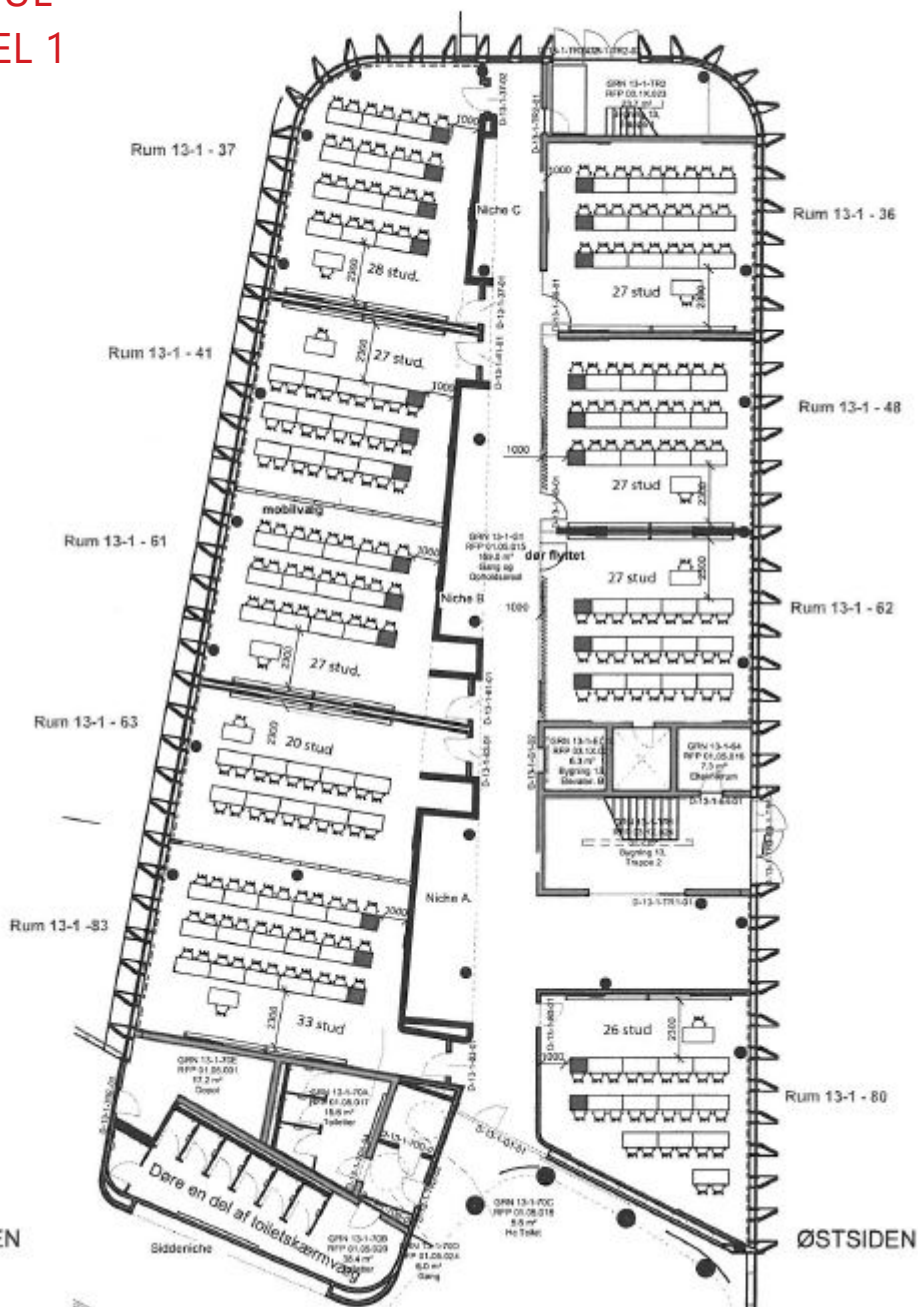

VENUE LEVEL 2

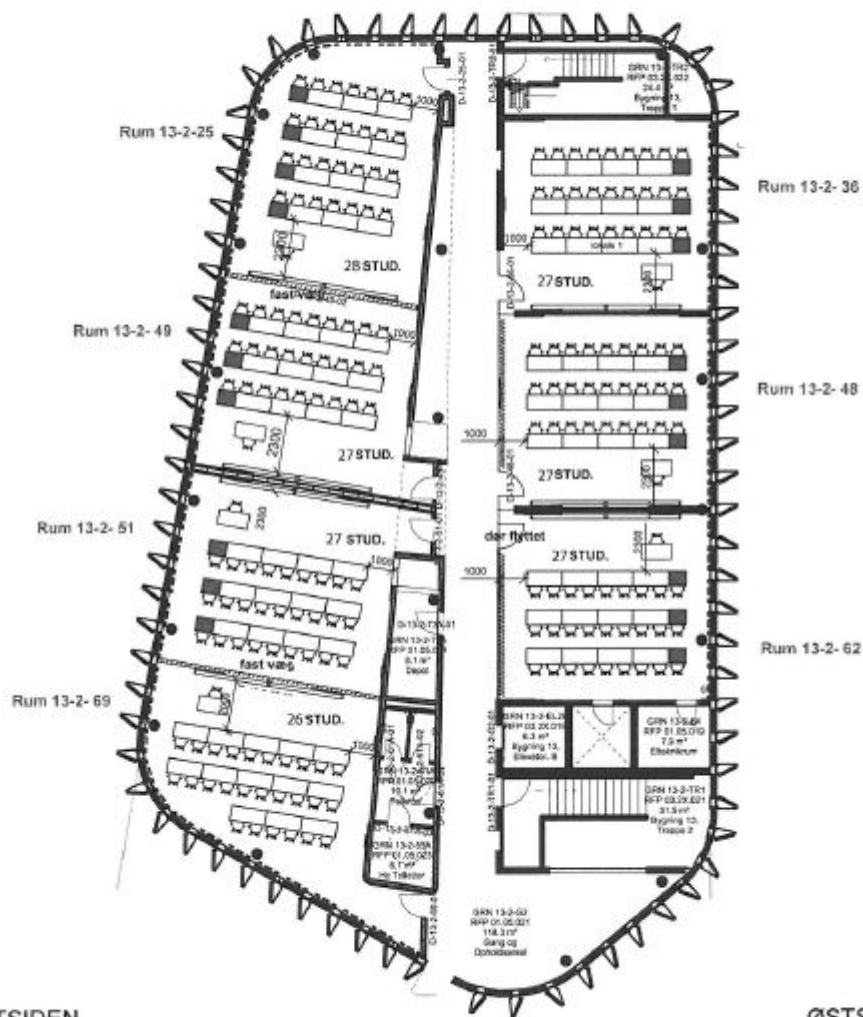

VESTSIDEN

ØSTSIDEN

OVERVIEW

Sunday, August 12	
12:00-17:30	REGISTRATION. Lobby, Maersk Tower
15:00-17:15	OPENING SESSION. Niels K. Jerne Auditory Chairmen: Anders Koch and Arja Rautio
15:00-15:20	Cultural event
15:20-15:35	Welcome to ICCH17. <i>Anders Koch, President of the IUCH</i>
15:35-15:50	Welcome to IUCH17. <i>Gert Mulvad, Danish Greenlandic Society for Circumpolar Health</i>
15:50-16:00	Welcome to IUCH17. <i>Doris J. Jensen, Ministry of Health and Research, Greenland Government</i>
16:00-16:10	Welcome to the Faculty of Health and Medical Sciences, the University of Copenhagen. <i>Ulla Wever, Dean & Professor, University of Copenhagen</i>
16.10-16:35	The era of old and new changes in Nunavut, from 1940 to present day: An Elder's View. <i>Levinia Brown, Elder, Deputy Minister, Nunavut</i>
16:35-17:00	Becoming a health professional abroad and returning to serve your native population. <i>Karsten Rex, MD, PhD student, Nuuk, Greenland</i>
17:00-17:15	Cultural event
19:00-21:00	RECEPTION. NORDATLANTENS BRYGGE

Monday, August 13	
07:30-17:00	REGISTRATION. Lobby, Maersk Tower
08:00-09:00	MEET AND HAVE BREAKFAST WITH THE EXPERTS Infectious diseases. <i>James Berner, Mike Bruce, André Corriveau, Tom Hennessy, Anders Koch, Brian McMahon & Pamela Orr.</i> Nielsine Nielsen Auditory Mental health. <i>Allison Crawford, Gwen Healey, Gunn Heatta, Jack Hicks, Rhonda Johnson, Michael Jong & Christina V.L. Larsen.</i> Jens Juul Holst Auditory
09:00-10:30	PLENARY SESSION: HEALTH IN THE ARCTIC. Niels K. Jerne Auditory Chairmen: Gert Mulvad and Christina Viskum Lytken Larsen Cultural event
09:00-09:15	Arctic health and wellbeing: working better together. <i>Rhonda Johnson, Professor, Fairbanks, Alaska, USA</i>
09:15-09:40	Health challenges in a society in transition. <i>Jon Øyvind Odland, Professor, University of the Arctic, Norway</i>
09:40-10:05	Could the microbes of Greenland lead the way to better food, health and economy in Greenland? <i>Aviaja Hauptmann, Post Doc, Ilisimatusarfik, University of Greenland, Nuuk Greenland</i>
10:05-10:30	
10:30-11:00	COFFEE BREAK. Lobby
11:00-12:30	ORAL PRESENTATIONS: SESSION 1. Auditories and classrooms
	LUNCH. Lobby Side meetings:
12:30-13:30	<ul style="list-style-type: none"> • International Network for Circumpolar Health Researchers. Room 13-1-83 • IUCH Working group formation: Built environment. Open invitation. <i>Philippe Amtisilavski.</i> Room 13-1-61 • Network formation: Mother and child network. Open invitation. <i>Ruth Montgomery-Andersen.</i> Room 13-1-62
13:30-15:00	ORAL PRESENTATIONS: SESSION 2. Auditories and classrooms
15:00-15:30	COFFEE BREAK AND POSTER PRESENTATIONS. Poster hall
15:30-17:00	PLENARY SESSION: CLIMATE CHANGE AND HEALTH. Niels K. Jerne Auditory Chairmen: Anders Koch and Jon Petter Storr Cultural event
15:30-15:45	Health risks of and adaptation to a changing climate. <i>Kristie Ebi, Professor, Washington, USA</i>
15:45-16:10	A One Health perspective on climate change in the Arctic. <i>Tom Hennessy, Director, Anchorage, Alaska, USA</i>
16:10-16:35	Planet Youth and Reykjavik as Healthy City. <i>Ingibjörg Thorisdóttir, PhD student, Reykjavik University</i>
16:35-17:00	
18:00-20:00	SOCIAL EVENT: COPENHAGEN CANAL TOUR

Tuesday, August 14	
07:30-17:00	REGISTRATION. Lobby, Maersk Tower
08:00-09:00	MEET AND HAVE BREAKFAST WITH THE EXPERTS Chronic diseases and genetic interactions. <i>Anders Albrechtsen, Laura Arbour, Tracey Galloway, Torben Hansen, Marit Eika Jørgensen & Michael Lyng Pedersen.</i> Nielsine Nielsen Auditory Population studies. <i>Peter Bjerregaard, Susan Chatwood, Jon Øyvind Odland, Arja Rautio, Mylene Riva & T. Kue Young.</i> Jens Juul Holst Auditory
09:00-10:30	PLENARY SESSION: A VIEW ON HEALTH FROM WITHIN. Niels K. Jerne Auditory Chairmen: Peter Bjerregaard and Gwen Healey Cultural event
09:00-09:20	
09:20-09:55	Circumpolar Approaches to Suicide Prevention. <i>Allison Crawford, associate professor, Toronto, Canada</i>
09:55-10:30	The professional patient. <i>Sten Lund, Research coordinator, Nuuk, Greenland</i>
10:30-11:00	COFFEE BREAK. Lobby
11:00-12:30	ORAL PRESENTATIONS: SESSION 3. Auditories and classrooms
	LUNCH. Lobby
	Side meetings:
12:30-13:30	<ul style="list-style-type: none"> • American Society for Circumpolar Health. Room 13-1-83 • Canadian Society for Circumpolar Health. Room 13-1-61 • Nordic Society for Circumpolar Health and Danish Greenlandic society for Circumpolar Health. Room 13-1-62 • Russian Academy of Polar Medicine and Extreme Human Ecology. Room 13-1-36
13:30-15:00	ORAL PRESENTATIONS: SESSION 4. Auditories and classrooms
15:00-15:30	COFFEE BREAK AND POSTER PRESENTATIONS. Poster hall
15:30-17:00	PLENARY SESSION: HEALTH IN TRANSITION. Niels K. Jerne Auditory Chairmen: Preben Homøe and Neil Murphy Cultural event
15:30-15:45	
15:45-16:10	The Russian Arctic, population changes in the recent past and future. <i>Anastasia Emelyanova, University of Oulu, Finland</i>
16:10-16:35	Diabetes among Arctic Inuit. <i>Marit Eika Jørgensen. Professor, Copenhagen, Denmark</i>
16:35-17:00	Tuberculosis in the Arctic. <i>Aase Bengaard Andersen, Professor, Copenhagen, Denmark</i>
18:00-20:00	SOCIAL EVENT: ARCTIC RING, COPENHAGEN ZOO

Wednesday, August 15	
08:00-17:00	REGISTRATION. Lobby, Maersk Tower
09:00-10:30	PLENARY SESSION: GENETICS. Niels K. Jerne Auditory Chairmen: Marit Eika Jørgensen and T. Kue Young
09:00-09:15	Cultural event
09:15-09:40	Early peopling of the Americas and the new world Arctic. <i>Eske Willerslev, Professor, Copenhagen, Denmark</i>
09:40-10:05	Genetics of complex diseases in Greenlandic Inuit. <i>Anders Albrechtsen, Associate professor, Copenhagen, Denmark</i>
10:05-10:30	Bridging the Genomic Divide: Why integrating genetics/genomics into health care matters for Circumpolar Indigenous peoples. <i>Laura Arbour, Professor, Victoria, Canada</i>
10:30-11:00	COFFEE BREAK. Lobby
11:00-12:30	ORAL PRESENTATIONS: SESSION 5. Auditories and classrooms
12:30-13:30	LUNCH. Lobby Side meetings: <ul style="list-style-type: none"> • Climate sensitive infectious diseases ICS working group. Room 13-1-83
13:30-14:30	PLENARY SESSION: IUCH GENERAL ASSEMBLY. Niels K. Jerne Auditory <ul style="list-style-type: none"> • President's and Treasurer's reports • Election of members from the floor
14:30-15:45	CIRCUMPOLAR NATION'S SPORTS CUP & COFFEE BREAK. Open air space, Maersk Tower
15:45-17:30	PLENARY SESSION: CLOSING CEREMONY. Niels K. Jerne Auditory Chairmen: Anders Koch, Mike Bruce and Michail Voevoda
15:45-16:00	Cultural event
16:00-16:30	Research in the Arctic. For What and for Whom? <i>Bo Lidegaard, Historian and Advisor, Copenhagen, Denmark</i>
16:30-17:30	Results of IUCH ballot
	Hildes and Jens Peder Hart Hansen Prize Awards
	Welcome to Sct. Petersburg 2021. <i>Michail Voevoda, Professor, Russian Academy of Polar Medicine and Extreme Human Ecology</i>
	Closing remarks. <i>Anders Koch, President of the IUCH</i>
19:00-02:00	SOCIAL EVENT: GALA DINNER LANGELINIE PAVILLON

SESSION OVERVIEW

Date and time	Track 1 Mental wellness	Track 2 Culturally sensitive health care	Track 3 Health care systems and ethics	Track 4 Environment I	Track 5 Environment II
	Jens Juul Holst Auditory	Classroom 13-1-37	Classroom 13-1-41	Classroom 13-1-61	Classroom 13-1-61
Monday 13					
11:00 – 12:30	Youth empowerment <i>Chairs:</i> CVL. Larsen A. Elman	Urban Inuit health and education <i>Chairs:</i> C. Fletcher H. Møller	Health programming <i>Chairs:</i> C. Ingemann S. Chatwood	Climate change and One health <i>Chairs:</i> J. Berner D. Orlov	Injuries and violence <i>Chairs:</i> B. Hanley S. Sigurdarson
13:30 – 15:00	Psychiatry and mental health overview <i>Chairs:</i> D. Willis KL. Hansen	Health education <i>Chairs:</i> K. Nystad J. Walker	Ethics and research I <i>Chairs:</i> G. Mulvad J. Bull	Contaminants and cold <i>Chairs:</i> EB. Jørgensen T. Ikäheimo	Substance use and gamb <i>Chairs:</i> B. Niclasen OA. McInnes
Tuesday 14					
11:00 – 12:30	Mental wellness and social determinants <i>Chairs:</i> M. Riva M. San Sebastian	Community involvement <i>Chairs:</i> L. Plourde- Léveillé L. Butler	Health care delivery <i>Chairs:</i> C. Liddy L. Seibæk	Environment and health <i>Chairs:</i> P. Amtislavski AR. Broderstad	Occupation medicine and physical ac <i>Chairs:</i> IK. Dahl-Pedersen A. Yurjeva
13:30 – 15:00	Suicide <i>Chairs:</i> M. Jong L. Wexler	Youth <i>Chairs:</i> AS. Homøe F. Walker	Education <i>Chairs:</i> S. Møller B. Geboe	Oral and dental health <i>Chairs:</i> M. Demuth M. Ogenchuk	Occupation medicine <i>Chairs:</i> KV. Logunov J. Børnløkke
Wednesday 15					
11:00 – 12:30	Photovoices and On the land <i>Chairs:</i> M. van Bibber M. Etter	Cultural safety <i>Chairs:</i> L. Daerga B. Norbye	Ethics and research II <i>Chairs:</i> J. Lavoie JB. Zoe		Telemedicine <i>Chairs:</i> D. Gillis T. Skifte

VIEW ICCH17

Track 5 Symptom	Track 6 Chronic diseases and genetics	Track 7 Infectious diseases	Track 8 Mother and child health	Track 9 Ageing, nursing and cancer	Track 10 Workshops
Room 48	Classroom 13-1-36	Nielsine Nielsen auditory	Classroom 13-1-62	Classroom 13-1-80	Classrooms 13-1-83 / 13-1-63
Topic	Cardiovascular diseases <i>Chairs:</i> <i>M. Voevoda</i> <i>PF. Rønn</i>	Tuberculosis <i>Chairs:</i> <i>B. Søborg</i> <i>A. Schertzer</i>	Child health I <i>Chairs:</i> <i>R. Seerup</i> <i>TE. Burtseva</i>	Ageing <i>Chairs:</i> <i>Stig Andersen</i> <i>S. Horlick</i>	W: Rural suicide prevention <i>Chair: Lisa Wexler</i>
Abstract topic	Diabetes <i>Chairs:</i> <i>ME. Jørgensen</i> <i>ML. Pedersen</i>	STI <i>Chairs</i> <i>MB. Johansen</i> <i>C. Jessen</i>	Child health II <i>Chairs.</i> <i>SW. Michelsen</i> <i>S. Collins</i>	Nursing <i>Chairs:</i> <i>L. Hounsgaard</i> <i>G. Mehus</i>	W: Age and well- being in the Arctic <i>Chair: Tenna Jensen</i> / W: Circumpolar suicide prevention <i>Chair: Sarah Cox</i>
Abstract topic	Genetics <i>Chairs:</i> <i>L. Arbour</i> <i>N. Barashkov</i>	HIV, HPV and viral hepatitis <i>Chairs:</i> <i>B. McMahon</i> <i>KF. Rex</i>	Child and maternal health <i>Chairs:</i> <i>LL. Schwarzburg</i> <i>M. Wielsøe</i>	Cancer I <i>Chairs:</i> <i>E. Roik</i> <i>J. Chan</i>	W: UArctic and Arctic Council <i>chairs: Gert Mulvad &</i> <i>Tom Hennesy</i> / W: Research is reflexive and relational: promoting and practicing ethical research with indigenous peoples <i>Chair: Julie Bull</i>
Abstract topic	Diet and nutrition I <i>Chairs:</i> <i>CJ. Burton</i> <i>SP. Jerome</i>	GI and food- borne infections <i>Chairs:</i> <i>E. Jenkins</i> <i>C. Nelson</i>	Hearing loss and otitis media <i>Chairs:</i> <i>P. Homøe</i> <i>A. Wiletto Wolfe</i>	Cancer II <i>Chairs:</i> <i>M. Odgaard</i> <i>DM. Lamothe</i>	W: Building on strengths in Naujaat – a youth initiative: first results <i>Chair: Polina Anang</i>
Abstract topic	Diet and nutrition II <i>Chairs:</i> <i>T. Galloway</i> <i>M. Brustad</i>	Respiratory and other infections <i>Chairs:</i> <i>M. Bruce</i> <i>Koch, A.</i>	Maternal health <i>Chairs:</i> <i>T. Fyfe</i> <i>R. Montgomery- Andersen</i>	Parental education <i>Chairs:</i> <i>PM. Moffitt</i> <i>SE. Nilsen</i>	W: Health system discussion <i>Chair: Chris Politis</i> / W: Sustainable development goals in a thriving Arctic <i>Chair: Nicole Kanayurak</i>

SESSION PROGRAM

Oral and poster presentations are divided by theme into 9 tracks with 5 sessions each of 1½ hours length. In addition, dedicated workshops form a track 10.

Sessions include oral and poster presentations.

Oral presentations are given 15 minutes: 10 minutes for presentation and 5 minutes for discussion. Posters will be on display in the lobby during the whole conference. Poster presenters are given the opportunity to present highlights from the poster for 5 minutes maximum in a given session.

In the following, presentations are listed by tracks and sessions.

Please see the Session Overview table for a full overview of tracks and sessions.

An author page index is found at the end of the program.

Track 1: Mental wellness.....	Page 2
Track 2: Culturally sensitive health care.....	Page 6
Track 3: Health care systems and ethics.....	Page 10
Track 4: Environment I.....	Page 15
Track 5: Environment II.....	Page 18
Track 6: Chronic diseases and genetics.....	Page 22
Track 7: Infectious diseases.....	Page 26
Track 8: Mother and child health.....	Page 31
Track 9: Ageing, nursing and cancer.....	Page 35
Track 10: Workshops.....	Page 39

Track 1: Mental wellness

Monday 13.08. 11:00 – 12:30. Jens Juul Holst auditory

1. Youth empowerment

Chairs: Larsen, CVL. And Elman, A.

Oral, abstract no. 300

Well-being among indigenous children and youth in the Arctic – with a focus on Sami and Greenland Inuit
Larsen, CVL. Ingemann, C.

Oral, abstract no. 137

Honoring Indigenous Stories to Protect our Youth - Family, community, and self healing through storytelling
Lewis, JP.

Oral, abstract no. 254

Te(a)ch: Teaching coding for youth empowerment and wellness in Nunavut
Tabish, T. Oliver, R.

Oral, abstract no. 5

A Narrative Review of Mindfulness-Meditation Programs for Aboriginal Youth: Program Implementation to Improve Anxiety/Stress and Emotional Wellbeing in a High Risk Population
Paniak, A. Jamal, A.

Poster, abstract no. 169

Makimautiksats Youth Wellness and Empowerment Camp: A Model for Promoting Community Well-being, Culture, and Resilience
Sallaffie, MC.

Oral, abstract no. 177

Mental health services in the Northwest Territories: A scoping review
Elman, A. Etter, M. Fairman, K. Chatwood, S.

Monday 13.08. 13:30 – 15:00. Jens Juul Holst Auditory

2. Psychiatry and mental health overview

Chairs: Willis, D. and Hansen, KL.

Oral, abstract no. 45

Child and Adolescent Psychiatry Delivered to the Inuit of Nunavut; A Discussion of Model of Care, Culture, Best Practices and Learnings
Willis, D. Madsen, V.

Oral, abstract no. 73

Cultural construction of Dementia among Alaska Natives and providers and implications for arctic communities
Lewis, J.

Oral, abstract no. 150

Indigenizing Mental Health Laws in Canada's North

Drossos, A.

Poster, abstract no. 86

Discrimination, Mental Health and Resilience Among Indigenous Sami and Non-Sami Populations in Norway: The SAMINOR2 Study

Hansen, KL.

Poster, abstract no. 236

Restoring Indigenous miyo-mahcihooyān (physical, emotional, mental, and spiritual wellness)

Graham, HA. Ramsden, V. Butt, P.

Poster, abstract no. 229

Relationship between health behaviors and marital adjustment and marital intimacy in multicultural family female immigrants

Lee, J. Kim, J. Kim, S. Jeong, J. Yoon, S. Kim, S. Lee, S.

Poster, abstract no. 190

Nenets and the Arctic: Forms of Adaptive Behaviour

Lobova, VA. Mironov, AV.

Tuesday 14.08. 11:00 – 12:30. Jens Juul Holst Auditory

3. Mental wellness and social determinants

Chairs: Riva, M. and San Sebastian, M.

Oral, abstract no. 176

Mental Health Resilience in Nunavut, Canada: Stressors and Practices for Maintaining Wellness in Three Inuit Communities

Gilbert, SZ. Kral, MJ. Guerin, C. Masson, K. Davies, L.

Oral, abstract no. 185

Moving to a new house in the Arctic: Significant improvements in housing conditions and in psychosocial and physical health outcomes

Riva, M. Perreault, K. Fletcher, C. Dufresne, P.

Oral, abstract no. 184

Moving to a new house in Nunavik and Nunavut: assessing the associations between changes in housing conditions and improvement in mental health

Perreault, K. Riva, M. Fletcher, C. Dufresne, P.

Oral, abstract no. 259

The effect of housing characteristics on health outcomes among Inuit in Greenland

Hansen, CB. Larsen, CVL. Riva, M.

Oral, abstract no. 178

Mine, yours or ours? Income inequality and mental health in Northern Sweden

San Sebastian, M. Mosquera, P. Gustafsson, PE.

Oral, abstract no. 295

Using Traditional Arctic Games to Promote Sustainability & Peace in the North

Kilbourne, J.

Tuesday 14.08. 13:30 – 15:00. Jens Juul Holst Auditory

4. Suicide

Chairs: Jong, M. and Wexler, L.

Oral, abstract no. 97

Enhancing suicide surveillance in Labrador, Canada: A case study in community-based population health research

Pollock, NJ.

Oral, abstract no. 22

An integrated knowledge explanation of factors leading to elevated rates of child and youth suicide behaviour in some Indigenous communities – and implications for suicide prevention strategies

Hicks, J.

Oral, abstract no. 294

Using Research to Inform Community Prevention Practice: Sharing Participatory Approach and Results from Promoting Community Conversations About Research to End Suicide (PC CARES) in Alaska

Wexler, L. Johnson, RM. Moto, R. McEachern, D. Dombrowski, K.

Oral, abstract no. 60

Community intervention to prevent repeated suicide attempts

Mishara, B. Crawford, A. Hicks, JR.

Oral, abstract no. 114

Forum Theatre for Indigenous Youth Suicide Prevention

Jardine, C. Friedel, T. Crowshoe, L. Henderson, R. Montesanti, S. Lines, LA.

Oral, abstract no. 98

Enhancing well being for Indigenous young men and boys through land-based program

Jong, M. Baker, K. Healey, G.

Wednesday 15.08. 11:00 – 12:30. Jens Juul Holst Auditory

5. Photovoices and On the Land

Chairs: Van Bibber, M. and Etter, M.

Oral, abstract no. 41

Capturing the process – Photovoice as an evaluation method for students participation in the Healers of Tomorrow Gathering

Shea, J. Sturge Sparkes, C.

Oral, abstract no. 4

A Knowledge Mobilization Model for First Nations Mental Wellness Strategies: Building on Local Knowledge and Networks

Morton Ninomiya, ME. Wells, S. George, J. Bernards, S. Plain, S. George, T. Graham, K. Linklater, R.

Oral, abstract no. 290

Understanding Youth-Identified 'Connection to the Land' as a Determinant of Dene First Nations Peoples' Health

Lines, LA. Jardine, CG.

Oral, abstract no. 163

Keeping Our Traditions for the Mental Wellbeing of Our Youth: "What do we do at the fish camps when there's no fish?"

Van Bibber, M. Kassi, N.

Oral, abstract no. 126

Growing Hope: Youth gardening in Black Tickle a photovoice project

Shea, J. Hudson, A.

Oral, abstract no. 221

Project Jewel: On-the-land Wellness Program and Inuvialuit-informed Monitoring and Evaluation

Etter, M. Ruttan, J. Giles, A.

Track 2: Culturally sensitive health care

Monday 13.08. 11:00 – 12:30. Classroom 13-1-37

1. Urban Inuit health and education

Chairs: Fletcher, C. and Møller, H.

Oral, abstract no. 274

The Qanuikkat Siqinirmiut project – developing a research partnership to describe Inuit health in Southern Quebec

Fletcher, C. Baron, A. Lyonnais, MC. Pisuktie, AP. Pisuktie, T. Riva, M.

Oral, abstract no. 172

Marginalized Greenlanders in Denmark and the impact of current initiatives

Møller, H. Bavisgar, S.

Oral, abstract no. 283

Transforming the academy: The University of Manitoba's Indigenous Institute of Health and Healing

Cook, C. Anderson, M. Lavallee, B. Lavoie, J. McKinnon, M.

Oral, abstract no. 84

Differences in socioeconomic characteristics and health status between Inuit living in and outside Inuit Nunangat

Riva, M. Dufresne, P. Fletcher, C.

Poster, abstract no. 72

Cultural Competency Training in a National Organization; Realizing the Truth and Reconciliation's Calls to Action.

Hutchinson, P. Tobin, P. Muirhead, A. Handa, D. Sunak, A. Ng, H.

Poster, abstract no. 241

Rural Week: Medical Student Perspectives on a one week first year placement in Northern and Remote Settings - 12 Years of Reflection

Durcan, A. **Goulet, S.** Conroy, D.

Poster, abstract no. 6

A paper media review of patient experiences in the Northwest Territories

Affleck, Z.

Monday 13.08. 13:30 – 15:00. Classroom 13-1-37

2. Health education

Chairs: Nystad, K. and Walker, J.

Oral, abstract no. 51

Circle of Care: A holistic approach to caring for First Nations peoples and communities.

Kyoon-Achan, G. **Walker, J.**

Oral, abstract no. 96

Enhancing cultural sensitivity in health care services in Nunavik by developing pedagogical tools for interveners working in health and social services

Plourde-Léveillé, L. Fraser, S.

Oral, abstract no. 71

Cultural based health interventions: indigenous doulas for First Nations women who travel for birth

Cidro, J. Sinclair, S. Phillips-Beck, W. Mercer, J. Bluesky, K.

Oral, abstract no. 25

Arctic health research at Umeå University – a bibliometric content analysis

Nilsson, LM.

Oral, abstract no. 138

How standard is standard? Examining the standard scores of the CELF-P2 in Northern Populations of the Beaufort Delta

Hay, ALM. Boyle, JM.

Oral, abstract no. 266

The impact of national culture on the life insurance holding: A Study Using SHARE Data

Lai, GC. Li, CS.

Poster, abstract no. 74

Culturally-responsive arts and social media-based interventions to promote positive sexual health, attitudes and behaviours among Nunavut youth

Horlick, S. Diakite, N. Healey, G.

Tuesday 14.08. 11:00 – 12:30. Classroom 13-1-37

3. Community involvement

Chairs: Plourde-Léveillé and Butler, L.

Oral, abstract no. 158

Inuit community perspectives and population health surveys: the example of the 'Community Component' of Qanuilirpitaa?, the 2017 Nunavik Health Survey

Riva, M. Fletcher, C. Lyonnais, MC. Lynch, M.

Oral, abstract no. 154

Innu eishkupenanu – Planning collaborative research on Innu minuinniuin (wellbeing): a case study in Indigenous community-based participatory research (CBPR)

Ward, LM. Hill, MJ. Piccard, A. Andrew, A. Poker, C. Chreim, S. Jull, J. Morton Ninomiya, ME. Olsen Harper, A. Pollock, NJ. Wells, SL.

Oral, abstract no. 57

Collaboration with Manitoba First Nations communities, sharing our experience of working together on the Rights path.

Phillips-Beck, W. Lavoie, J. Katz, A. Kinew, KA. Kyoon-Achan, G. Ibrahim, N. Sinclair, S.

Oral, abstract no. 95

Enhancing collaboration with Inuit community members in health and social services to reduce health inequities in Nunavik

*Fraser, S. **Plourde-Léveillé, L. Gagnon, D.***

Oral, abstract no. 108

Exploring Aajiiqatigiingniq as an Inuit-specific therapeutic approach to community justice in support of a Wellness Court in Nunavut, Canada

*Ferrazzi, P. **Tagalik, S. Karetak, J. Baker, K. Angalik, L.***

Oral, abstract no. 69

Creating an Innovative Pathway for a Culturally Relevant Health Workforce: Lessons Learned from Knowledge Keepers Forum

Butler, L. Moller, S. Kuosa,, K. Berry, L. Manskow, U. Mougaard-Frederiksen, H. Isidor, S. Olesen, P. Lennert Olsen, L. Frandsen, S.

Tuesday 14.08. 13:30 – 15:030. Classroom 13-1-37

4. Youth

Chairs: Homøe, AS. And Walker, F.

Oral, abstract no. 101

Equitable health services for the young? A decomposition of income-related inequalities in young adults' utilization of health care in Northern Sweden

*Mosquera, PA. Waenerlund, AK. Goicolea, I. **San Sebastian, M. Gustafsson, PE.***

Oral, abstract no. 102

Ethnic identity negotiation among Sami youth living in a majority Sami community in Norway

*Nystad, K. **Spein, AR. Balto, AM. Ingstad, B.***

Oral, abstract no. 248

Spoken words and silence use in young children medical consultation : the interactional dimension of healthcare, Nunavik, Quebec Arctic

Benoît, A.

Oral, abstract no. 233

Removal of Parents: A Manitoba First Nation community approach to reducing the trauma of child apprehension

*Kyoon-Achan, G. **Walker, F.***

Oral, abstract no. 144

Implementation of School Clinics as a way to Address Gaps in Health Provision among the Pediatric ADHD Population of a Northern Manitoba First Nations Reserve

Paniak, A. Morrow, A.

Oral, abstract no. 168

Leveraging Corporate Social Responsibility to Enable Cross Jurisdictional Programming in Arctic Communities in Nunavut Canada

Willis, D. Madsen, V.

Wednesday 15.08. 11:00 – 12:30. Classroom 13-1-37

5. Cultural safety

Chairs: Daerga, L. and Norbye, B.

Oral, abstract no. 230

Religion and health in North Norway: Data from the Saminor 2 survey

*Kiærbech, HM. Silviken, AC. Broderstad, AR. Lorem, GF. Kristiansen, RE. **Spein, A.***

Oral, abstract no. 164

Lack of trust in health and social professionals among reindeer-herding Sami

Daerga, L. Dahlgren, L. Edin-Liljegren, A. Sahlén, KG.

Oral, abstract no. 304

Working together to build a culturally safe health and social services system in the Northwest Territories

Yakeleya Newmark, M. Blondin Hall, K.

Oral, abstract no. 80

Developing a Cultural Safety Intervention for Clinician: Evaluation of a Pilot Study in the Northwest Territories

Hall, KEB.

Oral, abstract no. 59

Communities of practice in the Northwest Territories. A model for patient engagement in health system transformation.

Fairman, K. Chatwood, S.

Oral, abstract no. 289

Under the Same Sky Cultural sensitivity in nursing education - learning across the rural Circumpolar North

Norbye, B. Exner-Pirot, H. Butler, L.

Track 3: Health care systems and ethics

Monday 13.08. 11:00 – 12:30. Classroom 13-1-41

1. Health programming

Chairs: Ingemann, C. and Chatwood, S.

Oral, abstract no. 109

Facing health inequalities in Northern Sweden: experiences from starting up Norrland's Observatory for Equity in Health and Health Care

San Sebastian, M. Mosquera, P. Gustafsson, PE.

Oral, abstract no. 162

Inuvialuit Data Platform Project

MacLean, J.

Oral, abstract no. 79

Determinants of an integrated public health approach: The implementation process of Greenland's second public health program

Ingemann, C. Regeer, BJ. Larsen, CVL.

Oral, abstract no. 132

Health systems stewardship in circumpolar regions

Chatwood, S.

Oral, abstract no. 207

Our People, Our Health: Envisioning to Improve Primary Healthcare in Manitoba First Nation communities.

Kyoon-Achan, G. Avery Kinew, K. Phillips-Beck, W. Sinclair, S. Lavoie, J. Katz, A.

Poster, abstract no. 222

Prospective lines of establishment of medical care for indigenous peoples in Northern Territories difficult of access

Zubov, L. Gorbatova, L. Malyavskaya, S. Degteva, G.

Poster, abstract no. 115

Fostering Research Communities of Practice in the Canadian North: A Social Capital Analysis

Asghari, S. Araee, M. Graham, W. Bethune, C. Heeley, T.

Poster, abstract no. 170

Māmawōhkamātowin (working together) – Enhancing Health & Wellness with Sturgeon Lake First Nation

Ramsden, VR. Kirychuk, S. Rabbitskin, NY. Abonyi, S. Dolovich, L. Dosman, JA. Fenton, M. Graham, H. Lamarche, L. Bighead, S. Davis, B. Turner, T.

Monday 13.08. 13:30 – 15:00. Classroom 13-1-41

2. Ethics and research I

Chairs: Mulvad, G. and Bull, J.

Oral, abstract no. 16

Alaska Native and American Indian patient, provider, and community leader perspectives on precision medicine

Hiratsuka, V. Beans, J. Wark, K. Woodbury, RB.

Oral, abstract no. 159

Inuit Qaujimagatuqangit and community-based participatory research: The alignment of Inuit and academic ways of knowing and doing in health research

Rand, JR. Steenbeek, A. Martin, D. Loppie, C. Plested, B.

Oral, abstract no. 262

The eNuk Program: Participatory, community-led environment and health surveillance with Inuit in Rigolet, Nunatsiavut, Canada.

Cunsolo, A. Harper, S. Gillis, D. Shiwak, I. Flowers, C. Sawatzky, A. Kipp, A. Wood, M. Rigolet Inuit Community Government, Durish, NJ. Cook, O. Rourke, K.

Oral, abstract no. 298

Weaving Autoethnography, Poetry, Digital Storytelling, and Empirical Inquiry to Re-story the Research Ethics Regulatory System in Canada

Bull, J.

Poster, abstract no. 213

Place-Making in the Research Process: Sewing, Stories, and Sense of Place at a Medical Boarding Home in Iqaluit, Nunavut, Canada

Brubacher, LJ. Tatty, N. Healey, G. Dewey, CE. Cunsolo, A. Humphries, S. Harper, SL.

Poster, abstract no. 116

Fostering the conduct of ethical and equitable research practices: the imperative for integrated knowledge translation in research conducted by and with First Nations, Inuit and Métis community members

Jull, JE. Morton-Ninomiya, ME.

Poster, abstract no. 39

Building Partnerships on Solid Ground: Indigenous and non-Indigenous researchers exploring decolonised research relationships

Ireland, S. Marsh, J.

Poster, abstract no. 271

The Posttraumatic Growth: Current State of Subject and Research Perspectives

Zeliana, AN.

Tuesday 14.08. 11:00 – 12:30. Classroom 13-1-41

3. Health care delivery

Chairs: Liddy, C. and Seibæk, L.

Oral, abstract no. 146

Improving access to specialists in remote communities: a cross-sectional study and cost analysis of the use of eConsult in Nunavut, Canada

Liddy, C. McPhillips, F. Armstrong, CD. Afkham, A. Fraser-Roberts, L.

Oral, abstract no. 193

Northern Physicians as Researchers: Not a Remote Possibility

Heeley, T. Asghari, S. Doherty, S. Graham, W. Bethune, C.

Oral, abstract no. 7

A program to establish sustainable, certified foot and nail care for the indigent homeless in urban Alaska

Burdette-Taylor, M. Tyrrell, CA.

Oral, abstract no. 208

Patient involvement in Greenland hospital care: a clinical research project

Seibæk, L. Hounsgard, L.

Poster, abstract no. 148

Improving Recruitment and Retention of Physicians in Nunavut, Canada by Implementing a Health Career Camp for High School Aged Youth

Horlick, S. Wakegijig, J. Healey, G. Edgcombe, N. Ste Marie, K. Willard, LA. Beardsall, K. Enuaraq, N. Fawehinmi, T. Salomonie, A. LeBlanc, SL.

Poster, abstract no. 89

Emergency medical air transportation in Labrador, Canada: A population-based study

Pradhan, G. Pollock, NJ. Wilson, MM.

Poster, abstract no. 106

Examination of a new specialty clinical service in the Kivalliq region of Nunavut.

Durcan, A. Moffatt, M. Schantz, D. Soni, R. Nguyen, H.

Poster, abstract no. 15

Adult Occupational Therapy (OT) and Physiotherapy (PT) Services in the Kivalliq Region of Nunavut:

Mapping the Client Journey

Achtemichuk, M. Leclair, L. Fricke, M. Lavoie, J.

Tuesday 14.08. 13:30 – 15:00. Classroom 13-1-41

4. Education

Chairs: Møller, S. and Geboe, B.

Oral, abstract no. 111

First Peoples' Postsecondary Storytelling Exchange: Intersecting College and Community Circles

Fast, F. Nicole, I. Smith, M. Phillis, M. Briscoe, S.

Oral, abstract no. 93

Engaging faculty from rural Alaska: Strengthening diversity in the Alaska LEND Program

Miller, V. Ward, K.

Oral, abstract no. 151

Indigenous Access McGill, McGill University – Engaging Indigenous students in Social Work Education

Geboe, BJ. Ives, N. Gabriel, W.

Oral, abstract no. 252

Supporting Inuit students' academic retention through land-based education: Indigenous Field Studies, McGill School of Social Work

Ives, N. Geboe, BJ. Gabriel, W.

Oral, abstract no. 105

Evaluation of a printed health education magazine for use by Alaska native families Nuta'aq Unguwaq

Stiller, TL.

Poster, abstract no. 166

Learning from the Land and One Another: Place-based Indigenous health research education and mentorship in Atlantic Canada

Cunsolo, A. Hart, C. Bombay, A. Worden-Driscoll, I. McMillan, J. Pollock, N. Martin, D.

Poster, abstract no. 251

Summer research training institute for American Indian and Alaska Native (AI/AN) health professionals—a 15 year perspective

Becker, TM. Donald, C. Cunningham, GO. Warren-Mears, V.

Wednesday 15.08. 11:00 – 12:30. Classroom 13-1-41

5. Ethics and research II

Chairs: Lavoie, J. And Zoe, JB.

Oral, abstract no. 258

The Arctic Mental Health Working Group: an example of Arctic research coordination and support

Rosa, C.

Oral, abstract no. 17

Alaska Native Collaborative Hub for Research on Resilience

Wexler, L. Johnson, RM. Rasmus, S. Allen, J. Black, J.

Oral, abstract no. 234

Research Governance in NunatuKavut: Engagement, Expectations, and Evolution

Bull, J.

Oral, abstract no. 52

Circumpolar and south: Rethinking how we frame research with circumpolar nations

Lavoie, J. Clark, W.

Oral, abstract no. 103

Evaluating knowledge translation processes and outcomes in Indigenous health research

Morton Ninomiya, ME. Maddox, R. Atkinson, D. Brascoupe, S. Firestone, M. Robinson, N. Reading, J. Ziegler, C. Smylie, JK.

Oral, abstract no. 147

Improving Indigenous Population Health Outcomes in the Northwest Territories by Promoting Patient-oriented Research with an Indigenous Lens

Zoe, JB. DeLancey, D.

Track 4: Environment I

Monday 13.08. 11:00 – 12:30. Classroom 13-1-61

1. Climate change and one Health

Chairs: Berner, J. and Orlov, D.

Oral, abstract no. 54

Climate Change in Alaska: Social Workers Attitudes, Beliefs, and Experiences

Allen, MD.

Oral, abstract no. 82

Development of the Municipality of Anchorage climate adaptation plan using a student-driven, action learning approach

Hahn, M. Roderick, L. Donovan, S. Owens-Manley, J.

Oral, abstract no. 18

An Alaska Native (AN) tribally designed One Health approach to environmental monitoring of Arctic change in rural Alaska

Berner, JE.

Oral, abstract no. 175

Medical-geographical analysis of distribution of natural focal diseases in Yamalo-Nenets Autonomous Okrug (West Siberia) accounting for climate change

Orlov, D. Petäjä, T. Lappalainen, H. Basmakova, I. Bäck, J. Zilitinkevich, S. Malkhazova, S. Kulmala, M.

Oral, abstract no. 171

Mapping Safer and Shorter Routes to Clinics and Camps for Nenets Reindeer Herders

Amstislavski, P. Ceccato, P. Zubov, L. Roik, E. Pekel, JF.

Poster, abstract no. 88

Effects of climatic factors and climate change on infectious diseases in the Arctic

Waits, A. Emelyanova, A. Abass, K. Rautio, A.

Poster, abstract no. 204

One Arctic Health: Bringing the Arctic Health Website under the One Health Umbrella

Brudie, S. Sam, LD.

Monday 13.08. 13:30 – 15:00. Classroom 13-1-61

2. Contaminants and Cold

Chairs: Jørgensen, EB. and Ikäheimo, T.

Oral, abstract no. 56

Cold-related cardiorespiratory symptoms predict higher morbidity and mortality

Ikäheimo, TM. Jokelainen, J. Näyhä, S. Laatikainen, TY. Jousilahti, P. Laukkanen, JA. Jaakkola, JJK.

Oral, abstract no. 167

Levels of Contaminants in Human Populations in the Canadian Arctic

Adlard, B. Laird, B. Lemire, M. Ayotte, P. Chan, LHM. Curren, MS.

Oral, abstract no. 85

Dioxin-like POPs induced aryl hydrocarbon receptor transactivity in the Greenlandic pregnant women and relation to fetal growth indices

Long, M. Wielsøe, M. Bonefeld-Jørgensen, EC.

Poster, abstract no. 180

Monitoring Brown Adipose Tissue in Alaskan Sled Dogs: A Pilot Study

Dunlap, KL. Kromrey, L. Jerome, SP. Duffy, LK. Reynolds, AJ.

Poster, abstract no. 256

Temporal trends of environmental contaminants in Arctic human populations

Abass, K. Rautio, A.

Poster, abstract no. 67

Country Food Contaminant Advisories: Assessing Awareness and Preferences of Health and Risk Communication Messages in the Sahtú Region of the Northwest Territories, Canada

Brandow, D. Skinner, K. Laird, B. Ratelle, M. Simmons, D. Andrew, L. Bezha, W.

Tuesday 14.08. 11:00 – 12:30. Classroom 13-1-61

3. Environment and health

Chairs: Amtislavski, P. and Broderstad, AR.

Oral, abstract no. 242

Sekuwe (My house): discovering, envisioning and creating housing designs for Dene First Nation health.

Larcombe, L. Singer, M. Coar, L. Denechezhe, L. Yassie, E. Avery Kinew, K. Orr, P.

Oral, abstract no. 129

HALDI – the initiation of a survey on health and living conditions in the Swedish parts of Sápmi

Storm Mienna, C. Nilsson, LM. Omma, L. Utsi, R. Axelsson, P.

Oral, abstract no. 49

Chitin-based Biomaterials: New Prospects for Healthy Arctic Indoor Environments and for Reducing Micro-plastics Pollution

Amstislavski, P. Yang, J. White, MD. Mahoney, D. Stiasny, P. Tinsley, R. Garber-Slaght, R.

Oral, abstract no. 92

Enforcing the Right to a Healthy (Indoor) Environment in Nunatsiavut, Canada

Kohut, R. Riva, M. Baumgartner, J.

Oral, abstract no. 61

Community Response to Wildfire Smoke in Old Crow, Yukon

Hanley, B. Zuccharini, C. Coyne, J. Elliott, C.

Poster, abstract no. 43

Changing risks to outdoor soft-mobility and use of public spaces in the Arctic

Larsson, A. Chapman, D.

Poster, abstract no. 270

The Population-based Study on Health and Living in Regions with Sami and Norwegian Populations - the SAMINOR Study

Broderstad, AR. Melhus, M.

Poster, abstract no. 26

Arctic region: human and social factors

Lobova, VA. Mironov, A.

Tuesday 14.08. 13:30 – 15:00. Classroom 13-1-61

4. Oral and dental health

Chairs: Demuth, M. and Ogenchuk, M.

Oral, abstract no. 200

Observations on dental health in Nunavut

Demuth, M.

Oral, abstract no. 77

Dental caries and weight among children in Nuuk, Greenland, at school entry

Madsen, SS. Wetterstrand, VJR. Pedersen, ML.

Oral, abstract no. 296

Vision with Action for Pediatric Oral Health

Ogenchuk, M.

Poster, abstract no. 104

Evaluating the dental health status of American Indian and Alaska Native (AI/AN) children age 11-13

Lutz, T. Smith, N. **Becker, T.**

Poster, abstract no. 107

Exploring Pediatric Oral Health With Indigenous Populations

Ogenchuk, MJ. Graham, H. Ramsden, V. Weiler, RL. Uswal, G.

Track 5: Environment II

Monday 13.08. 11:00 – 12:30. Classroom 13-1-48

1. Injuries and violence

Chairs: Hanley, B. and Sigurdardottir, S.

Oral, abstract no. 156

Interrelation of mental health and committing crimes against the sexual inviolability of minors in the Far North of the Russian Federation

Skripchenko, N. Korneeva, Y.

Oral, abstract no. 47

Childhood violence and mental health among indigenous Sami and non-Sami populations in Norway

Eriksen, AMA. Hansen, K. Berit, S. Tore, S. Stigum, H. Espen, B. Cecilie, J.

Oral, abstract no. 46

Childhood sexual abuse: consequences and holistic intervention

Sigurdardottir, S. Halldorsdottir, S. Bender, S. Agnarsdottir, G. Gudmundsdottir, B.

Oral, abstract no. 179

Mobilizing action on violence prevention in Eeyou Istchee: Learning from Elders, engaging youth, and creating supportive social environments for health throughout the life course

Andermann, A. Berlie, MC. Diamond, G.

Oral, abstract no. 10

A Public Health Perspective on Motor Vehicle Collisions in Yukon Territory, Canada

Mitri, M. Hanley, B. Salter, S.

Poster, abstract no. 247

Spatial Epidemiology Analysis of Pedal-Cycle Crashes in Anchorage, Alaska from 2013-2016

Griffith, K. Amstislavski, P. Dougherty, K.

Poster, abstract no. 110

Family Violence in Nunavut: A Scoping Review

Diakite, NA.

Poster, abstract no. 206

Opioid overdoses and deaths in Yukon Territory, Canada

Hanley, B. Sohn, JJ.

Monday 13.08. 13:30 – 15:00. Classroom 13-1-48

2. Substance abuse and gambling

Chairs: Niclasen, B. and McInnis, OA.

Oral, abstract no. 285

Trends in drinking patterns in Greenland from 2005 to 2014 – how is the relation to social correlates?

Katajavaara Sørensen, I. Dahl-Petersen, IK. Sørensen, I. Larsen, CVL.

Oral, abstract no. 119

Gambling among Greenlandic youth

Niclasen, B. Udesen, S. Lenskjold, T. Schnohr, C.

Oral, abstract no. 301

Why do young Greenlanders drink alcohol?

Niclasen, B. Schnohr, C.

Oral, abstract no. 14

Addressing Substance Use Issues in Nunavut: An Interdisciplinary Perspective

McInnis, OA. Sehti, C. Caudarella, A.

Oral, abstract no. 277

The Struggle goes North: Industry Pressures and the Northern Alcohol Research Study

Hanley, B. Hobin, E. Stockwell, T. Corriveau, A.

Oral, abstract no. 81

Developing a Personalized Youth Alcohol Assessment Tool

Ogenchuk, M. Hellsten, L. Marsh, B. Wild, C.

Tuesday 14.08. 11:00 – 12:30. Classroom 13-1-48

3. Occupational medicine and physical activity

Dahl-Petersen, IK. And Yurjeva, A.

Oral, abstract no. 303

Working as a construction worker, in colder regions of Sweden, increases the risk of cardiovascular mortality

Pettersson, HG.

Oral, abstract no. 11

Adaptation mechanisms of workers of extractive industries in the shift work organization in the Far North and the Arctic

Yurjeva, A. Korneeva, Y.

Oral, abstract no. 281

Time trends in Physical activity in Greenland and the relation to social indicators - Greenland Health Surveys 2005 to 2014

Dahl-Petersen, IK. Bjerregaard, P. Kjær Ersbøll, A. Larsen, CVL. Jørgensen, ME.

Poster, abstract no. 182

Motivating and value aspects of exercise dependence in middle age women

Zeliana, AN. Varentsova, IA. Korelskaya, IE. Kinal, A. Nechaeva, E.

Poster, abstract no. 223

Psychological quality oil and gas companies workers with different levels of meteorological reaction in the Arctic

Korneeva, Y. Simonova, N. Degteva, G. Kinal, A.

Poster, abstract no. 273

The psychological risk in professional work shift workers as an example oil and gas companies in the Arctic

Simonova, N. Korneeva, Y.

Poster, abstract no. 63

Comparative analysis of the psychological safety of shift workers in oil and diamond productions in the Far North and the Arctic

Korneeva, Y. Simonova, N. Tyulyubaeva, T.

Poster, abstract no. 225

Quality of life in industrial region of Yakutia (Russia)

Zacharova, R. Klimova, T. Fedorov, A. Ammosov, E. Baltakhinov, M.

Tuesday 14.08. 13:30 – 15:00. Classroom 13-1-48

4. Occupational medicine

Chairs: Logunov, KV. And Bønløkke, J.

Oral, abstract no. 174

Medical emergencies on board ships in polar waters

Logunov, KV.

Oral, abstract no. 244

Serum selenium levels in Greenlandic seafood factory workers. Is there a link with asthma?

Bønløkke, JH. Bang, M. Carstensen, O. Ebbehøj, N. Jørgensen, LH. Omland, Ø. Sigsgaard, T. Rasmussen, K.

Oral, abstract no. 8

A project to create a new interdisciplinary platform with focus on occupational health in the high north

Skandfer, M. Höper, A. Brustad, M.

Poster, abstract no. 133

"Healthy Workplaces" – an intervention. Promoting health among Greenlandic employees

Beck, ALM. Sørensen, I. Ingemann, C. Larsen, CVL.

Poster, abstract no. 9

A Public Health Approach to Cannabis Legalization in Yukon, Canada

Hanley, B. Zuccharini, C.

Poster, abstract no. 224

Quality Of Life and Health Self-Rate of Working-Aged Migrants to the North

Lobova, VA.

Poster, abstract no. 209

Patterns of mortality rates in Republic of Sakha (Yakutia)

Klimova, T. Kuzmina, A. Malogulova, I.

Wednesday 15.08. 11:00 – 12:30. Classroom 13-1-48

5. Telemedicine

Chairs: Gillis, D. and Skifte, T.

Oral, abstract no. 272

The Promise of Telehealth for Northern and Indigenous Communities

Exner-Pirot, H. Butler, L. Berry, L.

Oral, abstract no. 255

Telemedicine Network in the Arctic Region of the Russian Federation

Kungurtsev, S. Ilin, V. Bye, SM. Zubov, L. Mikova, N.

Oral, abstract no. 232

Remote medical treatment for patients with cardiovascular diseases in the Arctic zone of the Russian Federation

Gorbunova, E. Ilin, V. Zubov, L. Kungurtsev, S. Bye, SM.

Oral, abstract no. 70

Critical care in remote communities through telehealth

Jong, M.

Oral, abstract no. 36

Bridging the Digital Divide in the Circumpolar North with Wireless Mobile Mesh Networks: a community-led participatory project in Rigolet, Nunatsiavut

Gillis, D. Durish, N. Seymour, F. Rourke, K. Cook, O. Shiwak, I. Flowers, C. Wood, M. Rigolet Inuit Community Government, . Harper, S. Cunsolo, A. Ernst, J.

Track 6: Chronic diseases and genetics

Monday 13.08. 11:00 – 12:30. Classroom 13-1-36

1. Cardiovascular diseases

Chairs: Voevoda, M. and Rønn, PF.

Oral, abstract no. 278

The use of big data for assessment of hypertensive care quality in Greenland

Skovgaard, N. Kleinschmidt, K. Pedersen, ML.

Oral, abstract no. 202

Omega-3 fatty acids and risk of first cardiovascular event in Greenlandic Inuit: A prospective cohort study.

Senftleber, NK. Albrechtsen, A. Lauritzen, L. Diaz, LJ. Rønn, PF. **Jørgensen, ME.**

Oral, abstract no. 141

Hypertension incidence: gender features in population with vital exhaustion. MONICA-psychosocial epidemiological study

Panov, D. Gagulin, I. Gromova, E. Gafarova, A. Krymov, E. Gafarov, V. **Voevoda, M.**

Oral, abstract no. 66

Control of the functional state of the cardiovascular system of patients with arterial hypertension in the Arctic zone during their health (Nordic) walking with poles

Illin, V. Tereshchenko, I. **Kovyazin, A.**

Oral, abstract no. 131

Health of Yakutia Indigenous Peoples in the modern world

Romanova, A. Egorova, A. Stepanov, K.

Poster, abstract no. 50

Chronostructure of blood pressure in workers engaged in monthly round-trip sojourns to the Arctic

Shurkevich, N. Vetoshkin, A. Gapon, L. Gubin, D.

Poster, abstract no. 121

Gender differences in carotid artery and heart remodeling in workers engaged in monthly round-trip sojourns to the Arctic

Vetoshkin, A. Shurkevich, N. Gapon, L. Velizhanin, S.

Poster, abstract no. 122

Gender features of myocardial infarction and stroke in population with sleep disorders in Russia / Siberia: MONICA-psychosocial epidemiological study

Gafarova, A. Gagulin, I. Gromova, E. Panov, D. Krymov, E. Gafarov, V. **Voevoda, M.**

Monday 13.08. 13:30 – 15:00. Classroom 13-1-36

2. Diabetes

Chairs: Jørgensen, ME. And Pedersen, ML.

Oral, abstract no. 181

Monitoring of treatment of patients with diabetes mellitus in remote regions of the Arctic zone of the Russian Federation using electronic mobile app

Arteeva, R. Zapalova, A. Zubov, L. Bye, SM.

Oral, abstract no. 33

Birth weight and glucose metabolism in adulthood among Greenlandic Inuit

Rønn, PF. Jørgensen, ME. Smith, LS. Bjerregaard, P. Dahl-Petersen, IK. Larsen, CVL. Andersen, AMN. Grarup, N. Andersen, G.

Oral, abstract no. 27

Are health inequalities rooted in the past? Income inequalities in metabolic syndrome decomposed by childhood conditions in northern Sweden

Mosquera, PA. San Sebastian, M. Ivarsson, A. Weinehall, L. Gustafsson, PE.

Oral, abstract no. 237

Risk of cardiovascular disease in Greenlandic Inuit with diabetes, defined by different diagnostic criteria

Byberg, S. Tvermosegaard, M. Larsen, CVL. Dahl-Petersen, IK. Rønn, PF. Bjerregaard, P. Jørgensen, ME.

Oral, abstract no. 83

Diabetes prevalence and incidence among Alaska Native People 2002-2005 vs 2012-2015

Narayanan, M. Schraer, C. Koller, K. Thompson, J.

Poster, abstract no. 218

Prevalence of metabolic syndrome in a multiethnic population in Northern Norway - The SAMINOR Study

Michalsen, VL. Kvaløy, K. Svartberg, J. Melhus, M. Broderstad, AR.

Poster, abstract no. 212

Picturing food insecurity: Using photographs to explore how users of food pantries eat

Burke, T. Walch, A. Byam, B. Gates, K.

Poster, abstract no. 30

Bases of creation of new food in Arctic territories

Konstantin, S. Uliana, L.

Tuesday 14.08. 11:00 – 12:30. Classroom 13-1-36

3. Genetics

Chairs: Arbour, L. and Barashkov, N.

Oral, abstract no. 28

Are Inuit newborns homozygous for the CPT1A P479L variant at increased risk for early neonatal hypoglycemia?

Hildes Ripstein, E. Collins, S. Thompson, JR. Barker, K. Arbour, L. Greenberg, C.

Oral, abstract no. 214

Population genomics of circumpolar populations

Stepanov, V. Vagaitseva, K. Zarubin, A. Kharkov, V.

Oral, abstract no. 76

Cytokine profile in aboriginals in Sakha Republic (Yakutia) with juvenile idiopathic arthritis.

Vinokurova, FV. **Burtseva, TY.** Nicolaev, VM. Argunova, VM. Chasnyk, VG. Kostik, MM.

Oral, abstract no. 197

Novel pathogenic variant in the POU3F4 gene associated with the X-linked deafness-2 (DFNX2) in Yakut family (Eastern Siberia, Russia)

Barashkov, N. Klarov, L. Solovyev, A. Konnikova, E. Romanov, G. Tobokhov, A. Morozov, I. Bondar, A. Posukh, O. Dzhemileva, L. Khusnutdinova, EV. Fedorova, S.

Poster, abstract no. 117

Frequency of a common splice site mutation in sucrase-isomaltase in Greenland.

Eiberg, H. Lind, O. Kern, P. Nielsen, IM. Bisgaard, ML.

Poster, abstract no. 118

Frequency of gene alleles - diabetogenic markers in Nenets population

Kuraeva, TL. **Zubov, LA.** Sibileva, EN. Imanova, ON. Stepanova, SM. Titovich, EV.

Tuesday 14.08. 13:30 – 15:00. Classroom 13-1-36

4. Diet and nutrition I

Chairs: Burton, CJ. And Jerome, SP.

Oral, abstract no. 68

Creating a Social Media Strategy for the Alaska Food Policy Council

Burton, CJ. Snyder, E. Garcia, G. Amstislavski, P. Lhotka, L.

Oral, abstract no. 276

The significance of sharing foods amongst low-income, non-Native Alaskan food pantry users

Burke, T. Byam, B.

Oral, abstract no. 269

The opportunities for, and challenges of Geographic Indications in supporting Indigenous Food Systems in Canada

Appavoo, D. Korzun, M.

Oral, abstract no. 186

"My stomach recognizes this food": A One Health approach to increasing access to traditional food in Nunavut hospitals and community programs

Caughey, A. Kilabuk, P. Joy, W. MacRury, A. Koonoo, T. Barker, K. Gonzalez, N. Sargeant, J.

Oral, abstract no. 2

25(OH)D levels in trained versus sedentary university students at 64° north

Jerome, SP. Sticka, KD. Schnurr, TM. Mangum, SJ. Reynolds, AJ. Dunlap, KL.

Oral, abstract no. 99

Environmental metals in subsistence species of coastal Chukotka, Russian Arctic.

Dudarev, AA. Chupakhin, VS.

Wednesday 15.08. 11:00 – 12:30. Classroom 13-1-36

5. Diet and nutrition II

Chairs: Galloway, T. and Brustad, M.

Oral, abstract no. 139

How to estimate the intake of “fish oils” in general population health surveys

Bjerregaard, P. Larsen, CVL. Olesen, I.

Oral, abstract no. 112

Food basket analyses – a novel approach to promotion of a healthy diet in Greenland

Bjerregaard, P. Larsen, CVL. Olesen, I.

Oral, abstract no. 267

The intersection of market-driven food subsidy with social, health and transportation policy in Canada’s north: structural elements constrain health and well-being for Inuit

Galloway, T.

Oral, abstract no. 113

Food for thought: Understanding transitions in Greenland fish monitoring practices

Ohlrogge, EC. Cesuroglu, T. Ingemann, C. Larsen, CVL.

Oral, abstract no. 297

Vitamin D status in a multiethnic population of Northern Norway – The SAMINOR 2 Clinical Survey

Petrenya, N. Lamberg-Allardt, C. Melhus, M. Broderstad, AR. **Brustad, M.**

Track 7: Infectious diseases

Monday 13.08. 11:00 – 12:30. Nielsine Nielsen auditory

1. Tuberculosis

Chairs: Sjøborg, B. and Schertzer, A.

Oral, abstract no. 291

Unhealthy Policies: The Government of Canada's response as a factor in the high rates of tuberculosis in Indigenous populations 1945-2015

Thomas, GS.

Oral, abstract no. 287

Tuberculosis program performance indicators in a remote Labrador Inuit community

Rahman, MD. Baikie, M. Doody, S. Buckle, TY.

Oral, abstract no. 62

Community wide screening for active and latent (LTBI) tuberculosis (TB) in Qikiqtarjuaq, Nunavut, Canada in 2018

Schertzer, A. Barker, K. Lavallee, C.

Oral, abstract no. 279

The use of emergency management principles to coordinate tuberculosis screening in a remote arctic community

Patterson, M.

Oral, abstract no. 91

Empowering Inuit communities to eliminate TB in Nunavut: piloting a community-based Initiative

Kiddell-Monroe, R. Devine, C. Saranchuk, P. Nash, M.

Poster, abstract no. 286

Tuberculosis disease features in relation to M.tuberculosis genetic clusters in the Sakha Republic (Yakutia)

Vinokurova, M. Evdokimova, N. Pavlov, NY. Alekseeva, G. Mordovskaya, L. Kravchenko, A. Zhdanova, S. Ogarkov, O.

Poster, abstract no. 239

Role of surgery in management of multidrug-resistant tuberculosis in the Sakha Republic (Yakutia), Northern Russia

Vinokurova, M. Kravchenko, A. Kondakov, S. Yakovleva, L.

Poster, abstract no. 187

Mycobacterium tuberculosis drug resistance in patients with tuberculosis/syphilis co-infection in a northern region of Russia

Mordovskaya, L. Vinokurova, M. Alekseeva, S. Pavlov, N.

Monday 13.08. 13:30 – 15:00. Nielsine Nielsen auditory

2. Sexually transmitted infections

Chairs: Johansen, MB. and Jessen, C.

Oral, abstract no. 124

Gonorrhoea in Greenland – trends and challenges in a Historical Perspective

Berntsen, S. Mulvad, G. Pedersen, ML.

Oral, abstract no. 125

Gonorrhoea in Greenland: Geographic differences in diagnostic activity and incidence of gonorrhoea in 2015

Homøe, AS. Berntsen, S. Pedersen, ML.

Oral, abstract no. 130

Health Native Youth Web Portal: Disseminating evidence-based sexual health programs for Indigenous youth

Jessen, C. Shegog, RR. Markham, C. Torres, J. Gorman, G. Gaston, A. Williamson, J. Craig Rushing, S.

Oral, abstract no. 282

Timiga, Ikumajuq: Reimagining Sexual Health Programming for Inuit Youth through the Arts

Sallaffie, MC. Sallaffie, M.

Oral, abstract no. 44

Checkup Project: a social marketing campaign using social media to influence the norm around screening for sexually transmitted and blood borne infections in Inuit youth

Morin, V. Le Gresley, F. D'Astous, C. Veilleux, S. Poirier, JE. Proulx, JF.

Oral, abstract no. 142

Ikajurniq: An Inuit Cascade of Care Framework for Sexually Transmitted and Blood Borne Infections

O'Hearn, T. Ashton, S.

Tuesday 14.08. 11:00 – 12:30. Nielsine Nielsen auditory

3. HIV, HPV and viral hepatitis

Chairs: McMahon, B. and Rex, KF.

Oral, abstract no. 189

Naturally Curious: Engaging Inuit Youth to Talk About Sexually Transmitted and Blood Borne Infections

Ashton, S. Enuaraq, S.

Oral, abstract no. 1

10-year all-cause mortality among Greenlanders with frequent chronic Hepatitis B infection

Rex, KF. Andersen, S. Krarup, H.

Oral, abstract no. 136

Hepatitis C Infection in Pregnant American Indian and Alaska Native Women; 2003-2015

Nolen, L. O'Malley, G. Seeman, S. Bruden, D. Apostolou, A. McMahon, B. Bruce, M.

Oral, abstract no. 238

Risk-Based Prenatal Hepatitis C Testing Practices, Alaska 2013-2016

Nolen, L. Gustin, C. Seeman, S. Murphy, N. Bruce, M. Bruden, D. Tiesinga, J. Truitt, S. McMahon, B.

Oral, abstract no. 308

Yukon Hepatitis C Epidemiologic Profile

Bouchouar, E. Strudwick, L. **Hanley, B.** Stannard, C.

Poster, abstract no. 143

Impact of high protein intake on viral load and hematological parameters in HIV-infected Khanty indigenous people

Butorov, E.

Poster, abstract no. 23

Antibody Levels and Protection after Hepatitis B Vaccine: Results of a 35 year Follow-up Study and Response to a Booster Dose

Bruce, M. Seeman, S. Hurlburt, D. Morris, J. Bruden, D. Thompson, G.V. Lecy, D. Simons, B. Rudolph, K. Spradling, P. Hennessy, T. McMahon, B.

Poster, abstract no. 210

Persistence of human papillomavirus (HPV) 16, 18, and 52 variants in Inuit women in Northern Quebec, Canada

Gauthier, B. Cerigo, H. Coutlee, F. Franco, E.L. Brassard, P.

Tuesday 14.08. 13:30 – 15:00. Nielsine Nielsen auditory

4. Gastrointestinal and food-borne infections

Chairs: Jenkins, E. and Nelson, C.

Oral, abstract no. 90

Emerging issues with Echinococcus in Canada – a One Health approach.

Jenkins, E. Schurer, J. Gesy, K. Bouchard, E. Kolapo, T. Revell, S. Wu, J. Bassil, M.

Oral, abstract no. 37

Building a Nunavut Based Trichinella Detection Program

Edmunds, SP. Shirley, J. Arreak-Kullualik, J.

Oral, abstract no. 217

Preliminary results from implementation of in-territory molecular testing for gastrointestinal pathogens at the Qikiqtani General Hospital, Nunavut.

Miners, AA. Yansouni, CP. Shalini, D. Barker, B. Nishi, W. Kim, H. Serra, EV. Marchand, S. Barker, K. Goldfarb, D.

Oral, abstract no. 228

Reinfection Twelve Years after Successful Eradication of Helicobacter pylori in Alaska

Bruce, M. Seeman, S. Raczniak, G. Thompson, G. Bruden, D. Morris, J. Sacco, F. Hurlburt, D. Klejka, JK. McMahon, B.

Oral, abstract no. 55

Clinical outcomes in patients with gastroduodenal diseases in Yakutia with cagA-positive and cagA-negative strains of *Helicobacter pylori*

Gotovtsev, N. Barashkov, N. Borisova, T. Pak, M. Alexeeva, M. Innokentieva, N. Loskutova, K. Pshennikova, V. Rafailov, A. Lekhanova, S. Fedorova, SL.

Poster, abstract no. 140

Hydro-climatic Change Impact on Water-related Disease

Ma, Y. Bring, A.

Poster, abstract no. 78

Detection of *Vibrio* spp. in commercial fishermen.

Nelson, CM. Bulzacchelli, MT. Davis, MF.

Poster, abstract no. 31

Best practices in tuberculosis prevention implemented in the Northern Circumpolar regions - from 2007 to 2017

Michelsen, SW. Koch, A. Soborg, B.

Wednesday 15.08. 11:00 – 12:30. Nielsine Nielsen auditory

5. Respiratory and other infections

Chairs: Bruce, M. and Koch, A.

Oral, abstract no. 53

Climate change impact on the epidemiology of infectious diseases in the Arctic. Linking landscape effects of climate change to the geographic spread of zoonotic infectious diseases.

Berggren, CH. Thierfelder, T. Evengård, B.

Oral, abstract no. 100

Epidemiology of invasive bacterial diseases among children under 2 years of age in northern Canada, 2011 to 2015

Huang, G. Li, AY. Martin, I. Demczuk, VHB. Tsang, R.

Oral, abstract no. 215

Population-based study of incidence, risk factors, and mortality for invasive pneumococcal disease in Greenland

Navne, JE. Børresen, ML. Slotved, HC. Hoffmann-Petersen, IT. Andersson, M. Hoffmann, S. Melbye, M. Ladefoged, K. **Koch, A.**

Oral, abstract no. 263

The Epidemiology of *Haemophilus influenzae* serotype a disease in the North American Arctic, 2000-2016

Bruce, M. Zulz, T. Johnson, K. Hurlburt, D. Rudolph, K. Debyle, C. Tsang, R.

Oral, abstract no. 250

Successful Prevention of Congenital Syphilis during 2016 Outbreak in the Kivalliq Region of Nunavut, Canada; Rapid mobilization of Community Resources and Regional Strategies.

Hildes-Ripstein, GE. Tavarro, A. Hernandez, L. Poliquin, V. Poliquin, PG. Patterson, M. Pawa, J. Barker, K. Singh, A.

Oral, abstract no. 216

Post-Infectious Fatigue Following Puumala Virus Infection: A Study From Northern Sweden.

Furberg, M. Anticono, C. Schumann, B.

Track 8: Mother and child health

Monday 13.08. 11:00 – 12:30. Classroom 13-1-62

1. Child health I

Chairs: Seerup, R. and Burtseva, TE.

Oral, abstract no. 127

Growth charts from birth to 17 years for Native, Yakut and European children-inhabitants of Yakutia
Chasnyk, VG. Burtseva, TE. Odland, JØ. Savvina, MS. Evseeva, SA. Avrusin, SL. Sinelnikova, EV. Bobko, JN. Solodkova, IV. Senkevich, JI. Barishek, EV.

Oral, abstract no. 128

Growth of children in Greenland exceeds the World Health Organization growth charts
Kløvgaard, M. Nielsen, NO. Sørensen, TL. Bjerregaard, P. Olsen, B. Júliusson, PB. Roelants, M. Christensen, HT.

Oral, abstract no. 48

Children in Greenland: Disease patterns and contacts to the health care system
Kløvgaard, M. Nielsen, NO. Sørensen, TL. Bjerregaard, P. Olsen, B. Christensen, HT.

Oral, abstract no. 302

Why Fetal Alcohol Spectrum Disorder (FASD) is Important for Circumpolar Health
Drossos, A.

Oral, abstract no. 75

Current health status of children living in Yakutia
Burtseva, TE. Chasnyk, VG. Odland, JØ. Savvina, MS. Evseeva, SA.

Oral, abstract no. 299

Weight among children in Nuuk at school entry from 2011-2016
Budtz, AES. Lynge, AR. Budtz, CS. Pedersen, ML.

Monday 13.08. 13:30 – 15:00. Classroom 13-1-62

2. Child health II

Chairs: Michelsen, SW. and Collins, S.

Oral, abstract no. 191

Neurologic diseases and mortality in children and adolescents with epilepsy in Greenland and Denmark - a register based study.
Mistry, JM. Andersson, M. Soborg, B. Koch, A. Miranda, M. Børresen, ML.

Oral, abstract no. 188

National vision screening of Greenlandic schoolchildren. Preliminary results.
Duelund, N. Jensen, H. Møller, HU.

Oral, abstract no. 64

Congenital Anomalies in Nunavut 2010-2014: What has changed over the last 25 years?
Morello, M. Collins, S. Selina, K. Healey, G. Edmunds-Potvin, S. Doucette-Issaluk, M. Barker, K. Arbour, L.

Oral, abstract no. 135

Heart disease among Greenlandic children and young adults: A nationwide cohort study

Tindborg, M. Michelsen, SW. Andersson, M. Juul, K. Geisler, UW. Wohlfahrt, J. Soborg, B. Koch, A.

Oral, abstract no. 120

Gender and life satisfaction: A mixed methods study among Greenlandic adolescents aged 13-15

Frid, KEF.

Poster, abstract no. 284

Trends and patterns of congenital heart diseases in children of Yakutia in 2001 - 2013

Nelunova, TI. Burtseva, TE. Avrusin, SL. Sinelnikova, EV. Solodkova, IV. Chasnyk, VG.

Tuesday 14.08. 11:00 – 12:30. Classroom 13-1-62

3. Child and maternal health

Chairs: Schwarzburg, LL. And Wielsøe, M.

Oral, abstract no. 183

"Moving Circumpolar Health Forward" in indigenous communities, with maternal and infant health leading the way

Schwarzburg, LL. Ellefson, K.

Oral, abstract no. 261

The EHLF Analysis: Exploring reproductive health inequity and environmental health literacy in Australian and Greenlandic Indigenous communities

Ireland, S. Montgomery-Andersen, R.

Oral, abstract no. 149

Increased number of daily cigarettes smoked during pregnancy decreased odds of preeclampsia: A Murmansk County Birth Registry study

Kharkova, O. Odland, JØ.

Oral, abstract no. 32

Biomarker Feedback Pilot Intervention for Tobacco Cessation among Pregnant Alaska Native Women

Patten, C. Flanagan, C. Hiratsuka, V. Koller, K. Willetto Wolfe, A. Murphy, N. Benowitz, N. Hatsukami, D. Hughes, C. Thomas, T.

Oral, abstract no. 265

The Greenlandic ACCEPT Birth Cohort: data and future studies

Bonefeld-Jørgensen, EC. Ghisari, M. Wielsøe, M. Long, M.

Poster, abstract no. 29

Availability of obstetric beds and women's reproductive health issues in Yakutia

Douglas, NI. Chasnyk, VG. Burtseva, TE. Pavlova, TY. Odland, JØ. Savvina, MS. Evseeva, SA.

Tuesday 14.08. 13:30 – 15:00. Classroom 13-1-62

4. Hearing loss and otitis media

Chairs: Homøe, P. and Wiletto Wolfe, A.

Oral, abstract no. 13

Addressing Childhood Hearing Loss Disparities in the Far North: Lessons from an Ongoing Community Randomized Trial in Northwest Alaska

Emmett, SD. Robler, SK. Wang, NY. Labrique, AB. Gallo, JJ. Hofstetter, P.

Oral, abstract no. 134

Hearing impairment among Greenlandic youth - HBSC Greenland 2018

Schnohr, C. Rasmussen, KE. Jensen, RG. Niclasen, B.

Oral, abstract no. 3

A Community-Designed Intervention for a Randomized Controlled Trial Addressing Childhood Hearing Loss in Rural Alaska

Robler, SK. Emmett, SD. Wang, NY. Gallo, JJ. Labrique, AB. Hofstetter, P.

Poster, abstract no. 260

The effects of ventilation tubes among Greenlandic children - The SIUTIT Trial

Demant, M. Jensen, RG. Jakobsen, JC. Gluud, C. Fleischer, JG. Homøe, P.

Wednesday 15.08. 11:00 – 12:30. Classroom 13-1-62

5. Maternal health

Chairs: Fyfe, T. and Montgomery-Andersen, R.

Oral, abstract no. 157

Inuit Childbirth in Canada: An Exploration of Place, Culture, and Health in Baffin Island, Nunavut

Brubacher, LJ. Tatty, N. Healey, G. Dewey, CE. Cunsolo, A. Humphries, S. Harper, SL.

Oral, abstract no. 219

Prevention of RhD alloimmunization in Northern British Columbia: An interpretive description

Fyfe, T. Lavoie, J. Payne, G. Banner, D. Callaghan, R. Johnston, S.

Oral, abstract no. 306

Worlds Apart: Exploring the logics of Indigenous women's planned birthplace locations in remote arctic Greenland and tropical Australia

Montgomery-Andersen, R. Ireland, S.

Oral, abstract no. 42

Cesarean section rates in Alaska: What's going on in the 49th State?

Groen, RSG. Murphy, NJ. Kushner, AL.

Oral, abstract no. 194

Northern Plights: The Scope of Postpartum Hemorrhage in Circumpolar Inuit

Doherty, ST. Asghari, S. Heeley, T. Hall, A. Swab, M.

Oral, abstract no. 292

Unwanted Pregnancies in Greenland – a situational analysis

Trulsson, AMC.

Track 9: Ageing, nursing and cancer

Monday 13.08. 11:00 – 12:30. Classroom 13-1-80

1. Ageing

Chairs: Andersen, S. and Horlick, S.

Oral, abstract no. 192

Northern Indigenous Kehtehayak (elderly) Caregiving

Beatty, B. McKay, J.

Oral, abstract no. 153

Individual, housing and community factors associated with healthy aging in Inuit communities in Canada

Baron, M. Riva, M. Fletcher, C.

Oral, abstract no. 211

Perspectives from community members and health service providers on the quality of End-of-Life care for Nunavummiut: preliminary findings from the Nunavut End of Life Care Research Project

Horlick, S. Amagoalik, L. Cherba, M. Feltaous, E. Edmunds-Potvin, S. Elliott, S. Bellefontaine, K. Colepaugh, J. Cole, M. Woodgate, R. Healey, G. Galloway, T.

Oral, abstract no. 246

Solutions to improve End-of-Life care for residents of Canadian Arctic communities: insights from the Nunavut End of Life Care Research Project

Horlick, S. Amagoalik, L. Cherba, M. Feltaous, E. Edmunds-Potvin, S. Elliott, S. Bellefontaine, K. Colepaugh, J. Cole, M. Woodgate, R. Healey, G. Galloway, T.

Poster, abstract no. 307

Wuskiwiy-tan! (Let's Move!): Aging well in a northern Saskatchewan Métis community

Oosman, S. Abonyi, S. Lavallee, A. Durocher, L. Roy, T.J.

Poster, abstract no. 20

An examination of health determinants and status of older Aboriginal and non-Aboriginal peoples in Canada using national survey data

Abonyi, S. Karunanayake, C. Khanam, U. Pahwa, P.

Poster, abstract no. 264

The Evolution of Chronic Primary Angle Closure Glaucoma in the Inuit and Oriental Eye

Price, PA. Lannon, M.

Monday 13.08. 13:30 – 15:00. Classroom 13-1-80

2. Nursing

Chairs: Hounsgaard, L. and Mehus, G.

Oral, abstract no. 268

The nature of nursing practice in Canada's northern territories

MacLeod, ML. Moffitt, P. Garraway, L. Jonatansdottir, S.

Oral, abstract no. 152

Indigenous Peoples Perspective in Education. Nurse Education in Norway without knowledge about indigenous peoples?

*Eriksen, LT. Bongo, BA. **Mehus, G.***

Oral, abstract no. 198

Nursing Education's Response to the Canadian Truth and Reconciliation Commission Calls to Action: Community Engagement and Reconciliation in one Canadian University College of Nursing

Berry, LE. Butler, LJ. McDougall, P. Exner-Pirot, H.

Oral, abstract no. 205

Online teaching of nursing students from Greenland in scientific subjects, - experiences and reflections

Karas, N.

Oral, abstract no. 199

Nursing research in rural areas in Norway; a scoping review

*De Smedt, S. **Mehus, G.***

Poster, abstract no. 21

An exploration of medication events in a Canadian undergraduate nursing program.

Pender, K. Burse, N.

Poster, abstract no. 195

Norwegian and Sami Nurses experience in health meeting with sami patients in north sami area

Engnes, JI.

Tuesday 14.08. 11:00 – 12:30. Classroom 13-1-80

3. Cancer I

Chairs: Roik, E. and Chan, J.

Oral, abstract no. 245

Sociodemographic and behavioral characteristics are associated with level of knowledge about cervical cancer prevention.

Roik, E. Odland, JØ.

Oral, abstract no. 12

Addressing Challenges to Cancer Control in the North: Culturally Relevant Online Education with Alaska's Community Health Workers

Cueva, K. Cueva, M. Revels, L. Dignan, M.

Oral, abstract no. 280

Time to treatment and outcomes among Inuit patients from Nunavut treated with palliative radiotherapy at The Ottawa Hospital.

Chan, J. Linden, K. McGrath, C. Renaud, J. Doering, P. MacDonald, S. Gaudet, M. Pantarotto, J. Asmis, T. Dennis, K.

Oral, abstract no. 196

Not Deciding Alone: A field-test of peer support shared decision-making with Inuit in cancer care

Jull, JE.

Poster, abstract no. 19

An analysis of media representations of cancer among residents of Canada's Arctic: preliminary findings

Cherba, M. Feltaous, E. Horlick, S. Amagoalik, L. Edmunds-Potvin, S. Elliott, S. Bellefontaine, K. Colepaugh, J. Cole, M. Woodgate, R. Healey, G. Galloway, T.

Poster, abstract no. 40

Cancer Screening in Northern Canada: An Analysis of Current Practices

Beaudry, A. Orr, P.

Poster, abstract no. 24

Approaching with humility: overcoming disparities in cancer screening in Yukon First Nations

Lamothe, D. Hanley, B. Edelman, S.

Tuesday 14.08. 13:30 – 15:00. Classroom 13-1-80

4. Cancer II

Chairs: Odgaards, M. and Lamothe, DM.

Oral, abstract no. 35

Breast cancer risk in Greenland: Associations with diet, environmental exposure, and genetics.

Wielsøe, M. Bonefeld-Jørgensen, EC.

Oral, abstract no. 203

Oncological treatment and outcome of colorectal cancer in Greenland

Odgaard, M. Lohse, N. Juhl, A. Bæksgaard, L.

Oral, abstract no. 145

Improved survival of head and neck cancer patients in Greenland

Lawaetz, M. Jensen, RG. Friberg, J. Herlow, L. Brofeldt, S. Fleischer, J. **Homøe, P.**

Oral, abstract no. 58

Colorectal cancer in Greenland (1987-2017)

Mousavi, N. Bernth-Andersen, S. Timmermans, V. Koch, A. Heegaard, S.

Oral, abstract no. 161

Inuusinni Aqqusaaqtara: An Inuit Cancer Project

Ashton, S. Torchetti, T.

Poster, abstract no. 249

Stomach Cancer Trends Across the North American Arctic

Simkin, J. O'Brien, D. Hannah, H. Nash, S. Corriveau, A. Hanley, B. Bruce, M. Ogilvie, G. Elliott, C.

Poster, abstract no. 94

Enhancing access to cancer screening in Yukon First Nation Communities

Lamothe, DM. Hanley, B. Edelman, S.

Wednesday 15.08. 11:00 – 12:30. Classroom 13-1-80

5. Parental education

Chairs: Moffitt, PM. And Nilsen, SE.

Oral, abstract no. 293

Uptake and Impact of Prenatal Education in Northwestern Ontario: Mother's Perspective

Møller, H. Alzghoul, M. Wakewich, P. **Sameshima, P.** Gupta, N.

Oral, abstract no. 165

Learning from Mothers and Grandmothers about Breastfeeding in the Northwest Territories Canada

Moffitt, PM. Lakhani, S. Cruz, S.

Oral, abstract no. 160

Inunnguiniq Parenting Program: A made-in-Nunavut program based on Inuit knowledge

Healey, G. **Tagalik, S.**

Oral, abstract no. 87

Early prevention in Greenland: MANU 0-2 years, a parent education program

Kuhn, RL. Larsen, CVL. Ingemann, C.

Oral, abstract no. 243

Selecting performance indicators for maternity care in a circumpolar context: a modified Delphi approach

Rich, R. Chatwood, S. D'Hont, T. Linton, J. Veillard, J. Murphy, K.

Oral, abstract no. 275

The SamBa study Growing up in the Arctic - a Longitudinal study of early childhood development and health in indigenous and non-indigenous children

Nilsen, SE. Kvernmo, S.

Track 10: Workshops

Monday 13.08. 13:30 – 15:00. Classroom 13-1-83

1. Rural suicide prevention

Chair: Wexler, L.

Workshop presentation, abstract no. 240

Rural Arctic Suicide Prevention: A Workshop to Try Promoting Community Conversations About Research to End Suicide (PC CARES)

Wexler, L. McEachern, D. Kirk, T. Moto, R. Pungowiyi, P. Sampson, EV.

Monday 13.08. 13:30 – 15:00. Classroom 13-1-83

2. Age and wellbeing in the Arctic

Chair: Jensen, T.

Workshop presentation, abstract no. 227

Rehabilitation in Everyday Life: Citizens' Perspectives on Old Age Life in Nuuk – Challenges and Possibilities in the Professional Support

Aagaard, T.

Workshop presentation, abstract no. 201

Old age in Greenland – negotiating identity and place in society

Siren, A.

Workshop presentation, abstract no. 123

Getting around, doing activities. Everyday practices and challenges of mobility

Nørtoft, K. Carroll, S.

Workshop presentation, abstract no. 231

Remembering life

Schlütter, MM. Dalsgård, L. Hounsgaard, L. Jensen, TY.

Workshop presentation, abstract no. 34

Body composition and basic movements' ability of elderly female population of Arctic cities (Arkangelsk Region)

Nechaeva, E.

Monday 13.08. 13:30 – 15:00. Classroom 13-1-63

3. Circumpolar suicide prevention

Chair: Cox, S.

Workshop presentation, abstract no. 226

Reducing the Incidence of Suicide in Indigenous Groups – Strengths United through Networks

Delgado, R. Pringle, B. Crawford, A.

Workshop presentation, abstract no. 65

Continuing Our Unity: Advancing Indigenous Suicide Prevention in the Circumpolar Arctic

Larsen, CVL. Crawford, A. Petrusek MacDonald, J. Ford, S. Durkalec, A. Hackett, C.

Workshop presentation, abstract no. 220

Project CREATEs: Circumpolar Resilience, Engagement and Action Through Story

Crawford, A. Larsen, CVL. Petrusek MacDonald, J. Ford, S.

Tuesday 14.08. 11:00 – 12:30. Classroom 13-1-83

4. UArctic and Arctic Council

Chairs: Mulvad, G. and Hennessy, T.

Workshop presentation, abstract no. 288

UArctic's Thematic Networks Health and Well-being in the Arctic

Mulvad, G. Emelyanova, A.

Workshop presentation, abstract no. 257

The 2018 survey among the members of the UArctic Thematic Network "Health and Well-being in the Arctic"

Emelyanova, A.

Workshop presentation, abstract no. 155

International Circumpolar Partnerships in One Health; Role of the Arctic Council

Hennessy, T. Corriveau, A. Rautio, A. Cox, S. Glasser, J.

Tuesday 14.08. 11:00 – 12:30. Classroom 13-1-63

5. Research is reflexive and relational: promoting and practicing ethical research with indigenous populations

Chair: Bull, J.

Workshop presentation, abstract no. 235

Research is reflexive and relational: promoting and practicing ethical research with indigenous peoples

Bull, J.

Tuesday 14.08. 13:30 – 15:00. Classroom 13-1-83

6. Building on strengths in Naujaat

Chair: Anang, P.

Workshop presentation, abstract no. 38

Building on Strengths in Naujaat – a Youth Initiative: First results

Anang, PJ. Haqpi, E. Putulik, S. Kopak, L. Bronson, M. Gordon, EV. Gottlieb, N.

Wednesday 15.08. 11:00 – 12:30. Classroom 13-1-83

7. Health system discussion

Chair: Politis, C.

Workshop presentation, abstract no. 173

Measuring the workload of family doctors at Ongomiizwin Health Services in Manitoba and Nunavut: An advocacy tool for change in a complex health care system

Goulet, S. Jamieson, R. Dawson, T. MacKinnon, M. Myeryz-Dixon, B. Nguyen, H.

Workshop presentation, abstract no. 305

Working Together to Support Indigenous Health and Wellness in Northwest Territories

Politis, C. Kandola, K. Tobin, P.

Wednesday 15.08. 11:00 – 12:30. Classroom 13-1-63

8. Sustainable development goals in a thriving Arctic

Kanayurak, N.

Workshop presentation, abstract no. 253

Sustainable Development Goals in a Thriving Arctic

Kanayurak, N. Larsen, C. Healy, G.

Author and session index

Page numbers for authors

<i>Abass, K.</i>	15; 16	<i>Baker, K.</i>	4; 8
<i>Abonyi, S.</i>	10; 35	<i>Baltakhinov, M.</i>	20
<i>Adlard, B.</i>	15	<i>Balto, AM.</i>	8
<i>Affleck, Z.</i>	6	<i>Bang, M.</i>	20
<i>Afkham, A.</i>	12	<i>Banner, D.</i>	33
<i>Agnarsdottir, G.</i>	18	<i>Barashkov, N.</i>	24; 29
<i>Albrechtsen, A.</i>	22	<i>Barishek, EV.</i>	31
<i>Alekseeva, G.</i>	26	<i>Barker, B.</i>	28
<i>Alekseeva, S.</i>	26	<i>Barker, K.</i>	23; 24; 26; 28; 30; 31
<i>Alexeeva, M.</i>	29	<i>Baron, A.</i>	6
<i>Allen, J.</i>	13	<i>Baron, M.</i>	35
<i>Allen, MD.</i>	15	<i>Basmakova, I.</i>	15
<i>Alzghoul, M.</i>	38	<i>Bassil, M.</i>	28
<i>Amagoalik, L.</i>	35; 37	<i>Baumgartner, J.</i>	16
<i>Ammosov, E.</i>	20	<i>Baviskar, S.</i>	6
<i>Amstislavski, P.</i>	15; 16; 18; 24	<i>Beans, J.</i>	11
<i>Anang, PJ.</i>	40	<i>Beardsall, K.</i>	12
<i>Andermann, A.</i>	18	<i>Beatty, B.</i>	35
<i>Andersen, AMN.</i>	23	<i>Beck, ALM.</i>	20
<i>Andersen, G.</i>	23	<i>Becker, T.</i>	17
<i>Andersen, S.</i>	27; 37	<i>Becker, TM.</i>	13
<i>Anderson, M.</i>	6	<i>Bellefontaine, K.</i>	35; 37
<i>Andersson, M.</i>	29; 31; 32	<i>Bender, S.</i>	18
<i>Andrew, A.</i>	7	<i>Benoît, A.</i>	8
<i>Andrew, L.</i>	16	<i>Benowitz, N.</i>	32
<i>Angalik, L.</i>	8	<i>Berggren, CH.</i>	29
<i>Anticono, C.</i>	30	<i>Berit, S.</i>	18
<i>Apostolou, A.</i>	27	<i>Berlie, MC.</i>	18
<i>Appavoo, D.</i>	24	<i>Bernards, S.</i>	5
<i>Araee, M.</i>	10	<i>Berner, JE.</i>	15
<i>Arbour, L.</i>	23; 31	<i>Berntsen, S.</i>	27
<i>Argunova, VM.</i>	24	<i>Berry, L.</i>	8; 21
<i>Armstrong, CD.</i>	12	<i>Berry, LE.</i>	36
<i>Arreak-Kullualik, J.</i>	28	<i>Bethune, C.</i>	10; 12
<i>Arteeva, R.</i>	23	<i>Bezha, W.</i>	16
<i>Asghari, S.</i>	10; 12; 33	<i>Bighead, S.</i>	10
<i>Ashton, S.</i>	27; 37	<i>Bisgaard, ML.</i>	24
<i>Asmis, T.</i>	36	<i>Bjerregaard, P.</i>	19; 23; 25; 31
<i>Atkinson, D.</i>	14	<i>Black, J.</i>	13
<i>Avery Kinew, K.</i>	10; 16	<i>Blondin Hall, K.</i>	9
<i>Avrusin, SL.</i>	31; 32	<i>Bluesky, K.</i>	7
<i>Axelsson, P.</i>	16	<i>Bobko, JN.</i>	31
<i>Ayotte, P.</i>	15	<i>Bombay, A.</i>	13
<i>Baikie, M.</i>	26	<i>Bondar, A.</i>	24

<i>Bonefeld-Jørgensen, EC</i>	16; 32; 37
<i>Bongo, BA</i>	36
<i>Borisova, T</i>	29
<i>Bouchard, E</i>	28
<i>Bouchouar, E</i>	28
<i>Boyle, JM</i>	7
<i>Brandow, D</i>	16
<i>Brascoupé, S</i>	14
<i>Brassard, P</i>	28
<i>Bring, A</i>	29
<i>Briscoe, S</i>	12
<i>Broderstad, AR</i>	9; 17; 23; 25
<i>Brofeldt, S</i>	37
<i>Bronson, M</i>	40
<i>Brubacher, LJ</i>	11; 33
<i>Bruce, M</i>	27; 28; 29; 37
<i>Bruden, D</i>	27; 28
<i>Brudie, S</i>	15
<i>Brustad, M</i>	20; 25
<i>Buckle, TY</i>	26
<i>Budtz, AES</i>	31
<i>Budtz, CS</i>	31
<i>Bull, J</i>	11; 13; 40
<i>Bulzacchelli, MT</i>	29
<i>Burdette-Taylor, M</i>	12
<i>Burke, T</i>	23; 24
<i>Bursey, N</i>	36
<i>Burton, CJ</i>	24
<i>Burtseva, TE</i>	31; 32
<i>Burtseva, TY</i>	24
<i>Butler, L</i>	8; 9; 21
<i>Butler, LJ</i>	36
<i>Butorov, E</i>	28
<i>Butt, P</i>	3
<i>Byam, B</i>	23; 24
<i>Byberg, S</i>	23
<i>Bye, SM</i>	21; 23
<i>Bäck, J</i>	15
<i>Bæksgaard, L</i>	37
<i>Bønløkke, JH</i>	20
<i>Børresen, ML</i>	29; 31
<i>Callaghan, R</i>	33
<i>Carroll, S</i>	39
<i>Carstensen, O</i>	20
<i>Caudarella, A</i>	19
<i>Caughey, A</i>	24
<i>Ceccato, P</i>	15
<i>Cecilie, J</i>	18
<i>Cerigo, H</i>	28
<i>Cesuroglu, T</i>	25
<i>Chan, J</i>	36
<i>Chan, LHM</i>	15
<i>Chapman, D</i>	16
<i>Chasnyk, VG</i>	24; 31; 32
<i>Chatwood, S</i>	2; 9; 10; 38
<i>Cherba, M</i>	35; 37
<i>Chreim, S</i>	7
<i>Christensen, HT</i>	31
<i>Chupakhin, VS</i>	25
<i>Cidro, J</i>	7
<i>Clark, W</i>	13
<i>Coar, L</i>	16
<i>Cole, M</i>	35; 37
<i>Colepaugh, J</i>	35; 37
<i>Collins, S</i>	23; 31
<i>Conroy, D</i>	6
<i>Cook, C</i>	6
<i>Cook, O</i>	11; 21
<i>Corriveau, A</i>	19; 37; 40
<i>Coutlee, F</i>	28
<i>Cox, S</i>	40
<i>Coyne, J</i>	16
<i>Craig Rushing, S</i>	27
<i>Crawford, A</i>	4; 39; 40
<i>Crowshoe, L</i>	4
<i>Cruz, S</i>	38
<i>Cueva, K</i>	36
<i>Cueva, M</i>	36
<i>Cunningham, GO</i>	13
<i>Cunsolo, A</i>	11; 13; 21; 33
<i>Curren, MS</i>	15
<i>Daerga, L</i>	9
<i>Dahlgren, L</i>	9
<i>Dahl-Petersen, IK</i>	18; 19; 23
<i>Dalsgård, L</i>	39
<i>D'Astous, C</i>	27
<i>Davies, L</i>	3
<i>Davis, B</i>	10
<i>Davis, MF</i>	29
<i>Dawson, T</i>	41
<i>De Smedt, S</i>	36
<i>Debyle, C</i>	29
<i>Degteva, G</i>	10; 19
<i>DeLancey, D</i>	14
<i>Delgado, R</i>	39
<i>Demant, M</i>	33
<i>Demczuk, VHB</i>	29
<i>Demuth, M</i>	17
<i>Denechezhe, L</i>	16
<i>Dennis, K</i>	36

<i>Devine, C.</i>	26	<i>Eriksen, AMA.</i>	18
<i>Dewey, CE.</i>	11; 33	<i>Eriksen, LT.</i>	36
<i>D'Hont, T.</i>	38	<i>Espen, B.</i>	18
<i>Diakite, N.</i>	7	<i>Etter, M.</i>	2; 5
<i>Diakite, NA.</i>	18	<i>Etter, M.</i>	5
<i>Diamond, G.</i>	18	<i>Evdokimova, N.</i>	26
<i>Diaz, LJ.</i>	22	<i>Evengård, B.</i>	29
<i>Dignan, M.</i>	36	<i>Evseeva, SA.</i>	31; 32
<i>Doering, P.</i>	36	<i>Exner-Pirot, H.</i>	9; 21; 36
<i>Doherty, S.</i>	12	<i>Fairman, K.</i>	2; 9
<i>Doherty, ST.</i>	33	<i>Fast, F.</i>	12
<i>Dolovich, L.</i>	10	<i>Fawehinmi, T.</i>	12
<i>Dombrowski, K.</i>	4	<i>Fedorov, A.</i>	20
<i>Donald, C.</i>	13	<i>Fedorova, S.</i>	24
<i>Donovan, S.</i>	15	<i>Fedorova, SL.</i>	29
<i>Doody, S.</i>	26	<i>Feltaous, E.</i>	35; 37
<i>Dosman, JA.</i>	10	<i>Fenton, M.</i>	10
<i>Doucette-Issaluk, M.</i>	31	<i>Ferrazzi, P.</i>	8
<i>Dougherty, K.</i>	18	<i>Firestone, M.</i>	14
<i>Douglas, NI.</i>	32	<i>Flanagan, C.</i>	32
<i>Drossos, A.</i>	3; 31	<i>Fleischer, J.</i>	37
<i>Dudarev, AA.</i>	25	<i>Fleischer, JG.</i>	33
<i>Duelund, N.</i>	31	<i>Fletcher, C.</i>	3; 6; 7; 35
<i>Duffy, LK.</i>	16	<i>Flowers, C.</i>	11; 21
<i>Dufresne, P.</i>	3; 6	<i>Ford, S.</i>	40
<i>Dunlap, KL.</i>	16; 24	<i>Franco, EL.</i>	28
<i>Durcan, A.</i>	6; 12	<i>Frandsen, S.</i>	8
<i>Durish, N.</i>	21	<i>Fraser, S.</i>	7; 8
<i>Durish, NJ.</i>	11	<i>Fraser-Roberts, L.</i>	12
<i>Durkalec, A.</i>	40	<i>Friberg, J.</i>	37
<i>Durocher, L.</i>	35	<i>Fricke, M.</i>	12
<i>Dzhemileva, L.</i>	24	<i>Frid, KEF.</i>	32
<i>Ebbehøj, N.</i>	20	<i>Friedel, T.</i>	4
<i>Edelman, S.</i>	37	<i>Furberg, M.</i>	30
<i>Edgecombe, N.</i>	12	<i>Fyfe, T.</i>	33
<i>Edin-Liljegren, A.</i>	9	<i>Gabriel, W.</i>	13
<i>Edmunds, SP.</i>	28	<i>Gafarov, V.</i>	22
<i>Edmunds-Potvin, S.</i>	31; 35; 37	<i>Gafarova, A.</i>	22
<i>Egorova, A.</i>	22	<i>Gagnon, D.</i>	8
<i>Eiberg, H.</i>	24	<i>Gagulin, I.</i>	22
<i>Eldelman, S.</i>	37	<i>Gallo, JJ.</i>	33
<i>Ellefson, K.</i>	32	<i>Galloway, T.</i>	25; 35; 37
<i>Elliott, C.</i>	16; 37	<i>Gapon, L.</i>	22
<i>Elliott, S.</i>	35; 37	<i>Garber-Slaght, R.</i>	16
<i>Elman, A.</i>	2	<i>Garcia, G.</i>	24
<i>Emelyanova, A.</i>	15; 40	<i>Garraway, L.</i>	35
<i>Emmett, SD.</i>	33	<i>Gaston, A.</i>	27
<i>Engnes, JJ.</i>	36	<i>Gates, K.</i>	23
<i>Enuaraq, N.</i>	12	<i>Gaudet, M.</i>	36
<i>Enuaraq, S.</i>	27	<i>Gauthier, B.</i>	28

<i>Geboe, BJ</i>	13	<i>Hart, C</i>	13
<i>Geisler, UW</i>	32	<i>Hatsukami, D</i>	32
<i>George, J</i>	5	<i>Hay, ALM</i>	7
<i>George, T</i>	5	<i>Healey, G</i>	4; 7; 11; 12; 31; 33; 35; 37; 38
<i>Gesy, K</i>	28	<i>Healy, G</i>	41
<i>Ghisari, M</i>	32	<i>Heegaard, S</i>	37
<i>Gilbert, SZ</i>	3	<i>Heeley, T</i>	10; 12; 33
<i>Giles, A</i>	5	<i>Hellsten, L</i>	19
<i>Gillis, D</i>	11; 21	<i>Henderson, R</i>	4
<i>Glasser, J</i>	40	<i>Hennessy, T</i>	28; 40
<i>Gluud, C</i>	33	<i>Herlow, L</i>	37
<i>Goicolea, I</i>	8	<i>Hernandez, L</i>	30
<i>Goldfarb, D</i>	28	<i>Hicks, J</i>	4
<i>Gonzalez, N</i>	24	<i>Hicks, JR</i>	4
<i>Gorbatova, L</i>	10	<i>Hildes Ripstein, E</i>	23
<i>Gorbunova, E</i>	21	<i>Hildes-Ripstein, GE</i>	30
<i>Gordon, EV</i>	40	<i>Hill, MJ</i>	7
<i>Gorman, G</i>	27	<i>Hiratsuka, V</i>	11; 32
<i>Gotovtsev, N</i>	29	<i>Hobin, E</i>	19
<i>Gottlieb, N</i>	40	<i>Hoffmann, S</i>	29
<i>Goulet, S</i>	6; 41	<i>Hoffmann-Petersen, IT</i>	29
<i>Graham, H</i>	10; 17	<i>Hofstetter, P</i>	33
<i>Graham, HA</i>	3	<i>Homøe, AS</i>	27
<i>Graham, K</i>	5	<i>Homøe, P</i>	33; 37
<i>Graham, W</i>	10; 12	<i>Horlick, S</i>	7; 12; 35; 37
<i>Grarup, N</i>	23	<i>Hounsgard, L</i>	12
<i>Greenberg, C</i>	23	<i>Hounsgaard, L</i>	39
<i>Griffith, K</i>	18	<i>Huang, G</i>	29
<i>Groen, RSG</i>	33	<i>Hudson, A</i>	5
<i>Gromova, E</i>	22	<i>Hughes, C</i>	32
<i>Gubin, D</i>	22	<i>Humphries, S</i>	11; 33
<i>Gudmundsdottir, B</i>	18	<i>Hurlburt, D</i>	28; 29
<i>Guerin, C</i>	3	<i>Hutchinson, P</i>	6
<i>Gupta, N</i>	38	<i>Höper, A</i>	20
<i>Gustafsson, PE</i>	3; 8; 10; 23	<i>Ibrahim, N</i>	7
<i>Gustin, C</i>	28	<i>Ikäheimo, TM</i>	15
<i>Hackett, C</i>	40	<i>Ilin, V</i>	21; 22
<i>Hahn, M</i>	15	<i>Imanova, ON</i>	24
<i>Hall, A</i>	33	<i>Ingemann, C</i>	2; 10; 20; 25; 38
<i>Hall, KEB</i>	9	<i>Ingstad, B</i>	8
<i>Halldorsdottir, S</i>	18	<i>Innokentieva, N</i>	29
<i>Handa, D</i>	6	<i>Ireland, S</i>	11; 32; 33
<i>Hanley, B</i>	16; 18; 19; 20; 28; 37	<i>Isidor, S</i>	8
<i>Hannah, H</i>	37	<i>Ivarsson, A</i>	23
<i>Hansen, CB</i>	3	<i>Ives, N</i>	13
<i>Hansen, K</i>	18	<i>Jakobsen, JC</i>	33
<i>Hansen, KL</i>	3	<i>Jamal, A</i>	2
<i>Haqpi, E</i>	40	<i>Jamieson, R</i>	41
<i>Harper, S</i>	11; 21	<i>Jardine, C</i>	4
<i>Harper, SL</i>	11; 33	<i>Jardine, CG</i>	5

<i>Jenkins, E.</i>	28	<i>Kleinschmidt, K.</i>	22
<i>Jensen, H.</i>	31	<i>Klejka, JK.</i>	28
<i>Jensen, RG.</i>	33; 37	<i>Klimova, T.</i>	20
<i>Jensen, TY.</i>	39	<i>Kløvgaard, M.</i>	31
<i>Jeong, J.</i>	3	<i>Koch, A.</i>	29; 31; 32; 37
<i>Jerome, SP.</i>	16; 24	<i>Kohut, R.</i>	16
<i>Jessen, C.</i>	27	<i>Kolapo, T.</i>	28
<i>Johnson, K.</i>	29	<i>Koller, K.</i>	23; 32
<i>Johnson, RM.</i>	4; 13	<i>Kondakov, S.</i>	26
<i>Johnston, S.</i>	33	<i>Konnikova, E.</i>	24
<i>Jokelainen, J.</i>	15	<i>Konstantin, S.</i>	23
<i>Jonatansdottir, S.</i>	35	<i>Koonoo, T.</i>	24
<i>Jong, M.</i>	4; 21	<i>Kopak, L.</i>	40
<i>Jousilahti, P.</i>	15	<i>Korelskaya, IE.</i>	19
<i>Joy, W.</i>	24	<i>Korneeva, Y.</i>	18; 19; 20
<i>Juhl, A.</i>	37	<i>Korzun, M.</i>	24
<i>Júliusson, PB.</i>	31	<i>Kostik, MM.</i>	24
<i>Jull, J.</i>	7	<i>Kovyazin, A.</i>	22
<i>Jull, JE.</i>	11; 37	<i>Kral, MJ.</i>	3
<i>Juul, K.</i>	32	<i>Krarup, H.</i>	27
<i>Jørgensen, LH.</i>	20	<i>Kravchenko, A.</i>	26
<i>Jørgensen, ME.</i>	19; 22; 23	<i>Kristiansen, RE.</i>	9
<i>Jaakkola, JJK.</i>	15	<i>Kromrey, L.</i>	16
<i>Kanayurak, N.</i>	41	<i>Krymov, E.</i>	22
<i>Kandola, K.</i>	41	<i>Kuhn, RL.</i>	38
<i>Karas, N.</i>	36	<i>Kulmala, M.</i>	15
<i>Karetak, J.</i>	8	<i>Kungurtsev, S.</i>	21
<i>Karunanayake, C.</i>	35	<i>Kuosa, K.</i>	8
<i>Kassj, N.</i>	5	<i>Kuraeva, TL.</i>	24
<i>Katajavaara Sørensen, I.</i>	18	<i>Kushner, AL.</i>	33
<i>Katz, A.</i>	7; 10	<i>Kuzmina, A.</i>	20
<i>Kern, P.</i>	24	<i>Kvaløy, K.</i>	23
<i>Khanam, U.</i>	35	<i>Kvernmo, S.</i>	38
<i>Kharkov, V.</i>	24	<i>Kyoon-Achan, G.</i>	6; 7; 8; 10
<i>Kharkova, O.</i>	32	<i>Labrique, AB.</i>	33
<i>Khusnutdinova, EV.</i>	24	<i>Ladefoged, K.</i>	29
<i>Kiddell-Monroe, R.</i>	26	<i>Lai, GC.</i>	7
<i>Kilabuk, P.</i>	24	<i>Laird, B.</i>	15; 16
<i>Kilbourne, J.</i>	4	<i>Lakhani, S.</i>	38
<i>Kim, H.</i>	28	<i>Lamarche, L.</i>	10
<i>Kim, J.</i>	3	<i>Lamberg-Allardt, C.</i>	25
<i>Kim, S.</i>	3	<i>Lamothe, D.</i>	37
<i>Kinal, A.</i>	19	<i>Lamothe, DM.</i>	37
<i>Kinew, KA.</i>	7	<i>Lannon, M.</i>	35
<i>Kipp, A.</i>	11	<i>Lappalainen, H.</i>	15
<i>Kirk, T.</i>	39	<i>Larcombe, L.</i>	16
<i>Kiryuchuk, S.</i>	10	<i>Larsen, C.</i>	41
<i>Kiærbech, HM.</i>	9	<i>Larsen, CVL.</i>	2; 3; 10; 18; 19; 20; 23; 25; 38; 40
<i>Kjær Ersbøll, A.</i>	19	<i>Larsson, A.</i>	16
<i>Klarov, L.</i>	24	<i>Laukkanen, JA.</i>	15

<i>Lauritzen, L.</i>	22	<i>Malyavskaya, S.</i>	10
<i>Lavallee, A.</i>	35	<i>Mangum, SJ.</i>	24
<i>Lavallee, B.</i>	6	<i>Manskow, U.</i>	8
<i>Lavallee, C.</i>	26	<i>Marchand, S.</i>	28
<i>Lavoie, J.</i>	6; 7; 10; 12; 13; 33	<i>Markham, C.</i>	27
<i>Le Gresley, F.</i>	27	<i>Marsh, B.</i>	19
<i>LeBlanc, SL.</i>	12	<i>Marsh, J.</i>	11
<i>Leclair, L.</i>	12	<i>Martin, D.</i>	11; 13
<i>Lecy, D.</i>	28	<i>Martin, I.</i>	29
<i>Lee, J.</i>	3	<i>Masson, K.</i>	3
<i>Lee, S.</i>	3	<i>McDougall, P.</i>	36
<i>Lekhanova, S.</i>	29	<i>McEachern, D.</i>	4; 39
<i>Lemire, M.</i>	15	<i>McGrath, C.</i>	36
<i>Lennert Olsen, L.</i>	8	<i>McInnis, OA.</i>	19
<i>Lenskjold, T.</i>	19	<i>McKay, J.</i>	35
<i>Lewis, J.*-</i>	2	<i>McKinnon, M.</i>	6
<i>Lewis, JP.</i>	2	<i>McMahon, B.</i>	27; 28
<i>Lhotka, L.</i>	24	<i>McMillan, J.</i>	13
<i>Li, AY.</i>	29	<i>McPhillips, F.</i>	12
<i>Li, CS.</i>	7	<i>Mehus, G.</i>	36
<i>Liddy, C.</i>	12	<i>Melbye, M.</i>	29
<i>Lind, O.</i>	24	<i>Melhus, M.</i>	17; 23; 25
<i>Linden, K.</i>	36	<i>Mercer, J.</i>	7
<i>Lines, LA.</i>	4; 5	<i>Michalsen, VL.</i>	23
<i>Linklater, R.</i>	5	<i>Michelsen, SW.</i>	29; 32
<i>Linton, J.</i>	38	<i>Mikova, N.</i>	21
<i>Lobova, VA.</i>	3; 17; 20	<i>Miller, V.</i>	13
<i>Logunov, KV.</i>	20	<i>Miners, AA.</i>	28
<i>Lohse, N.</i>	37	<i>Miranda, M.</i>	31
<i>Long, M.</i>	16; 32	<i>Mironov, A.</i>	17
<i>Loppie, C.</i>	11	<i>Mironov, AV.</i>	3
<i>Lozem, GF.</i>	9	<i>Mishara, B.</i>	4
<i>Loskutova, K.</i>	29	<i>Mistry, JM.</i>	31
<i>Lutz, T.</i>	17	<i>Mitri, M.</i>	18
<i>Lynch, M.</i>	7	<i>Moffatt, M.</i>	12
<i>Lynge, AR.</i>	31	<i>Moffitt, P.</i>	35
<i>Lyonnais, MC.</i>	6; 7	<i>Moffitt, PM.</i>	38
<i>Laatikainen, TY.</i>	15	<i>Moller, S.</i>	8
<i>Ma, Y.</i>	29	<i>Montesanti, S.</i>	4
<i>MacDonald, S.</i>	36	<i>Montgomery-Andersen, R.</i>	32; 33
<i>MacKinnon, M.</i>	41	<i>Mordovskaya, L.</i>	26
<i>MacLean, J.</i>	10	<i>Morin, V.</i>	27
<i>MacLeod, ML.</i>	35	<i>Morozov, I.</i>	24
<i>MacRury, A.</i>	24	<i>Morris, J.</i>	28
<i>Maddox, R.</i>	14	<i>Morrow, A.</i>	8
<i>Madsen, SS.</i>	17	<i>Morton Ninomiya, ME.</i>	5; 7; 14
<i>Madsen, V.</i>	2; 9	<i>Mosquera, P.</i>	3; 10
<i>Mahoney, D.</i>	16	<i>Mosquera, PA.</i>	8; 23
<i>Malkhazova, S.</i>	15	<i>Moto, R.</i>	4; 39
<i>Malogulova, I.</i>	20	<i>Mougaard-Frederiksen, H.</i>	8

<i>Mousavi, N.</i>	37	<i>Orr, P.</i>	16; 37
<i>Muirhead, A.</i>	6	<i>Owens-Manley, J.</i>	15
<i>Mulvad, G.</i>	27; 40	<i>Pahwa, P.</i>	35
<i>Murphy, K.</i>	38	<i>Pak, M.</i>	29
<i>Murphy, N.</i>	28; 32	<i>Paniak, A.</i>	2; 8
<i>Murphy, NJ.</i>	33	<i>Panov, D.</i>	22
<i>Myeryz-Dixon, B.</i>	41	<i>Pantarotto, J.</i>	36
<i>Møller, H.</i>	6; 38	<i>Patten, C.</i>	32
<i>Møller, HU.</i>	31	<i>Patterson, M.</i>	26; 30
<i>Narayanan, M.</i>	23	<i>Pavlov, N.</i>	26
<i>Nash, M.</i>	26	<i>Pavlov, NY.</i>	26
<i>Nash, S.</i>	37	<i>Pavlova, TY.</i>	32
<i>Navne, JE.</i>	29	<i>Pawa, J.</i>	30
<i>Nechaeva, E.</i>	19; 39	<i>Payne, G.</i>	33
<i>Nelson, CM.</i>	29	<i>Pedersen, ML.</i>	17; 22; 27; 31
<i>Nelunova, TI.</i>	32	<i>Pekel, JF.</i>	15
<i>Ng, H.</i>	6	<i>Pender, K.</i>	36
<i>Nguyen, H.</i>	12; 41	<i>Perreault, K.</i>	3
<i>Niclasen, B.</i>	19; 33	<i>Petrasek MacDonald, J.</i>	40
<i>Nicolaev, VM.</i>	24	<i>Petrenya, N.</i>	25
<i>Nicole, I.</i>	12	<i>Petterson, HG.</i>	19
<i>Nielsen, IM.</i>	24	<i>Petäjä, T.</i>	15
<i>Nielsen, NO.</i>	31	<i>Phillips-Beck, W.</i>	7; 10
<i>Nilsen, SE.</i>	38	<i>Phillis, M.</i>	12
<i>Nilsson, LM.</i>	7; 16	<i>Piccard, A.</i>	7
<i>Nishi, W.</i>	28	<i>Pisuktie, AP.</i>	6
<i>Nolen, L.</i>	27; 28	<i>Pisuktie, T.</i>	6
<i>Norbye, B.</i>	9	<i>Plain, S.</i>	5
<i>Nystad, K.</i>	8	<i>Plested, B.</i>	11
<i>Näyhä, S.</i>	15	<i>Plourde-Léveillé, L.</i>	7; 8
<i>Nørtoft, K.</i>	39	<i>Poirier, JE.</i>	27
<i>O'Brien, D.</i>	37	<i>Poker, C.</i>	7
<i>Odgaard, M.</i>	37	<i>Poliquin, PG.</i>	30
<i>Odland, JØ.</i>	31; 32; 36	<i>Poliquin, V.</i>	30
<i>Ogarkov, O.</i>	26	<i>Politis, C.</i>	41
<i>Ogenchuk, M.</i>	17; 19	<i>Pollock, N.</i>	13
<i>Ogenchuk, MJ.</i>	17	<i>Pollock, NJ.</i>	4; 7; 12
<i>Ogilvie, G.</i>	37	<i>Posukh, O.</i>	24
<i>O'Hearn, T.</i>	27	<i>Pradhan, G.</i>	12
<i>Ohlrogge, EC.</i>	25	<i>Price, PA.</i>	35
<i>Olesen, I.</i>	25	<i>Pringle, B.</i>	39
<i>Olesen, P.</i>	8	<i>Proulx, JF.</i>	27
<i>Oliver, R.</i>	2	<i>Pshennikova, V.</i>	29
<i>Olsen Harper, A.</i>	7	<i>Pungowiyi, P.</i>	39
<i>Olsen, B.</i>	31	<i>Putulik, S.</i>	40
<i>O'Malley, G.</i>	27	<i>Rabbitskin, NY.</i>	10
<i>Omland, Ø.</i>	20	<i>Raczniak, G.</i>	28
<i>Omma, L.</i>	16	<i>Rafailov, A.</i>	29
<i>Oosman, S.</i>	35	<i>Rahman, MD.</i>	26
<i>Orlov, D.</i>	15	<i>Ramsden, V.</i>	3; 17

<i>Ramsden, VR.</i>	10	<i>Schumann, B.</i>	30
<i>Rand, JR.</i>	11	<i>Schurer, J.</i>	28
<i>Rasmus, S.</i>	13	<i>Schwarzburg, LL</i>	32
<i>Rasmussen, K.</i>	20	<i>Seeman, S.</i>	27; 28
<i>Rasmussen, KE.</i>	33	<i>Sehti, C.</i>	19
<i>Ratelle, M.</i>	16	<i>Seibæk, L.</i>	12
<i>Rautio, A.</i>	15; 16; 40	<i>Selina, K.</i>	31
<i>Reading, J.</i>	14	<i>Senftleber, NK.</i>	22
<i>Regeer, BJ.</i>	10	<i>Senkevich, JJ.</i>	31
<i>Renaud, J.</i>	36	<i>Serra, EV.</i>	28
<i>Revell, S.</i>	28	<i>Seymour, F.</i>	21
<i>Revels, L.</i>	36	<i>Shalini, D.</i>	28
<i>Rex, KF.</i>	27	<i>Shea, J.</i>	4; 5
<i>Reynolds, AJ.</i>	16; 24	<i>Shegog, RR.</i>	27
<i>Rich, R.</i>	38	<i>Shirley, J.</i>	28
<i>Rigolet Inuit Community Government</i>	11; 21	<i>Shiwak, I.</i>	11; 21
<i>Riva, M.</i>	3; 6; 7; 16; 35	<i>Shurkevich, N.</i>	22
<i>Robinson, N.</i>	14	<i>Sibileva, EN.</i>	24
<i>Robler, SK.</i>	33	<i>Sigsgaard, T.</i>	20
<i>Roderick, L.</i>	15	<i>Sigurdardottir, S.</i>	18
<i>Roelants, M.</i>	31	<i>Silviken, AC.</i>	9
<i>Roik, E.</i>	15; 36	<i>Simkin, J.</i>	37
<i>Romanov, G.</i>	24	<i>Simmons, D.</i>	16
<i>Romanova, A.</i>	22	<i>Simonova, N.</i>	19; 20
<i>Rosa, C.</i>	13	<i>Simons, B.</i>	28
<i>Rourke, K.</i>	11; 21	<i>Sinclair, S.</i>	7; 10
<i>Roy, TJ.</i>	35	<i>Sinelnikova, EV.</i>	31; 32
<i>Rudolph, K.</i>	28; 29	<i>Singer, M.</i>	16
<i>Ruttan, J.</i>	5	<i>Singh, A.</i>	30
<i>Rønn, PF.</i>	22; 23	<i>Siren, A.</i>	39
<i>Sacco, F.</i>	28	<i>Skandfer, M.</i>	20
<i>Sahlén, KG.</i>	9	<i>Skinner, K.</i>	16
<i>Sallaffie, M.</i>	27	<i>Skovgaard, N.</i>	22
<i>Sallaffie, MC.</i>	2; 27	<i>Skripchenko, N.</i>	18
<i>Salomonie, A.</i>	12	<i>Slotved, HC.</i>	29
<i>Salter, S.</i>	18	<i>Smith, LS.</i>	23
<i>Sam, LD.</i>	15	<i>Smith, M.</i>	12
<i>Sameshima, P.</i>	38	<i>Smith, N.</i>	17
<i>Sampson, EV.</i>	39	<i>Smylie, JK.</i>	14
<i>San Sebastian, M.</i>	3; 8; 10; 23	<i>Snyder, E.</i>	24
<i>Saranchuk, P.</i>	26	<i>Soborg, B.</i>	29; 31; 32
<i>Sargeant, J.</i>	24	<i>Sohn, JJ.</i>	18
<i>Savvina, MS.</i>	31; 32	<i>Solodkova, IV.</i>	31; 32
<i>Sawatzky, A.</i>	11	<i>Solovyev, A.</i>	24
<i>Schantz, D.</i>	12	<i>Soni, R.</i>	12
<i>Schertzer, A.</i>	26	<i>Spein, A.</i>	9
<i>Schlütter, MM.</i>	39	<i>Spein, AR.</i>	8
<i>Schnohr, C.</i>	19; 33	<i>Spradling, P.</i>	28
<i>Schnurr, TM.</i>	24	<i>Stannard, C.</i>	28
<i>Schraer, C.</i>	23	<i>Ste Marie, K.</i>	12

<i>Steenbeek, A.</i>	11	<i>Trulsson, AMC.</i>	34
<i>Stepanov, K.</i>	22	<i>Tsang, R.</i>	29
<i>Stepanov, V.</i>	24	<i>Turner, T.</i>	10
<i>Stepanova, SM.</i>	24	<i>Tvermosegaard, M.</i>	23
<i>Stiassny, P.</i>	16	<i>Tyrrell, CA.</i>	12
<i>Sticka, KD.</i>	24	<i>Tyulyubaeva, T.</i>	20
<i>Stigum, H.</i>	18	<i>Udesen, S.</i>	19
<i>Stiller, TL.</i>	13	<i>Uliana, L.</i>	23
<i>Stockwell, T.</i>	19	<i>Uswal, G.</i>	17
<i>Storm Mienna, C.</i>	16	<i>Utsi, R.</i>	16
<i>Strudwick, L.</i>	28	<i>Vagaitseva, K.</i>	24
<i>Sturge Sparkes, C.</i>	4	<i>Van Bibber, M.</i>	5
<i>Sunak, A.</i>	6	<i>Varentsova, IA.</i>	19
<i>Svartberg, J.</i>	23	<i>Veillard, J.</i>	38
<i>Swab, M.</i>	33	<i>Veilleux, S.</i>	27
<i>Sørensen, I.</i>	18; 20	<i>Velizhanin, S.</i>	22
<i>Sørensen, TL.</i>	31	<i>Vetoshkin, A.</i>	22
<i>Tabish, T.</i>	2	<i>Vinokurova, FV.</i>	24
<i>Tagalik, S.</i>	8; 38	<i>Vinokurova, M.</i>	26
<i>Tatty, N.</i>	11; 33	<i>Waenerlund, AK.</i>	8
<i>Tavarro, A.</i>	30	<i>Waits, A.</i>	15
<i>Tereshchenko, I.</i>	22	<i>Wakegijig, J.</i>	12
<i>Thierfelder, T.</i>	29	<i>Wakewich, P.</i>	38
<i>Thomas, GS.</i>	26	<i>Walch, A.</i>	23
<i>Thomas, T.</i>	32	<i>Walker, F.</i>	8
<i>Thompson, G.</i>	28	<i>Walker, J.</i>	6
<i>Thompson, GV.</i>	28	<i>Wang, NY.</i>	33
<i>Thompson, J.</i>	23	<i>Ward, K.</i>	13
<i>Thompson, JR.</i>	23	<i>Ward, LM.</i>	7
<i>Tiesinga, J.</i>	28	<i>Wark, K.</i>	11
<i>Timmermans, V.</i>	37	<i>Warren-Mears, V.</i>	13
<i>Tindborg, M.</i>	32	<i>Weiler, RL.</i>	17
<i>Tinsley, R.</i>	16	<i>Weinehall, L.</i>	23
<i>Titovich, EV.</i>	24	<i>Wells, S.</i>	5
<i>Tobin, P.</i>	6; 41	<i>Wetterstrand, VJR.</i>	17
<i>Tobokhov, A.</i>	24	<i>Wexler, L.</i>	4; 13; 39
<i>Torchetti, T.</i>	37	<i>White, MD.</i>	16
<i>Tore, S.</i>	18	<i>Wielsøe, M.</i>	16; 32; 37
<i>Torres, J.</i>	27	<i>Wild, C.</i>	19
Track 1: Mental wellness	1; 2	<i>Willard, LA.</i>	12
Track 10: Workshops	39	<i>Willetto Wolfe, A.</i>	32
Track 2: Culturally sensitive health care	6	<i>Williamson, J.</i>	27
Track 3: Health care systems and ethics	10	<i>Willis, D.</i>	2; 9
Track 4: Environment I	1; 15	<i>Wilson, MM.</i>	12
Track 5: Environment II	18	<i>Wohlfahrt, J.</i>	32
Track 6: Chronic diseases and genetics	22	<i>Wood, M.</i>	11; 21
Track 7: Infectious diseases	26	<i>Woodbury, RB.</i>	11
Track 8: Mother and child health	31	<i>Woodgate, R.</i>	35; 37
Track 9: Ageing, nursing and cancer	1; 35	<i>Worden-Driscoll, I.</i>	13
<i>Truitt, S.</i>	28	<i>Wu, J.</i>	28

<i>Yakeleya Newmark, M.</i>	9	<i>Zelianina, AN.</i>	11; 19
<i>Yakovleva, L.</i>	26	<i>Zhdanova, S.</i>	26
<i>Yang, J.</i>	16	<i>Ziegler, C.</i>	14
<i>Yansouni, CP.</i>	28	<i>Zilitinkevich, S.</i>	15
<i>Yassie, E.</i>	16	<i>Zoe, JB.</i>	14
<i>Yoon, S.</i>	3	<i>Zubov, L.</i>	10; 15; 21; 23
<i>Yurjeva, A.</i>	19	<i>Zubov, LA.</i>	24
<i>Zacharova, R.</i>	20	<i>Zuccharini, C.</i>	16; 20
<i>Zapalova, A.</i>	23	<i>Zulz, T.</i>	29
<i>Zarubin, A.</i>	24	<i>Aagaard, T.</i>	39