

# 84 The Orchards

Epping, Essex

Guide Price £800,000

Council Tax band: F

Tenure: Freehold

- Detached Bungalow
- Chain Free
- 3 Bedrooms
- Walking distance to Epping Underground Station
- Desirable Location
- Surrounded by Essex Countryside
- Opportunity to add own stamp
- Corner plot



**Hallway**

**Living Room**

17' 7" x 15' 7" (5.37m x 4.76m)

**Kitchen**

12' 10" x 8' 0" (3.92m x 2.44m)

**Utility**

8' 8" x 6' 7" (2.64m x 2.00m)

**Dining Room**

12' 1" x 8' 8" (3.68m x 2.64m)

**Bedroom 1**

13' 9" x 9' 11" (4.19m x 3.01m)

**Dressing Room**

8' 10" x 7' 10" (2.68m x 2.38m)

**Bedroom 2**

11' 11" x 10' 3" (3.64m x 3.12m)

**Bedroom 3**

11' 11" x 7' 1" (3.64m x 2.15m)

**Bathroom**

8' 2" x 5' 7" (2.48m x 1.71m)







### Ground Floor

Main area: approx. 104.6 sq. metres (1126.2 sq. feet)  
Plus garages, approx. 13.4 sq. metres (144.1 sq. feet)

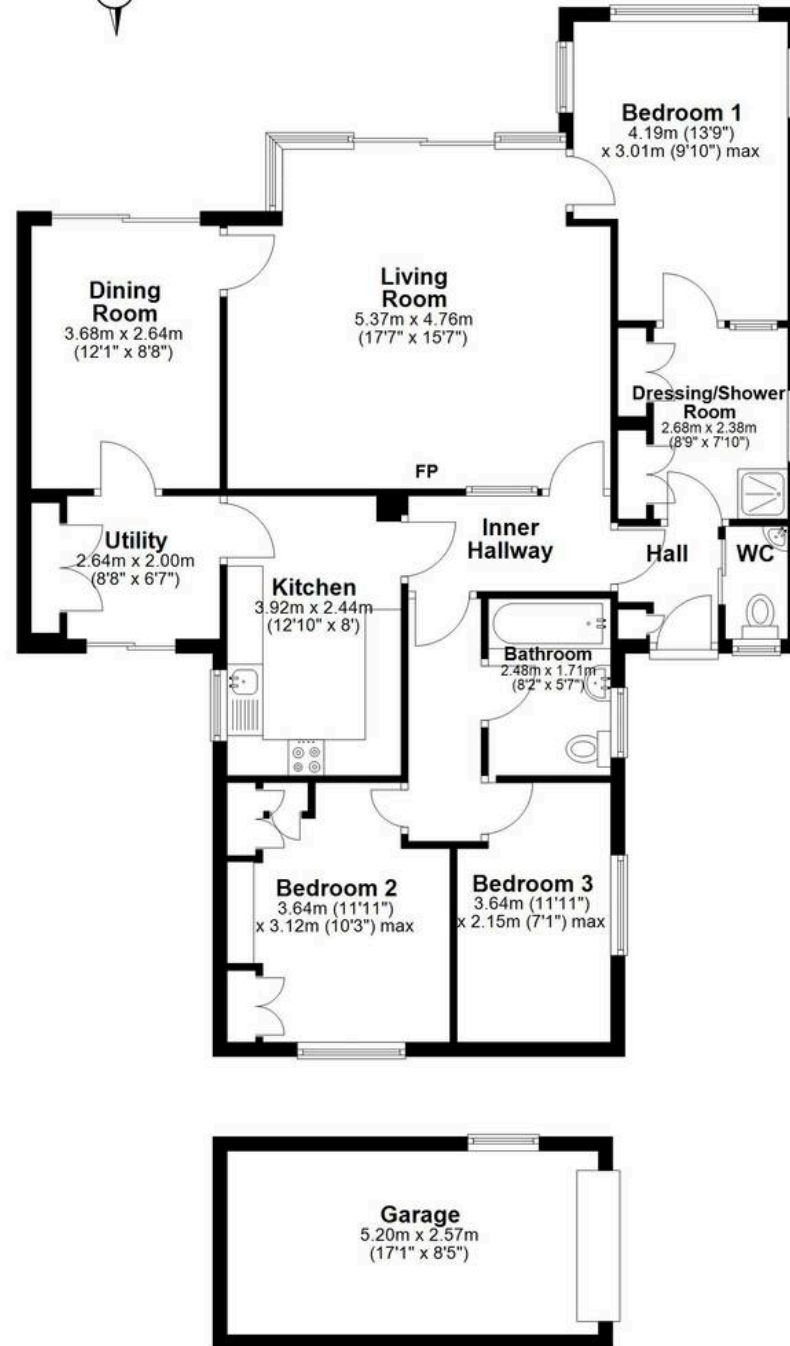

Main area: Approx. 104.6 sq. metres (1126.2 sq. feet)  
Plus garages, approx. 13.4 sq. metres (144.1 sq. feet)