



Hammond
& Smith

Flat 16, Wilhelm Mohr Court Rayley Lane, North Weald
£340,000





Flat 16

Wilhelm Mohr Court Rayley Lane, Epping

Council Tax band: C

Tenure: Leasehold

- PENTHOUSE APARTMENT
- 2 ALLOCATED PARKING SPACES
- LARGE BALCONY SPACE
- UNDERFLOOR HEATING THROUGHOUT
- PRIMARY BEDROOM WITH EN-SUITE
- SHORT DISTANCE TO M11 JUNCTION





Apartment

Approx. 72.2 sq. metres (777.1 sq. feet)

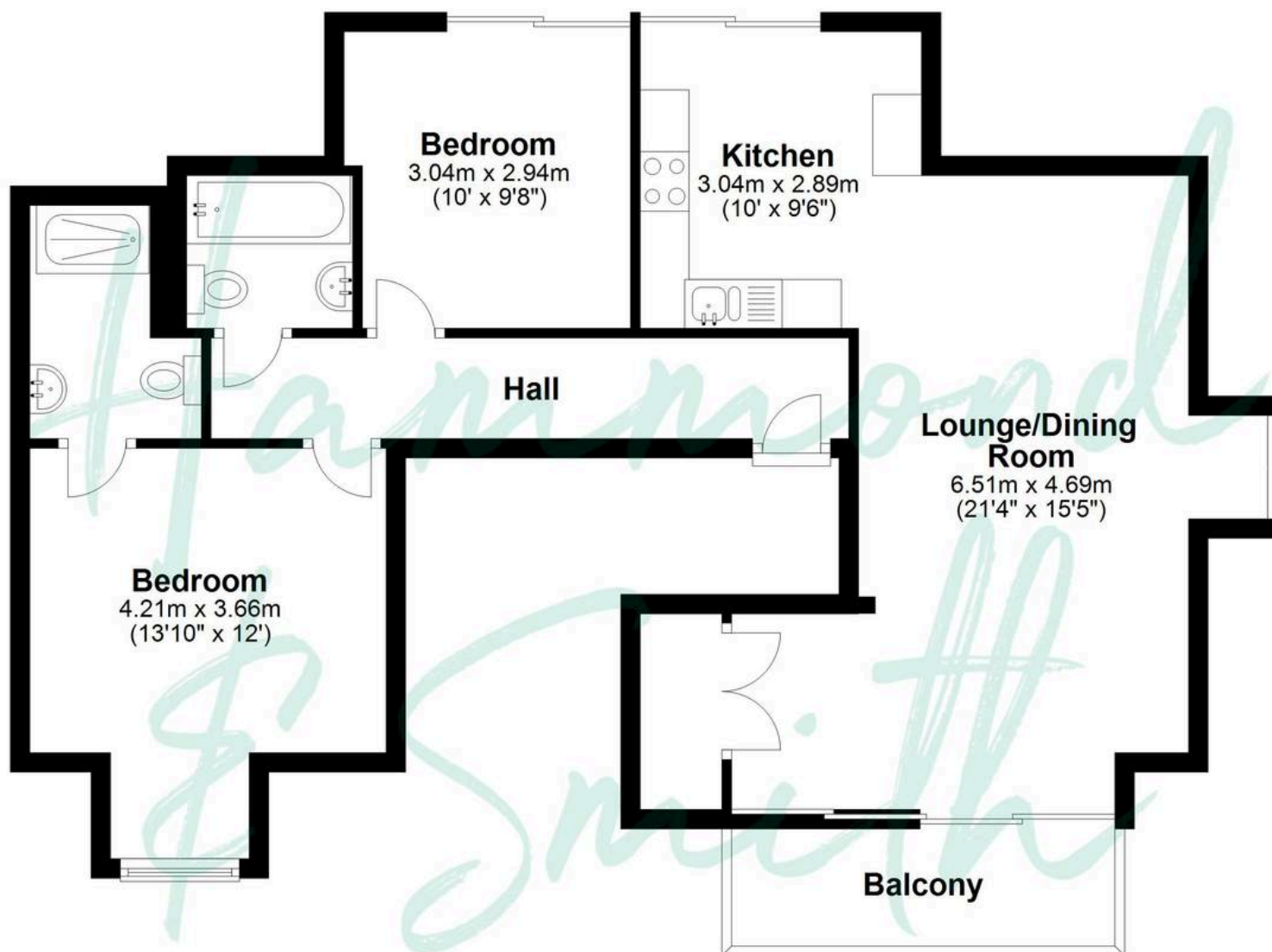

Total area: approx. 72.2 sq. metres (777.1 sq. feet)

THE FLOORPLAN IS FOR ILLUSTRATIVE PURPOSES ONLY AND IS NOT TO SCALE. Measurements and features are approximate and may differ from the actual property. Verify all details independently; no liability is accepted for errors or omissions.