

32 Cedar Court

Epping, Epping

Council Tax band: F

Tenure: Share of Freehold

- ONE BEDROOM APARTMENT
- ALLOCATED PARKING
- SHORT WALK TO STATION
- IDEAL BUY TO LET
- DOUBLE GLAZED
- FIRST FLOOR
- CLOSE TO EPPING HIGH STREET



Entrance Hall

WC

Kitchen

7' 3" x 9' 11" (2.21m x 3.03m)

Lounge/ Diner

13' 1" x 17' 6" (4.00m x 5.34m)

Bedroom

9' 10" x 19' 2" (3.00m x 5.85m)

En-suite Bathroom

5' 9" x 5' 9" (1.76m x 1.75m)







First Floor

Approx. 49.9 sq. metres (537.0 sq. feet)

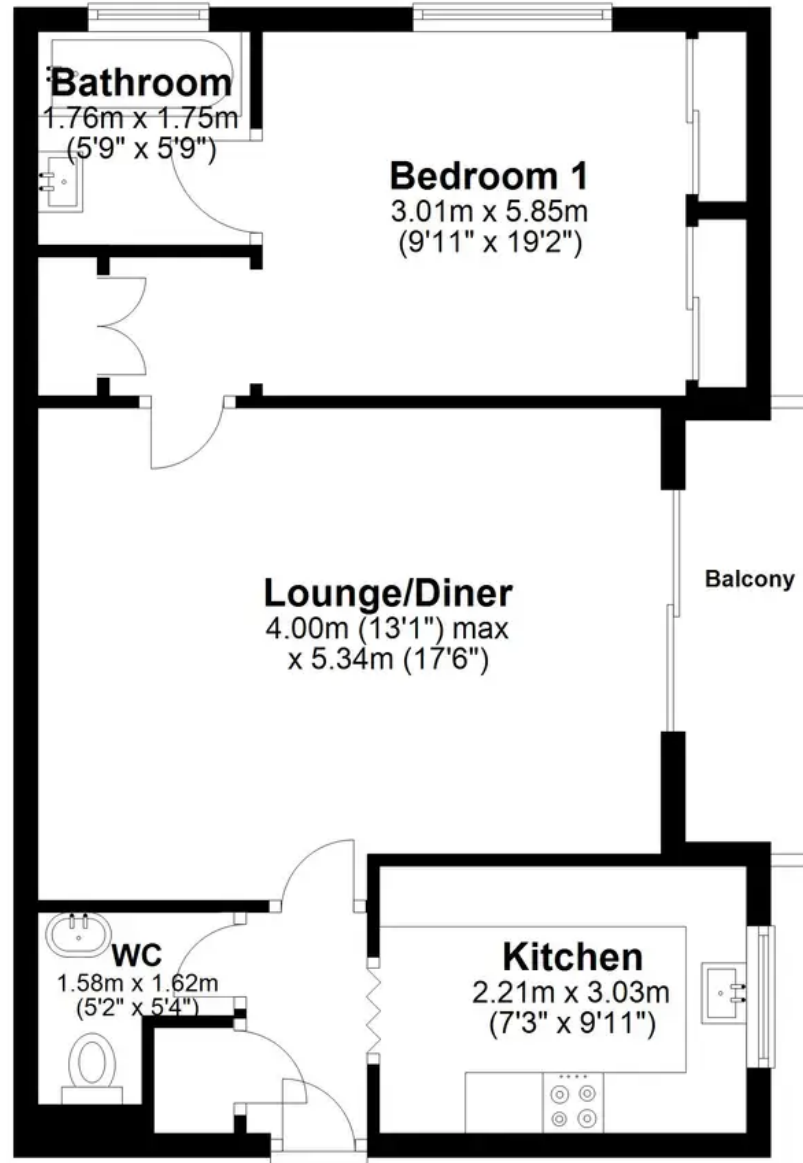

Total area: approx. 49.9 sq. metres (537.0 sq. feet)