

22 Stewards Close

Epping, Epping

Council Tax band: E

Tenure: Freehold

- PEACEFUL CUL DE SAC
- POTENTIAL TO EXTEND (STP)
- GARAGE AND OFF ROAD PARKING
- MODERN KITCHEN
- CLOSE TO IVY CHIMNEYS AND COOPERSALE HALL SCHOOL
- SHORT WALK TO STATION
- 3 RECEPTION ROOMS
- MODERN DECOR
- GROUND FLOOR SHOWER ROOM



Entrance Hall

Living Room

17' 7" x 12' 2" (5.36m x 3.72m)

Dining Area

11' 3" x 10' 1" (3.42m x 3.08m)

Kitchen Area

10' 2" x 8' 1" (3.10m x 2.47m)

Family Room/Study

10' 2" x 9' 3" (3.10m x 2.83m)

Conservatory

11' 2" x 8' 5" (3.40m x 2.56m)

Shower Room

8' 7" x 6' 2" (2.62m x 1.89m)

Landing

Bedroom 1

14' 11" x 11' 4" (4.55m x 3.46m)

Bedroom 2

13' 5" x 11' 4" (4.08m x 3.46m)

Bedroom 3

8' 1" x 6' 2" (2.46m x 1.89m)

Bathroom

8' 7" x 6' 2" (2.62m x 1.89m)





Ground Floor

Approx. 80.4 sq. metres (865.7 sq. feet)

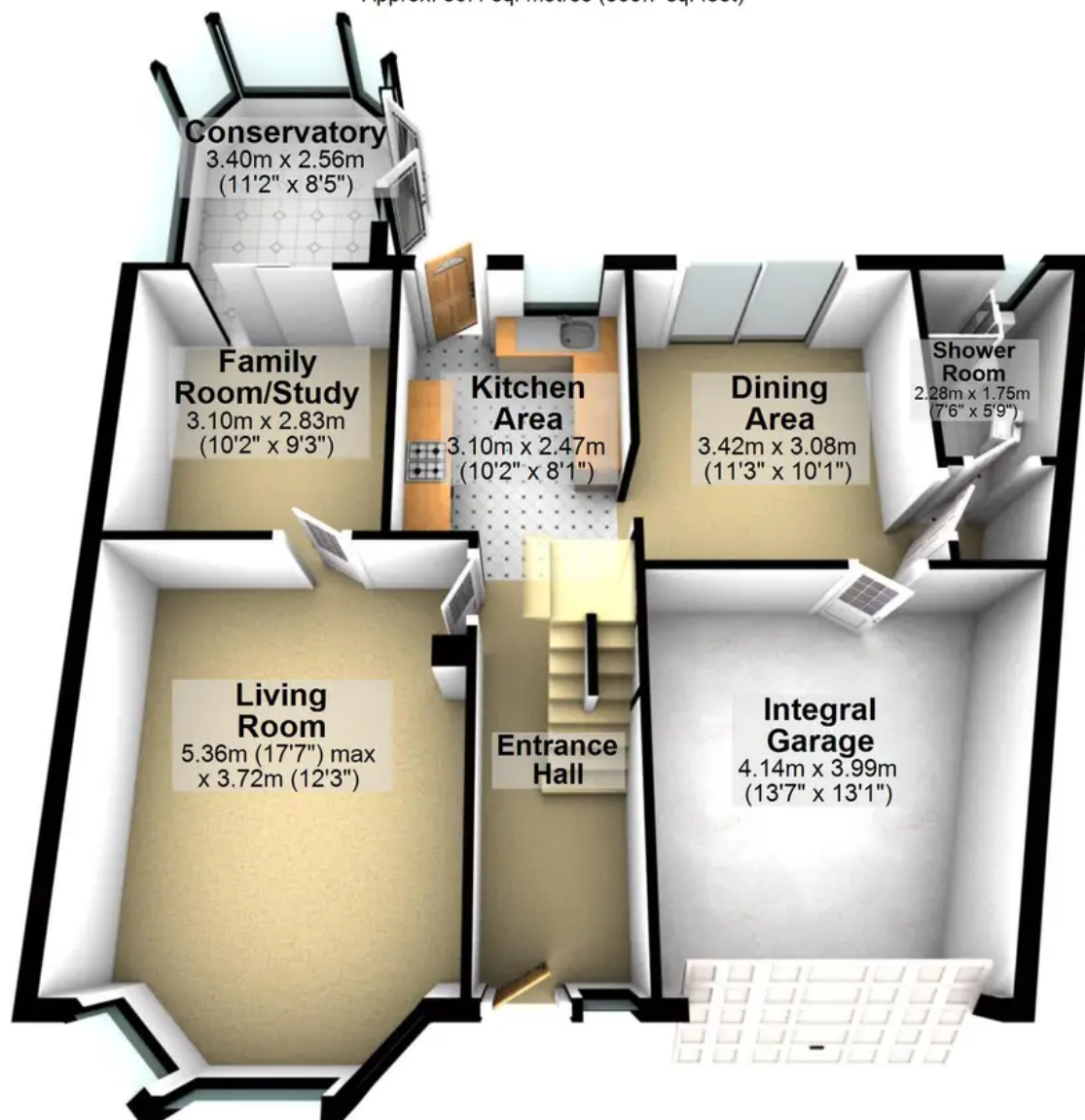

First Floor

Approx. 44.6 sq. metres (479.5 sq. feet)

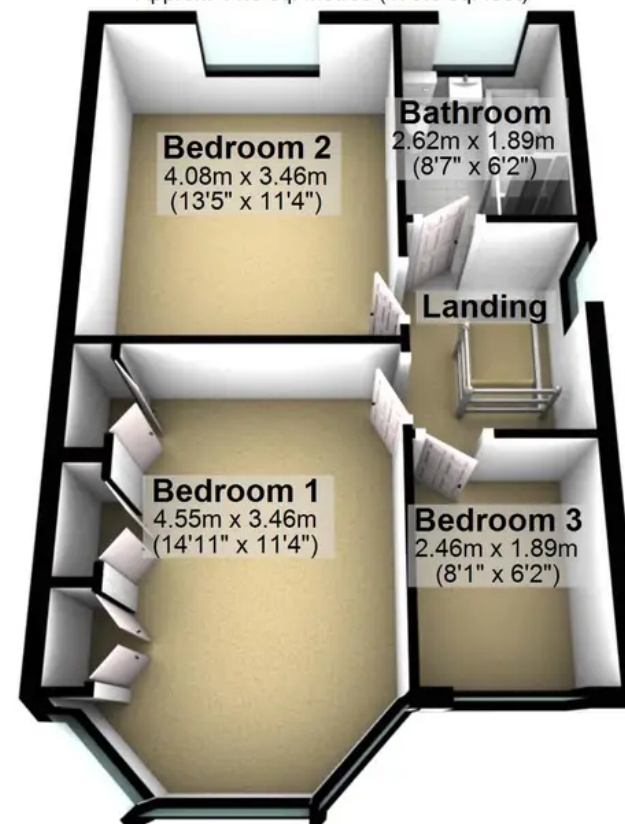

Total area: approx. 125.0 sq. metres (1345.3 sq. feet)