



Pear Tree Cottage, Epping Road, Nazeing

In Excess of £700,000



mond
ll



Pear Tree Cottage, Epping Road

Nazeing, Waltham Abbey

Council Tax band: G

Tenure: Freehold

- DETACHED NEW BUILD
- OPEN PLAN KITCHEN DINER
- EN-SUITE TO MASTER BEDROOM
- UTILITY ROOM
- SEPARATE LOUNGE
- OFF ROAD PARKING
- DOWNSTAIRS WC
- VIEWS ACCROSS PADDOCKS





Ground Floor

Approx. 52.4 sq. metres (564.5 sq. feet)

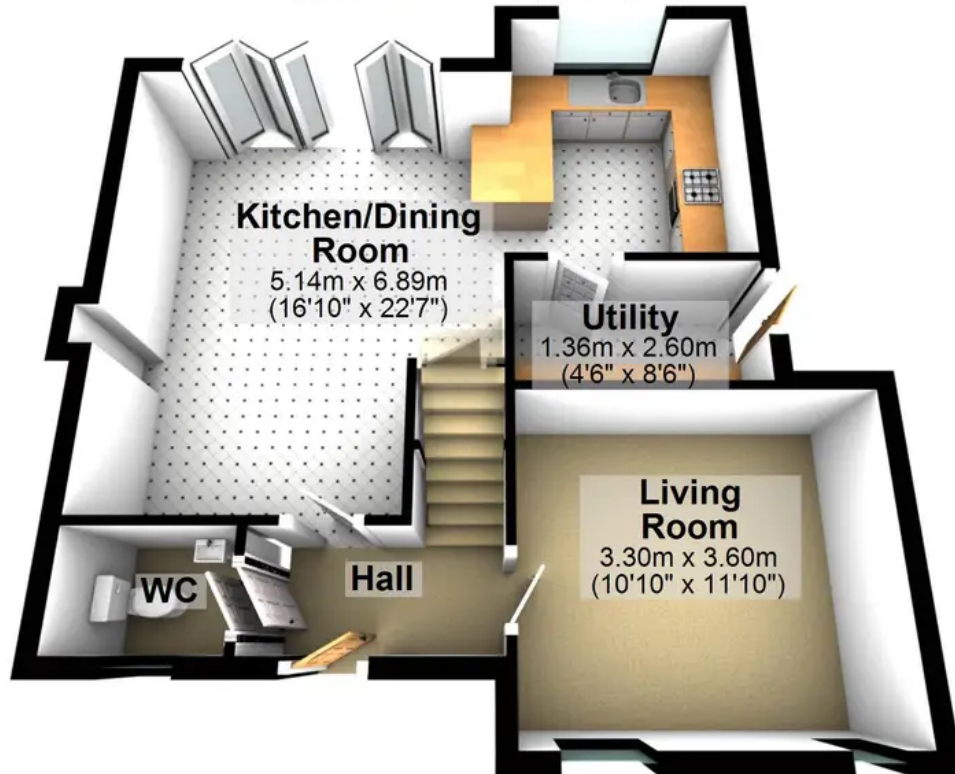

First Floor

Approx. 53.8 sq. metres (579.1 sq. feet)



Total area: approx. 106.2 sq. metres (1143.5 sq. feet)