

Tudor Cottage Woodside

Thornwood, Epping

Jam packed with character, this gorgeous 3 - 4 bedroom cottage tucked away in the peaceful spot of Woodside, Thornwood, is wonderful place to call home.

Council Tax band: C

Tenure: Freehold

- REAR PARKING
- GRADE II LISTED CHARACTER COTTAGE
- SHORT WALK TO EPPING FOREST
- SUNNY REAR GARDEN
- 3/4 BEDROOMS
- INTEGRATED APPLIANCES



Living Room

11' 7" x 10' 11" (3.53m x 3.33m)

Kitchen/Dining Room

15' 9" x 10' 8" (4.80m x 3.25m)

Utility Room

7' 7" x 6' 0" (2.31m x 1.83m)

Bedroom 3

11' 1" x 9' 7" (3.38m x 2.92m)

Bedroom 4

10' 2" x 9' 7" (3.10m x 2.92m)

Bedroom 2

11' 1" x 12' 2" (3.38m x 3.71m)

Bathroom

10' 11" x 8' 6" (3.33m x 2.59m)

Bedroom 1

11' 7" x 10' 11" (3.53m x 3.33m)





Ground Floor

Approx. 62.4 sq. metres (672.1 sq. feet)

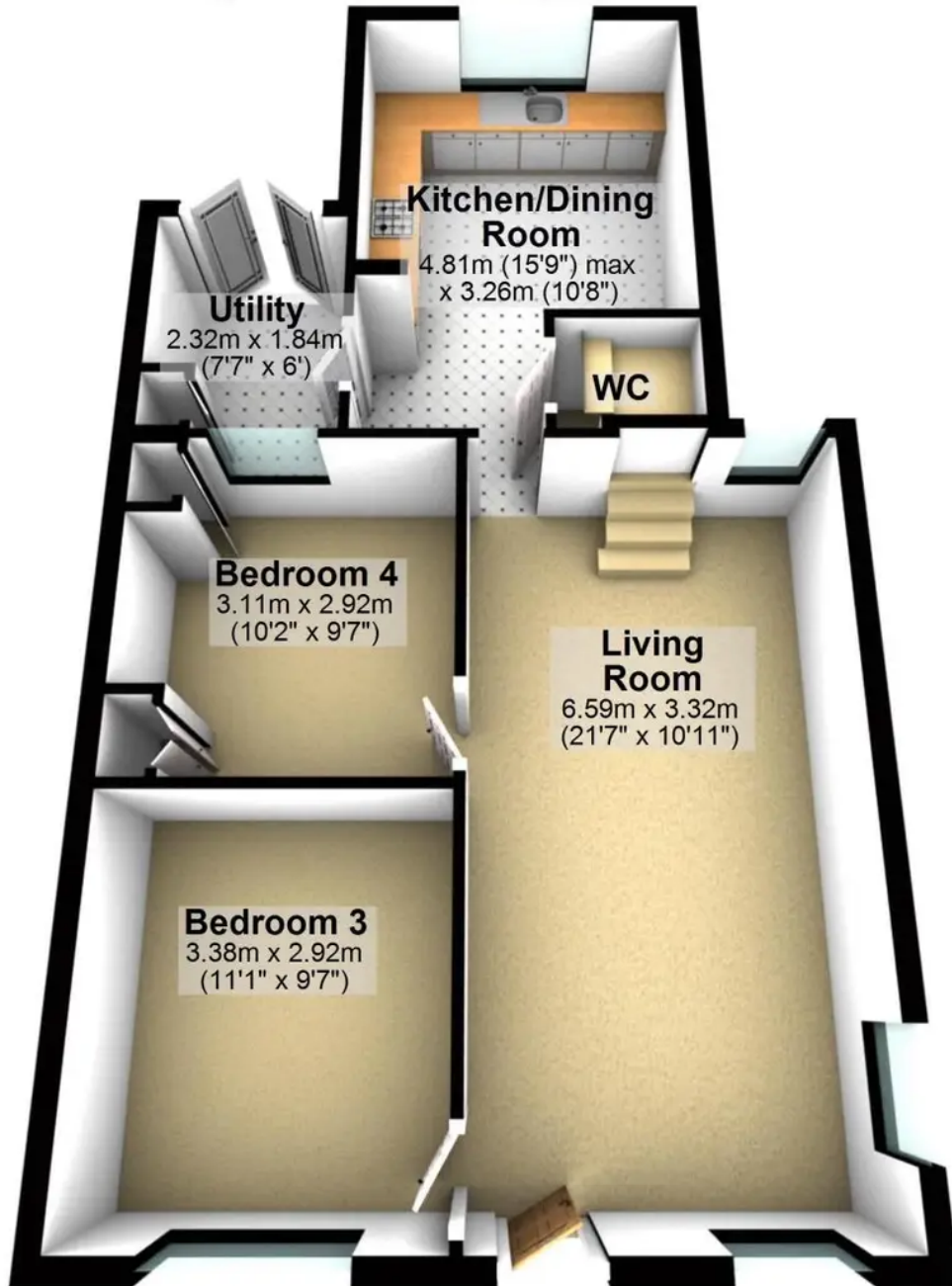

First Floor

Approx. 42.7 sq. metres (459.5 sq. feet)



Total area: approx. 105.1 sq. metres (1131.6 sq. feet)