

60 Epping Road

Toot Hill, Ongar

Council Tax band: F

Tenure: Freehold

- SPLIT LEVEL LIVING
- DOUBLE GARAGE
- STUNNING VIEWS
- POTENTIAL TO EXTEND (STP)
- GATED DETACHED HOME
- SPACIOUS LOUNGE
- SEMI RURAL LIVING
- FAMILY ROOM WITH VIEWS
- UTILITY ROOM
- KITCHEN/DINER

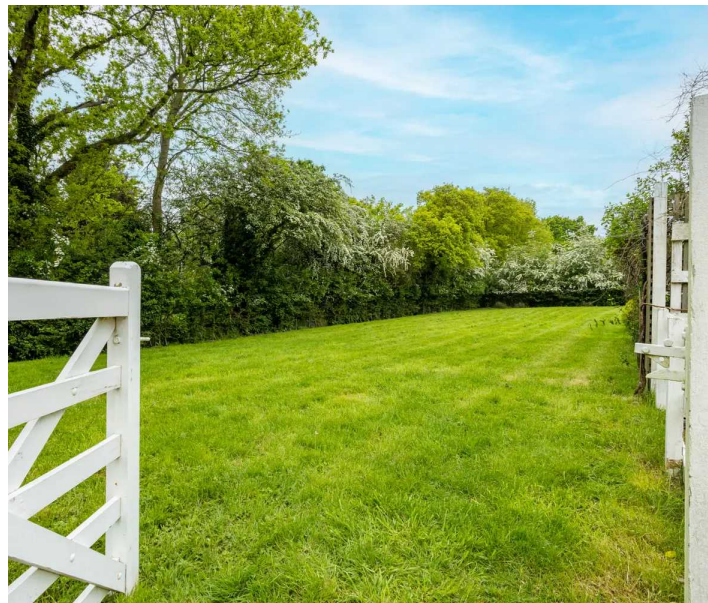

Porch

Entrance Hall

Dining Area

10' 11" x 8' 3" (3.34m x 2.51m)

Kitchen

10' 2" x 11' 7" (3.1m x 3.52m)

Family Room

7' 9" x 15' 10" (2.37m x 4.83m)

Utility Room

6' 7" x 14' 11" (2.01m x 4.56m)

WC

Lounge

15' 6" x 14' 10" (4.73m x 4.52m)

Bedroom 3

8' 9" x 12' 0" (2.67m x 3.67m)

Bedroom 2

11' 8" x 11' 7" (3.55m x 3.54m)

Master Bedroom

17' 5" x 11' 11" (5.31m x 3.63m)

Bathroom

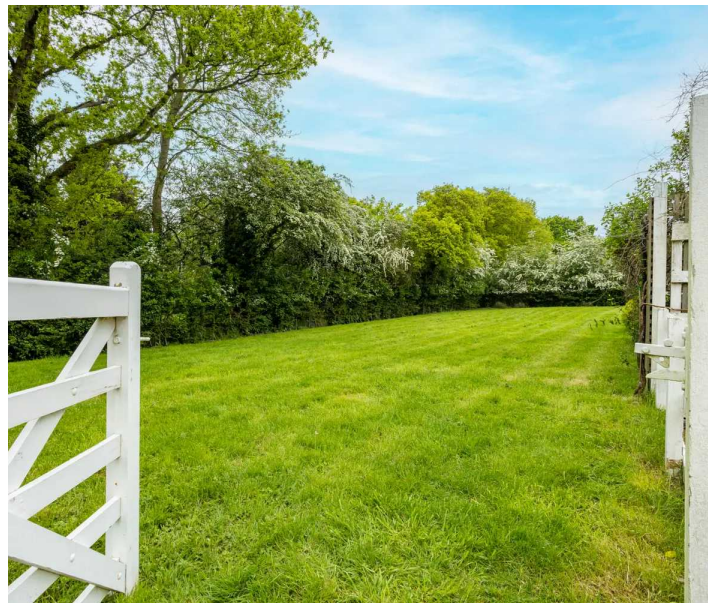



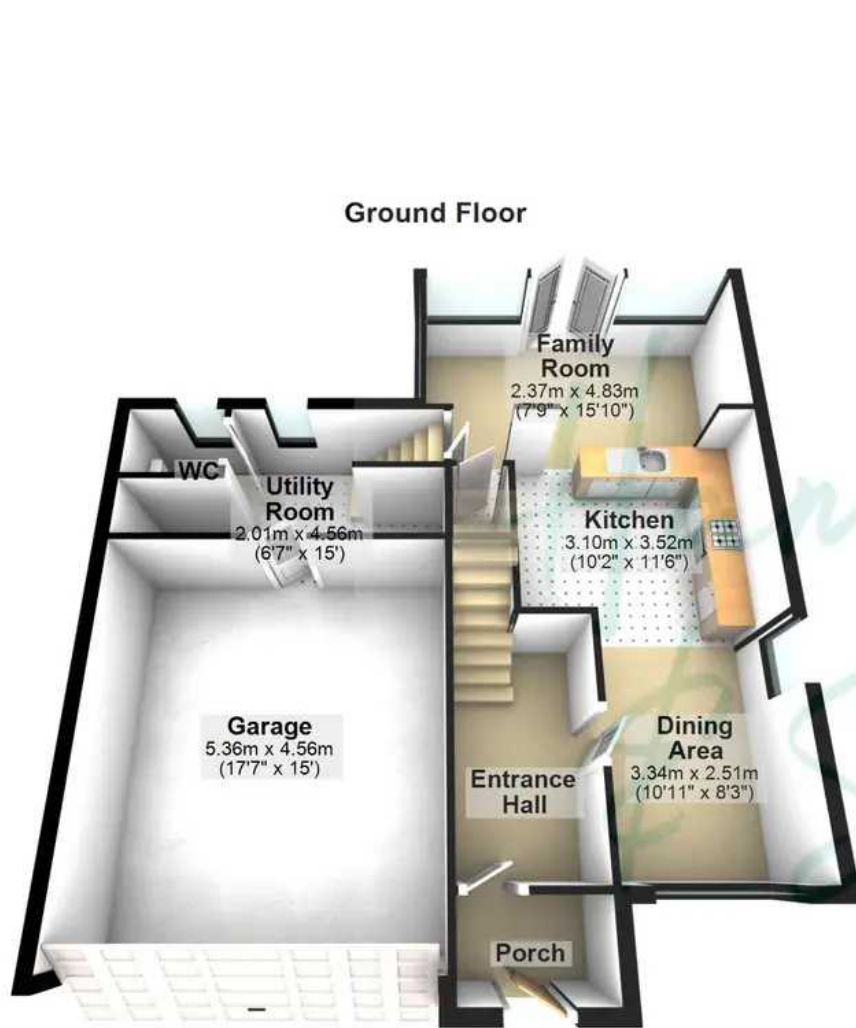

Total area: approx. 167.9 sq. metres (1807.8 sq. feet)

Floorplans are provided for guidance only. They are not to scale & must not form any part of a legal contract or be reproduced
Plan produced using PlanUp.