

31 Sunnyside Road

Epping, Epping

Council Tax band: C

Tenure: Freehold

- PERIOD PROPERTY
- SIDE ACCESS
- POTENTIAL TO EXTEND (STP)
- TWO RECEPTION ROOMS
- FAMILY BATHROOM
- GAS CENTRAL HEATING
- WEST FACING GARDEN
- IVY CHIMNEYS CATCHMENT



Porch

Dining Room

14' 6" x 10' 11" (4.42m x 3.33m)

Lounge

10' 4" x 10' 11" (3.15m x 3.33m)

Kitchen

8' 2" x 10' 11" (2.5m x 3.33m)

Bathroom

Bedroom

10' 7" x 10' 11" (3.23m x 3.33m)

Bedroom

14' 2" x 10' 11" (4.32m x 3.33m)





Ground Floor



First Floor

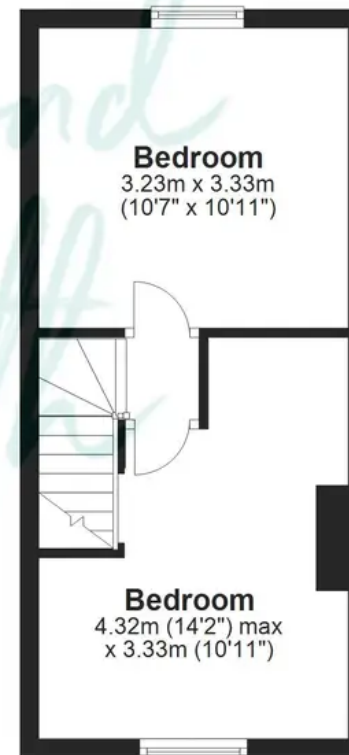

Total area: approx. 65.4 sq. metres (704.2 sq. feet)

Floorplans are provided for guidance only. They are not to scale & must not form any part of a legal contract or be reproduced
Plan produced using PlanUp.