

17 Cedar Court

Epping, Epping

Council Tax band: C

Tenure: Share of Freehold

- FIRST FLOOR APARTMENT
- CLOSE TO STATION
- NEEDS MODERNISATION
- ALLOCATED PARKING
- SHARE OF FREEHOLD
- SHORT WALK TO HIGH STREET
- EPC RATING E



Entrance

Wc

Kitchen

7' 3" x 10' 0" (2.21m x 3.06m)

Lounge/ Diner

13' 1" x 17' 0" (3.98m x 5.18m)

Bedroom One

9' 11" x 13' 1" (3.01m x 4.00m)

En-suite Bathroom





Ground Floor

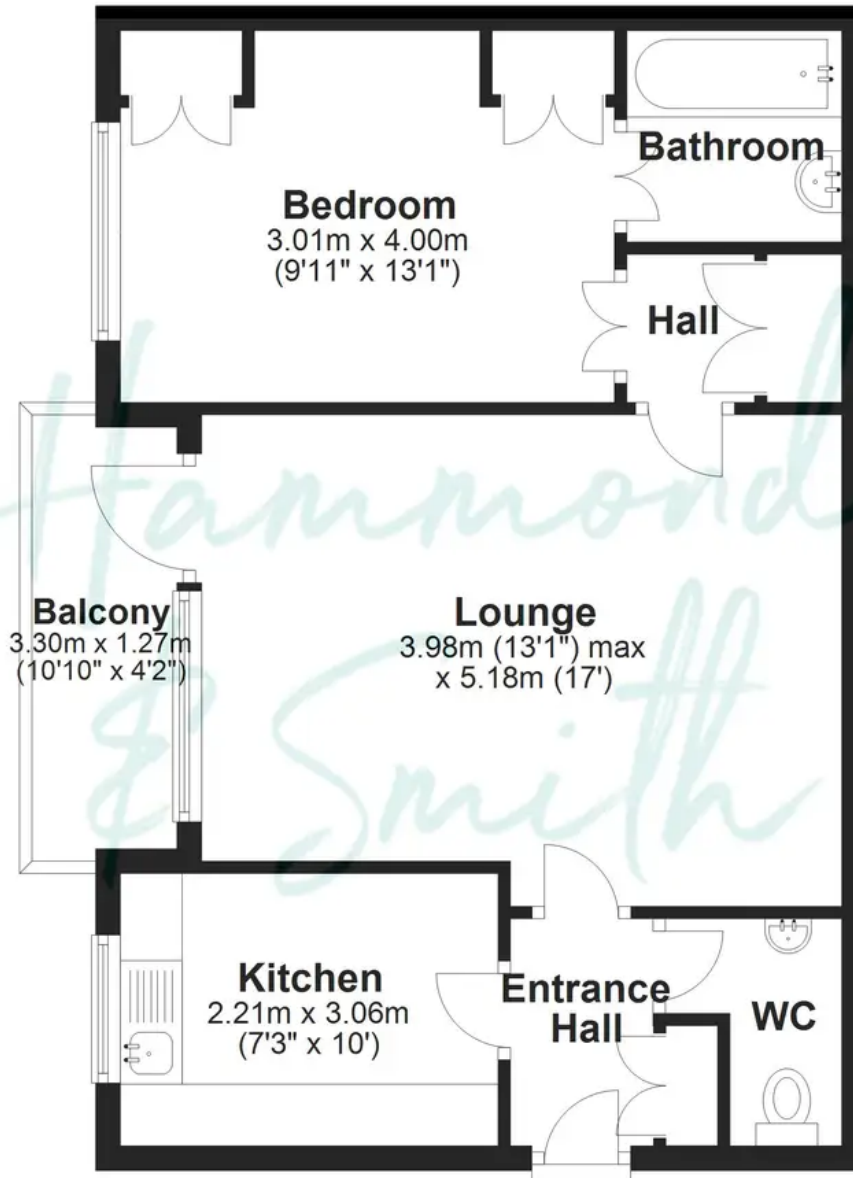

Total area: approx. 50.2 sq. metres (540.7 sq. feet)

Floorplans are provided for guidance only. They are not to scale & must not form any part of a legal contract or be reproduced
Plan produced using PlanUp.