

# 2 Lysander Court High Street

North Weald, Epping

Tenure: Freehold

- MODERN KITCHEN
- FOUR GOOD SIZE BEDROOMS
- TWO BATHROOMS
- DETACHED GARAGE
- GAS CENTRAL HEATING
- DOWNSTAIRS WC
- SHORT WALK TO SCHOOL
- CLOSE TO SHOPS



**Entrance Hall**

**Lounge/Dining Room**

19' 1" x 11' 9" (5.82m x 3.59m)

**Kitchen**

8' 11" x 8' 3" (2.72m x 2.52m)

**First Floor**

**Bedroom One**

12' 4" x 10' 11" (3.75m x 3.32m)

**En-suite Shower Room**

6' 3" x 5' 11" (1.90m x 1.81m)

**Bedroom Two**

10' 7" x 9' 7" (3.22m x 2.91m)

**Bedroom Three**

10' 7" x 9' 5" (3.22m x 2.87m)

**Bedroom Four**

10' 7" x 8' 1" (3.22m x 2.46m)

**Bathroom**

8' 6" x 6' 4" (2.60m x 1.93m)





## Ground Floor

Main area: approx. 37.8 sq. metres (407.3 sq. feet)  
Plus garages, approx. 13.5 sq. metres (145.8 sq. feet)

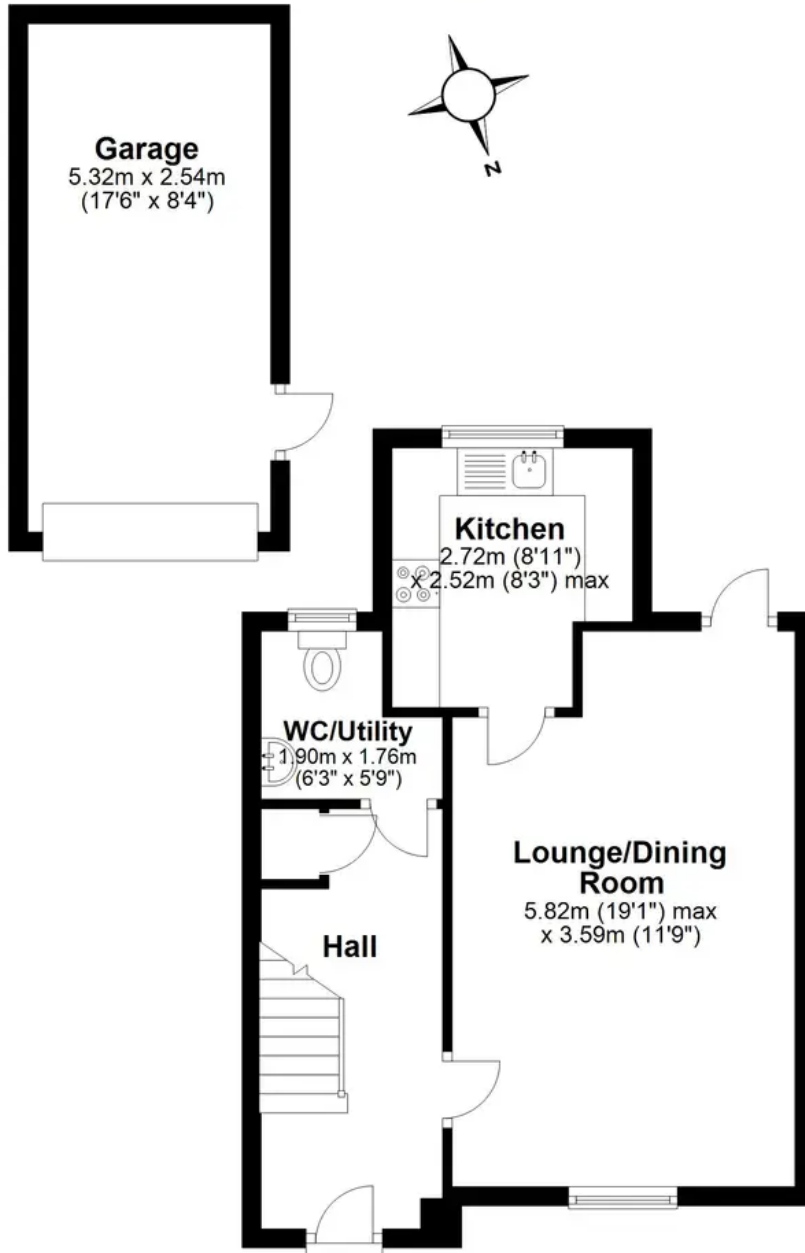

## First Floor

Approx. 59.3 sq. metres (638.0 sq. feet)

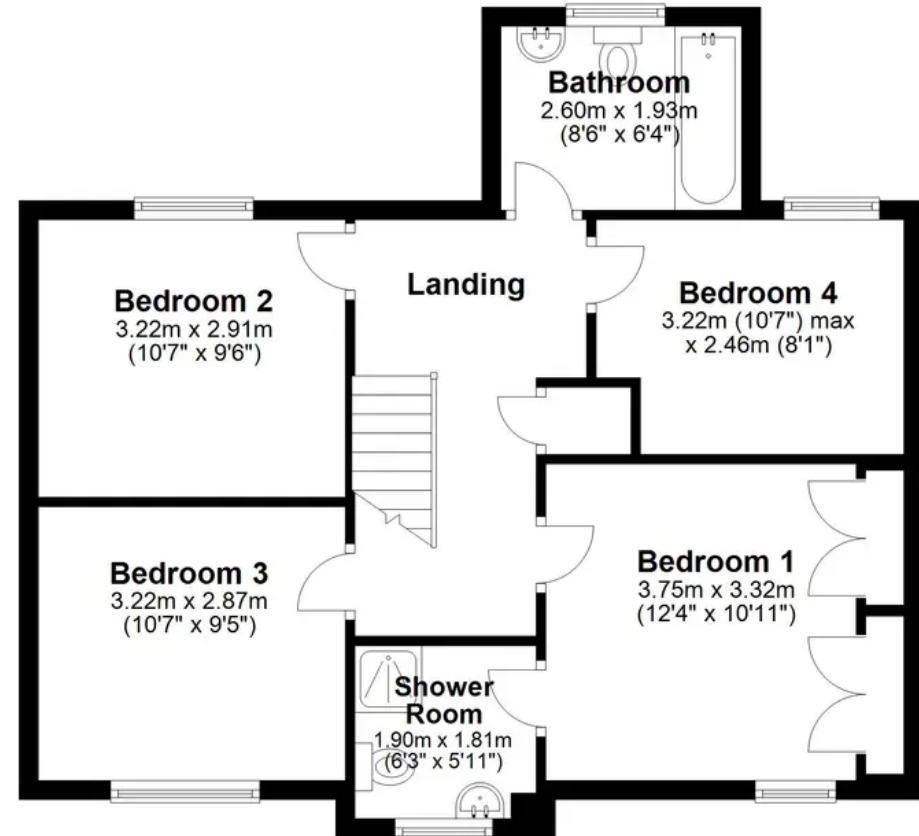

Main area: Approx. 97.1 sq. metres (1045.3 sq. feet)

Plus garages, approx. 13.5 sq. metres (145.8 sq. feet)