







Comet 2U Mono-Glass Module

645W-670W

 **Higher Power**
Lower LCOE

-  Partial Shading Optimisation
-  Better Temperature Coefficient
-  High Temperature Restriction
-  Micro-crack Resistance



Product
Warranty



Performance
Warranty



reddot winner 2023



Munich RE



670W
Output

24.8%
Efficiency

≤1%
First-year Degradation

≤0.35%
Annual Degradation from Year 2-30

30-year Linear Performance Warranty

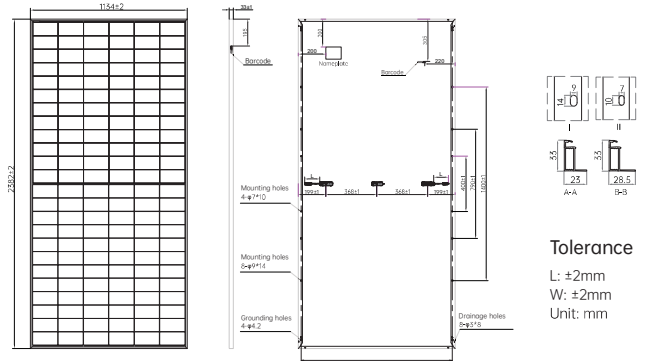
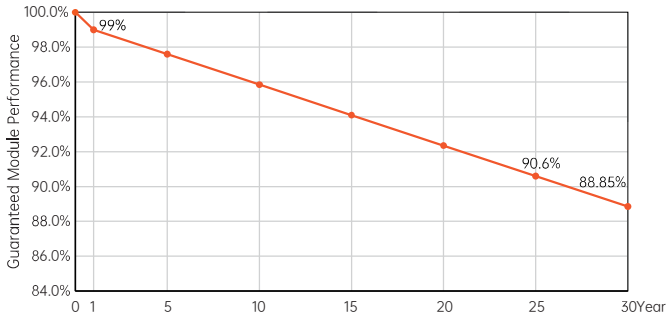

| Electrical Characteristics (STC: AM1.5 1000W/m ² 25°C NOCT: AM1.5 800W/m ² 20°C 1m/s) | | | | | | | | | | | | Power Tolerance: 0~ + 3% | |
|---|-------------------|-------|-------------------|-------|-------------------|-------|-------------------|-------|-------------------|-------|-------------------|--------------------------|--|
| Module Type | AIKO-G645-MCH72Mw | | AIKO-G650-MCH72Mw | | AIKO-G655-MCH72Mw | | AIKO-G660-MCH72Mw | | AIKO-G665-MCH72Mw | | AIKO-G670-MCH72Mw | | |
| Test Conditions | STC | NOCT | STC | NOCT | STC | NOCT | STC | NOCT | STC | NOCT | STC | NOCT | |
| P _{max} [W] | 645 | 486 | 650 | 490 | 655 | 493 | 660 | 497 | 665 | 501 | 670 | 505 | |
| V _{oc} [V] | 54.40 | 51.37 | 54.50 | 51.47 | 54.60 | 51.56 | 54.70 | 51.66 | 54.79 | 51.76 | 54.88 | 51.86 | |
| V _{mp} [V] | 45.21 | 42.70 | 45.31 | 42.79 | 45.41 | 42.89 | 45.51 | 42.99 | 45.61 | 43.09 | 45.71 | 43.19 | |
| I _{sc} [A] | 15.02 | 12.15 | 15.08 | 12.20 | 15.14 | 12.24 | 15.20 | 12.29 | 15.26 | 12.34 | 15.32 | 12.39 | |
| I _{mp} [A] | 14.27 | 11.39 | 14.35 | 11.46 | 14.43 | 11.51 | 14.51 | 11.57 | 14.59 | 11.63 | 14.67 | 11.69 | |
| Module Efficiency | 23.9% | | 24.0% | | 24.2% | | 24.4% | | 24.6% | | 24.8% | | |

Mechanical Specification

| | |
|----------------|---|
| Cell Type | N-Type ABC |
| Glass | 3.2 mm tempered glass |
| Frame | Anodized aluminum |
| Cable | 4mm ² (IEC) 12AWG(UL) +350mm, -280mm/±1400mm or Customized Length |
| No. of Cells | 144(6*24) |
| Junction Box | IP68,3 bypass diodes |
| Connector | MC4 compatible/MC4-Evo2 |
| Weight | 28.2kg±3% |
| Dimension | 2382*1134*33mm |
| Package Detail | 33pcs per pallet / 132pcs per 20'GP / 660pcs per 40'HC |

Temperature Ratings (STC)

| | |
|---|-------------|
| Temperature Coefficient of I _{sc} | + 0.05%/ °C |
| Temperature Coefficient of V _{oc} | - 0.22%/ °C |
| Temperature Coefficient of P _{max} | - 0.26%/ °C |

Installation Guide

| | |
|---|-------------------------------|
| Operation Temperature | -40°C - +85°C |
| Maximum Series Fuse Rating | 30A |
| Protection Class | Class II |
| V _{oc} and I _{sc} Tolerance | ±3% |
| Maximum System Voltage | DC1500V |
| Maximum Static Loading | Front 5400Pa Back 2400Pa |
| Hail Test | 25 mm diameter hail at 23 m/s |
| Fire Rating | IEC Class C |

