

# Perc Mono PV Module

Mono



# 158.75mm

# DHM60X

## 310W-325W

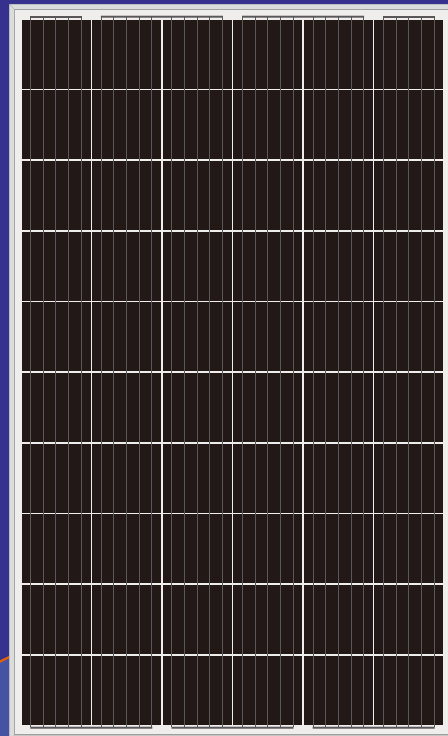

## QUALITY GUARANTEE

### LINEAR POWER OUTPUT GUARANTEE

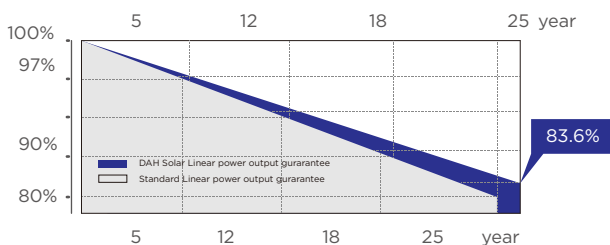

10 years

10-year material & technology warranty

25 years

25-year linear power output warranty

0~+5W

Positive Tolerance

19.48%

Max Module Eff.(%)

## PRODUCT PERFORMANCE ADVANTAGE



Select Grade A crystalline silicon solar cells, high-power output with cost-effective



Preferred packaging materials and strict process technology, excellent PID free performance



Certified by Dust-Sand, Salt-Mist, Ammonia etc. weather resistance tests, strong environmental adaptability



Highly transparent coated tempered glass to increase light absorption and reduce power loss



Optimized frame design to improve PV module load capacity and appearance protection



Excellent low-light performance, increasing power generation efficiency in cloudy, morning and evening



Top runner of smart PV module

**Factory Address:** No.358 Tianhe Road, Luyang Industrial Park, Hefei City, Anhui, China

**Office Address:** Floor 1-3, 6#A, Gongtuo Xinglu Industrial Park, Hefei City, Anhui, China

**Email:** dhsolar@dh-solar.cn **Tel:** +86-551-65176633

# Perc Mono PV Module

## DHM60X 310W-325W

### Design

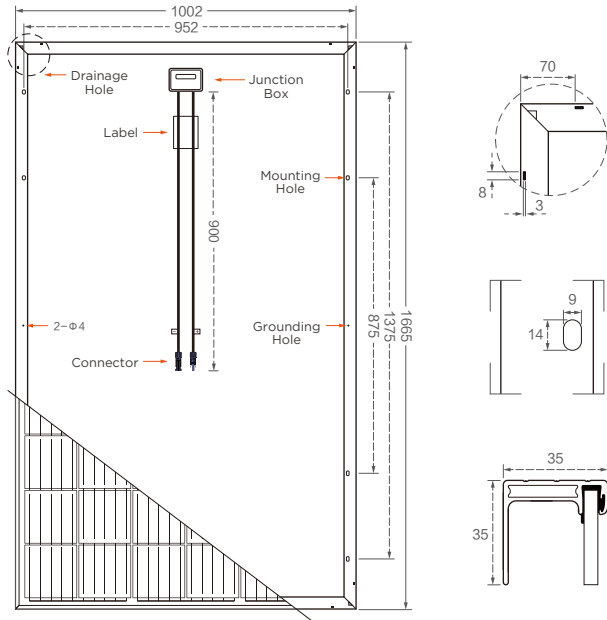

### Mechanical Specification

Cells Type	Mono 158.75×158.75mm
Weight	19kg
Dimension (L×W×T)	1665×1002×35mm
Output Cables	TUV, Length 900mm, 4.0mm <sup>2</sup>
No.of Cells	60(6×10)
Glass	3.2mm High Transmission, Antireflection Coating
Junction box	IP68, 3 Bypass Diodes
Connector	MC4 or MC4 compatible
Packing	30pcs/pallet, 400pcs/20GP, 910pcs/40HQ

### Operating Parameters

Maximum system voltage	1000V/1500V DC
Operating Temperature	-40 ~ +85°C
Maximum series fuse rating	16A
Snow load, frontside	5400Pa
Wind load, backside	2400Pa
Nominal operating cell temperature	45°C±2°C
Application level	Class A

### Electrical Characteristics(STC)

Module Type	DHM60X-310W	DHM60X-315W	DHM60X-320W	DHM60X-325W
Maximum Power (Pmax)	310W	315W	320W	325W
Open-circuit Voltage (Voc)	40.3V	40.5V	40.7V	40.9V
Maximum Power Voltage (Vmp)	33.0V	33.2V	33.4V	33.6V
Short-circuit Current (Isc)	9.89A	9.98A	10.07A	10.16A
Maximum Power Current (Imp)	9.40A	9.49A	9.59A	9.68A
Module Efficiency (%)	18.58%	18.88%	19.18%	19.48%
Power Tolerance	0~+5W			
Temperature Coefficient of Isc	0.048%/°C			
Temperature Coefficient of Voc	-0.28%/°C			
Temperature Coefficient of Pmax	-0.37%/°C			
Standard Test Environment	Irradiance 1000w/m <sup>2</sup> , Cell temperature 25°C, Spectrum AM1.5			

### Electrical Characteristics(NOCT)

Module Type	DHM60X-310W	DHM60X-315W	DHM60X-320W	DHM60X-325W
Maximum Power (Pmax)	231W	235W	239W	242W
Open-circuit Voltage (Voc)	37.4V	37.6V	37.8V	38.0V
Maximum Power Voltage (Vmp)	31.0V	31.2V	31.4V	31.6V
Short-circuit Current (Isc)	8.20A	8.33A	8.44A	8.54A
Maximum Power Current (Imp)	7.49A	7.56A	7.62A	7.66A
Standard Test Environment	Irradiance 800w/m <sup>2</sup> , Cell temperature 20°C, Spectrum AM1.5, Wind speed 1m/s			