

# ORTHODONTIC

## Product Catalogue

**GESTENCO®**

Made by Sweden



# THE COMPANY

## goals and visions

Gestenco International AB has over the years developed and produced a variety of aesthetic orthodontic appliance systems. Several independent in vitro and in vivo university studies have verified our products to be among the best of its kind in the marketplace today. Subsequently, they have been very well received and used for many years by doctors all over the world.

We believe that our appliances have a great advantage to other materials particularly when it comes to things like:

- Aesthetics
- Biocompatibility
- Non-allergic
- Less pain to the patient
- No damage to enamel
- Easy bonding and debonding
- No discoloration
- Very low friction
- Preventing rootresorption

Our products are “made by Sweden” where quality and design is the key to a successful treatment and happy doctors and patients.

# TABLE OF CONTENTS

SPRINGTIME	3	INSTRUMENTS	33
SPRINGTIME C	5	RUBBER SOUL	37
VITRINE	7	LIP AND CHEEK RETRACTORS	39
PHANTOM	9	MARK VI	40
CABRIOLET	11	DAILY MIRROR	41
IMAGE	13	IMAGE TUBE	43
BLONDE RAINBOW	16	SUPPLIES	44
CITIZEN	17		
CITIZEN VOGUE	18		
CITIZEN BUCCAL TUBE	19		
CITIZEN ARCH WIRES	21		
IMAGINATION	23		
SMARTBOND SC	25		
SMARTBOND LC	27		
FREDDY BUTTON	29		
FREDDY HOOK	30		
SUNSET STRIP	31		
BITE-BUMPER	32		



# Springtime™

## metal self-ligation bracket

- Interactive Self-ligating bracket with a clip
- Made of a hard 17-4 stainless steel material.
- Metal injection molding (MIM) advanced technology
- Contoured appearance for maximum comfort
- Mesh base with laser mark
- Available in Roth .022 .018 and MBT



### Passive Phase

Small round wires slide freely, initiating the tooth movement process as the archwire gently levels the teeth and coaxes them into alignment.



### Expressive Phase

Square or rectangular wires are seated into the base of the slot without contacting the clip. Rotations are corrected and space closures are completed.



### Active Phase

Rectangular archwires extend beyond the slot to fully engage the clip, providing the active control necessary for finishing uprighting of the roots and adjusting the torque

Springtime™ Formula Roth*					
Type	Description	Torque	Ang.	.022	
Centrals	Upper right	+12°	5°	SP-11-55	SP-21-55
	left				
Laterals	Upper right	+8°	9°	SP-12-55	SP-22-55
	left				
Cuspids w/hook	Upper right	-2°	10°	SP-13-55HK	SP-23-55HK
	left				
1st Bicuspids	Upper right	-7°	0°	SP-14-55	SP-24-55
	left				
1st Bicuspids	Upper right	-7°	0°	SP-14-55HK	SP-24-55HK
	left				
2nd Bicuspids	Upper right	-7°	0°	SP-15-55	SP-25-55
	left				
2nd Bicuspids	Upper right	-7°	0°	SP-15-55HK	SP-25-55HK
	left				
Anteriors	Lower right	-1°	0°	SP-40-55	SP-30-55
	left				
Cuspids w/hook	Lower right	-11°	7°	SP-43-55HK	SP-33-55HK
	left				
1st Bicuspids	Lower right	-17°	0°	SP-44-55	SP-34-55
	left				
1st Bicuspids	Lower right	-17°	0°	SP-44-55HK	SP-34-55HK
	left				
2nd Bicuspids	Lower right	-22°	0°	SP-45-55	SP-35-55
	left				
2nd Bicuspids	Lower right	-22°	0°	SP-45-55HK	SP-35-55HK
	left				

\* Gestenco Int. does not imply authorization or endorsement by Dr. Roth.

Springtime™ Formula MBT*					
Type	Description	Torque	Ang.	.022	
Centrals	Upper right	+17°	4°	SP-11-52	SP-21-52
	left				
Laterals	Upper right	+10°	8°	SP-12-52	SP-22-52
	left				
Cuspids w/hook	Upper right	-7°	8°	SP-13-52HK	SP-23-52HK
	left				
1st Bicuspids	Upper right	-7°	0°	SP-14-52	SP-24-52
	left				
1st Bicuspids	Upper right	-7°	0°	SP-14-52HK	SP-24-52HK
	left				
2nd Bicuspids	Upper right	-7°	0°	SP-15-52	SP-25-52
	left				
2nd Bicuspids	Upper right	-7°	0°	SP-15-52HK	SP-25-52HK
	left				
Anteriors	Lower right	-6°	0°	SP-40-52	SP-30-52
	left				
Cuspids w/hook	Lower right	-6°	3°	SP-43-52HK	SP-33-52HK
	left				
1st Bicuspids	Lower right	-12°	2°	SP-44-52	SP-34-52
	left				
1st Bicuspids	Lower right	-12°	2°	SP-44-52HK	SP-34-52HK
	left				
2nd Bicuspids	Lower right	-17°	2°	SP-45-52	SP-35-52
	left				
2nd Bicuspids	Lower right	-17°	2°	SP-45-52HK	SP-35-52HK
	left				

\*MBT is a registered trademark by 3M/Unitek. Gestenco's version of the McLaughlin, Bennett and Trevisi prescription is not intended to be a duplication of, nor an endorsement by these doctors and such endorsement is not implied by the use of this term.

# Springtime C™

ceramic self-ligation bracket

- Interactive clear self-ligating bracket with a metal spring-clip
- Dual options for opening the spring-clip/ hole on top or pushing from the gingival side.
- Made of transparent ceramic material.
- Contoured appearance for maximum comfort
- Ceramic mesh base
- Available in Roth .022.



Springtime C™ Formula Roth*				
Type	Description	Torque	Ang.	.022
Centrals	Upper right left	+12°	5°	SPC-11-55 SPC-21-55
Laterals	Upper right left	+8°	9°	SPC-12-55 SPC-22-55
Cuspids w/hook	Upper right left	-2°	10°	SPC-13-55HK SPC-23-55HK
Bicuspid w/hook	Upper right left	-7°	0°	SPC-14-55HK SPC-24-55HK
Anteriors	Lower right left	-1°	0°	SPC-40-55 SPC-30-55
Cuspids w/hook	Lower right left	-11°	+5°	SPC-43-55HK SPC-33-55HK
1st Bicuspid	Lower right left	-17°	0°	SPC-44-55HK SPC-34-55HK
2nd Bicuspid	Lower right left	-22°	0°	SPC-45-55HK SPC-35-55HK

\*Gestenco Int. does not imply authorization or endorsement by Dr. Roth.



# VITRINE™

ceramic brackets



## Mechanical performance

- One-body manufacturing injection process solves the problem of brittleness and breakage and guarantees the precise slot.
- Undercut mesh in base enables optimal bonding strength and easy debonding.

### Physical characteristics

- High breakage resistance and torque strength are achieved from the dense polycrystalline structure.
- Good biocompatibility, colour stability and no discolouration.

## What patients will find...

- Aesthetics  
A more transparent and invisible appearance.
- Comfortable  
Smooth surface, lower profile, smart hooks and perfect rounded facial contours enhance comfort.

### What orthodontists will find...

- Easy identification  
Colour-mark on the gingival distal tie-wings identify the four quadrants.
- FDI notations in the base for accurate placement on the right tooth for Roth
- Accurate placement  
Anatomically contour-compound base for fast and accurate fit.
- Available in Roth .022 / .018. MBT .022

Vitrine™ Formula Roth*					
Type	Description	Torque	Ang.	.018	.022
Centrals	Upper right	+12°	5°	VIM-11-45	VIM-11-55
	left			VIM-21-45	VIM-21-55
Laterals	Upper right	+8°	9°	VIM-12-45	VIM-12-55
	left			VIM-22-45	VIM-22-55
Cuspids w/hook	Upper right	-2°	11°	VIM-13-45HK	VIM-13-55HK
	left			VIM-23-45HK	VIM-23-55HK
Bicuspids	Upper right/left	-7°	0°	VIM-14-45	VIM-14-55
Bicuspids w/hook	Upper right	-7°	0°	VIM-14-45HK	VIM-14-55HK
	left			VIM-24-45HK	VIM-24-55HK
Anteriors	Lower right/left	-1°	2°	VIM-30-45	VIM-30-55
Cuspids w/hook	Lower right	-11°	5°	VIM-43-45HK	VIM-43-55HK
	left			VIM-33-45HK	VIM-33-55HK
1st Bicuspids	Lower right/left	-17°	0°	VIM-44-45	VIM-44-55
1st Bicuspids w/hook	Lower right	-17°	0°	VIM-44-45HK	VIM-44-55HK
	left			VIM-34-45HK	VIM-34-55HK
2nd Bicuspids	Lower right/left	-22°	0°	VIM-45-45	VIM-45-55
2nd Bicuspids w/hook	Lower right	-22°	0°	VIM-45-45HK	VIM-45-55HK
	left			VIM-35-45HK	VIM-35-55HK

\* Gestenco Int. does not imply authorization or endorsement by Dr. Roth.

Vitrine™ MBT*-Style				
Type	Description	Torque	Ang.	.022
Centrals	Upper right	+17°	4°	VIM-11-52
	left			VIM-21-52
Laterals	Upper right	+10°	8°	VIM-12-52
	left			VIM-22-52
Cuspids w/hook	Upper right	-7°	8°	VIM-13-52HK
	left			VIM-23-52HK
Bicuspids w/hook	Upper right	-7°	0°	VIM-14-52HK
	left			VIM-24-52HK
Anteriors	Lower right/left	-6°	0°	VIM-30-52
Cuspids w/hook	Lower right	-6°	3°	VIM-43-52HK
	left			VIM-33-52HK
1st Bicuspids w/hook	Lower right	-12°	2°	VIM-44-52HK
	left			VIM-34-52HK
2nd Bicuspids w/hook	Lower right	-17°	2°	VIM-45-52HK
	left			VIM-35-52HK

\*MBT is a registered trademark by 3M/Unitek. Gestencos version of the McLaughlin, Bennett and Trevisi prescription is not intended to be a duplication of, nor an endorsement by these doctors and such endorsement is not implied by the use of this term.



# PHANTOM™

transparent lingual direct bonding self-ligating bracket



## "THE ÖRTENDAHL LINGUAL SYSTEM"

- Self-ligating
- Direct bonding with fixed placement-jig guarantees correct position
- Interactive in final stage
- Optional tubes on premolars
- Manufactured in a transparent special medical grade polymer
- Great patient comfort from protective closing door
- Ceramic body for strength and secure bonding.
- Metal insert

## WHY A TRANSPARENT LINGUAL BRACKET?

- No dark shades from brackets visible through teeth
- Truly invisible – also on lowers

Phantom™ lingual bracket						
Type	Description	Torque	Ang.	M/D mm	.018	
Cent./ Lat. /Cusp.	Upper/lower Right/left	55°	0°	4.2	PH-10-46	
Bicuspids	Upper /lower Right/left	10°	0°	4.2	PH-20-46	
Tube	Upper/lower	10°	0°	3.5	PH-67-00	

Phantom™ lingual arch wires		
.016 NiTi	Upper	Lower
Small	PH-NT-116S	PH-NT-216S
Medium	PH-NT-116M	PH-NT-216M
Large	PH-NT-116L	PH-NT-216L
.016x.022 NiTi	Upper	Lower
Small	PH-NT-1622S	PH-NT-2622S
Medium	PH-NT-1622M	PH-NT-2622M
Large	PH-NT-1622L	PH-NT-2622L
.016x.022 TiMb	PH-TI-1622	PH-TI-2622
.016x.022 SS	PH-SS-1622	PH-SS-2622

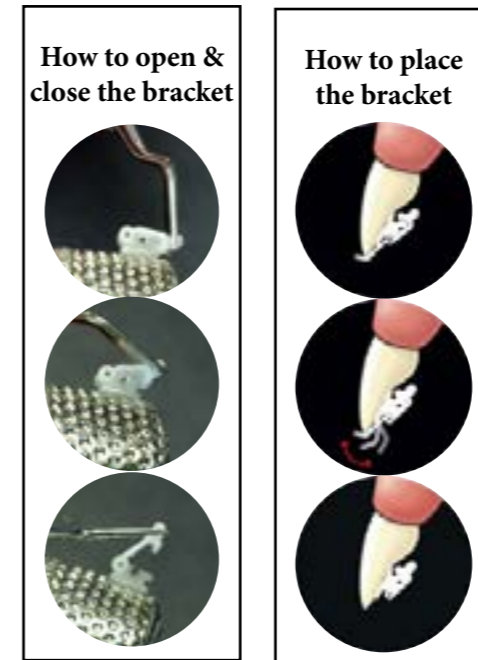

1. Put the placement-guide against the incisal edge for aligning and vertical distance
2. After bond set remove the guide by moving it back and forward 2-3 times
3. Open door for wire insertion with special instrument

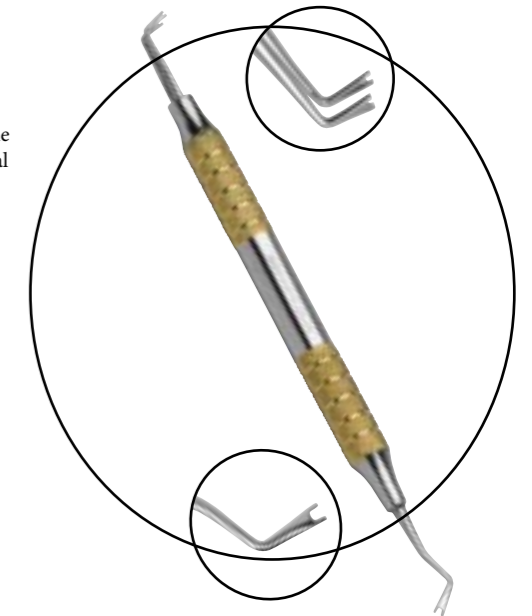

Phantom™ /Duett cap opener  
PH-CO-01

Phantom™ Pearl chain	
Continuous	PC-00-01
Short	PC-00-02
Long	PC-00-03



## Convenient starter kit

### Contents

- Brackets and tubes
- Selected wire sequence
- Special thin elastic chains
- Instrument for door opening and wire-placement
- Practise thimble



# CABRIOLET™

the clear hybrid self-ligating ortho appliance



- Polymer snap-on door for easy and fast closing/opening - also protects in trauma situations.
- Ceramic body for strength and secure bonding.
- Slim design with low profile.
- Centred T hook for elastics and fits all NiTi chains.
- Both passive and active.
- Stainless steel hinge.
- Metal insert for reduced wire- friction.
- Radius in base for easier de-bonding.
- FDI notation in base for easy identification.



Cabriolet™ Formula Roth*							
Type	Description	Torque	Ang.	M/D mm	.018	.022	
Centrals	Upper right	+12°	5°	3.3	CA-11-45	CA-11-55	
	left				CA-21-45	CA-21-55	
Laterals	Upper right	+8°	9°	3	CA-12-45	CA-12-55	
	left				CA-22-45	CA-22-55	
Cuspids w/hook	Upper right	-2°	9°	3	CA-13-45HK	CA-13-55HK	
	left				CA-23-45HK	CA-23-55HK	
Bicuspids w/hook	Upper right/left	-7°	0°	3	CA-14-45HK	CA-14-55HK	
Anteriors	Lower right/left	0	0°	3	CA-30-45	CA-30-55	
Cuspids w/hook	Lower right	-11	5°	3	CA-43-45HK	CA-43-55HK	
	left				CA-33-45HK	CA-33-55HK	
1st Bicuspids	Lower right/left	-17	0°	3	CA-44-45	CA-44-55	
2nd Bicuspids	Lower right left	-22°	0°	3.	CA-45-45	CA-45-55	

\* Gestenco Int. does not imply authorization or endorsement by Dr. Roth.

## Cap opener

A double ended instrument with one end specially designed to open the cap on the Cabriolet brackets, and the other end with a wire director and height gauge.



Cap Opener	
Description	Catalogue No.
Cap opener	CO-00-01



# IMAGE™

aesthetics in every case and prescription



Image™ Standard Edgewise				
Type	Description	M/D mm	.018	.022
Centrals/Laterals	Upper right/left	3.5	IM-10-44	IM-10-54
Cuspids/Bicus-pids	Upper right/left	3.5	IM-20-44	IM-20-54
Anteriors	Lower right/left	2.6	IM-30-44	IM-30-54
Cuspids/Bicus-pids	Lower right/left	3.5	IM-40-44	IM-40-54

Image™ Formula Roth*							
Type	Description	Torque	Ang.	Offset	M/D mm	.018	.022
Centrals	Upper right left	+12°	5°	0°	3.5	IM-11-45 IM-21-45	IM-11-55 IM-21-55
Laterals	Upper right left	+8°	9°	0°	3.5	IM-12-45 IM-22-45	IM-12-55 IM-22-55
Cuspids	Upper right left	-2°	9°	4°M	3.5	IM-13-45 IM-23-45	IM-13-55 IM-23-55
Cuspids w/hook	Upper right left	-2°	9°	4°M	3.5	IM-13-45HK IM-23-45HK	IM-13-55HK IM-23-55HK
Bicuspids	Upper right/left	-7°	0°	0°	3.3	IM-14-45	IM-14-55
Bicuspids w/hook	Upper right/left	-7°	0°	0°	3.3	IM-14-45HK	IM-14-55HK
Anteriors	Lower right/left	0°	0°	0°	3.0	IM-30-45	IM-30-55
Cuspids	Lower right left	-11°	5°	2°M	3.5	IM-43-45 IM-33-45	IM-43-55 IM-33-55
Cuspids w/hook	Lower right left	-11°	5°	2°M	3.5	IM-43-45HK IM-33-45HK	IM-43-55HK IM-33-55HK
Bicuspids	Lower right/left	-17°	0°	0°	3.3	IM-44-45	IM-44-55

\* Gestenco Int. does not imply authorization or endorsement by Dr. Roth.

## THE PERFECT COMBINATION OF AESTHETICS AND CLINICAL PERFORMANCE

Image is made of a special grade polymer enforced with glassfiber, in order to reinforce the bracket to withstand all necessary orthodontic forces, without losing its flexibility.

### GOOD LOOKS

Image stain-resistant material retains an aesthetic appearance throughout treatment. Upper and lower arches can confidentially be bonded, since enamel wear is virtually eliminated when in occlusion.

### BONDING

Use your favourite bonding material, the mechanical lock base provides for easy and safe bonding, without the need for additional conditioners.

### MARKING

A colour-coding system and placement jigs makes identification and alignment on the tooth real easy.

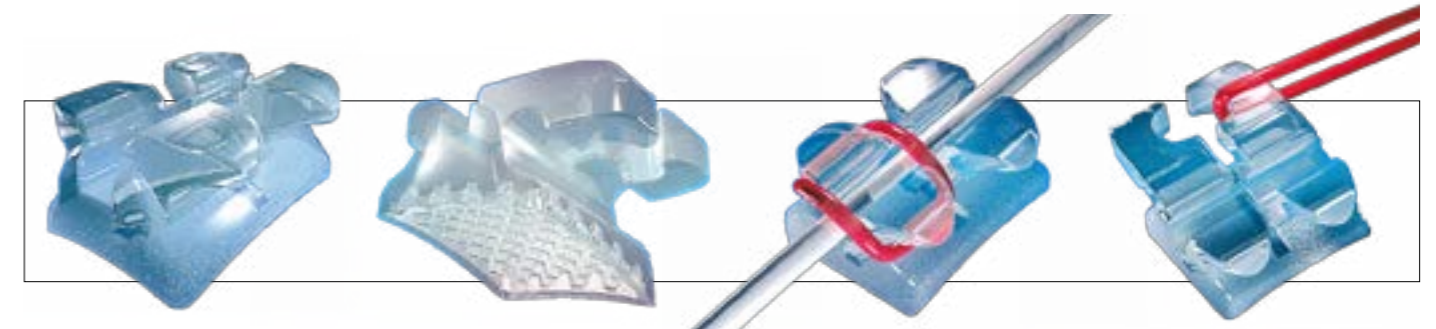

The relative ductility of the material combined with Image contoured compound curvature assures proven fit and bond-strength, without the concern of debonding complications.

The mechanical lock base on the Image bracket provides 150% more bonding surface.

The ability to tie one set of wings in the most severe malocclusions helps provide the necessary rotational control.

Double hook design for easy engagement of intraoral elastics.



# IMAGE™

Image™ Ricketts Biopressive*						
Type	Description	Torque	Ang.	M/D mm	.018	
Centrals	Upper right left	+22°	0°	3.5	IM-11-47 IM-21-47	
Laterals	Upper right left	+14°	8°	3.5	IM-12-47 IM-22-47	
Cuspids	Upper right left	+7°	5°	3.5	IM-13-47 IM-23-47	
Bicuspid	Upper right/left	0°	0°	3.3	IM-14-47	
Anteriors	Lower right/left	0°	0°	3.0	IM-30-47	
Cuspids	Lower right left	+7°	5°	3.5	IM-43-47 IM-33-47	
Bicuspid	Lower right/left	0°	0°	3.5	IM-44-47	

Image™ MBT*-Style						
Type	Description	Torque	Ang.	M/D mm	.022	
Centrals	Upper right left	+17°	4°	3.5	IM-11-52 IM-21-52	
Laterals	Upper right left	+10°	8°	3.5	IM-12-52 IM-22-52	
Cuspids	Upper right left	-7°	8°	3.5	IM-13-52 IM-23-52	
Cuspids w/hook	Upper right left	-7°	8°	3.5	IM-13-52HK IM-23-52HK	
Bicuspid	Upper right/left	-7°	0°	3.3	IM-14-52	
Bicuspid w/hook	Upper right/left	-7°	0°	3.3	IM-14-52HK	
Anteriors	Lower right/left	-6°	0°	3.0	IM-30-52	
Cuspids	Lower right left	-6°	3°	3.5	IM-43-52 IM-33-52	
Cuspids w/hook	Lower right left	-6°	3°	3.5	IM-43-52HK IM-33-52HK	
Bicuspid	Lower right/left	-17°	0°	3.3	IM-44-52	

\*MBT is a registered trademark by 3M/Unitek. Gestenco version of the McLaughlin, Bennett, and Trevisi prescription is not intended to be a duplication of, nor an endorsement by these doctors and such endorsement is not implied by the use of this term.

# BLONDE™

## Rainbow edition

Put some colours into your patients smile with coloured blonde

Most young patients prefer coloured ligatures.

Why not go all the way and offer them coloured brackets like the Blonde Rainbow Edition, a composite bracket in pink, blue, red and pearl violet.

### Glass-reinforced composite polymer bracket

Blonde offers both the strength and the good looks that will give you and your patient great satisfaction. The Blonde bracket is available in Standard Edgewise and in a complete and true "Straight-Arch" formula with:

- Ins and outs
- Torque in base
- Rhomboid shape for easy bracketplacement
- Rotation and anti-rotation offsets
- Hooks on cuspids U/L/bicuspid Upper
- Mechanical/chemical lock bonding base
- Each bracket is identified, according to the FDI system, with engraved numbers in the bracketbase



Blonde™ Rainbow formula Roth - Available in slot .018 and .022						
Type	Description	Torque	Ang	Offset	M/D mm	
Centrals	Upper right/left	+12°	5°	0°	3,5	
Laterals	Upper right/left	+8°	9°	0°	3,5	
Cuspids w/hook	Upper right/left	-2°	9°	4°M	3,5	
Bicuspid w/hook	Upper right/left	-7°	0°	0°	3,3	
Anteriors	Lower right/left	0°	0°	0°	3	
Cuspids w/hook	Lower right/left	-11°	5°	2°M	3,5	
Bicuspid	Lower right/left	-17°	0°	0°	3,3	

\* Gestenco Int. does not imply authorization or endorsement by Dr. Roth.

# CITIZEN™

## medium and mini metal brackets with sandblasted base

- Prescription Roth and MBT
- Slot .018 and .022
- Hooks on 3 or 3, 4, 5
- Lower profile design for minimum occlusal interference
- Deeper tie wings undercut for easy ligation
- Anatomically contoured sandblasted mesh base for better bond strength and accurate fit.
- Rhomboidal shape
- Colour coding on bracket wings
- 80 gauge mesh pad for an anatomically formed fit and maximum bonding strength

For mini size add M to part number ex. CIM-11-45



Citizen™ Formula Roth* medium size					
Type	Description	Torque	Angulation	Roth .018	Roth .022
Centrals	Upper right	12°	5°	CI-11-45	CI-11-55
	left	12°	5°	CI-21-45	CI-21-55
Laterals	Upper right	8°	9°	CI-12-45	CI-12-55
	left	8°	9°	CI-22-45	CI-22-55
Cuspids	Upper right	-2°	11°	CI-13-45	CI-13-55
	left	-2°	11°	CI-23-45	CI-23-55
Cuspids w/hk	Upper right	-2°	11°	CI-13-45HK	CI-13-55HK
	left	-2°	11°	CI-23-45HK	CI-23-55HK
1 <sup>st</sup> Bicuspids	Upper right	-7°	0°	CI-14-45	CI-14-55
	left	-7°	0°	CI-24-45	CI-24-55
1 <sup>st</sup> Bicuspids w/hk	Upper right	-7°	0°	CI-14-45HK	CI-14-55HK
	left	-7°	0°	CI-24-45HK	CI-24-55HK
2 <sup>nd</sup> Bicuspids w/hk	Upper right	-7°	0°	CI-15-45	CI-15-55
	left	-7°	0°	CI-25-45	CI-25-55
2 <sup>nd</sup> Bicuspids w/hk	Upper right	-7°	0°	CI-15-45HK	CI-15-55HK
	left	-7°	0°	CI-25-45HK	CI-25-55HK
1 <sup>st</sup> Anteriors	Lower right	-1°	2°	CI-41-45	CI-41-55
	left	-1°	2°	CI-31-45	CI-31-55
2 <sup>nd</sup> Anteriors	Lower right	-1°	2°	CI-42-45	CI-42-55
	left	-1°	2°	CI-32-45	CI-32-55
Cuspids	Lower right	-11°	5°	CI-43-45	CI-43-55
	left	-11°	5°	CI-33-45	CI-33-55
Cuspids w/hk	Lower right	-11°	5°	CI-43-45HK	CI-43-55HK
	left	-11°	5°	CI-33-45HK	CI-33-55HK
1 <sup>st</sup> Bicuspids	Lower right	-17°	0°	CI-44-45	CI-44-55
	left	-17°	0°	CI-34-45	CI-34-55
1 <sup>st</sup> Bicuspids w/hk	Lower right	-17°	0°	CI-44-45HK	CI-44-55HK
	left	-17°	0°	CI-34-45HK	CI-34-55HK
2 <sup>nd</sup> Bicuspids	Lower right	-22°	0°	CI-45-45	CI-45-55
	left	-22°	0°	CI-35-45	CI-35-55
2 <sup>nd</sup> Bicuspids	Lower right	-22°	0°	CI-45-45HK	CI-45-55HK
	left	-22°	0°	CI-35-45HK	CI-35-55HK

\* Gestenco Int. does not imply authorization or endorsement by Dr. Roth.

Citizen™ Formula MBT* medium size					
Type	Description	Torque	Angulation	MBT .018	MBT .022
Centrals	Upper right	17°	4°	CI-11-42	CI-11-52
	left	17°	4°	CI-21-42	CI-21-52
Laterals	Upper right	10°	8°	CI-12-42	CI-12-52
	left	10°	8°	CI-22-42	CI-22-52
Cuspids	Upper right	-7°	8°	CI-13-42	CI-13-52
	left	-7°	8°	CI-23-42	CI-23-52
Cuspids w/hk	Upper right	0°	0°	CI-13-42HK	CI-13-52HK
	left	0°	0°	CI-23-42HK	CI-23-52HK
1 <sup>st</sup> Bicuspids	Upper right	-7°	0°	CI-14-42	CI-14-52
	left	-7°	0°	CI-24-42	CI-24-52
1 <sup>st</sup> Bicuspids w/hk	Upper right	-7°	0°	CI-14-42HK	CI-14-52HK
	left	-7°	0°	CI-24-42HK	CI-24-52HK
2 <sup>nd</sup> Bicuspids	Upper right	-7°	0°	CI-15-42	CI-15-52
	left	-7°	0°	CI-25-42	CI-25-52
2 <sup>nd</sup> Bicuspids w/hk	Upper right	-7°	0°	CI-15-42HK	CI-15-52HK
	left	-7°	0°	CI-25-42HK	CI-25-52HK
1 <sup>st</sup> Anteriors	Lower right	-6°	0°	CI-41-42	CI-41-52
	left	-6°	0°	CI-31-42	CI-31-52
2 <sup>nd</sup> Anteriors	Lower right	-6°	0°	CI-42-42	CI-42-52
	left	-6°	0°	CI-32-42	CI-32-52
Cuspids	Lower right	-6°	3°	CI-43-42	CI-43-52
	left	-6°	3°	CI-33-42	CI-33-52
Cuspids w/hk	Lower right	0°	3°	CI-43-42HK	CI-43-52HK
	left	0°	3°	CI-33-42HK	CI-33-52HK
1 <sup>st</sup> Bicuspids	Lower right	-12°	2°	CI-44-42	CI-44-52
	left	-12°	2°	CI-34-42	CI-34-52
1 <sup>st</sup> Bicuspids w/hk	Lower right	-12°	2°	CI-44-42HK	CI-44-52HK
	left	-12°	2°	CI-34-42HK	CI-34-52HK
2 <sup>nd</sup> Bicuspids	Lower right	-17°	2°	CI-45-42	CI-45-52
	left	-17°	2°	CI-35-42	CI-35-52
2 <sup>nd</sup> Bicuspids	Lower right	-17°	2°	CI-45-42HK	CI-45-52HK
	left	-17°	2°	CI-35-42HK	CI-35-52HK

\*MBT is a registered trademark by 3M/Unitek. Gestenco version of the McLaughlin, Bennett and Trevisi prescription is not intended to be a duplication of, nor an endorsement by these doctors and such endorsement is not implied by the use of this term.



Citizen Vogue edition

### Citizen™ lingual metal button

Description	Catalog no.
Flat base	CIB-00-01
Curved base	CIB-00-02



# CITIZEN™

## metal buccal tubes

What orthodontists will find..

- Trumpet entry for fast guiding of the arch wire
- Color code and base laser mark makes it easy to identify
- Positioning notch to assist with placement
- Rounded ball hook design offer maximum comfort.
- 80 gauge mesh pad for an anatomically formed fit and maximum bonding strength
- Metal injection molding (MIM) for low friction and precise accuracy

What patients will find..

- Maximum comfort due to the low profile, rounded edge ballhook
- Minimal irritation due to smooth design with no sharp edges.
- Excellent biocompatibility from highly corrosion resistant stainless steel

Citizen™ Tube Formula Roth*				
Description	Torque	Offset	Roth .022 convert	Roth .022 nonconvert
1 <sup>st</sup> molar, upper right	-9	7	CI-16-221	CI-16-222
left	-9	7	CI-26-221	CI-26-222
1 <sup>st</sup> molar, lower left	-30	7	CI-36-221	CI-36-222
right	-30	7	CI-46-221	CI-46-222
			<b>Roth .018 convert</b>	<b>Roth .018 nonconvert</b>
1 <sup>st</sup> molar, upper right	-9	7	CI-16-181	CI-16-182
left	-9	7	CI-26-181	CI-26-182
1 <sup>st</sup> molar, lower left	-30	7	CI-36-181	CI-36-182
right	-30	7	CI-46-181	CI-46-182
				<b>Roth .022 nonconvert</b>
2 <sup>nd</sup> molar, upper right	-9	6	-	CI-17-222
left	-9	6	-	CI-27-222
2 <sup>nd</sup> molar, lower left	-30	6	-	CI-37-222
right	-30	6	-	CI-47-222
				<b>Roth .018 nonconvert</b>
2 <sup>nd</sup> molar, upper right	-9	6	-	CI-17-182
left	-9	6	-	CI-27-182
2 <sup>nd</sup> molar, lower left	-30	6	-	CI-37-182
right	-30	6	-	CI-47-182

\* Gestenco Int. does not imply authorization or endorsement by Dr. Roth.



Convertible buccal tubes

Citizen™ Tube Formula MBT*				
Description	Torque	Offset	MBT .022 convert	MBT .022 nonconvertw
1 <sup>st</sup> molar, upper right	-14	10	CI-16-223	CI-16-224
left	-14	10	CI-26-223	CI-26-224
1 <sup>st</sup> molar, lower left	-20	0	CI-36-223	CI-36-224
right	-20	0	CI-46-223	CI-46-224
			<b>MBT .018 convert</b>	<b>MBT .018 nonconvert</b>
1 <sup>st</sup> molar, upper right	-14	10	CI-16-183	CI-16-184
left	-14	10	CI-26-183	CI-26-184
1 <sup>st</sup> molar, lower left	-20	0	CI-36-183	CI-36-184
right	-20	0	CI-46-183	CI-46-184
				<b>MBT .022 nonconvert</b>
2 <sup>nd</sup> molar, upper right	-14	10	-	CI-17-224
left	-14	10	-	CI-27-224
2 <sup>nd</sup> molar, lower left	-10	0	-	CI-37-224
right	-10	0	-	CI-47-224
				<b>MBT .018 nonconvert</b>
2 <sup>nd</sup> molar, upper right	-14	10	-	CI-17-184
left	-14	10	-	CI-27-184
2 <sup>nd</sup> molar, lower left	-10	0	-	CI-37-184
right	-10	0	-	CI-47-184

\*MBT is a registered trademark by 3M/Unitek. Gestencos version of the McLaughlin, Bennett and Trevisi prescription is not intended to be a duplication of, nor an endorsement by these doctors and such endorsement is not implied by the use of this term.



Nonconvertible buccal tubes

# CITIZEN™

arch wires MBT\*-style

Recovery force Nickel titanium

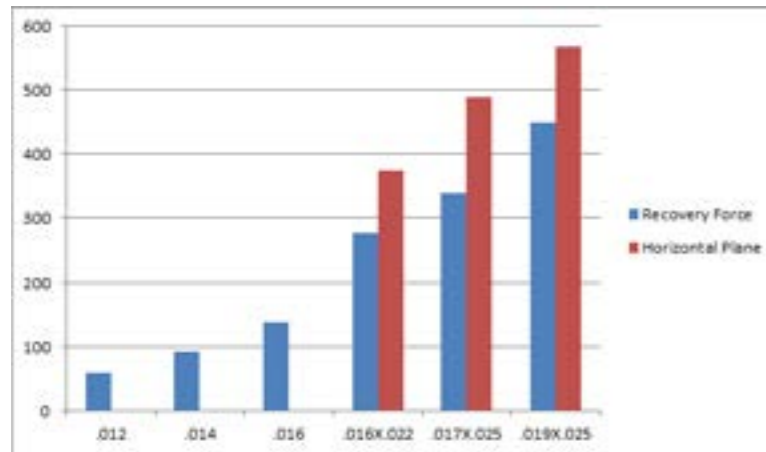

The Citizen Nickel Titanium is a uniquely enhanced alloy that has been exclusively formulated to yield consistent and specific force, memory, and elasticity values.

The clinically significant characteristics of Citizen Nickel Titanium include lower initial load forces, for patient comfort, and increased residual forces as full shape recovery progresses. Teeth move farther and faster.

By applying internationally recognized quality standards in our production processes, we can consistently deliver world class quality to our customers

The Stainless steel archwires are made by high quality 304v medical grade stainless steel.

By using only 304v medical grade stainless steel in conjunction with state-of-the-art wire forming equipment, we can ensure you a precise, high-quality stainless steel arch with consistent performance characteristics and integrity.

\*MBT is a registered trademark by 3M/Unitek. Gestencos version of the McLaughlin, Bennett and Trevisi prescription is not intended to be a duplication of, nor an endorsement by these doctors and such endorsement is not implied by the use of this term.

Recovery Force Stainless Steel

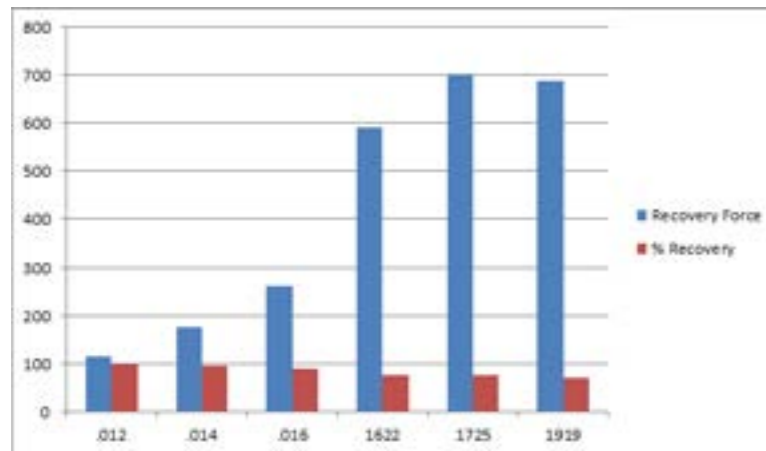

Wire size	Citizen™ Nickel-Titanium (units of 10)		Stainless Steel (units of 10)	
	Upper	Lower	Upper	Lower
.012	CIW-NT-112	CIW-NT-212	CIW-SS-112	CIW-SS-212
.014	CIW-NT-114	CIW-NT-214	CIW-SS-114	CIW-SS-214
.016	CIW-NT-116	CIW-NT-216	CIW-SS-116	CIW-SS-216
.016X.022	CIW-NT-1622	CIW-NT-2622	CIW-SS-1622	CIW-SS-2622
.017X.025	CIW-NT-1725	CIW-NT-2725	CIW-SS-1725	CIW-SS-2725
.019X.025	CIW-NT-1925	CIW-NT-2925	CIW-SS-1925	CIW-SS-2925

Citizen™ Posted Stainless Steel (units of 10)		
Wire size		
.016X.022	22mm	CIW-PW-162222
.016X.022	24mm	CIW-PW-162224
.016X.022	26mm	CIW-PW-162226
.016X.022	28mm	CIW-PW-162228
.016X.022	30mm	CIW-PW-162230
.016X.022	32mm	CIW-PW-162232
.016X.022	34mm	CIW-PW-162234
.016X.022	36mm	CIW-PW-162236
.016X.022	38mm	CIW-PW-162238
.016X.022	40mm	CIW-PW-162240
.016X.022	42mm	CIW-PW-162242
.016X.022	44mm	CIW-PW-162244
.019X.025	22mm	CIW-PW-192522
.019X.025	24mm	CIW-PW-192524
.019X.025	26mm	CIW-PW-192526
.019X.025	28mm	CIW-PW-192528
.019X.025	30mm	CIW-PW-192530
.019X.025	32mm	CIW-PW-192532
.019X.025	34mm	CIW-PW-192534
.019X.025	36mm	CIW-PW-192536
.019X.025	38mm	CIW-PW-192538
.019X.025	40mm	CIW-PW-192540
.019X.025	42mm	CIW-PW-192542
.019X.025	44mm	CIW-PW-192544

Citizen™ Heat-NiTi Arch wire (units of 10)		
Wire size	Upper	Lower
.014	CIW-HNT-114	CIW-HNT-214
.016	CIW-HNT-116	CIW-HNT-216
.016X.022	CIW-HNT-1622	CIW-HNT-2622
.017X.025	CIW-HNT-1725	CIW-HNT-2725
.019X.019	CIW-HNT-1925	CIW-HNT-2925

Citizen™ TiMo Arch wire (units of 10)	
Wire size	Straight length
.016	CIW-TIMO-016
.016X.022	CIW-TIMO-1622
.017X.025	CIW-TIMO-1725
.018X.025	CIW-TIMO-1825

Citizen™ Copper NiTi(units of 10)		
Wire size	Upper	Lower
.012	CIW-CNT-112	CIW-CNT-212
.014	CIW-CNT-114	CIW-CNT-214
.016	CIW-CNT-116	CIW-CNT-216
.018	CIW-CNT-118	CIW-CNT-218
.020	CIW-CNT-120	CIW-CNT-220
.016X.022	CIW-CNT-1622	CIW-CNT-2622
.017X.025	CIW-CNT-1725	CIW-CNT-2725
.018X.018	CIW-CNT-1818	CIW-CNT-2818
.018X.025	CIW-CNT-1825	CIW-CNT-2825
.019X.025	CIW-CNT-1925	CIW-CNT-2925
.020X.020	CIW-CNT-2020	CIW-CNT-3020
.021X.025	CIW-CNT-2125	CIW-CNT-3125

# IMAGINATION™

tooth-coloured arch wires



Epoxy coated tooth-coloured arch wires with a NiTi (superelastic) or stainless steel core. They offer low friction when used with Image, Oyster ESL, Blonde and Solo, or any ceramic, metal or plastic bracket (see University reports on gestenco.com).

- Superior wear resistance and colour stability
- Retains superelastic qualities
- More natural looking than white coatings
- The only complete aesthetic wire range for a full treatment
- Available in Straight-wire and MBT\*-style arch forms
- Also available with reverse curve of spee



The coating adds .002 inches to raw wire size



Straight-wire arch form

Nickel-Titanium Reverse Curve (units of 10)		
Coated Wire Size	Upper	Lower
.012	IM-RC-112	IM-RC-212
.014	IM-RC-114	IM-RC-214
.016	IM-RC-116	IM-RC-216
.018	IM-RC-118	IM-RC-218
.020	IM-RC-120	IM-RC-220
.016x.022	IM-RC-1622	IM-RC-2622
.017x.025	IM-RC-1725	IM-RC-2725
.018x.018	IM-RC-1818	IM-RC-2818
.018x.025	IM-RC-1825	IM-RC-2825
.019x.025	IM-RC-1925	IM-RC-2925
.020x.020	IM-RC-2020	IM-RC-3020
.021x.025	IM-RC-2125	IM-RC-3125



MBT\*-style arch form

Straight-Wire Arch Form Nickel-Titanium (units of 10) Stainless Steel (units of 10)				
Coated Wire Size	Upper	Lower	Upper	Lower
.012	IM-NT-112	IM-NT-212	N/A	N/A
.014	IM-NT-114	IM-NT-214	IM-SS-114	IM-SS-214
.016	IM-NT-116	IM-NT-216	IM-SS-116	IM-SS-216
.018	IM-NT-118	IM-NT-218	IM-SS-118	IM-SS-218
.020	IM-NT-120	IM-NT-220	IM-SS-120	IM-SS-220
.016x.022	IM-NT-1622	IM-NT-2622	IM-SS-1622	IM-SS-2622
.017x.025	IM-NT-1725	IM-NT-2725	IM-SS-1725	IM-SS-2725
.018x.018	IM-NT-1818	IM-NT-2818	IM-SS-1818	IM-SS-2818
.018x.025	IM-NT-1825	IM-NT-2825	IM-SS-1825	IM-SS-2825
.019x.025	IM-NT-1925	IM-NT-2925	IM-SS-1925	IM-SS-2925
.020x.020	IM-NT-2020	IM-NT-3020	IM-SS-2020	IM-SS-3020
.021x.025	IM-NT-2125	IM-NT-3125	IM-SS-2125	IM-SS-3125

MBT*-Style Arch Form Nickel-Titanium (units of 10) Stainless Steel (units of 10)				
Coated Wire Size	Upper	Lower	Upper	Lower
.012	IM-NT-412	IM-NT-512	N/A	N/A
.014	IM-NT-414	IM-NT-514	IM-SS-414	IM-SS-514
.016	IM-NT-416	IM-NT-516	IM-SS-416	IM-SS-516
.018	IM-NT-418	IM-NT-518	IM-SS-418	IM-SS-518
.020	IM-NT-420	IM-NT-520	IM-SS-420	IM-SS-520
.016x.022	IM-NT-4622	IM-NT-5622	IM-SS-4622	IM-SS-5622
.017x.025	IM-NT-4725	IM-NT-5725	IM-SS-4725	IM-SS-5725
.018x.018	IM-NT-4818	IM-NT-5818	IM-SS-4818	IM-SS-5818
.018x.025	IM-NT-4825	IM-NT-5825	IM-SS-4825	IM-SS-5825
.019x.025	IM-NT-4925	IM-NT-5925	IM-SS-4925	IM-SS-5925
.020x.020	IM-NT-4020	IM-NT-5020	IM-SS-4020	IM-SS-5020
.021x.025	IM-NT-4125	IM-NT-5125	IM-SS-4125	IM-SS-5125

\* MBT is a registered trademark by 3M/Unitek.



Coated ligature

Coated Ligatures	
Description	Catalog no.
.012	IM-CL-12

# SMARTBOND SC<sup>®</sup>

The "superglue" in orthodontics and oral surgery



SmartBond is a completely new approach to bonding. A true one-step adhesive that allows you to bond brackets, buccal tubes and other attachments in a wet field, without the use of a light source or additional primers.

Other features:

- Biocompatible
- Allergy-tested

- Moisture activated
- Bonds on composite and porcelain surfaces
- No bad taste or smell for the patient
- No discolouration throughout treatment
- Bonds on plastic, metal and ceramic attachments
- Clinically proven efficiency for bonding of impacted canines

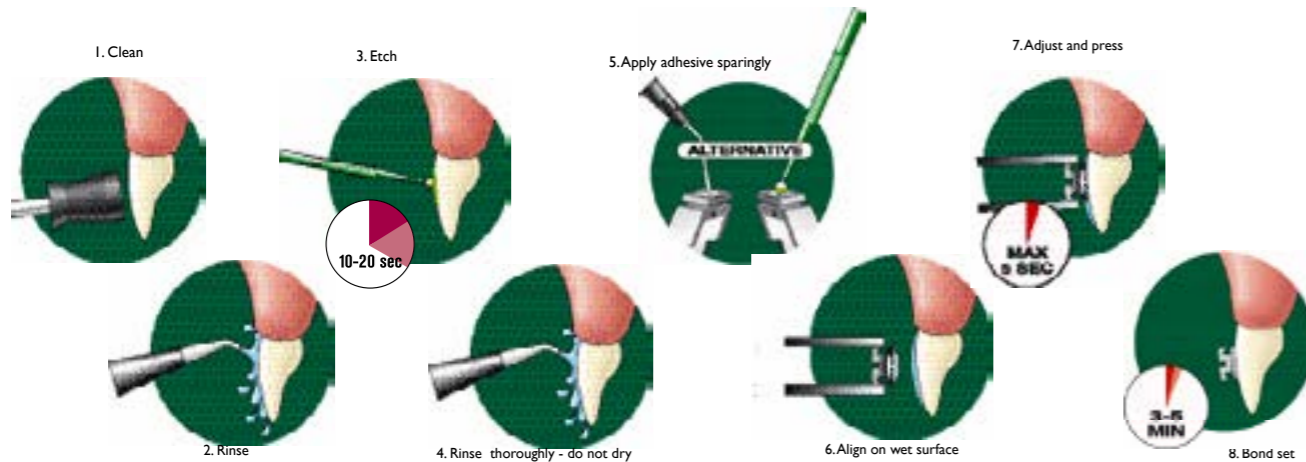

TRIAL KIT, SM-010



ECONOMY KIT, SM-001



SmartBond products	
Description	Catalogue No.
Trial-kit, 1g	SM-010
Mini-kit, 3g	SM-000
Economy kit, 6g	SM-001
Instant adhesive, 3g	SM-002
Etching gel, 6g	SM-003
Brushes, pkg of 50	SM-004
Luer-lock tips, pkg of 40	SM-005
Mixing pad	SM-006

# SMARTBOND LC<sup>®</sup>

## Light cure bonding adhesive



- For routine bonding 5 to 5
  - 1st and 2nd molar bonding
  - Exposed and high cuspid bonding
  - Works with water, saliva or blood
  - After etching, it's simply paste and light
  - No primers or conditioners that turns yellow after a while
- Bonds in a wet or dry field - your option
  - Dual-cure, light and/or selfcure
    - insures complete polymerization
    - fills any irregular pockets between base & enamel
  - Works with metal, plastic and ceramic brackets

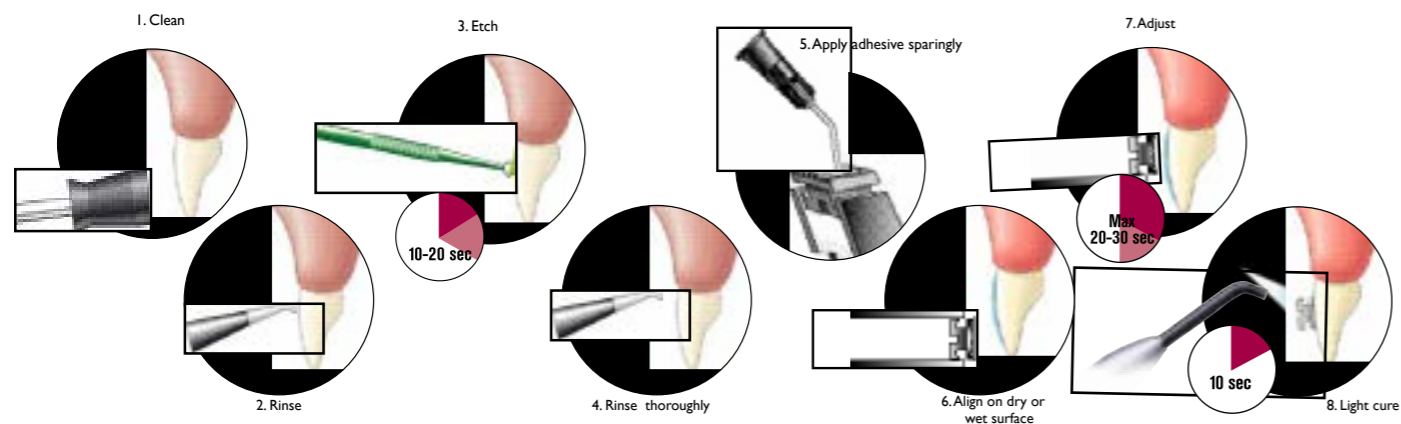

SmartBond LC products	
Description	Catalogue no.
Economy kit, 3g	SM-300-LC
Mini-kit, 1g	SM-100-LC
Etching gel, 6g	SM-003
Brushes, pkg of 50	SM-004
Flowthru tips, pkg of 30	SM-105-LC
Mixing pad	SM-006

SMARTBOND LC MINI-KIT  
SM-100-LC



SMARTBOND LC ECONOMY KIT  
SM-300-LC

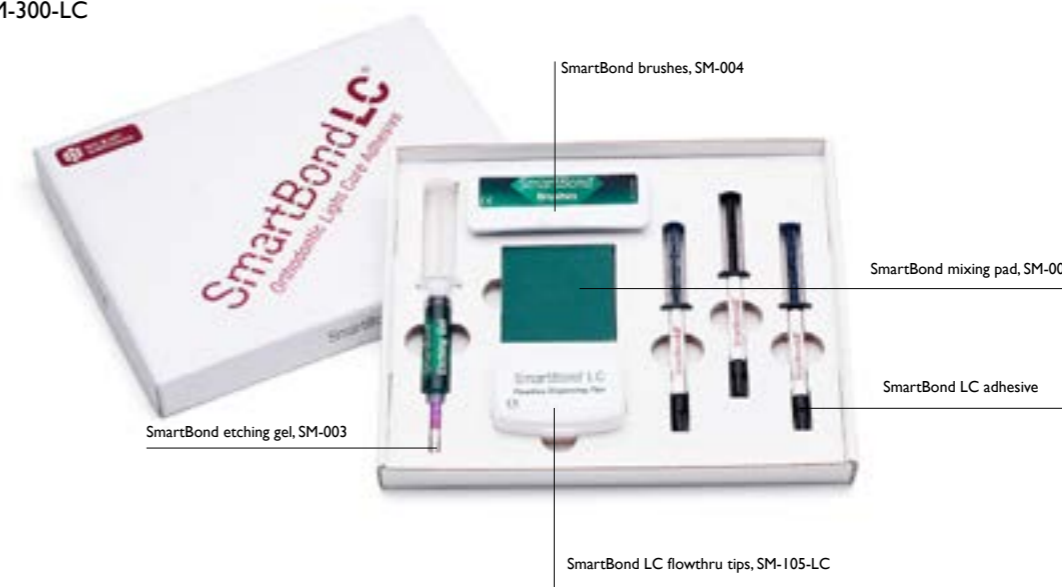

# FREDDY™

## ceramic button

The Freddy ceramic button\* is the perfect clear utility button for all aesthetic appliances.

- Works lingual as well as labial
- The oral surgeons use them whenever clear appliances are indicated
- Mesh structure of base makes a strong bonding
- Bonds well with most common adhesives
- Anatomy and size of base fits all teeth
- Enough space around tie wing for all elastics
- Maintains the transparent look for aligners as anchorage for elastics

Freddy™ ceramic button	
Description	Catalogue No.
Ceramic buttons	FCB-00-01

\*Patented



# FREDDY™

## ceramic hook

The Freddy hook\* has a smooth low profile and ellipse shape.

It has the same characteristics as the standard Freddy button and matches perfect together with Invisalign and other aligners as well as hook for class II mechanics in lingual.

Freddy™ hook	
Description	Catalogue No.
Ceramic hook	FCB-00-01HK



\*Patented



# BITE-BUMPER™

open deep bite without trauma



Bite-Bumper™	
Description	Catalogue no.
Bite-Bumper (in packs of 10)	BB-00-01

Bite-Bumpers work in deep bite cases by allowing the anteriors to ride up and out of occlusion. The Bite-Bumpers eliminate bond failures of brackets and are especially valuable with ceramic or self-ligating brackets.

The unique fixed "placement-jig" guarantees the correct height on the lingual of the tooth and makes sure the two Bite-Bumpers are 100 % parallel..

The Bite-Bumpers are made of a composite polymer that is more comfortable, aesthetic and will increase biocompatibility in nickel sensitive patients.

Bite-Bumpers are bonded in the same manner as metal or ceramic brackets. The Bite-Bumpers have a slotted mechanical bonding base.

The placement-jig can easily be removed by hand or by a cutting instrument after bonding.

# SUNSET STRIP™

## Single-Sided Sunset strip™

Our Versatile single-sided Sunset strip™ are perfect for contouring and finishing composite restorations and for single tooth slenderization.



Part number	SU-SS-01	SU-SS-02	SU-SS-03	SU-SS-04
Grit	Super Fine	Fine	Medium	Coarse
Thickness	0.08	0.10	0.13	0.18

## Double-Sided Sunset strip™

Excellent at contouring and finishing composite restorations and are especially well suited for interproximal reductions.



Part number	SU-DS-01	SU-DS-02	SU-DS-03	SU-DS-04
Grit	Super Fine	Fine	Medium	Coarse
Thickness	0.11	0.15	0.21	0.30



Sunset Strip™ box	
Description	Catalogue no.
Box incl. 10strips and 2 handles	KITSU-10



Part number	SU-SAW-01
Thickness	0.05

# Instruments

	<b>Weingart Plier</b>
Catalogue no:	G-556



	<b>Bracker remover</b>
Catalogue no:	G-545



	<b>Angled bracket remover</b>
Catalogue no:	G-344



	<b>Ligature cutter</b>
Catalogue no:	G-552



	<b>Crile Murray</b>
Catalogue no:	G-124



	<b>Distal end cutter</b>
Catalogue no:	G-550



	<b>Mathieu needle holder</b>
Catalogue no:	G-216



	<b>Ligature cutter, mini</b>
Catalogue no:	G-551



	<b>Distal end cutter, mini</b>
Catalogue no:	G-554



	<b>Posterior band remover</b>
Catalogue no:	G-347



	<b>Jarabak plier</b>
Catalogue no:	G-209



	<b>Cap opener</b>
Catalogue no:	CO-00-01



	<b>Duett cap opener</b>
Catalogue no:	PH-CO-01



	<b>Lange Probe</b>
Catalogue no:	LA-CO-01



	<b>Moberg arch bender</b>
Catalogue no:	MO-00-01



# RUBBER SOUL™

elastomerics

Elastomerics manufactured from the finest surgical grade natural latex rubber to ensure reliable force delivery.



Rubber Soul Latex	
Description	Catalogue No.
Latex 1/8 2,5oz	RS-LX-1825
Latex 1/8 4,5oz	RS-LX-1845
Latex 1/8 6,5oz	RS-LX-1865
Latex 3/16 2,5oz	RS-LX-31625
Latex 3/16 4,5oz	RS-LX-31645
Latex 3/16 6,5oz	RS-LX-31665
Latex 1/4 2,5oz	RS-LX-1425
Latex 1/4 4,5oz	RS-LX-1445
Latex 1/4 6,5oz	RS-LX-1465
Latex 5/16 2,5oz	RS-LX-51625
Latex 5/16 4,5oz	RS-LX-51645
Latex 5/16 6,5oz	RS-LX-51665
Latex 3/8 2,5oz	RS-LX-3825
Latex 3/8 4,5oz	RS-LX-3845
Latex 3/8 6,5oz	RS-LX-3865

Rubber Soul Sleeve*	
Description	Catalogue No.
Sleeve .025 grey	RS-ASG-027
Sleeve .025 clear	RS-ASC-027

Rubber Soul Thread*	
Description	Catalogue No.
Thread .025 grey	RS-TG-025
Thread .025 clear	RS-TC-25

\*Latex free

Rubber Soul Separators*	
Description	Catalogue No.
Separators blue	RS-RES-00



Rubber Soul Ties*	
Description	Catalogue No.
Ties Clear	RS-CL-00
Ties metallic silver	RS-MS-00
Ties assorted neon	RS-AP-01
Ties assorted basic	RS-AP-02
Ties assorted multi	RS-AP-03

\*Latex free



Assorted Basic



Assorted Neon



Assorted Multi

# LIP-AND CHEEK RETRACTORS

Lip retractor	
Description	Catalogue No.
Adult size	LR-00-01
Child size	LR-00-02



Cheek Retractor	
Description	Catalogue No.
Cheek Retractor	CR-00-01



Evacu Cheek Retractor	
Description	Catalogue No.
Evacu Cheek Retractor	EV-00-01



Thomas Photo / Cheek Retractor	
Description	Catalogue No.
Thomas Cheek / photo Retractor	TR-00-01



# MARK VI™

## IPR measuring gauge

Used during Interproximal Reduction (IPR) to measure and confirm space.

- Includes six gauges: 0.1mm, 0.2mm, 0.25mm, 0.3mm, 0.4mm, and 0.5mm
- Stainless steel
- Autoclavable



MARK VI™	
Description	Catalogue no.
MARK VI IPR measuring gauge	MK-00-01



# DAILY™

## photographic mirror

Our Swedish glass Rhodium coated mirrors offer the ultimate in durability. Highly polished surfaces cannot chip, scratch or peel. Double sided for maximum life, the mirrors have polished, rounded edges for patient comfort and are compatible with autoclave sterilization.

Child Occlusal  
L: 81mm  
W: 54mm



Adult Occlusal  
L: 95mm  
W: 67mm



XL Occlusal  
L: 131mm  
W: 66mm



### Daily photographic mirror

Description	Catalogue No.
Buccal	PM-00-01
Lingual	PM-00-02
Child Occlusal	PM-00-03
Adult Occlusal	PM-00-04
XL Occlusal	PM-00-05

Buccal  
L: 145mm  
W: 41mm



Lingual  
L: 147mm  
W: 52mm



# IMAGE™

## buccal tube

### BUCCAL TUBES

Glassfiber composite polymer bonding tube with torque-in-base for lower profile and reduced occlusal interference. Two types fits all molars, .018 and .022 archwire slots in the same attachment.

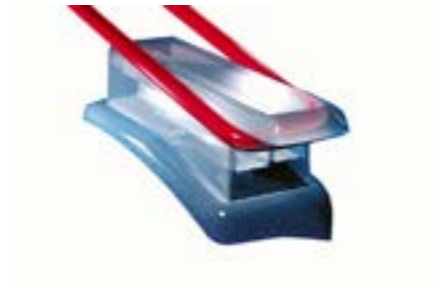

Buccal Tubes					
Description	Torque	Offset	M/D mm	.018	.022
Upper right/ lower left	-10°	7°D	7.0	IM-67-01	IM-67-01
Upper left/ lower right	-10°	7°D	7.0	IM-67-02	IM-67-02



# SUPPLIES



Overbite Ruler	
Description	Catalogue No.
Overbite ruler, aluminum	OP-11-00
Overbite ruler, steel	OP-11-01

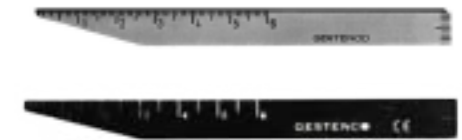

Coated Ligatures		
Description		Catalogue No.
Coated ligatures	.012	IM-CL-12



Citizen ligatures, short ties		
Description		Catalogue No.
Ligature ties x500	.010	CIW-SLT-010



Citizen ligatures, long ties		
Description		Catalogue No.
Ligature ties x1000	.010	CIW-LT-010







# **GESTENCO**

Gestenco International AB

P O Box 24067, SE-400 22 Gothenburg, Sweden

Phone +46 31 81 00 35, Fax +46 31 81 46 55

[www.gestenco.com](http://www.gestenco.com) / [info@gestenco.com](mailto:info@gestenco.com)

ISO 9001 and  
ISO 13485/CE certified