

# BITE-BUMPER™

opens deep bite without trauma

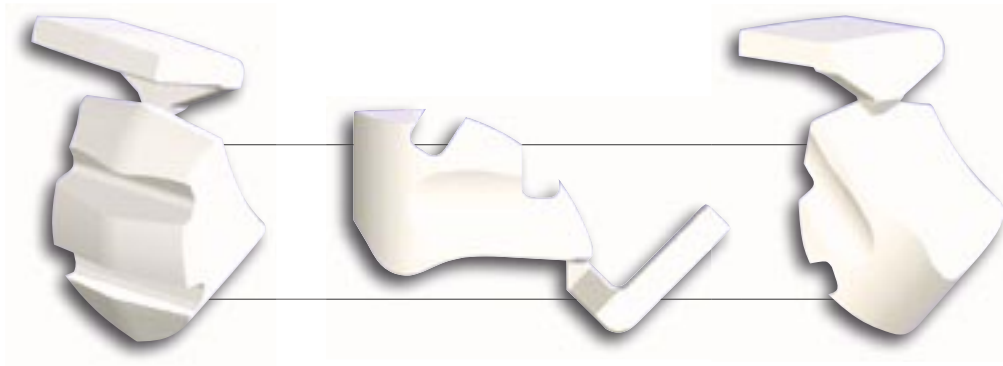

Bite-Bumpers work in open and deep bite cases by allowing the anteriors to ride up and out of occlusion. The Bite-Bumpers eliminate bond failures of brackets and are especially valuable with ceramic or self-ligating brackets.

The unique fixed "placement-jig" guarantees the correct height on the lingual of the tooth and makes sure the two Bite-Bumpers are 100 % parallel.

The Bite-Bumpers are made of a composite polymer that is more comfortable, aesthetic and will increase biocompatibility in nickel sensitive patients.

Bite-Bumpers are bonded in the same manner as metal or ceramic brackets. The Bite-Bumpers have a slotted mechanical bonding base.

The placement-jig can easily be removed by hand or by a cutting instrument after bonding - see illustration.

## INSTRUCTIONS

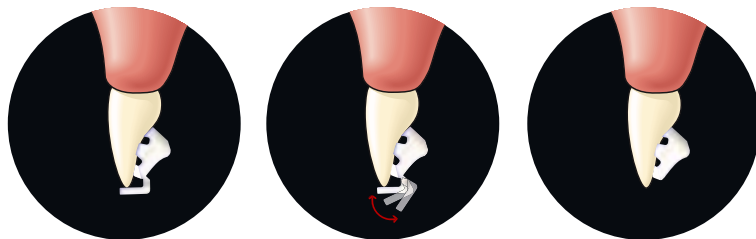

1. Put the placement-jig against the incisal edge

2. Remove the jig

3. Bite-Bumper ready

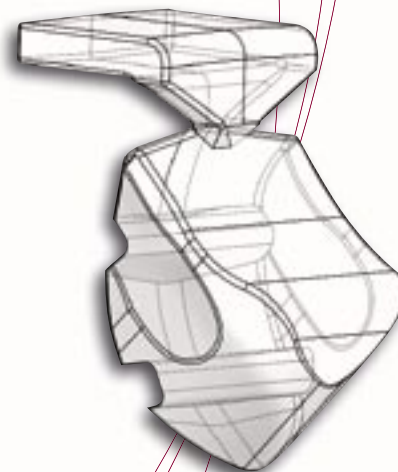

### Bite-Bumper™

Description	Catalogue No.
Bite-Bumper (in packs of 10)	BB-00-01

ISO 9001 and  
ISO 13485/CE certified

# GESTENCO

Gestenco International AB  
P O Box 24067, SE-400 22 Gothenburg, Sweden  
Phone +46 31 81 00 35, Fax +46 31 81 46 55  
[www.gestenco.com](http://www.gestenco.com) / [info@gestenco.com](mailto:info@gestenco.com)