

WOLLENBERG

STEEL WELDED HANDWHEELS

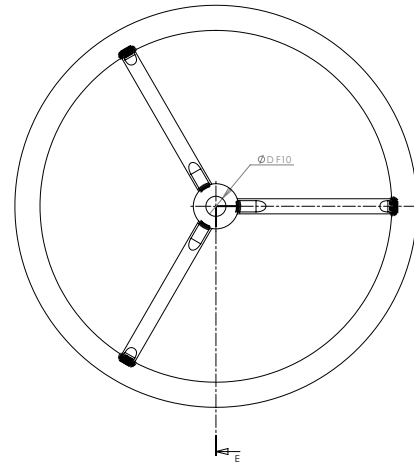
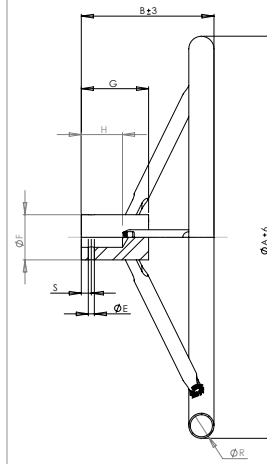

TYPE	DIAMETER Ø MM	HEIGHT WITHOUT HUB MM	NO. OF SPOKES
S 150	Ø 150	48	3
S 200	Ø 200	48	3
S 250	Ø 250	60	3
S 300	Ø 300	73	3
S 350	Ø 350	84	3
S 400	Ø 400	97	3
S 450	Ø 450	109	4
S 500	Ø 500	122	4
S 600	Ø 600	145	4
S 700	Ø 700	168	4

Surface treatment: Ferro-phosphated and powder coated with polyester based coating.

Standard color: Black RAL No. 9005.

Stamping: The handwheels are stamped with "Open" and "Shut".

We offer machined hubs meeting most international standards. By larger quantities, special requirements for hub measurements and colours can be met. We are also able to deliver handwheels up to 1200 mm.