

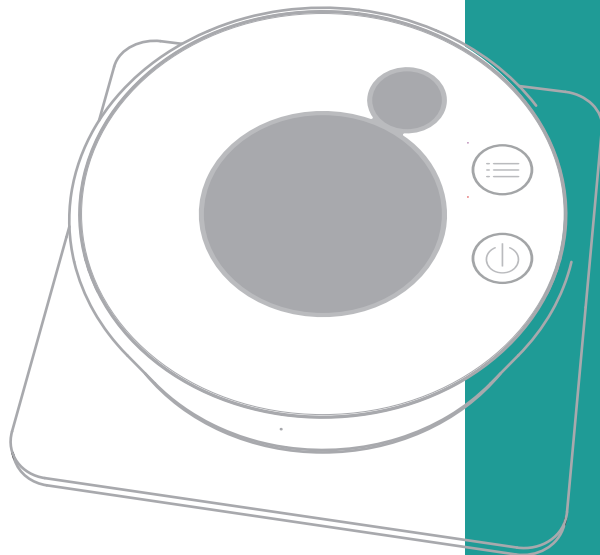

Use your mobile phone to scan the QR  
code to download the mobile App

## Internet WIFI Thermostat User Manual





## Internet WIFI Thermostat

### General

AT002 is an Internet WIFI Thermostat which allows user to control room temperature locally or remotely via Mobile App. It applies to the control of 2-pipes and 4-pipes Fan Coil Unit.















### Features

- Monitor room temperature, adjustable setpoint
- 2.8 inches TFT colorful screen display
- With WIFI module, able to connect to Home Router by WIFI
- Supports locally control or remotely control via Mobile App
- Able to connect to subcontrollers and centrally control the subcontrollers via Mobile App

### Technical Data

- (1) Power Supply: 220VAC $\pm$ 10% 50/60HZ
- (2) Display Screen: 2.8 Inches TFT Color Screen
- (3) Setting Temperature Range: 10~30 $^{\circ}$ C
- (4) Setting Temperature Accuracy: 0.5 $^{\circ}$ C
- (5) Ambient Temperature Display Accuracy: 0.1 $^{\circ}$ C
- (6) Operating Temperature Range: 0~45 $^{\circ}$ C
- (7) Control Accuracy:  $\leq$ 1 $^{\circ}$ C
- (8) Load Current: 3A (Resistive Load) 1A (Inductive Load)
- (9) Power Consumption: 1.5W (Standby) 5W (Operating)
- (10) LCD Panel Dimension:90\*90\*21.8mm

### Keys and Display

-  Lock icon. Display after locked
-  Cloud platform connection display icon. Display when connected to cloud server.
-  WIFI connected.  WIFI disconnected.
-  Timing On/Off indicator
-  Valve is closed  Valve is open
-  Fan speed icon: High :  Med :  Low :  Auto : 
-  Sleeping icon. Display when sleeping mode is enabled.
-  Warning icon. Display by flickering when device failure.

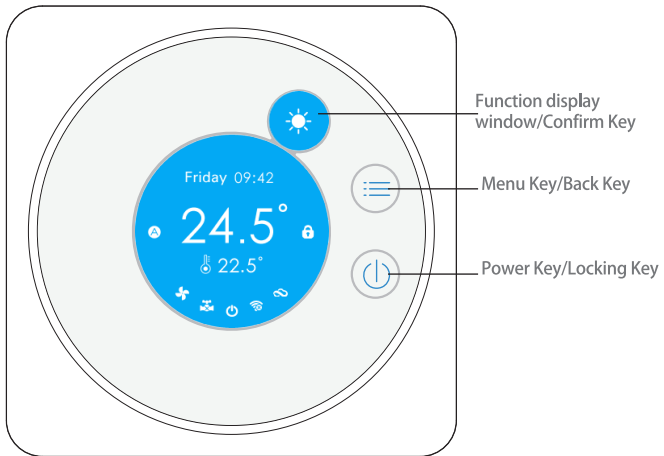

## Operation Instruction

This product realizes related parameters settings and viewing by rotating and touching.

**Rotating Operation:** Rotate the metal ring of the thermostat to realize the submenu selection, parameters selection and adjustment and etc.

**Touch operation:** Touch "Menu key" and "Functions Display Window" to complete various operations, such as menu opening, submenu entering and parameters confirming and etc.

## Function and Interface Operation Instruction

### 1. Power On/Off

During status of power off, press "Power key" for 3 seconds to start up the thermostat. After displaying startup screen for 3 seconds, it will display "Main Interface". The "Functions Display Window" will show present working mode ("Cool", "Heat", "Dry" or "Ventilate"). During status of power on, press "Power key" for 3 seconds to power off.

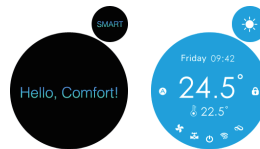

## 2.Lock/Unlock

During status of power on, touch "Power key/Locking key" to switch lock status.

## 3. Functions Setting Interface

Touch "Menu key" to enter into "Function Setting Interface", rotate the metal ring to switch among "Mode", "Fan Speed", "Sleep", "Settings", "Network", "Ambient", "About" and "Back", touch "Confirm" to enter into related setting interface".



### 3.1 Mode Setting

Rotate the metal ring during "Mode" interface to switch among "Cool", "Heat", "Dry", "Ventilate" and "Back". Touch "Confirm" to apply the selected mode. Touch "Menu key" to return to "Function Setting Interface".

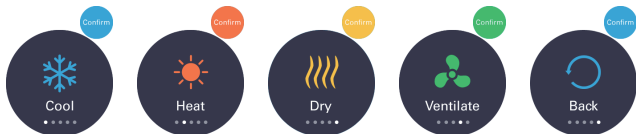

### 3.2 Fan Speed Setting

Rotate the metal ring to switch among "Low", "Med", "High", "Auto" and "Back". Touch "Confirm" to apply the selected fan speed. It will automatically return to "Main Interface" upon confirmation.



### 3.3 Sleeping Setting

Rotate the metal ring to switch among "Enable", "Disable" and "Back". Touch "Confirm" to apply the setting. Touch "Menu key" to return to "Function Setting Interface".



### 3.4 Parameters Setting

Rotate the metal ring to switch among "Time", "Advanced Settings", "Communication" and "Back". Touch "Confirm" to enter into related settings. Touch "Back" to return to "Function Setting Interface".

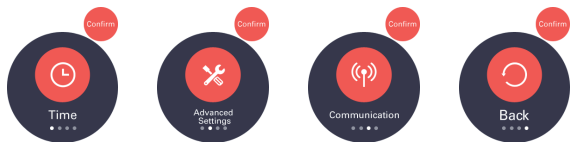

### 3.4.1 Time: 24 Hours, YYYY-MM-DD, Week.

Enter into "Time Interface", touch "Confirm", digits are flickering, and then rotate the metal ring to realize the setting. After setting, touch "Menu key" to quit the setting.



### 3.4.2 Advanced Settings

Enter into "Advanced Settings Interface", rotate the metal ring to switch among "Temperature Calibration", "System Selection", "Timing On/Off", "Temperature Limitation", "Restore" and "Back". Choose the option you would like to set, touch "Confirm" to enter into related setting interface. Touch "Confirm" again, digits are flickering, and then rotate the metal ring to set the desired parameters. After setting, touch "Menu key" to quit the setting.

Code	Option	Remark
1	Temperature Calibration	Used for compensating the measured temperature. Range: -9 °C to +9 °C
2	System Selection	"C1": for 2-pipes Fan Coil Unit, control motorized valve and 3 speed fan, fan stops when setpoint is reached "C2": for 2-pipes Fan Coil Unit, control motorized valve and 3 speed fan, continuous fan even though setpoint is reached "E1": for 4-pipes Fan Coil Unit, control motorized valve and 3 speed fan, fan stops when setpoint is reached "E2": for 4-pipes Fan Coil Unit, control motorized valve and 3 speed fan, continuous fan even though setpoint is reached
3	Timing On/Off	Timing On: 08:00; It will be automatically turned on at 8:00 Timing Off: 22:00; It will be automatically turned off at 22:00
4	Temperature Limitation	Cooling Minimum Temperature: 10 °C - 30 °C, Default: 10 °C. While working in cooling mode, setpoint can not be set lower than Cooling Minimum Temperature. Heating Maximum Temperature: 10 °C - 30 °C, Default: 10 °C. While working in heating mode, setpoint can not be set higher than Heating Maximum Temperature.
5	Restore	Reset all of the parameters to factory settings. Please use with caution
6	Back	Return to "Settings Interface"

### 3.4.3 Communication Setting ( RS485 communication function is optional)

Rotate the metal ring to switch among “IP” , “Baud rate” and “Confirm” . Select “IP” or “Baud rate” , and then touch “Confirm” on the “Function Display Window” to enter into related settings. Rotate the metal ring to adjust the parameters. After setting, rotate the metal ring to “Confirm” in the Main Screen, and then touch “Confirm” on the “Function Display Window” . The settings will be saved and it will return to “Main Interface” .



### 3.5 Network Configuration (WIFI connection)

- 1) Firstly, make sure mobile device and thermostat are closed to the same WIFI router.
- 2) Launch the mobile App and log in.
- 3) Enter into “Network” option on the thermostat, and then double-click “Configuration” on the “Main Screen” to enter into “Network Configuration Interface” . The “Configuration” icon will start flickering and waiting for connection.
- 4) Press “add device” in the mobile App, and then press “start connection” after inputting passwords of SSID of WIFI router. The thermostat will connect to WIFI router within 60 seconds.



\* If connection fails, please completely terminate the mobile App and repeat the procedures again.

### 3.6 Ambient

Choose “Ambient” by rotating the metal ring during “Function Setting Interface” , and then enter into “Ambient Interface” by touching “Confirm” . Touch “Confirm” again to return to “Main Interface” .



### 3.7 About

Choose “About” by rotating the metal ring during “Function Setting Interface”, and then enter into “About Interface” by touching “Confirm”. It will show device version information. Touch “Confirm” again to return to “Main Interface” .



### 3.8 Back

During the “Function Setting Interface”, choose “Back” by rotating the metal ring, and then touch “Confirm” to return to “Main Interface” .



## Installation Instruction

### 1. Installation Diagram

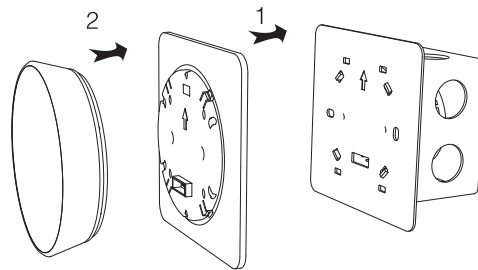

### Step 1

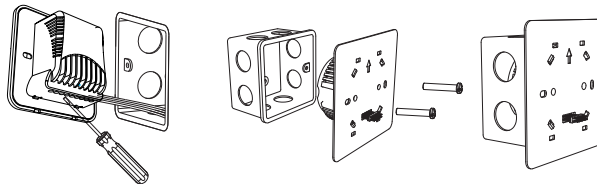

Step 2

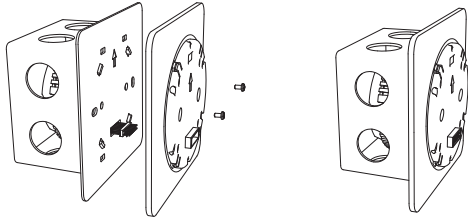

Step 3

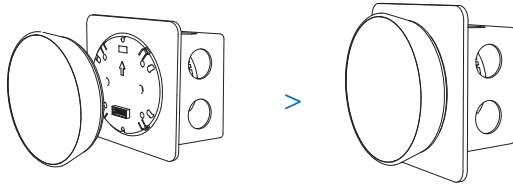

### Wiring Diagram

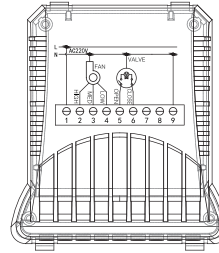

C1 & C2

For 2-pipes Fan Coil Unit, control on/off type motorized valve and 3 speed fan

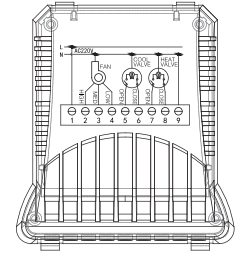

E1 & E2

For 4-pipes Fan Coil Unit, control on/off type motorized valve and 3 speed fan

### Simple Exception Handling

Code	Phenomenons	Handling
1.	Power on, but no display	<ul style="list-style-type: none"> <li>Check if the L,N power supply is working and also check the reliability of wiring;</li> <li>Check Power on/off key is flexible and efficient; * Check if the pin headers between control panel and driver board is efficiently connected to the socket or not;</li> </ul>
2.	Display is working, but no output	<ul style="list-style-type: none"> <li>Firstly, replace the control panel, and then replace the driver board;</li> <li>The pin headers for connecting control panel and driver board are damaged;</li> </ul>
3.	Temperature Setting Abnormal	<ul style="list-style-type: none"> <li>Temperature is not calibrated. Please calibrate the temperature through the LCD panel directly;</li> </ul>
4.	Wifi Communication Malfunction	<ul style="list-style-type: none"> <li>Check if WiFi is connected to network, and make sure that the internet connection is working;</li> <li>Reconnect to WiFi.</li> </ul>