

## ● Standard Dimensions

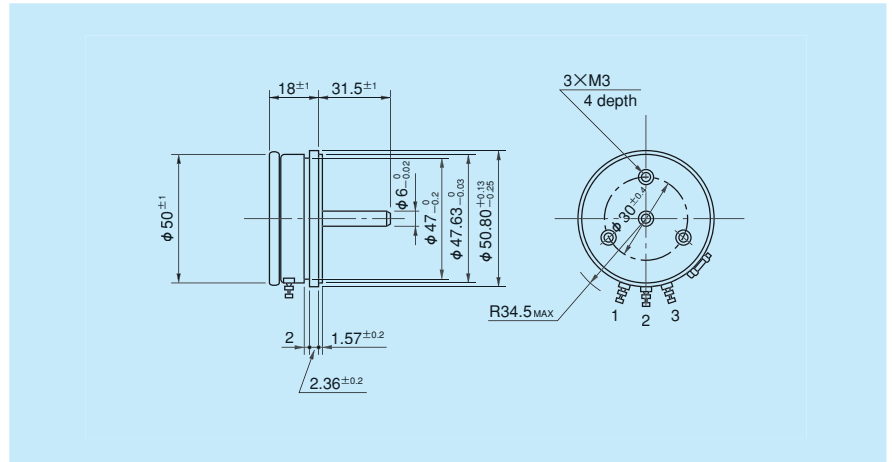

Model CP50



1-Turn ▶ Contact type ▶ Wirewound

## ● General Specifications

<b>Standard Resistance Range</b>	50,100,200,500,1k,2k,5k,10k,20k Ω
<b>Max. Practical Resistance Value</b>	50kΩ
<b>Total Resistance Tolerance</b>	Standard Class ±3% (H) Precision Class ±1% (F)
<b>Independent Linearity Tolerance</b>	Standard Class ±0.5% Precision Class ±0.1% (±0.2% in case of within 2kΩ)
<b>Power Rating</b>	1.5W

<b>Noise</b>	Within 100Ω E.N.R.
<b>Electrical Travel</b>	355° ±3°
<b>Mechanical Travel</b>	360° (Endless)
<b>Insulation Resistance</b>	Over 1,000MΩ at 1,000V.D.C.
<b>Dielectric Strength</b>	1 minute at 1,000V.A.C.
<b>Starting Torque</b>	Within 5mN · m (50gf · cm)
<b>Resistance Temperature Coefficient</b>	±20p.p.m./°C
<b>Mass</b>	Approx. 75g

## ● Standard Resistance Values ■ No. of Wire Turns ■ Resistance Wire Used

Resist. Value (Ω)	50	100	200	500	1k	2k	5k	10k	20k	※ 50k
No. of Wire Turns	500	650	800	1,100	1,000	1,250	1,810	2,180	2,780	3,500
Resist. Wire Used	Cu-Ni					Ni-Cr				

Note: Mark ※ shows special high resistance value.

## ● Special Specifications Available

(In the case of the potentiometer with special specifications, the general specifications and environmental specifications may change. Please consult us in advance.)

- Lower resistance values (10Ω, 20Ω)      ● Extra taps (Available up to 10 taps)
- Multi-ganged (Available up to 7 gangs. Housing length is extended by 12mm per 1 gang)      ● Bushingmount type
- Shaft with front and rear extension (Rear shaft with 6mm dia. and 15mm length)
- Spring return device incorporated (Automatically returning to the zero position)
- With stopper (Rotating angle is 330° and stopper strength is 0.9N · m [9kgf · cm])      ● Special electrical travel
- Shaft dia. (φ 6.35mm) with inch dimension      ● Special machining on the shaft