

**TWO-WIRE TEMPERATURE TRANSMITTER
(with integrated Pt-100 sensor)
(with or without digital indication)**

BTT789

- Pt100 or Pt1000 sensitive element
- 2-wire 4...20 mA output
- Easy & Fast connection plug M12
- Vibration-proof design
- Small dimensions
- Extended design for higher temperature available
- High protection class - IP65
- Local indicator available

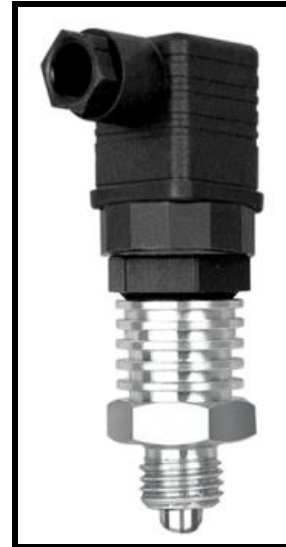

DESCRIPTION

BTT789 measures temperature by the means of a Pt_x sensitive element and converts it into standard 4...20 mA 2-wire current signal. This transmitter has a robust vibration-proof stainless steel sheath with IP65 protection class, and is equipped with a DIN 43650 connector that allows fast and easy electrical decoupling. The probe interior is filled with special compound, which protects the electronics from the harsh ambient influences. Eight different temperature measurement ranges from -50 °C and up to 400 °C as well as customer specified ranges are available. Various stem diameters and lengths as well as stainless steel types are also available. A local loop-powered indicator BLP200 can be optionally mounted between the sheath top and the connector. Thanks to its small size and robust design, BTT789 is applicable for cars, rail vehicles, construction machines, and other industrial equipment.

SPECIFICATIONS GENERAL

RTD Pt100 or Pt1000: -50.0 – 400.0°C JIS or DIN
Min range : Min 50°C
Output : Two-wire, 4-20 mA
Maximum load : 0 - 750Ω at 24VDC

INSTALLATION

Supply voltage : 10 - 32 VDC +/-10%
Operating temp : -40 to 85°C
Media pressure : Max 25 bar

MECHANICAL SPECIFICATION

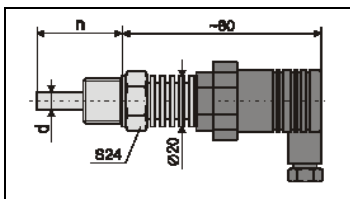
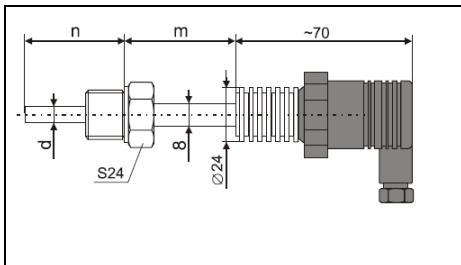

PERFORMANCE

Accuracy : ±0.1%
Burnout : More than 23mA
Display : 4 digit LCD or LED
EMC : EN 50081-1, EN 50082-2, EN 61000, EN61010 89/336/EEC

ORDERING CODE

BTT789-X-X-X-X-X-X



Variant	Range	Steam Diameter	Steam Length
K Short	TZ Specify	6mm	20-300mm
K1 Extended	T10 -20-60C T17 -50+50C T18 0-50C T19 0-100C T12 -50-100C T20 0-150C T7 0-200C T23 0-300C T8 0-400C	8mm	

Extension Length	Connection	Material
50-100mm	Q0 M16 Q1 M18 Q2 M20 Q3 G3/8" Q4 G1/2" Q9 3/8" NPT Q10 1/2" NPT QZ Specify	M1 1.4301 M2 1.4541 M3 1.4571 M9 1.4404

Tip shape	Options	Indicator
X Standard N Narrowed	X None OP electro Chemically Polished	X None A Indicator BLP200 B Indicator BLP220

