

X-STEP PP Sliding Steps

User and service manual

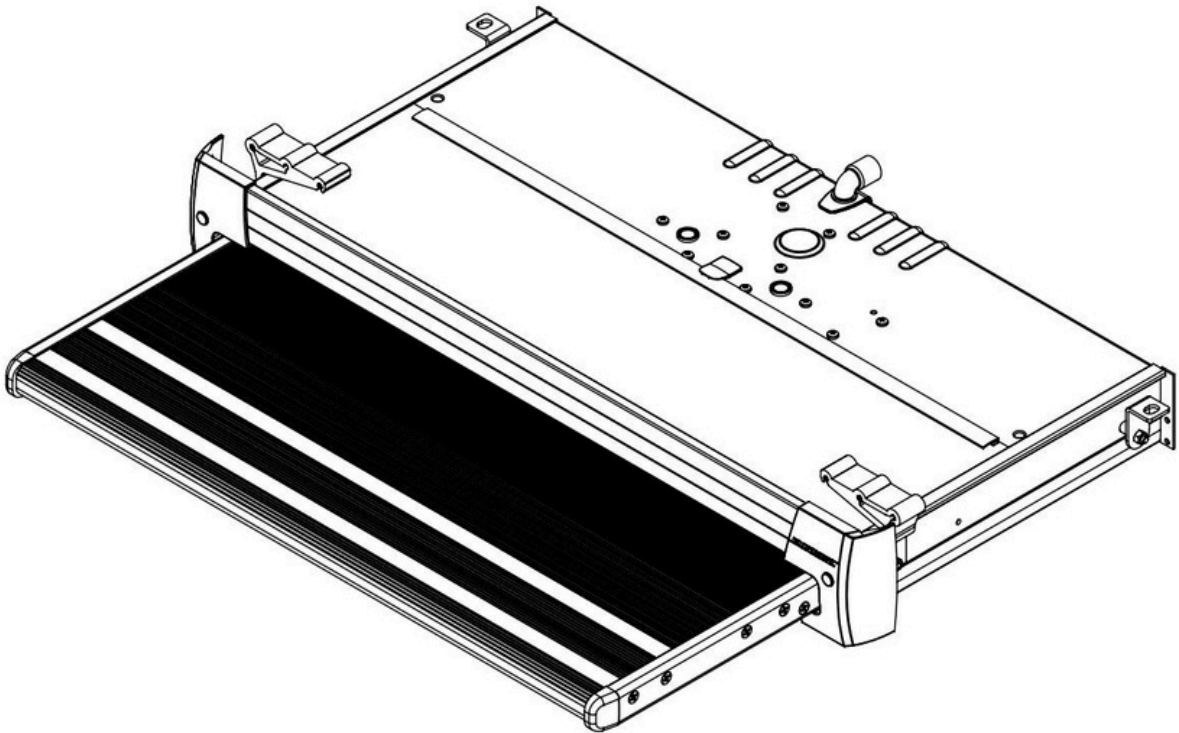

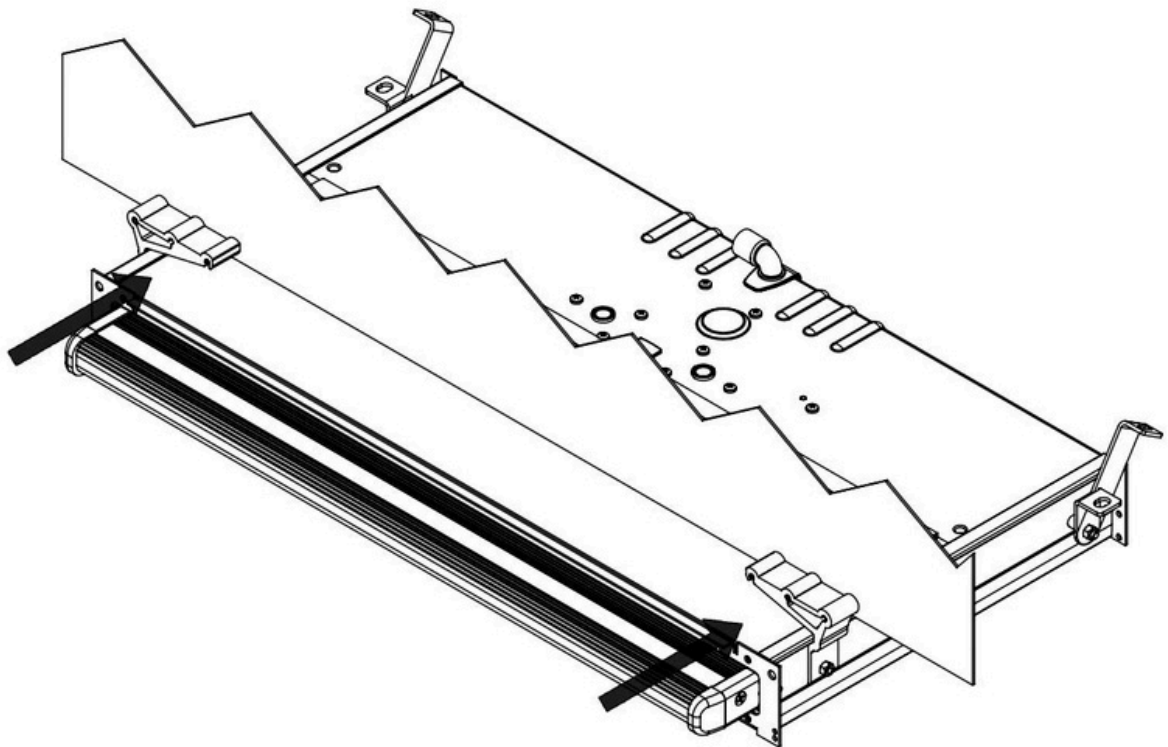
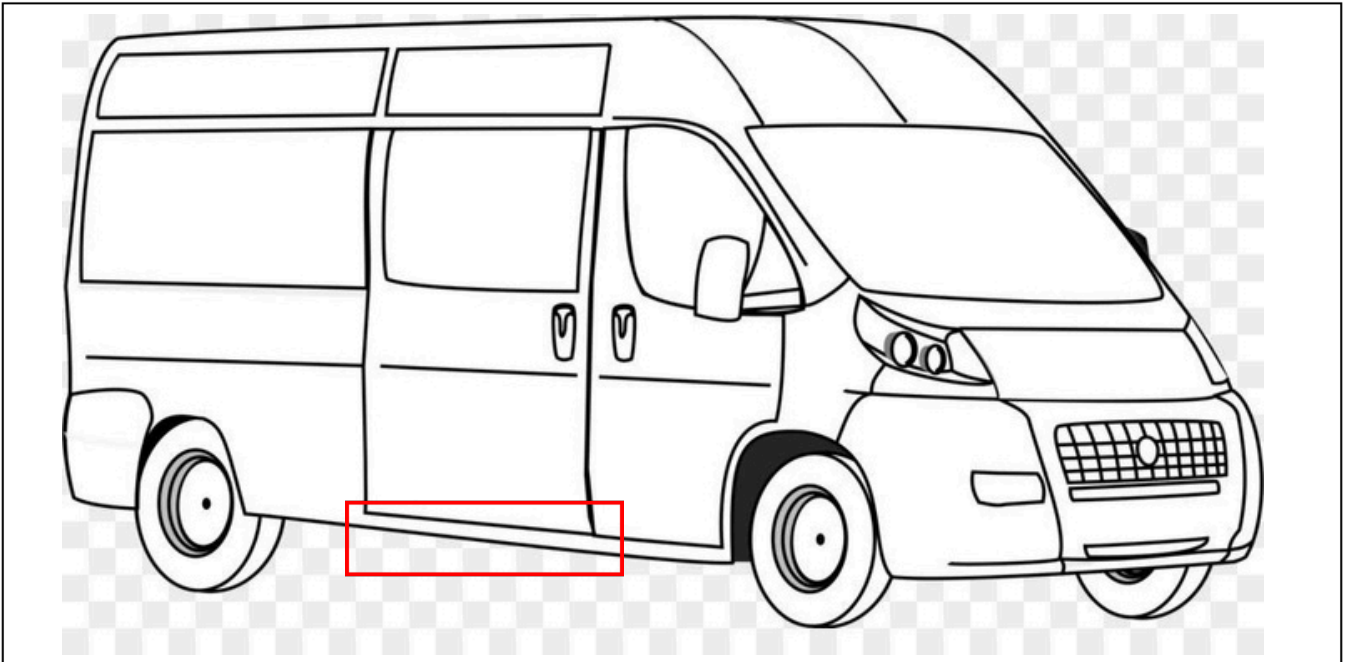

Please put the footboard (1) in the front of the sill plate as in the picture.
Mark the 6 holes on the aluminium bracket.

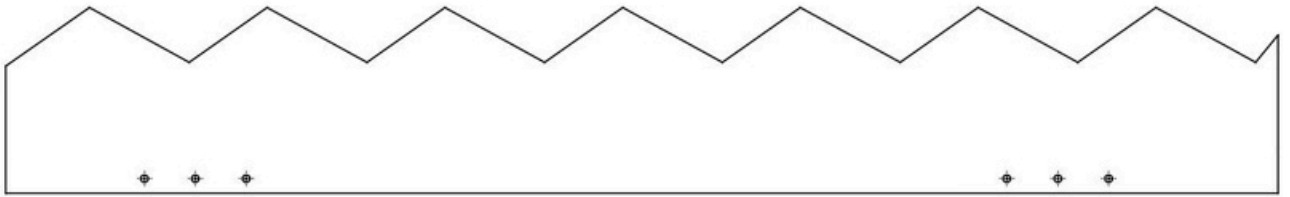

Drill these 6 holes with $\varnothing 6$ drill on the sill plate.

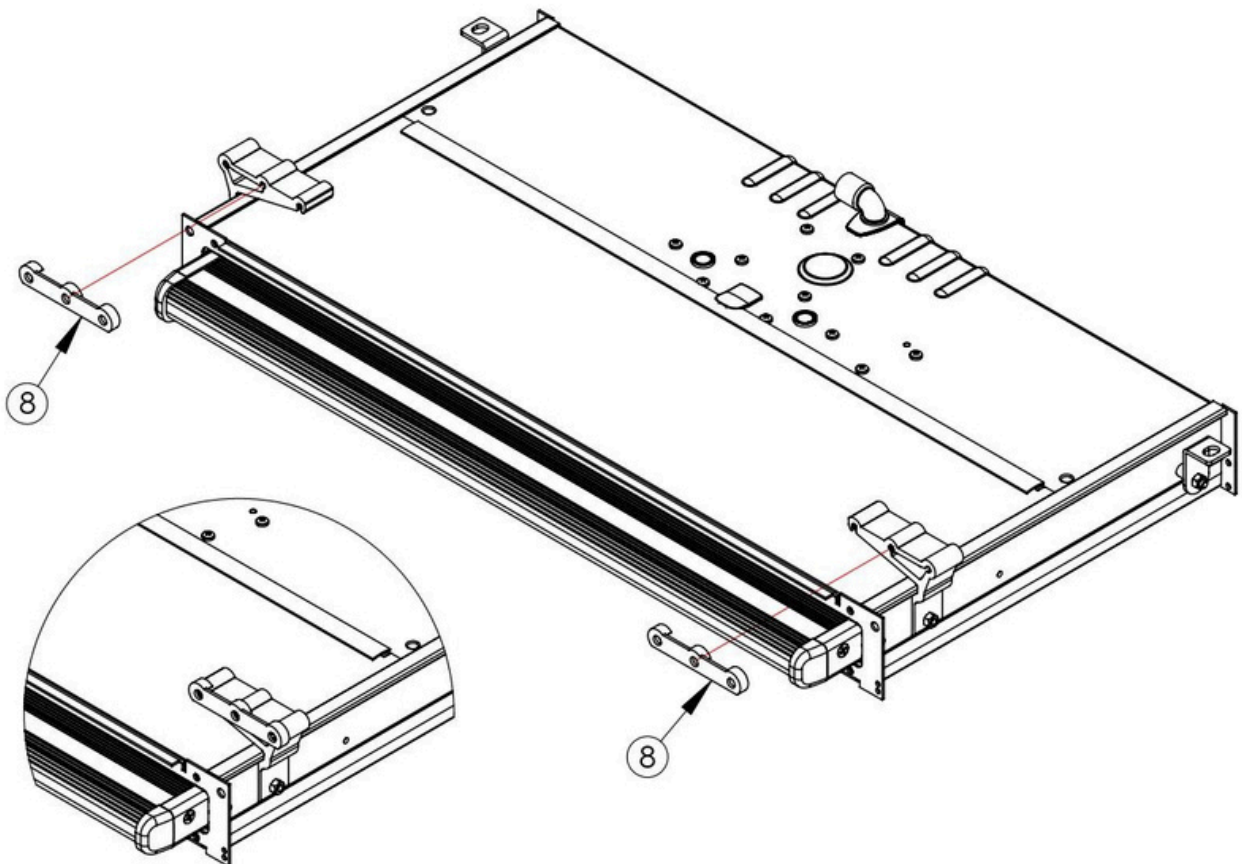

Put the anti-vibration plastics (8) on the aluminium brackets as in the picture.

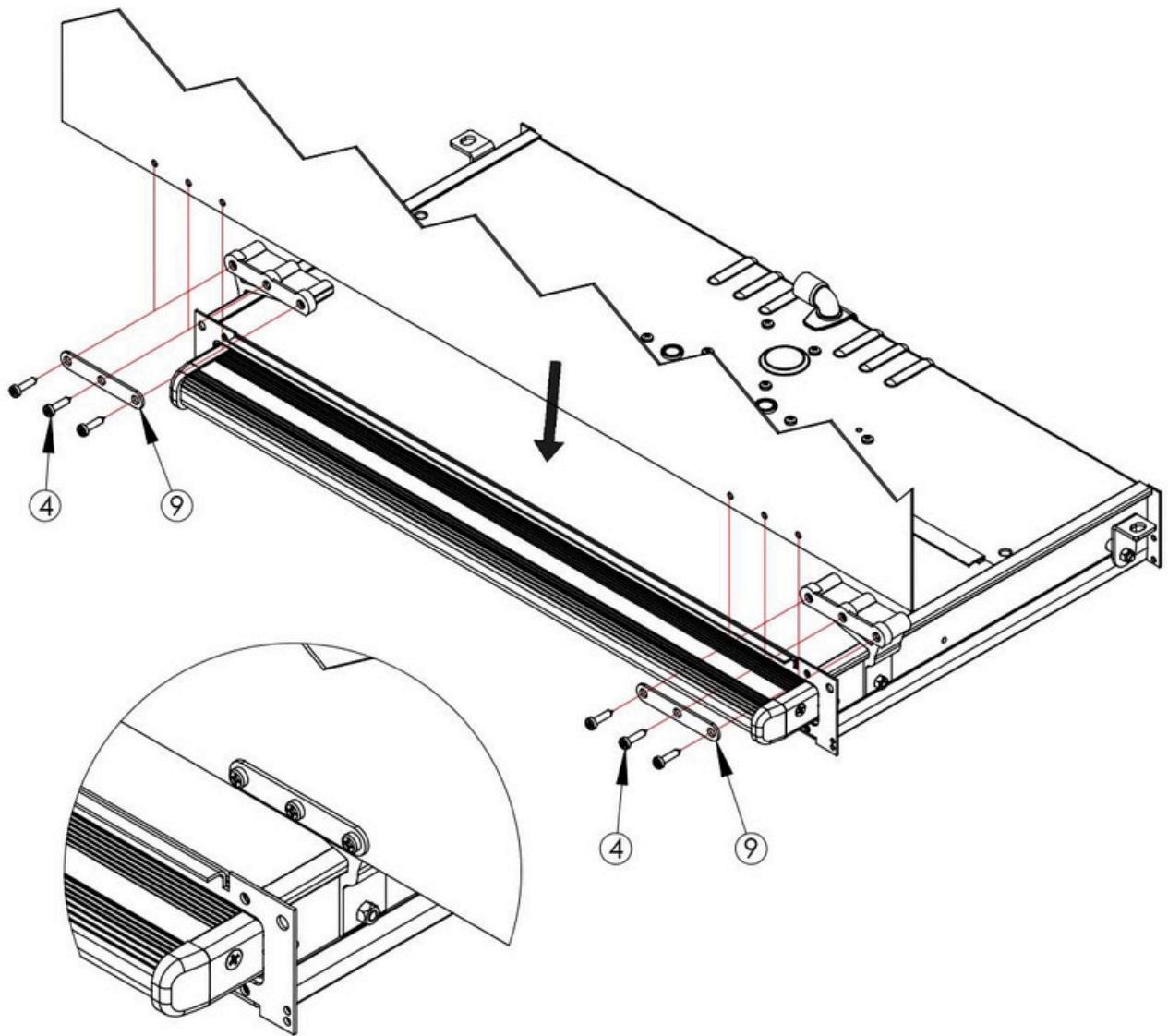

Put the footboard behind the sill plate and use the front brackets (9) to fix with screws(4).

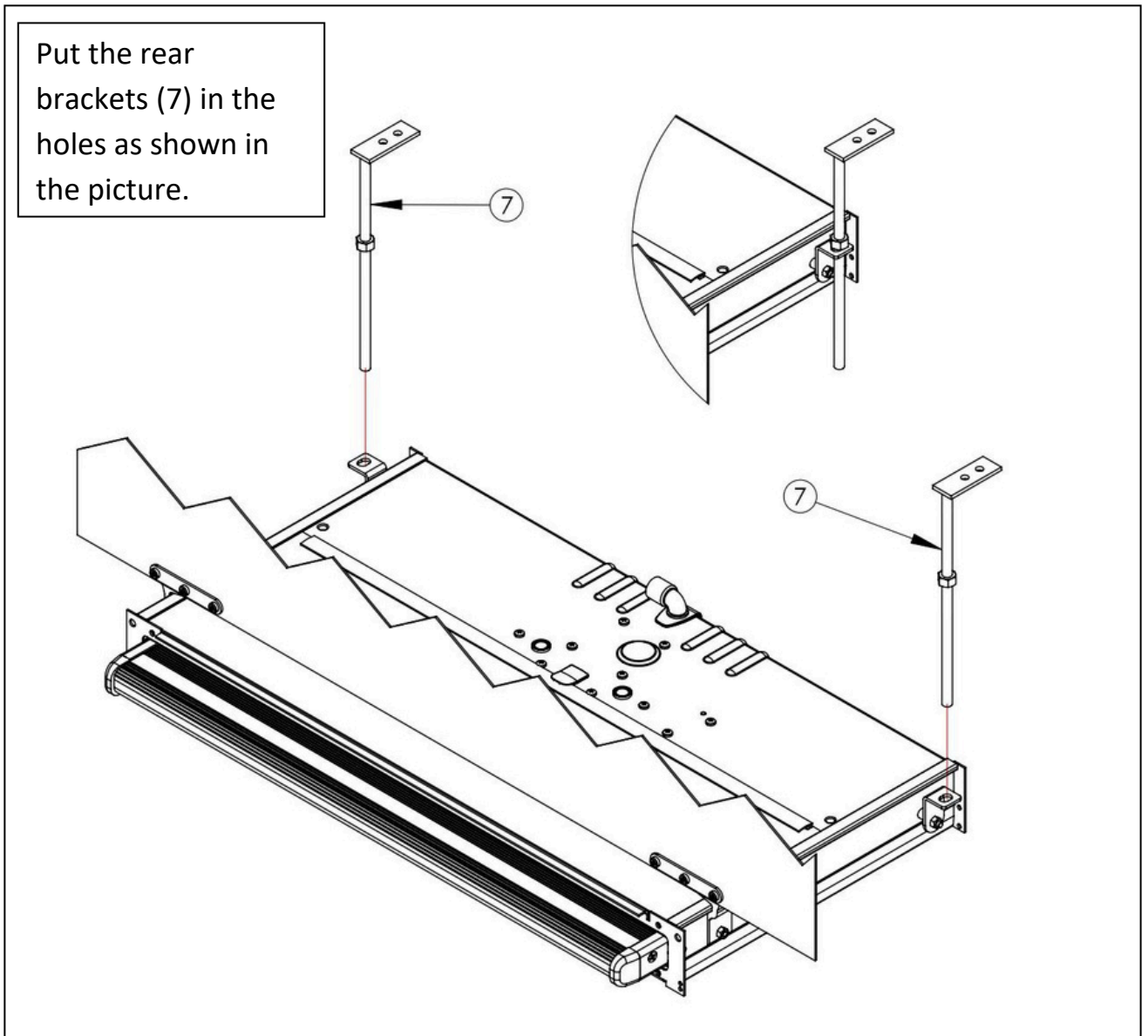
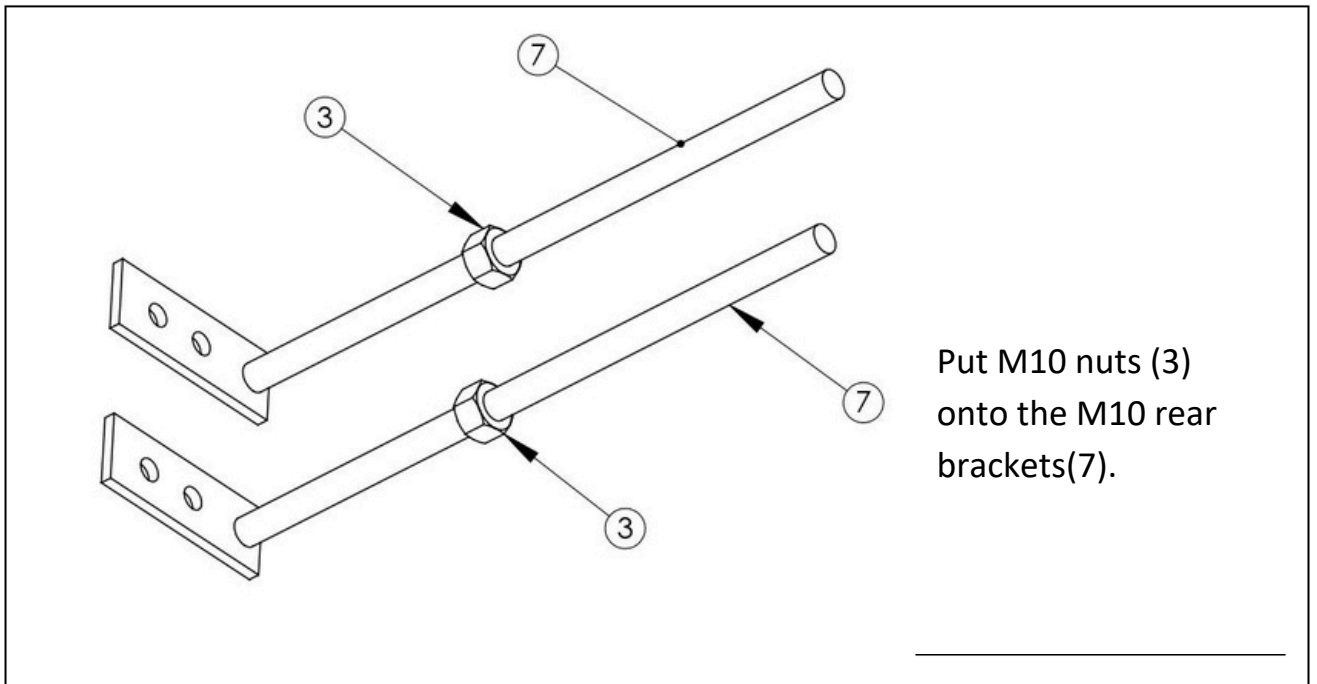

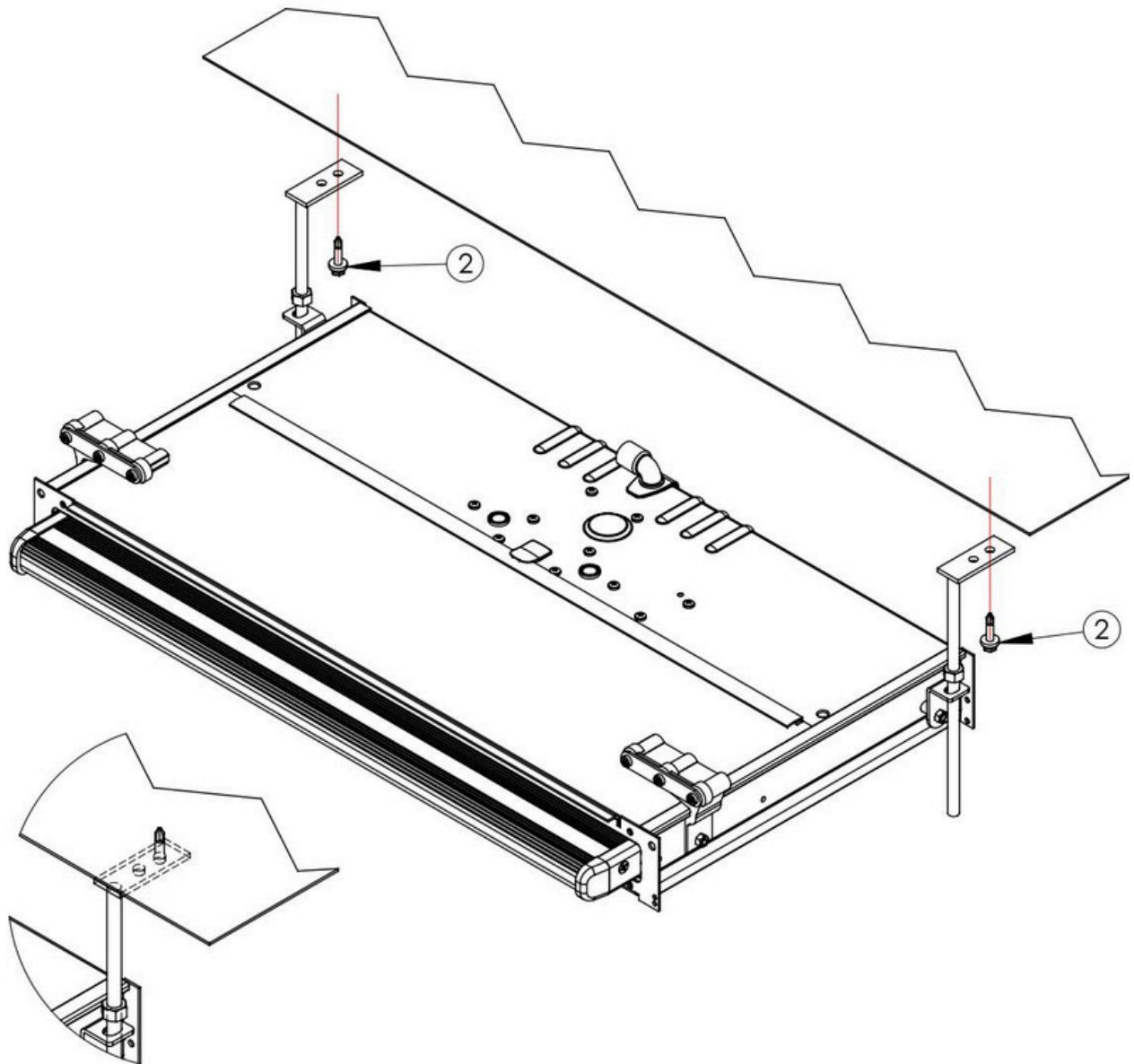

Fix the rear brackets(7) with screws (2) under the vehicle.

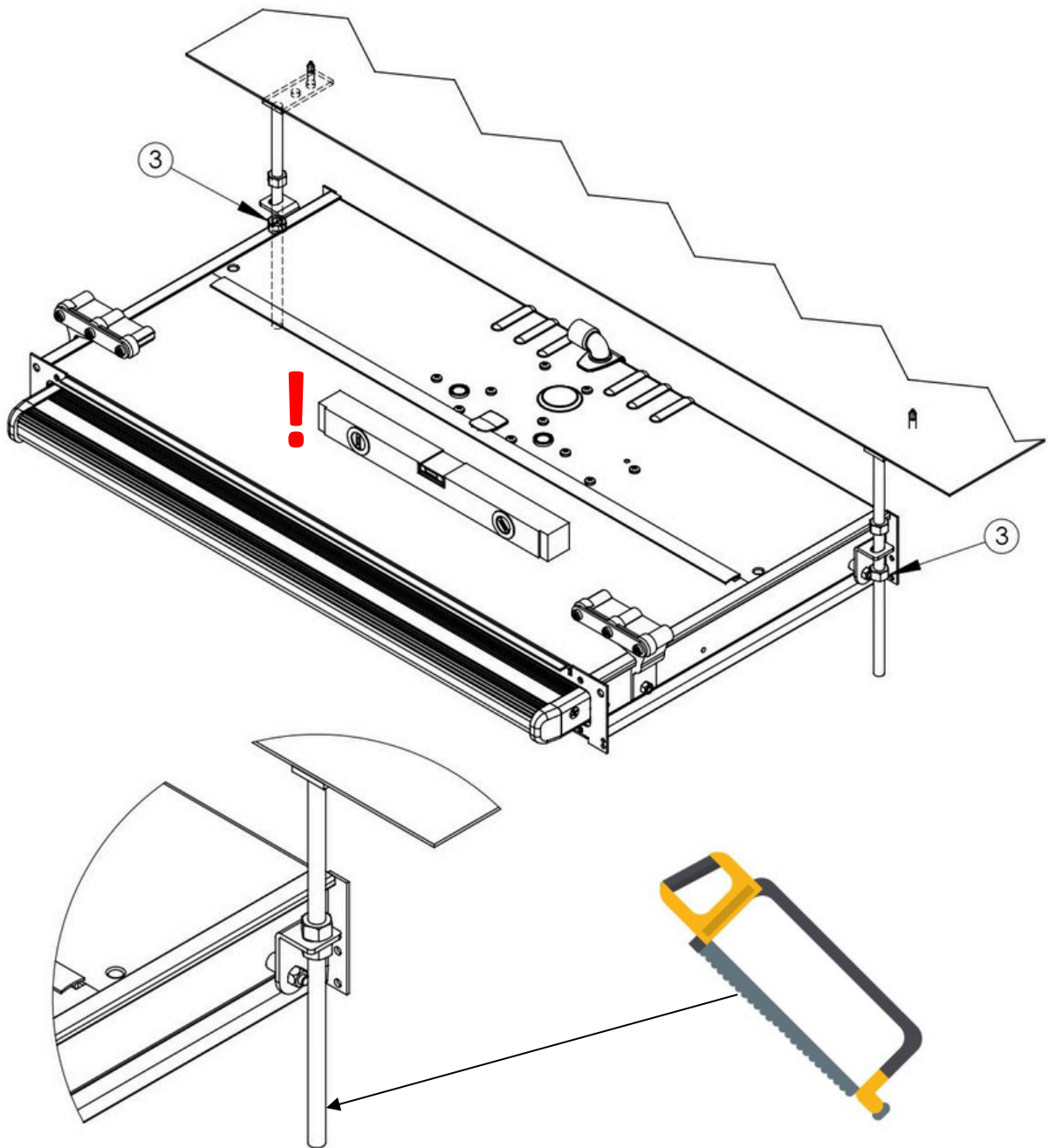

After fixing the rear brackets to the vehicle, use 2 nuts (3) to fix firmly.

Attention: You can cut redundant parts according to the vehicle.

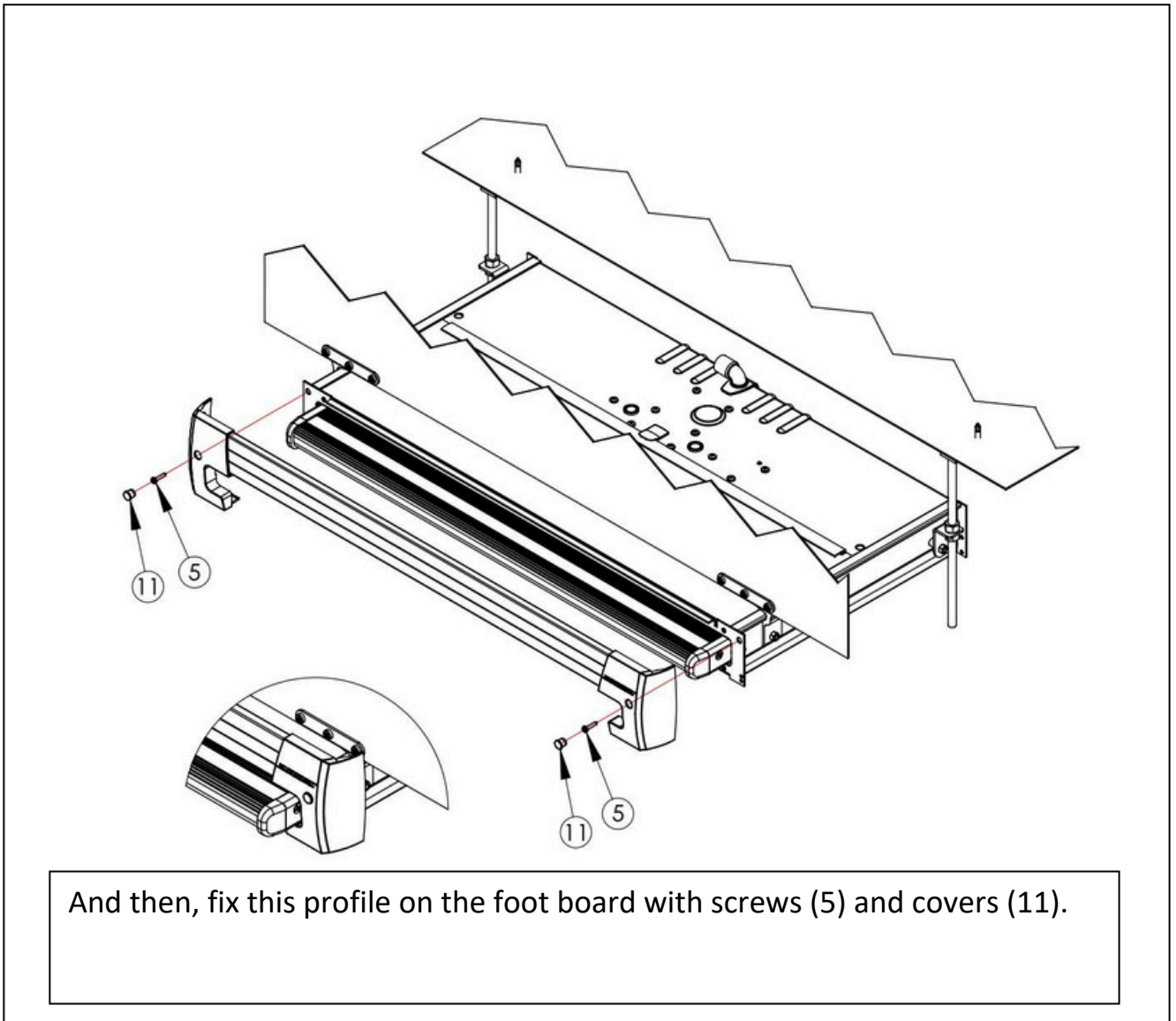
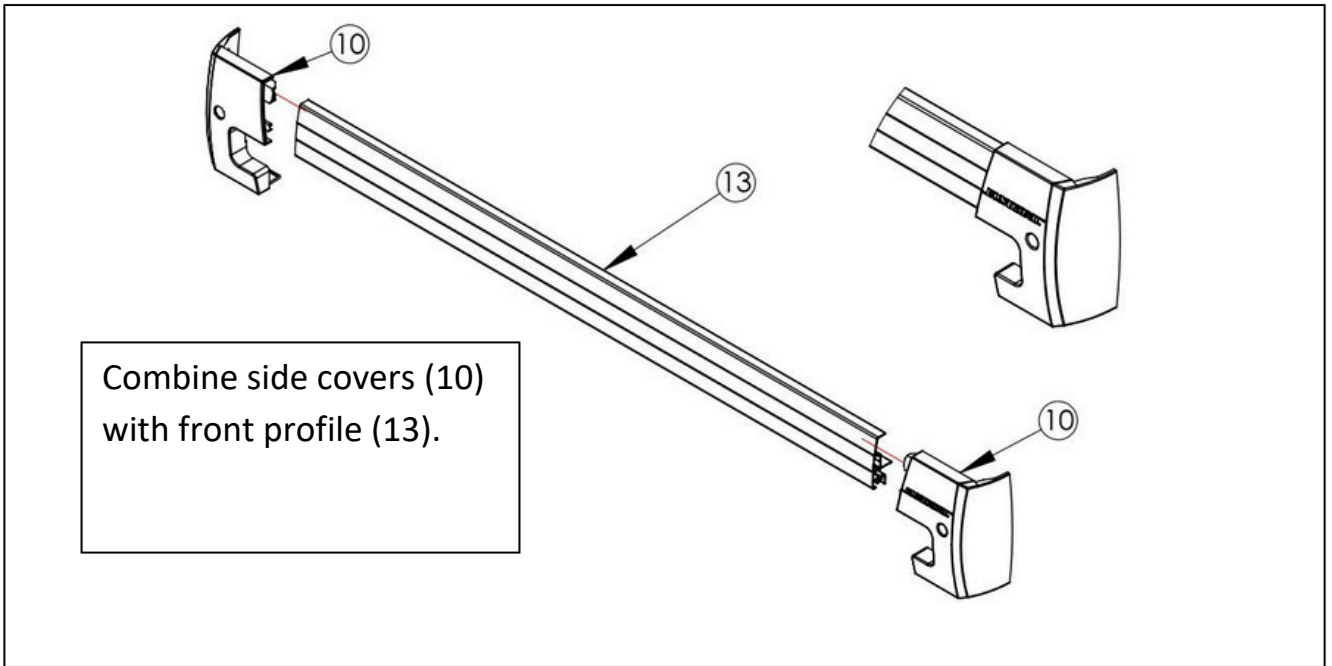

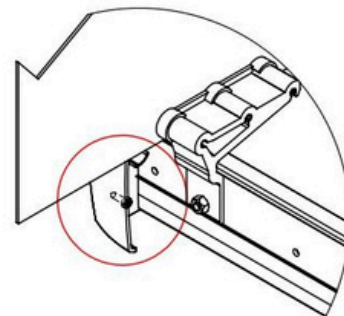
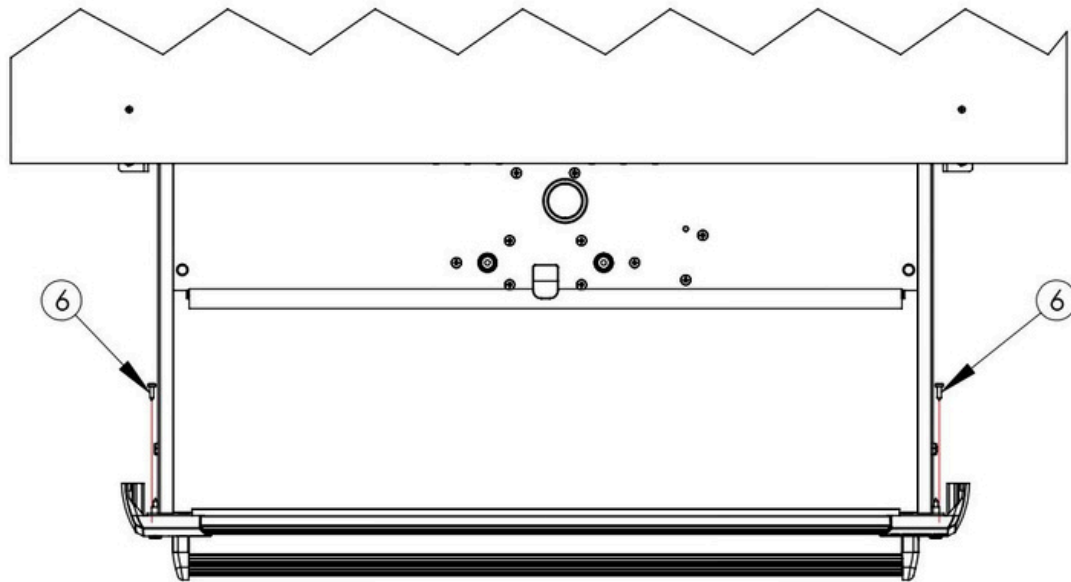

Fix the screws (6) behind the side covers (10).

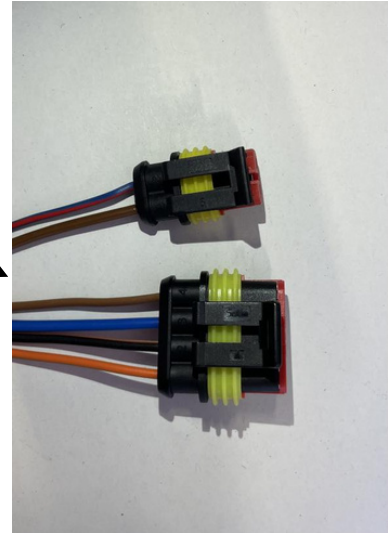

Please combine LED output socket and motor socket to the cable group (14) as below.

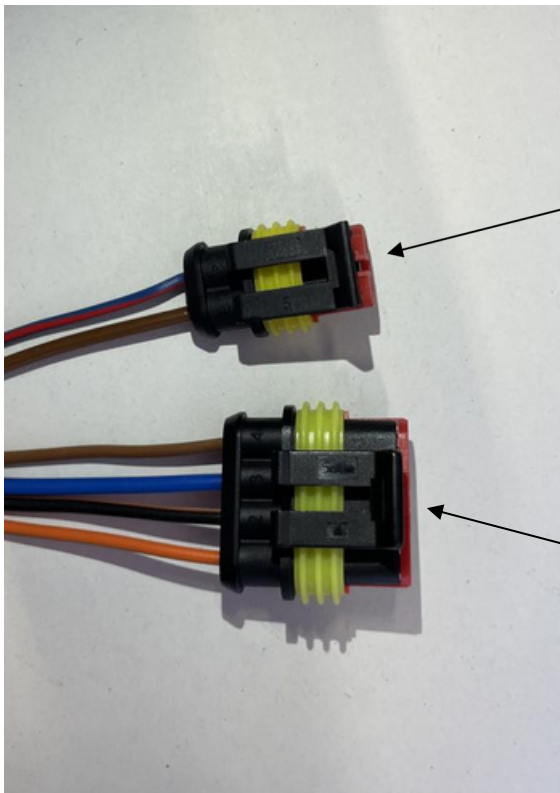

Cable group (14)

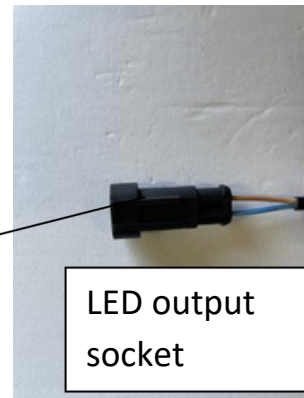

LED output socket

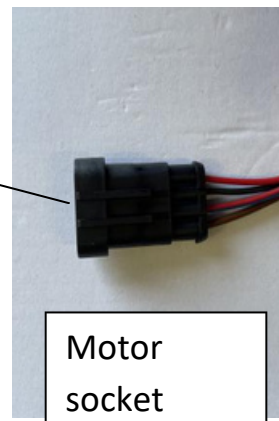

Motor socket

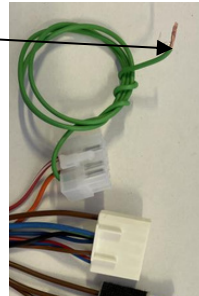

Put the two of the sockets of the cable group to the electronic board (12).

Detent cable (green)

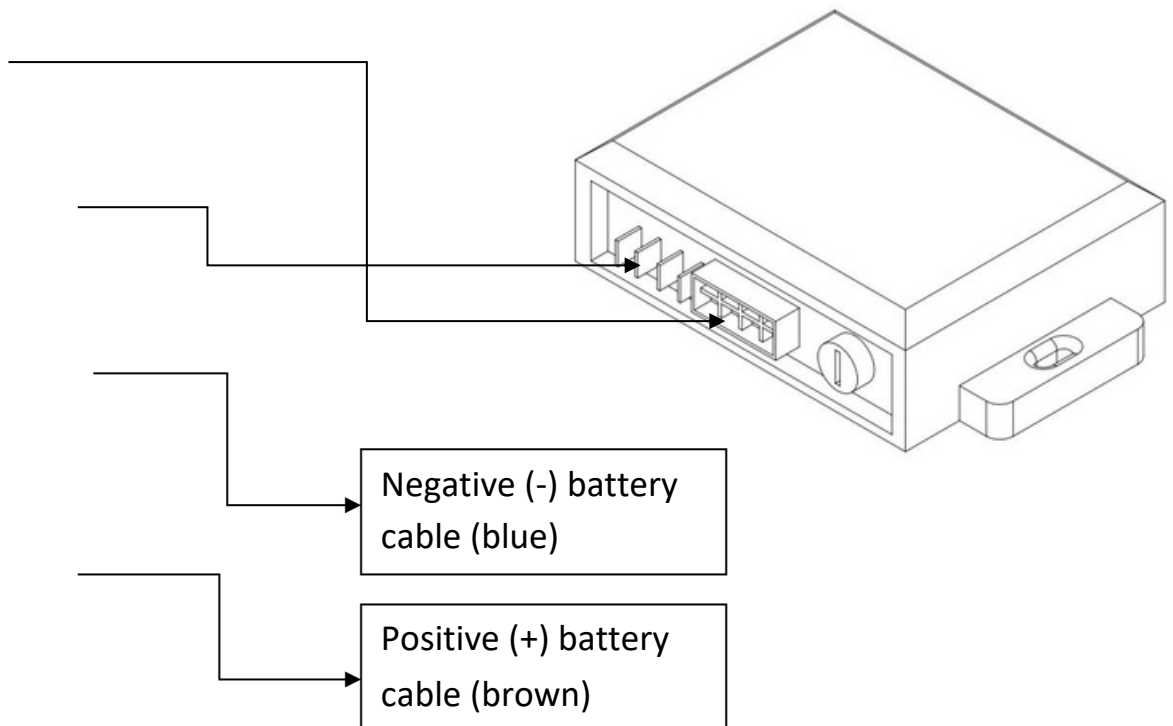

Electrical Schema

“

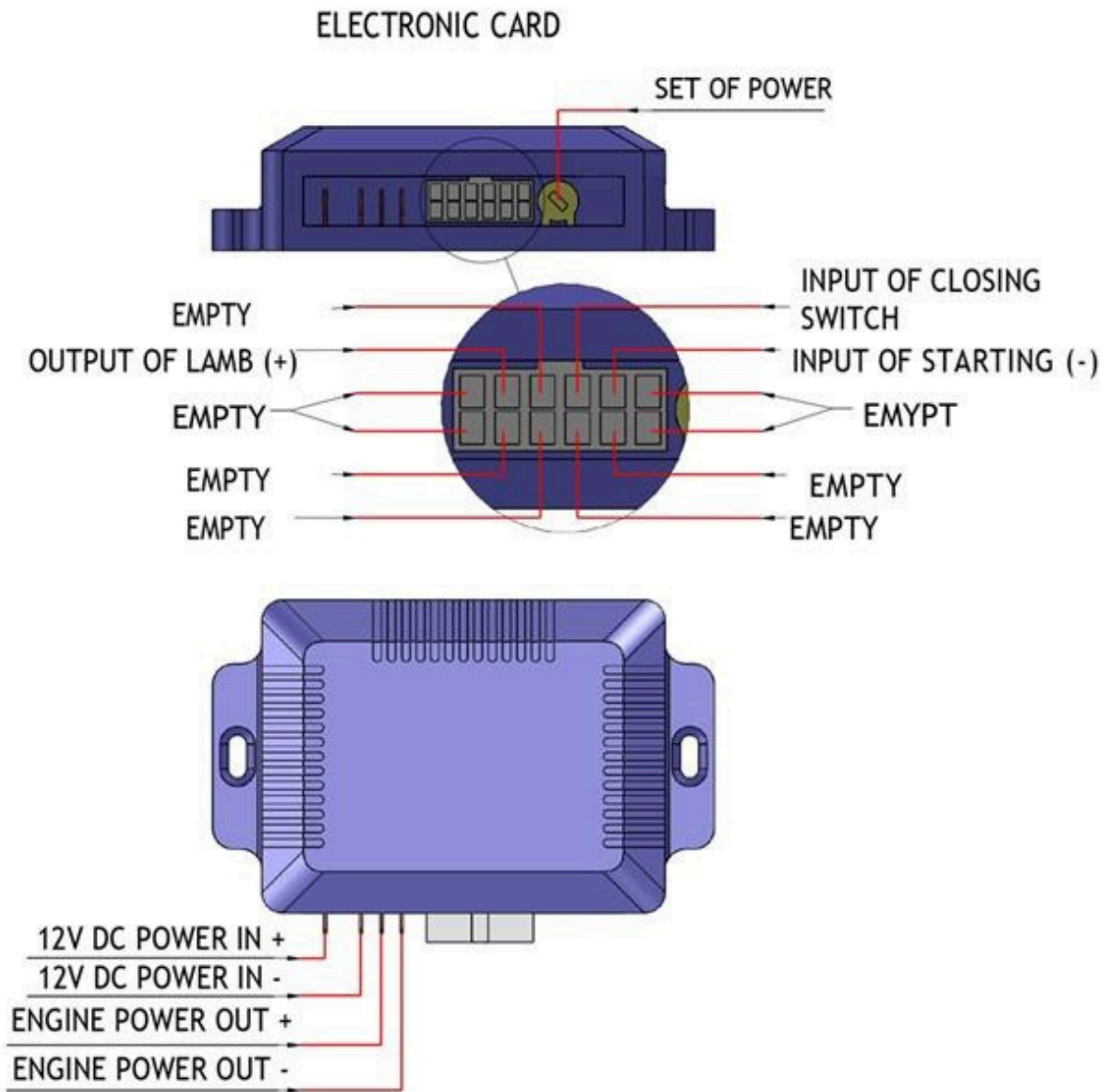

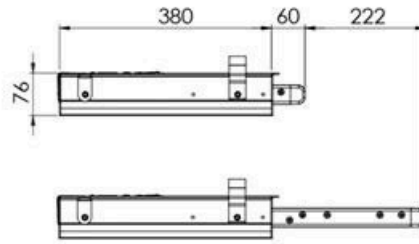
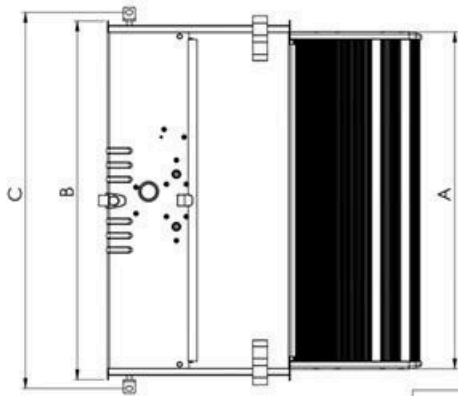

DIMENSIONS	A	B	C
400	407	452	490
550	557	602	640
700	707	752	790

4



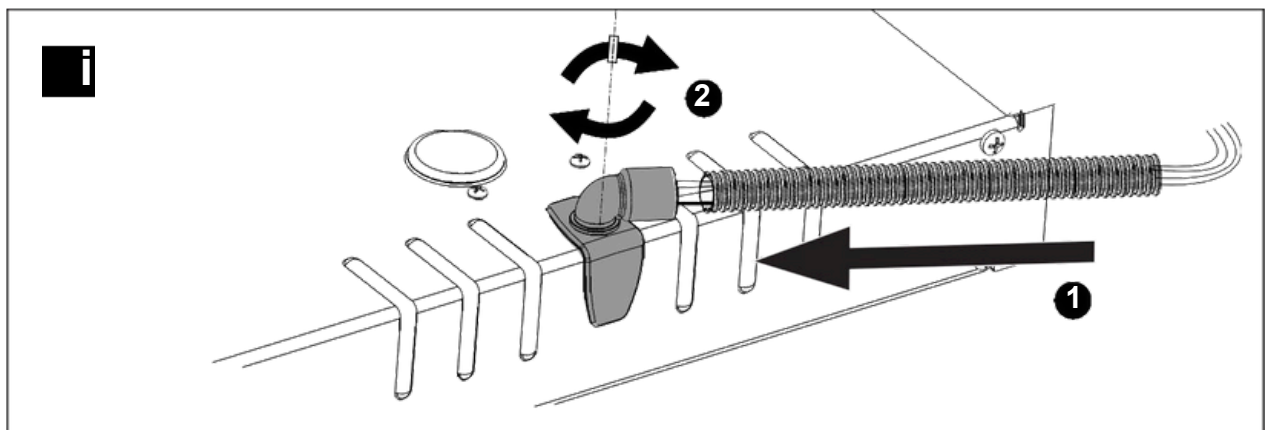
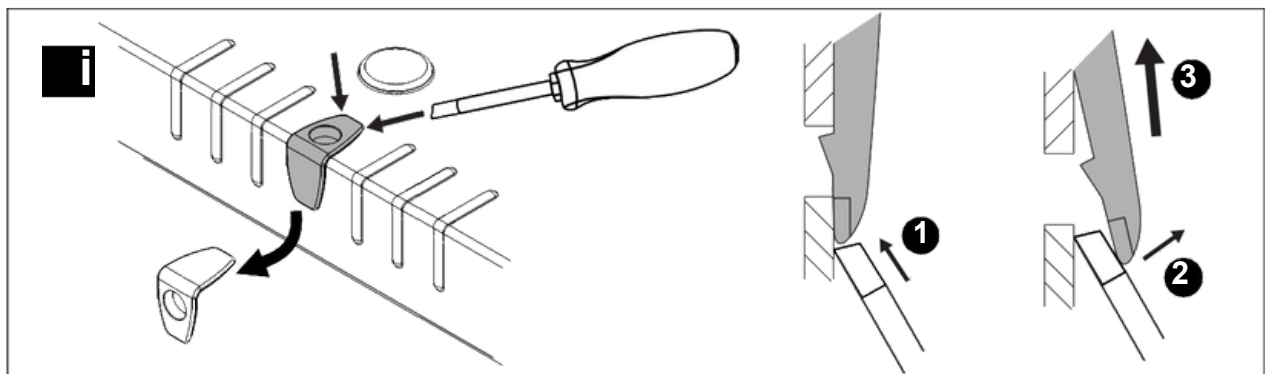
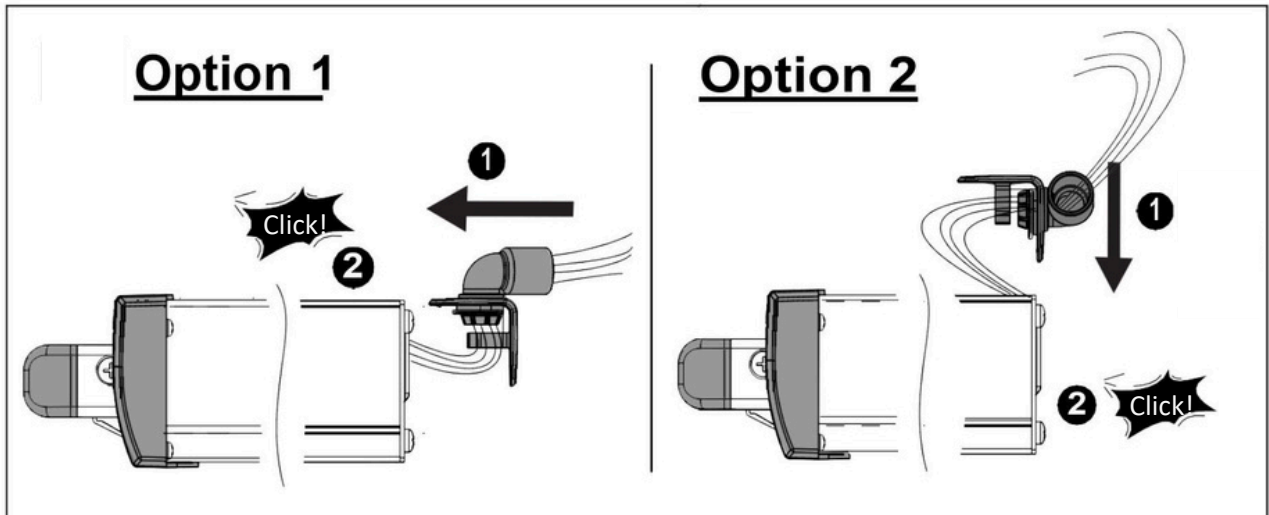

Instructions:

1-Operation

- X-STEP PP step tested up to 200 kg
- The step should not be more than 400 mm from the ground and should be 300 mm at the most from the next step when extended. (EN 1646-1, EN 1645-1)

2-Maintenance

X-STEP PP is a serviceable item and requires regular maintenance. To maintain the warranty, it must be serviced/inspected every 12 months. Sand, dirt, frost, etc., can cause the step to become get stuck. In such case, it is recommended to clean the cassette and lubricate the moving parts. Keep the footboard clean and check the operation of the switch regularly. It is possible to remove the footboard to clean the inside of the step.

- Retract the footboard using the lever switch, if possible not fully. Disconnect the power to the step.
- Detach the two driverods from the footboard by removing the clips at the underside of the footboard.
- Remove the two blackstops and screws on the outside.
- Remove and clean the footboard.
- Brush the inside of the step and remove dirt with a vacuum cleaner. Do not use a high-pressure cleaner or water.
- Reconnect the driving rods first, then secure the end stops.

MAINTENANCE

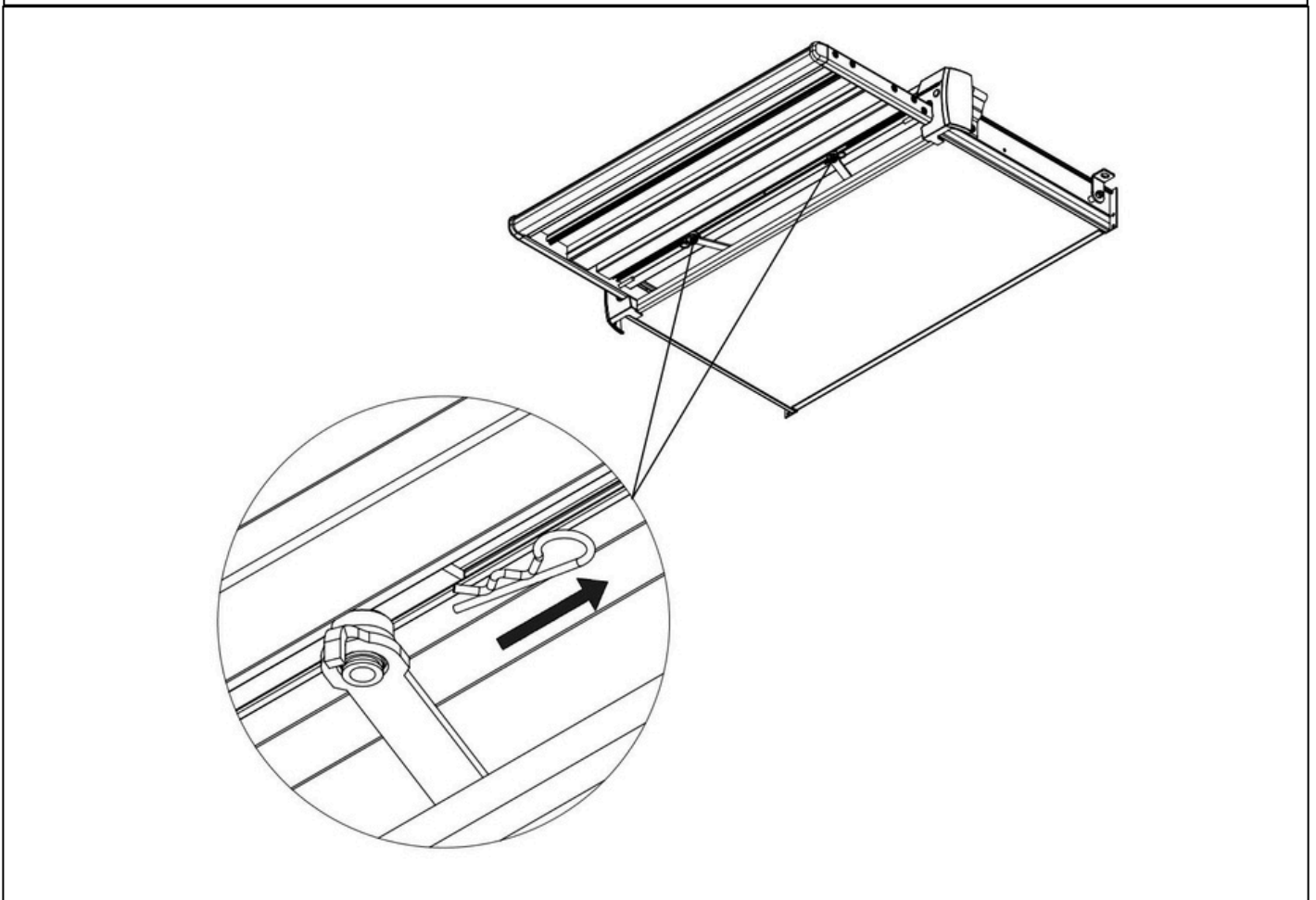
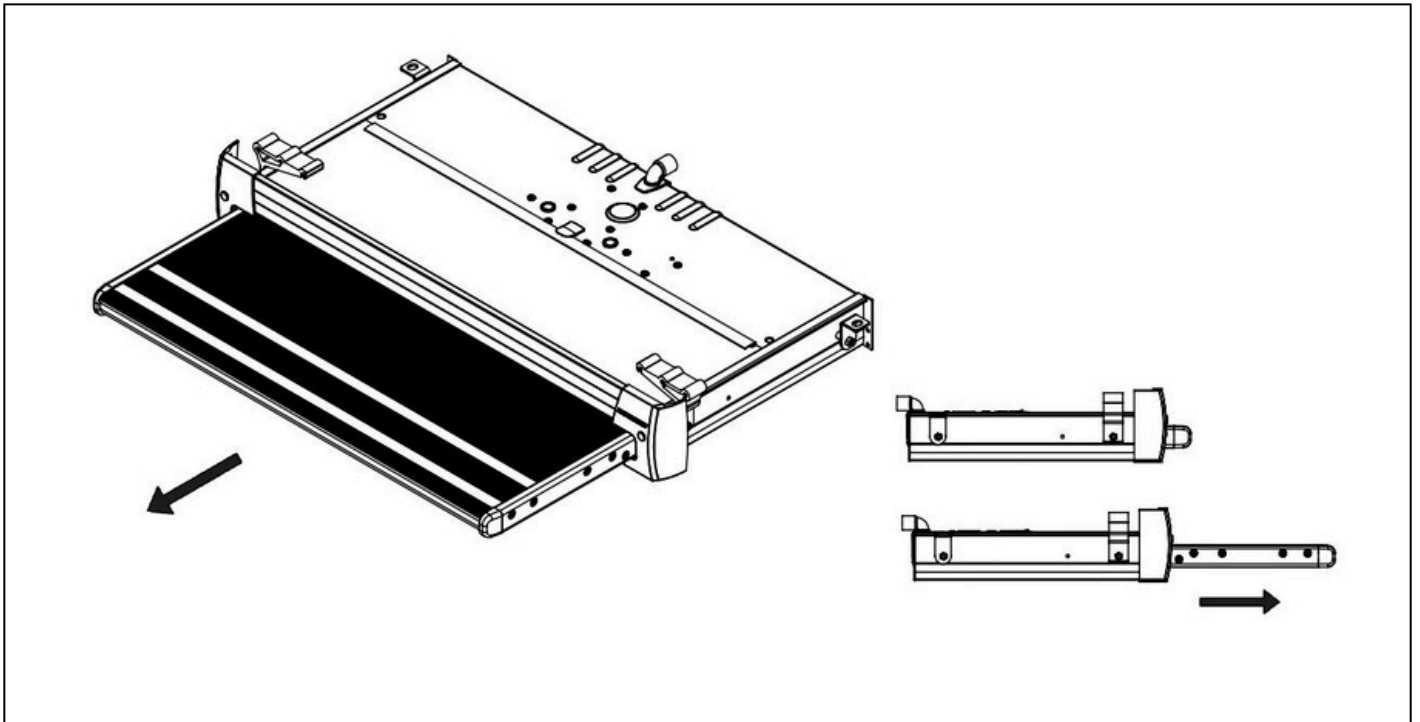

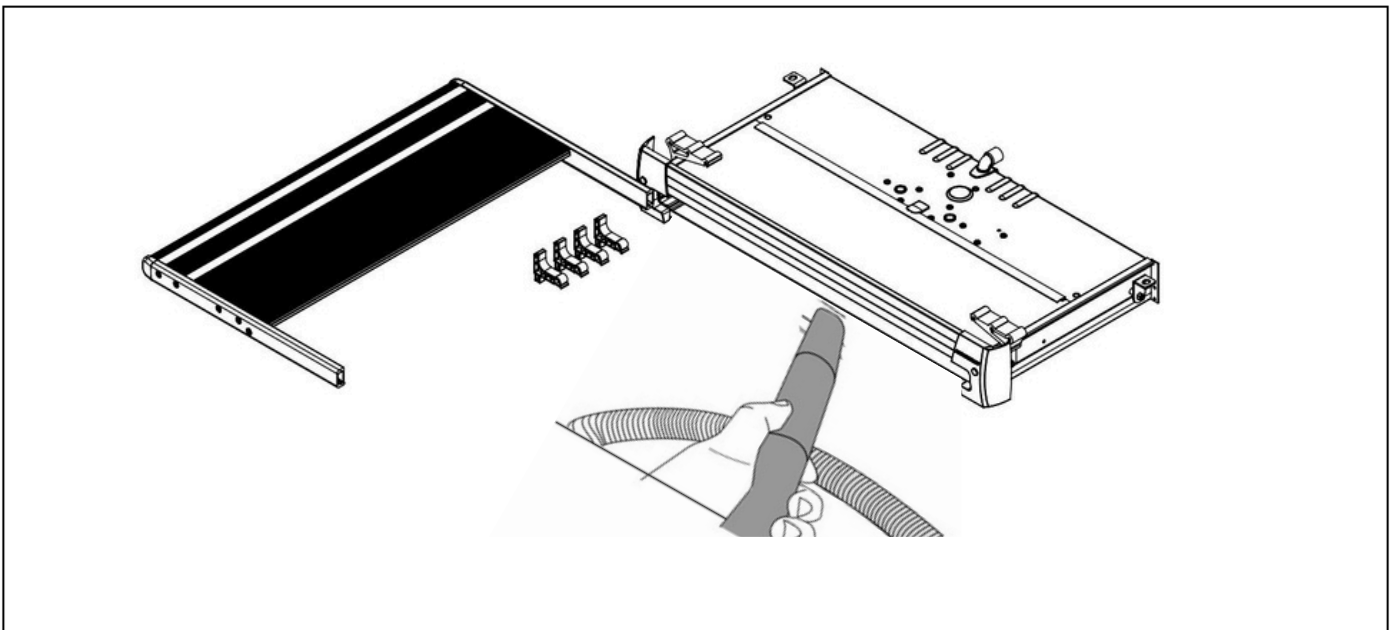
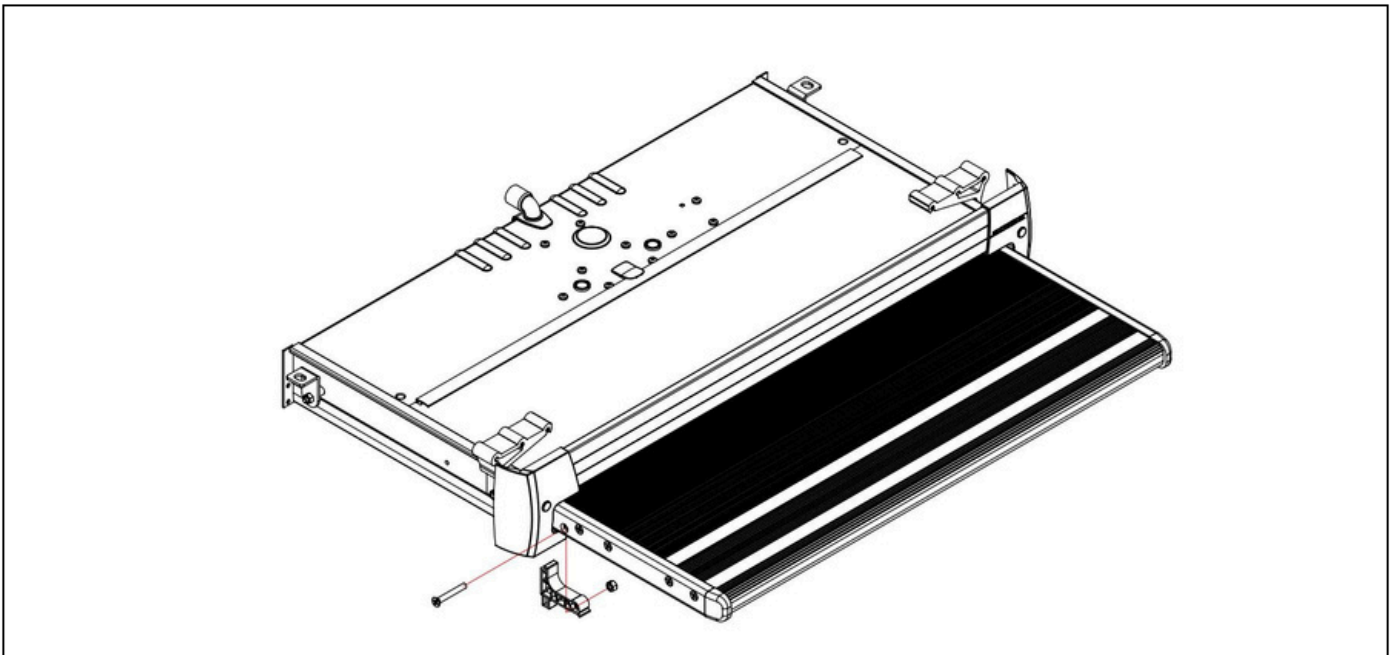
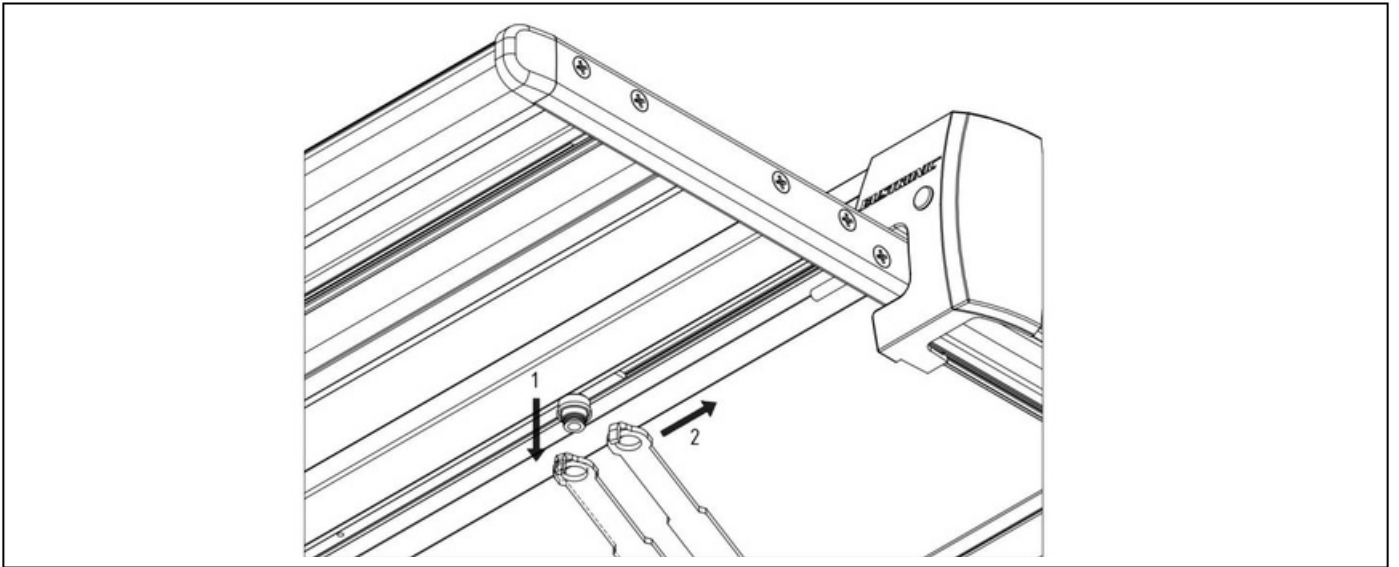

MANUAL RELEASE

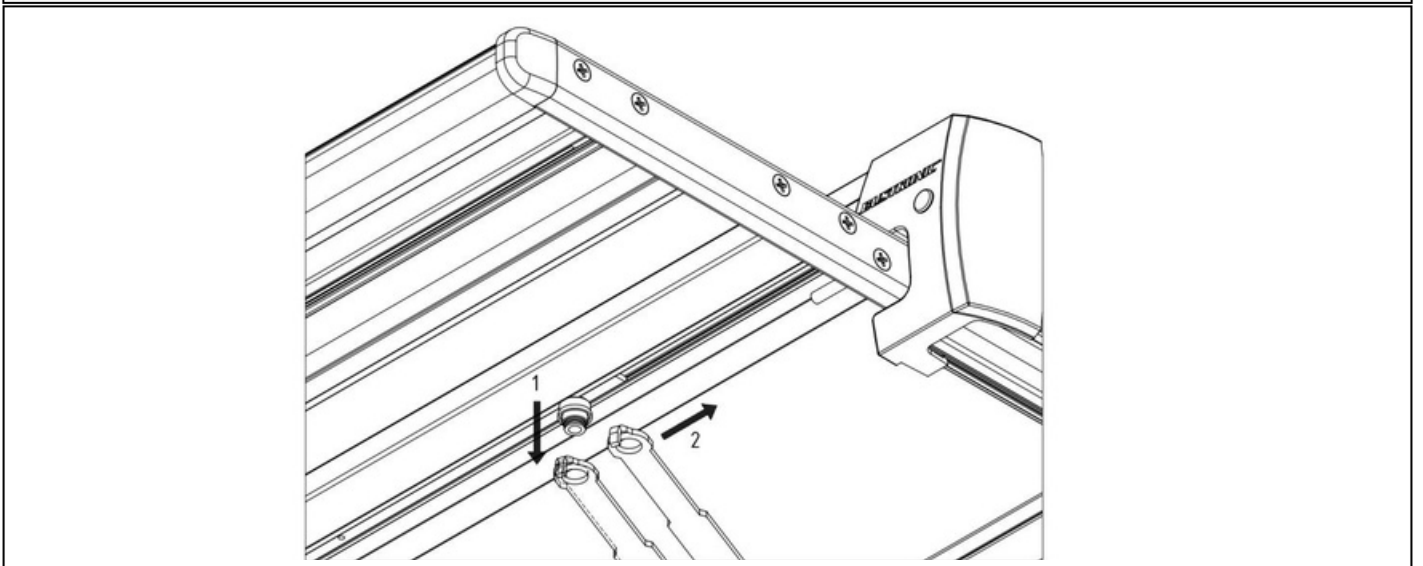
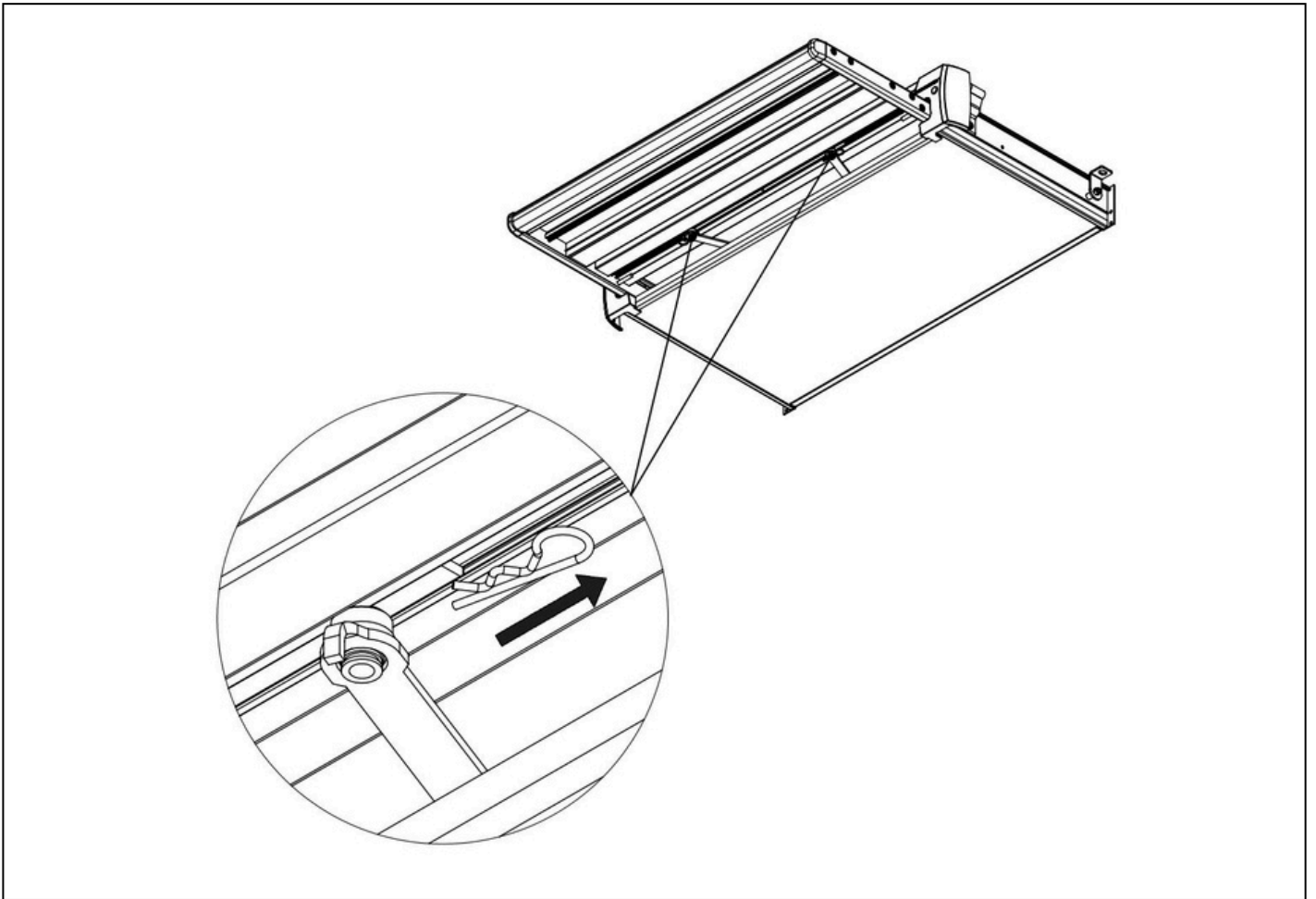

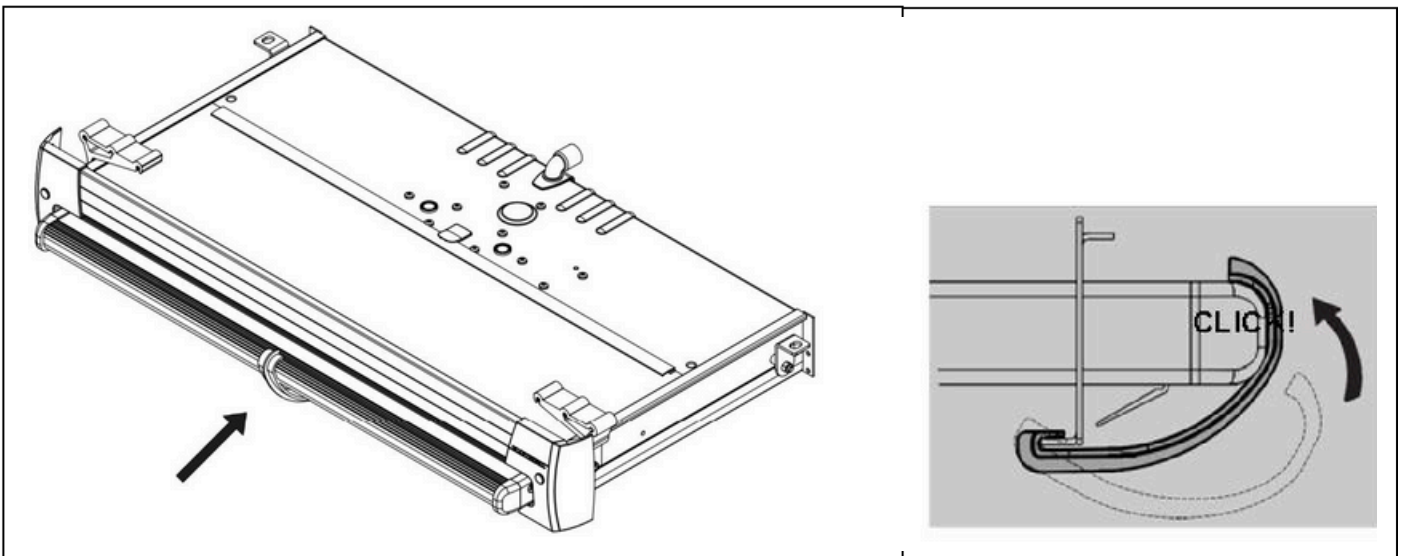
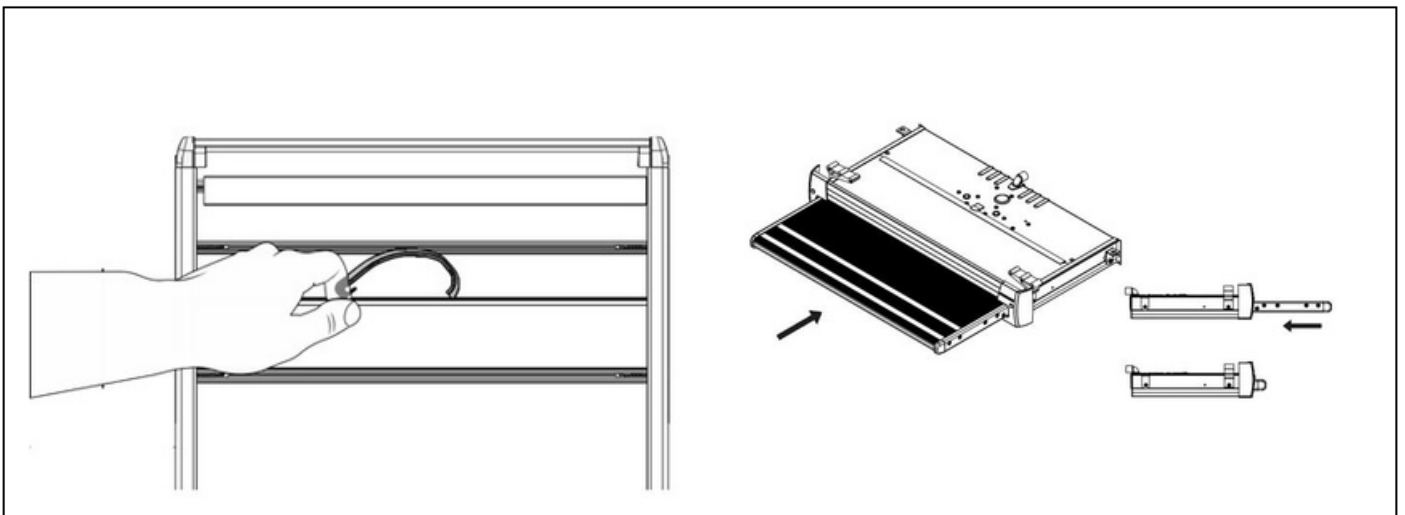
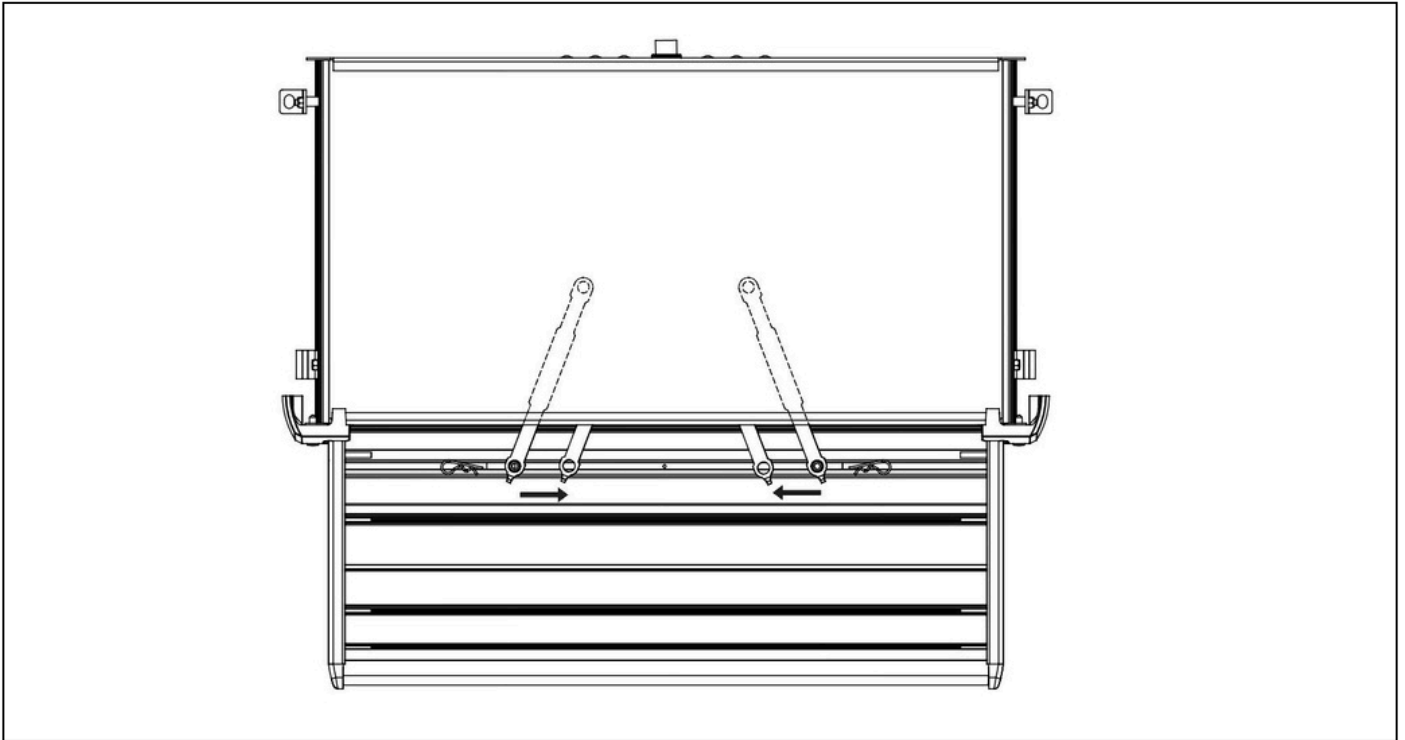

Caution!

Safety instruction relating to danger emanating from electrical currents or voltage:

Failure to observe this instruction can cause material damage or personal injury and impair the proper functioning of the device.

According to current legislation, a service inspection is required by law to be performed **once per year**. In addition to this statutory requirement, we strongly recommend carrying out **a visual service inspection** approximately **every 6 months** to ensure optimal performance, safety, and early identification of potential issues.

The manufacturer will not be held liable for claims for damage resulting from the following:

- Faulty assembly or connection
- Damage to the appliance resulting from mechanical influences and excess voltage
- Alterations to the device without express permission from the manufacturer
- Use for purposes other than those described in the operating manual

To activate and maintain the warranty, below table must be filled in correctly.

Date of installation	Service year 1
Service year 2	Service year 3
Service year 4	Service year 5