

#6440

METALLIZED POLYPROPYLENE CAPACITORS

PAM 340-010 cv4 K

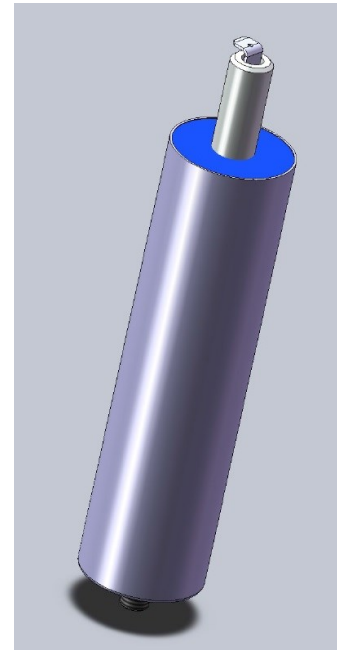
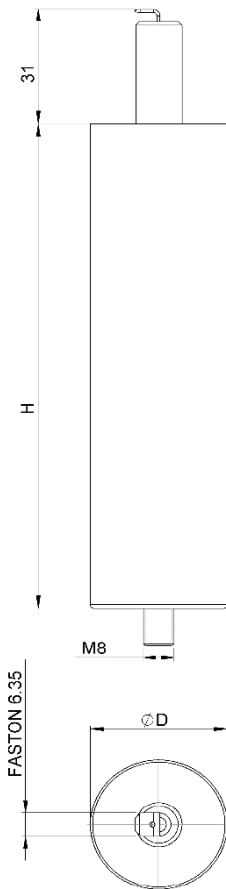

Dielectric of metallized polypropylene

FAST-ON 6.3 x 0.8 mm

Resin end sealing

Aluminium case

Parameter	Symbol	Value	Unit	Condition
Capacitance	C	0.1	μF	1 V / 1 kHz
Tolerance		± 10	%	
Rated voltage	U_r	3400	VAC	
Surge voltage	U_s	5800	V	
repetitive current	$I_{cr. max}$	300	A	
Surge current	I_s	750	A	
RMS current	I_{RMS}	16	A	
Tangent delta	$tg\delta$	≤ 5	10^{-4}	1 V / 1 kHz
Equivalent serie resistance	ESR	≤ 26.0	$m\Omega$	100 kHz
Stray inductance	ESL	≤ 200	nH	
insulation resistance between terminals	R_i	$\geq 50\,000$	$M\Omega$	500 V / 1 min
Test voltage between terminals	U_T	3400	VAC	50 Hz / 10 sec.
Ambiant temperature		- 25 ... + 85	$^{\circ}\text{C}$	

Dimension	Symbol	Value	Unit	Conditions
Diameter	D	35	mm	
Height	H	131	mm	
Terminals				
Fast-on		6.3 x 0.8	mm	
fixing stud		M8	mm	

M1			
M0			
Modification	Date	Visa émetteur	

Condensateurs CH 1400 Yverdon, Switzerland
 Kondensatoren Tel.: ++41 24 445 66 88
 Capacitors Fax: ++41 24 445 66 89

Leclanché
Capacitors
A FISCHER & TAUSSCHÉ COMPANY

HJJ

www.Lcap.ch
 28.09.2015

capinfo@Lcap.ch
 faisab6440.XLS