

#6439

METALLIZED POLYPROPYLENE CAPACITORS

PAM 140-1.0 cv4 K

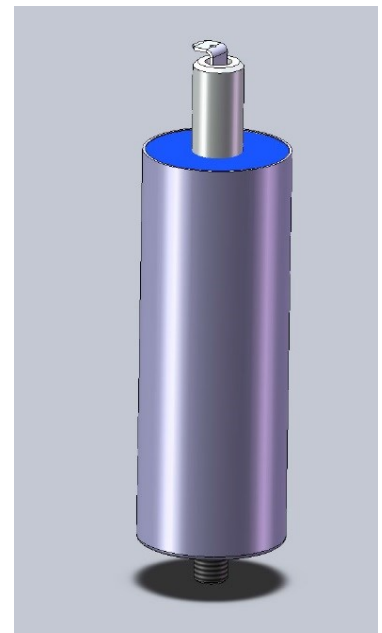
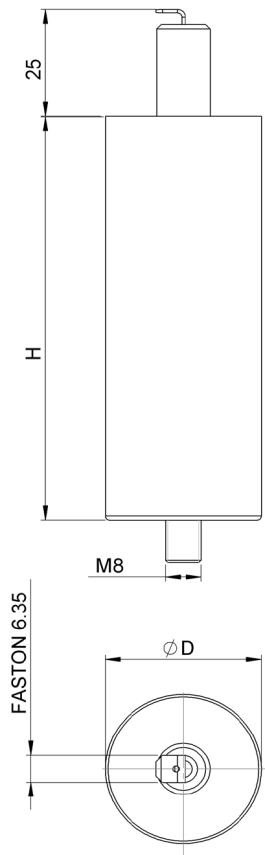

Dielectric of metallized polypropylene

FAST-ON 6.3 x 0.8 mm

Resin end sealing

Aluminium case

Parameter	Symbol	Value	Unit	Condition
Capacitance	C	1	$\mu\text{F}$	1 V / 1 kHz
Tolerance		$\pm 10$	%	
Rated voltage	$U_r$	2000	VAC	
Surge voltage	$U_s$	2400	V	
repetitive current	$I_{cr. max}$	600	A	
Surge current	$I_s$	1500	A	
RMS current	$I_{RMS}$	18	A	
Tangent delta	$tg\delta$	$\leq 5$	$10^{-4}$	1 V / 1 kHz
Equivalent serie resistance	ESR	$\leq 12.5$	$m\Omega$	100 kHz
Stray inductance	ESL	$\leq 100$	nH	
insulation resistance between terminals	$R_i$	$\geq 50\,000$	$M\Omega$	500 V / 1 min
Test voltage between terminals	$U_T$	1800	VAC	50 Hz / 10 sec.
Ambiant temperature		- 25 ... + 85	$^{\circ}\text{C}$	

Dimension	Symbol	Value	Unit	Conditions
Diameter	D	35	mm	
Height	H	95	mm	
Terminals				
Fast-on		6.3 x 0.8	mm	
fixing stud		M8	mm	

M1			
M0			
Modification	Date	Visa émetteur	

Condensateurs CH 1400 Yverdon, Switzerland  
 Kondensatoren Tel.: ++41 24 445 66 88  
 Capacitors Fax: ++41 24 445 66 89

**Leclanché**  
**Capacitors**  
A FISCHER & TAUSSIG COMPANY

HJJ

www.Lcap.ch  
 25.09.2015

capinfo@Lcap.ch  
 faisab6439.XLS