

#5613

## Power Electronics Capacitors

MKT 10-8.2 a K

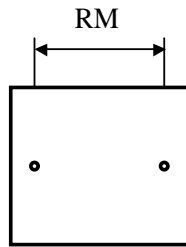

Operating conditions		
Ambient Temperature [°]	Voltage [VDC]	Current I RMS max 300 kHz
100	Ur	6.1 A
115	0.85 Ur	3.9 A
125	0.75 Ur	1.1 A

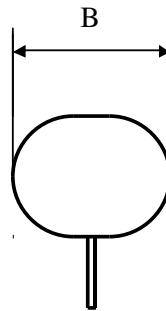
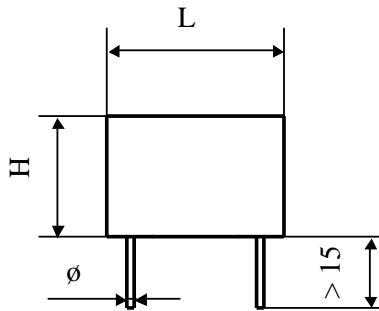

Dielectric : metallized polyester  
Polyester wrapped

Epoxy resin sealing

Parameter	Symbol	Value	Unit	Condition
Capacitance	C	8.2	μF	1 V / 1 kHz
Tolerance		± 10	%	
Rated voltage	Ur	100	VDC	100°C
Rated voltage	Un AC	40	Veff	50 Hz
RMS current	I RMS ma	6.1	Aeff	300 kHz / 100°C
Tangent delta	tgδ	≤ 85	1C <sup>-4</sup>	1 kHz
Equivalent serie resistance	ESR	≤ 6	mΩ	300 kHz
Stray inductance	ESL	≤ 15	nH	
Insulation resistance	Ri	1220	MΩ	50 VDC - 1 min
Test voltage between terminals	U T1	160	VDC	10 s
Climatic category		40/105/56		

Dimension	Symbol	Value	Unit	Conditions
Width	B max	16	mm	
Height	H max	12	mm	
Length	L max	17	mm	
Terminals				
Radial tinned wire	∅	1	mm	
RM		12.5 ± 0.5	mm	
	M1	06.11.2007	HJJ	
	M0	18.12.2006	HJJ	
	Modification	Date	Visa émetteur	

Condensateurs CH 1401 Yverdon-les-Bains  
Kondensatoren Tel.: ++41 24 445 66 88  
Capacitors Fax: ++41 24 445 66 89

**Le lanché**  
**Capacitors**  
A FISCHER & FABRICE COMPANY

HJJ

21.11.2006

faisab5613.XLS