

#5649

Power Electronics Capacitors

MKT 10-75.0 c6 K

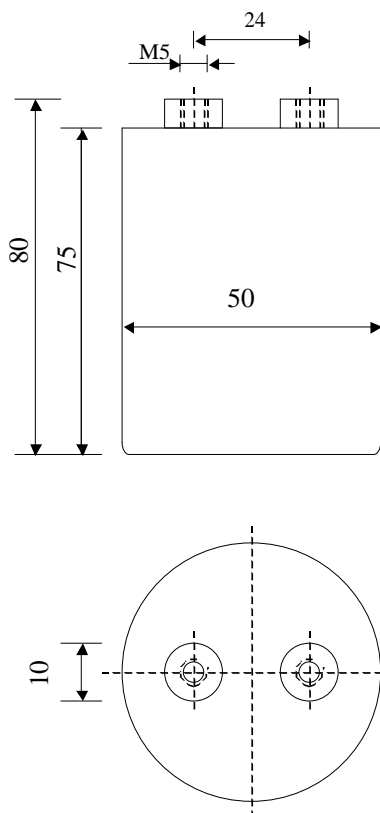

Dielectric of metallized polyester

Threaded outputs

Epoxy resin end sealing

Aluminium case

Parameter	Symbol		Value	Unit	Condition
Capacitance	C		75	$\mu\text{F}$	1 V / 1 kHz
Tolerance			$\pm 10$	%	
Rated voltage	$U_n \text{ DC}$		100	VDC	
RMS current (40 kHz)	I RMS max.		43	$A_{\text{eff}}$	25 °C
RMS current (40 kHz)	I RMS max.		37	$A_{\text{eff}}$	45 °C
RMS current (40 kHz)	I RMS max.		26	$A_{\text{eff}}$	65 °C
RMS current (40 kHz)	I RMS max.		20	$A_{\text{eff}}$	75 °C
Surge current	I cr. max		2500	A	
Tangente delta	$\text{tg}\delta$		$\leq 100$	$10^{-4}$	1 kHz
Equivalent serie resistance	ESR		$\leq 3.5$	$\text{m}\Omega$	40 kHz
Stray inductance	ESL		$\leq 25$	nH	
Insulation resistance	$R_i$		133	$\text{M}\Omega$	100 VDC - 1 min
Test voltage between terminals	U T1		150	VDC	10 s
Climatic category			40/105/56		
Dimension	Symbol			Unit	Conditions
Diameter	D		50	mm	
Height	H		75	mm	
Terminals					
Thread			M5 x 10	mm	
Thread spacing			24	mm	
	M1				
	M0				
	Modification	Date	Visa émetteur		

Condensateurs CH 1400 Yverdon-les-Bains  
 Kondensatoren Tel.: ++41 24 445 66 88  
 Capacitors Fax: ++41 24 445 66 89

**Le lanché**  
**Capacitors**  
A FISCHER & WALDICH COMPANY

HJJ

19.03.2007

faisab5649.XLS