

#5635

METALLIZED POLYPROPYLENE CAPACITORS

PPM 120-50.0 cv6 K

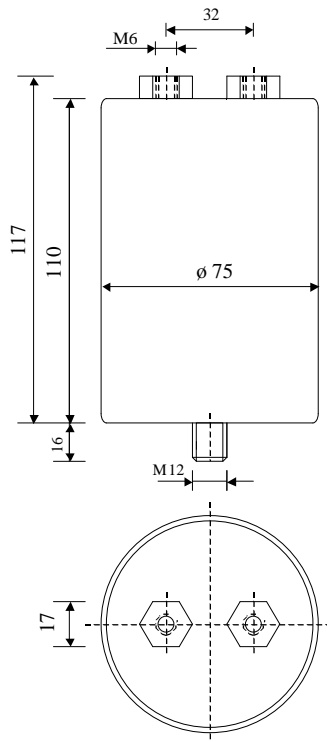

Dielectric of metallized polypropylene

Threaded outputs

Resin end sealing

Aluminium case

Parameter	Symbol	Value	Unit	Condition
Capacitance	C	50	μF	1 V / 1 kHz
Tolerance		± 10	%	
Rated voltage	Un DC	1200	VDC	
Rated voltage	Un AC	400	VAC	50 Hz to 300 Hz
RMS Current - 30 kHz	I _{eff} max.	50	A _{eff}	Temp. Amb. max 45°C
Slope of voltage variation	du/dt max.	16	V/ μs	max. repetitive
Repetitive surge current	I cr. max	800	A	
Tangente delta	tg δ	≤ 9	10^{-4}	1 V / 1 kHz
Equivalent serie resistance	ESR	2.4	m Ω	1 V / 10 kHz
Stray inductance	ESL	≤ 100	nH	
Insulation resistance	Ri x C	$\geq 20'000$	s	300 VDC - 1 min
Test voltage between terminals	U T1	1800	VDC	10 s
Test voltage terminals to case	U T2	2700	VAC	50 Hz / 1 min
Climatic category		55/105/56		
Dimension	Symbol		Unit	Condition
Diameter	D	75	mm	
Height	H	110	mm	
Terminals				
Thread		M6 x 6	mm	
Thread spacing	e	32	mm	
Fixing stud		M12 x 16	mm	
	M1			
	M0			
	Modification	Date	Visa émetteur	

Condensateurs CH 1400 Yverdon-les-Bains
 Kondensatoren Tel.: ++41 24 445 66 88
 Capacitors Fax: ++41 24 445 66 89

Le Janché
Capacitors
A FISCHER & TROSCHE COMPANY

HJJ

05.02.2007

faisab5635.XLS