

Leclanché Capacitors
 48, av. de Grandson
 1400 Yverdon, Switzerland



Tel. +41 24 445 66 88
 Fax +41 24 445 66 89
capinfo@Lcap.ch
www.Lcap.ch

Drawing No. : 1024429-53567
 created from : 08/11/2012 08:10:00

Part Number : GMB36336090200

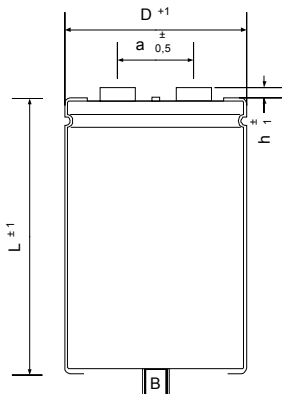

∅ D : 90 mm
 L : 200 mm
 a : 31,7 mm
 h : 5 mm
 B : M12
 Terminals : M6

Electrical Parameter

Rated Capacitance (C_R) @ 100 Hz / 20 °C	36000 μF	
Tolerance	±20 %	
Rated Voltage (U_R)	360 V	
Surge Voltage (U_S) max. 5 x 1 min / h	396 V	
Reverse Voltage (U_U) max. 1 s	2 V	
Leakage Current (I_L) @ U_R / 5 min / 20 °C	78 mA	
ESR typ. @ 100 Hz / 20°C	3 mΩ	
Tan δ typ. @ 100 Hz / 20°C	6 %	
Z max. @ 10 kHz / 20°C	2,4 mΩ	
ESL typ.	20 nH	
Rated Ripple Current (I_R) @ 100 Hz / 85 °C	26,3 A	
Useful life @ $I_R, U_R, 85$ °C	8000 h	21 A -> 15000 h
IEC Climatic category / Standards	40/085/56	IEC 60384-4
Applications	General Industrial	
Your article No. / Project		