

Leclanché Capacitors
48, av. de Grandson
1400 Yverdon, Switzerland



Tel. +41 24 445 66 88
Fax +41 24 445 66 89
capinfo@Lcap.ch
www.Lcap.ch

Drawing No. : 1027192-53567 **Preliminary**
created from : 06/05/2014 07:16:00 release: 13.05.2014 06:50:00

Part Number : GB68210075145

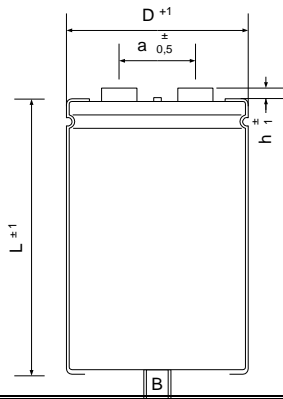

∅ D : 75 mm
L : 145 mm
a : 31,7 mm
h : 5 mm
B : M12
Terminals : M5

Electrical Parameter

Rated Capacitance (C_R) @ 100 Hz / 20 °C	6800 μ F	
Tolerance	-10 +30 %	
Rated Voltage (U_R)	100 V	
Surge Voltage (U_S) max. 5 x 1 min / h	115 V	
Reverse Voltage (U_U) max. 1 s	2 V	
Leakage Current (I_L) @ U_R / 5 min / 20 °C	1400 μ A	
ESR typ. @ 100 Hz / 20°C	23 m Ω	
Tan δ typ. @ 100 Hz / 20°C	10 %	
Z max. @ 10 kHz / 20°C	19 m Ω	
ESL typ.	20 nH	
Rated Ripple Current (I_R) @ 100 Hz / 105 °C	9,5 A	
Useful life @ $I_R, U_R, 105$ °C	8000 h	2000h @ 20A ($\Delta T_{over} = 20^\circ C$) 1000h @ 24A ($\Delta T_{over} = 30^\circ C$)
IEC Climatic category / Standards	55/105/56	IEC 60384-4
Applications	General Industrial	
Your article No. / Project		