

Leclanché Capacitors  
48, av. de Grandson  
1400 Yverdon, Switzerland



Tel. +41 24 445 66 88  
Fax +41 24 445 66 89  
[capinfo@Lcap.ch](mailto:capinfo@Lcap.ch)  
[www.Lcap.ch](http://www.Lcap.ch)

Drawing No. : 1011745-53567  
created from : 10/06/2014 21:36:00

**Part Number : EFVA 63-2200 35047**

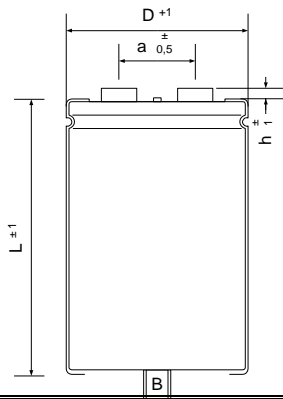

∅ D : 35 mm  
L : 47 mm  
a : 13 mm  
h : 6 mm  
B : M8  
Terminals : M5

**Electrical Parameter**

Rated Capacitance ( C <sub>R</sub> ) @ 100 Hz / 20 °C	<b>2200</b> μF	
Tolerance	<b>-10 +30</b> %	
Rated Voltage ( U <sub>R</sub> )	<b>63</b> V	
Surge Voltage ( U <sub>S</sub> ) max. 5 x 1 min / h	<b>72</b> V	
Reverse Voltage ( U <sub>U</sub> ) max. 1 s	<b>2</b> V	
Leakage Current ( I <sub>L</sub> ) @ U <sub>R</sub> / 5 min / 20 °C	<b>832</b> μA	
ESR typ. @ 100 Hz / 20°C	<b>80</b> mΩ	
Tan δ typ. @ 100 Hz / 20°C	<b>11</b> %	
Z max. @ 10 kHz / 20°C	<b>64</b> mΩ	
ESL typ.	<b>20</b> nH	
Rated Ripple Current ( I <sub>R</sub> ) @ 100 Hz / 105 °C	<b>2,67</b> A	
Useful life @ I <sub>R</sub> , U <sub>R</sub> , 105 °C	<b>8000</b> h	
IEC Climatic category / Standards	<b>40/105/56</b>	<b>IEC 60384-4</b>
Applications	General Industrial	
Your article No. / Project		