

B-TAP® Insulation-Piercing Tap Connectors

- Eliminates split bolts and tape
- Easy two-minute installation requires only box/socket wrench
- Installs on energized systems eliminating costly power shutdowns
- Self-sealing, grease-filled end-cap ensures safe, weather-tight connection
- Unique turbo spacer keeps connector wide open for quick and easy installation
- Torque-regulating nut breaks off when proper tension is reached
- Full-line is 600V dual-rated, 194°F (90°C)



B-Tap® Wire Range Chart
Wire Size

Cat. No.	Main	Tap	14	12	10	8	6	4	3	2	1	1/0	2/0	3/0	4/0	250	300	350	400	500	750	
BTC1/0-10	Main: 1/0 - 8	Tap: 2 - 10																				
BTC2/0-14	Main: 2/0 - 4	Tap: 10 - 14																				
BTC4/0-12	Main: 4/0 - 2	Tap: 4/0 - 4																				
BTC4/0-10	Main: 4/0 - 3	Tap: 2 - 10																				
BTC4/0-6	Main: 4/0 - 2	Tap: 2/0 - 6																				
BTC250-4	Main: 250 - 1	Tap: 4/0 - 4																				
BTC350-1/0	Main: 350 - 1/0	Tap: 350 - 1/0																				
BTC500-4	Main: 500 - 2/0	Tap: 4/0 - 4																				
BTC500-1/0	Main: 500 - 4/0	Tap: 350 - 1/0																				
BTC500-14	Main: 750 - 3/0	Tap: 10 - 14																				
BTC750-250	Main: 750 - 250	Tap: 500 - 250																				

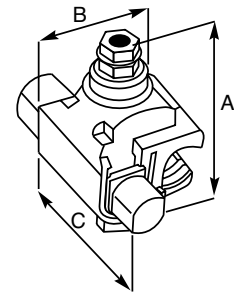

Conductor Range		Voltage Rating	Dimensions (Inches)			Socket Size (Inches)	Torque (In. Lbs.)	No. of Bolts	Cat. No.
Run	Tap		A	B	C				
1/0-8	2-10 ¹	600V	3.1	1.8	2.2	1/2	80	1	BTC1/0-10
2/0-4	10-14 ²	600V	3.1	1.8	2.2	1/2	80	1	BTC2/0-14
4/0-2	4/0-4	600V	4.4	2.4	3.2	1/2	160	1	BTC4/0-2
4/0-3	2-10 ³	600V	3.1	1.8	2.2	1/2	125	1	BTC4/0-10
4/0-2	2/0-6	600V	3.5	2.2	2.5	1/2	160	1	BTC4/0-6
250-1	4/0-4	600V	3.5	2.2	2.5	1/2	160	1	BTC250-4
350-1/0	350-1/0	600V	4.5	3	3.9	5/8	330	2	BTC350-1/0
500-2/0	4/0-4	600V	4.5	3	3.9	5/8	330	2	BTC500-4
500-4/0	350-1/0	600V	4.5	3	3.9	5/8	330	2	BTC500-1/0
750-3/0	10-14 ⁴	600V	3.7	2.5	2.2	1/2	80	1	BTC500-14
750-250	500-250	600V	4.7	3.4	4.75	5/8	330	2	BTC750-250

¹ Tap #2 - #10 Cu solid/stranded; #2 - #10 Al stranded
² Tap #10 - #14 Cu solid/stranded; #10 - #14 Al stranded

³ Tap #2 - #10 Cu solid/stranded; #2 - #8 Al stranded
⁴ Tap #10 - #14 Cu solid/stranded; #10 - #12 Al stranded

