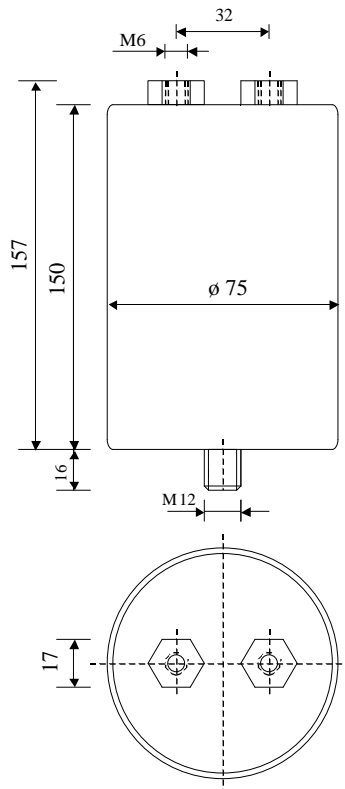

#5539

METALLIZED POLYPROPYLENE CAPACITORS

PPM 50-650.0 cv6 K

Dielectric of metallized
polypropylene

Threaded outputs

Resin end sealing

Aluminium case

Parameter	Symbol	Value	Unit	Condition
Capacitance	C	650	μF	1 V / 1 kHz
Tolerance		± 10	%	
Rated voltage	Un DC	500	VDC	
RMS Current	$I_{\text{eff max.}}$	47.5	Aeff	Temp. Amb. max 25°C
RMS Current	$I_{\text{eff max.}}$	36.6	Aeff	Temp. Amb. max 50°C
RMS Current	$I_{\text{eff max.}}$	20.5	Aeff	Temp. Amb. max 75°C
Repetitive surge current	I cr. max	4100	A	
Tangente delta	$\text{tg}\delta$	≤ 200	10^{-4}	1 V / 1 kHz
Equivalent serie resistance	ESR	5	m Ω	1 V / 10 kHz
Stray inductance	ESL	≤ 100	nH	
Insulation resistance	Ri x C	$\geq 20'000$	s	300 VDC - 1 min
Test voltage between terminals	U T1	800	VDC	10 s
Test voltage terminals to case	U T2	2500	VAC	50 Hz / 1 min
Climatic category		55/105/56		

Dimension	Symbol	Value	Unit	Condition
Diameter	D	75	mm	
Height	H	150	mm	
Terminals				
Thread		M6 x 6	mm	
Thread spacing	e	32	mm	
Fixing stud		M12 x 16	mm	

	M1			
	M0			
	Modification	Date	Visa émetteur	

Condensateurs CH 1401 Yverdon-les-Bains
 Kondensatoren Tel.: ++41 24 445 66 88
 Capacitors Fax: ++41 24 445 66 89

Le Lanché
Capacitors
A FISCHER & TAUSSIG COMPANY

HJJ

01.02.2006

faisab5539.XLS