

#5911

METALLIZED POLYPROPYLENE CAPACITORS

PPM 1500-110 ru K

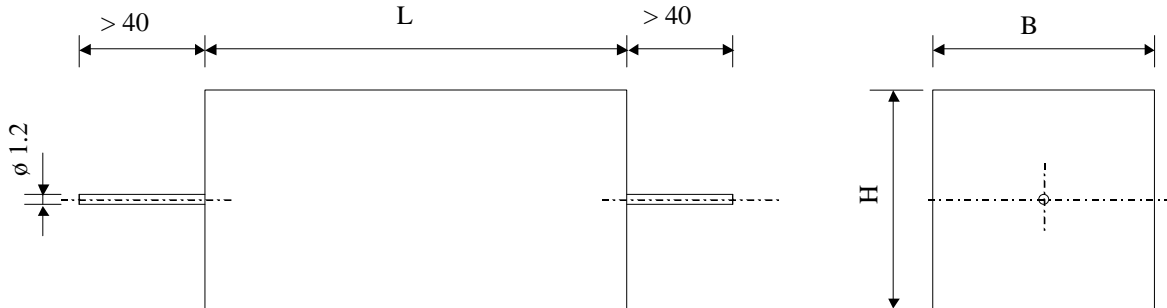

Dielectric of metallized polypropylene

Plastic case - resin filled

Parameter	Symbol	Value	Unit	Condition
Capacitance	C	0.01	$\mu\text{F}$	1 V / 1 kHz
Tolerance		$\pm 10$	%	
Rated voltage	Un DC	15'000	VDC	
Rated voltage	Un AC	7200	VAC	50 Hz
slope of voltage variation	du/dt max.	5'000	V/ $\mu\text{sec}$	max. repetitive
Repetitive surge current	I cr. max	50	A	
Tangente delta	tg $\delta$	6	$10^{-4}$	1 V / 1 kHz
Tangente delta	tg $\delta$	12	$10^{-4}$	1 V / 10 kHz
Stray inductance	ESL	$\leq 160$	nH	
Insulation resistance	Ri	$> 100'000$	M $\Omega$	300 VDC - 1 min
Test voltage between terminals	U T1	22'500	VDC	10 s.
Climatic category		40/85/56		
Estimated operational life (-3%)		100'000	h	Un DC / 70°C
Dimension	Symbol	Value	Unit	Conditions
Width	B	$42 \pm 1$	mm	
Height	H	$40 \pm 1$	mm	
Length	L	$100 + 0 / -1$	mm	
Terminals				
Axial tinned wire	d	$\varnothing 1.2 \times 40$	mm	
	M1			
	M0			
	Modification	Date	Visa émetteur	

Condensateurs CH 1400 Yverdon-les-Bains  
 Kondensatoren Tel.: ++41 24 445 66 88  
 Capacitors Fax: ++41 24 445 66 89

**Le lanché**  
**Capacitors**  
A FISCHER & TAUSSIG COMPANY

HJJ

23.03.2010

faisab5911.XLS