

#5855

## Discharge Capacitors

MKTF 60-5000.0 r K

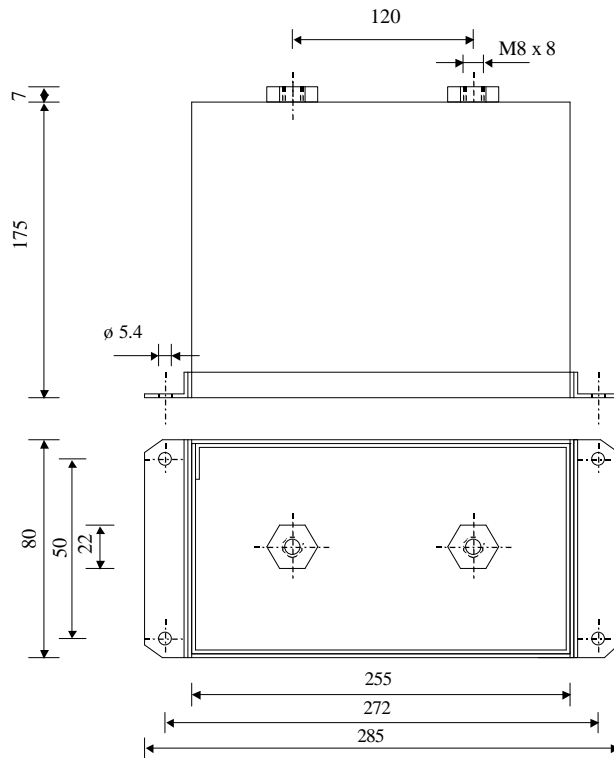

Dielectric of metallized polyester

Threaded outputs

Resin end sealing

Aluminium case  
thick 1.2 mm

| Parameter                              | Symbol       |      | Value          | Unit       | Condition       |
|--|--------------|------|----------------|------------|-----------------|
| Capacitance                            | C            |      | 5000           | $\mu$ F    | 1 V / 100 Hz    |
| Tolerance                              |              |      | $\pm 10$       | %          |                 |
| Rated voltage                          | Un DC        |      | 600            | VDC        |                 |
| Surge current                          | I cr. max    |      | 1'000          | A          |                 |
| Equivalent serie resistance            | ESR          |      | $\leq 2.6$     | m $\Omega$ | 1 kHz           |
| Stray inductance                       | ESL          |      | $\leq 50$      | nH         |                 |
| Insulation resistance                  | Ri x C       |      | $> 10'000$     | s          | 100 VDC - 1 min |
| Test voltage between terminals         | U T1         |      | 660            | VDC        | 10 s            |
| Test voltage between terminals to case | U T2         |      | 2'500          | VAC        | 50 Hz - 1 min   |
| Operating temp.                        |              |      | - 25 / + 70 °C |            |                 |
|  |              |      |                |            |                 |
|  |              |      |                |            |                 |
|  |              |      |                |            |                 |
| Dimension                              | Symbol       |      |                | Unit       | Conditions      |
| Width                                  | B            |      | 80             | mm         |                 |
| Length                                 | L            |      | 255            | mm         |                 |
| Height                                 | H            |      | 175            | mm         |                 |
| Thread                                 |              |      | M8 x 8         | mm         |                 |
| Thread spacing                         |              |      | 120            | mm         |                 |
|  |              |      |                |            |                 |
|  | M1           |      |                |            |                 |
|  | M0           |      |                |            |                 |
|  | Modification | Date | Visa émetteur  |            |                 |

Condensateurs CH 1400 Yverdon-les-Bains  
 Kondensatoren Tel.: ++41 24 445 66 88  
 Capacitors Fax: ++41 24 445 66 89

**Le lanché**  
**Capacitors**  
A FROEGER & TALECHÉ COMPANY

HJJ

18.09.2009

faisab5855.XLS