

Leclanché Capacitors
48, av. de Grandson
1400 Yverdon, Switzerland



Tel. +41 24 445 66 88
Fax +41 24 445 66 89
capinfo@Lcap.ch
www.Lcap.ch

Drawing No. : 1024707-53567
created from : 18/01/2013 08:06:00

Part Number : GB10304050060

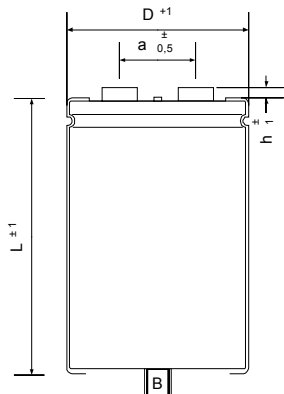

∅ D : 50 mm
L : 60 mm
a : 22 mm
h : 5 mm
B : M 12 x 16
Terminals : M 5

Electrical Parameter

| | | |
|--|--------------------|--------------------|
| Rated Capacitance (C _R) @ 100 Hz / 20 °C | 10000 μF | |
| Tolerance | -10 +30 % | |
| Rated Voltage (U _R) | 40 V | |
| Surge Voltage (U _S) max. 5 x 1 min / h | 46 V | |
| Reverse Voltage (U _U) max. 1 s | 2 V | |
| Leakage Current (I _L) @ U _R / 5 min / 20 °C | 2400 μA | |
| ESR typ. @ 100 Hz / 20°C | 27 mΩ | |
| Tan δ typ. @ 100 Hz / 20°C | 17 % | |
| Z max. @ 10 kHz / 20°C | 22 mΩ | |
| ESL typ. | 20 nH | |
| Rated Ripple Current (I _R) @ 100 Hz / 105 °C | 4,5 A | |
| Useful life @ I _R , U _R , 85 °C | 32000 h | |
| IEC Climatic category / Standards | 40/105/56 | IEC 60384-4 |
| Applications | General Industrial | |
| Your article No. / Project | | |