

Leclanché Capacitors
48, av. de Grandson
1400 Yverdon, Switzerland



Tel. +41 24 445 66 88
Fax +41 24 445 66 89
capinfo@Lcap.ch
www.Lcap.ch

Drawing No. : 100010927
created from : hm 15/03/2013 10:14:00

Part Number : GB10335090200

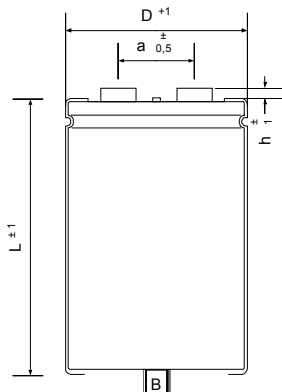

Ø D : 90 mm
L : 200 mm
a : 31,7 mm
h : 5 mm
B : M12 x 16

Terminals :

Electrical Parameter

Rated Capacitance (C _R) @ 100 Hz / 20 °C	10000 µF	
Tolerance	-10 +30 %	
Rated Voltage (U _R)	350 V	
Surge Voltage (U _S) max. 5 x 1 min / h	385 V	
Reverse Voltage (U _U) max. 1 s	2 V	
Leakage Current (I _L) @ U _R / 5 min / 20 °C	21000 µA	
ESR typ. @ 100 Hz / 20°C	9,6 mΩ	
Tan δ typ. @ 100 Hz / 20°C	6 %	
Z max. @ 10 kHz / 20°C	8,2 mΩ	
ESL typ.	20 nH	
Rated Ripple Current (I _R) @ 100 Hz / 105 °C	25 A	
Useful life @ I _R , U _R , 105 °C	8000 h	
IEC Climatic category / Standards	40/105/56	IEC 60384-4
Applications	General Industrial	
Your article No. / Project		